

Mobile Kids' Desk

SKU: DESK-V202A

Instruction Manual

Assembly Video & Product Info
www.vivo-us.com/products/desk-v202a





If you do not understand these directions, or if you have any doubts about the safety of the installation, please contact our product support team at 309-278-5303 or help@vivo-us.com for further assistance. Check carefully to make sure there are no missing or defective parts. Improper installation may cause damage or serious injury. Do not use this product for any purpose that is not explicitly specified in this manual. Do not exceed weight capacity. We cannot be liable for damage or injury caused by improper mounting, incorrect assembly or inappropriate use.



WARNING: CHOKING HAZARD

SMALL PARTS - NOT FOR CHILDREN UNDER 3 YEARS. ADULT SUPERVISION IS REQUIRED.



DO NOT EXCEED WEIGHT CAPACITY

FAILURE TO DO SO MAY RESULT IN SERIOUS INJURY.



WARNING: PINCH POINT

DO NOT PLACE HANDS ON OR NEAR SUPPORT BARS. MOVING PARTS CAN CRUSH AND CUT. PINCH POINTS ARE CREATED DURING LIFTING AND LOWERING THE WORK SURFACE. FAILURE TO FOLLOW THESE INSTRUCTIONS MAY RESULT IN SERIOUS PERSONAL INJURY.

We're Here for You

Open **Monday - Friday 7:00am - 7:00pm CST**, our dedicated support team can offer immediate assistance with rapid response times. If any parts are received damaged or defective, please contact us. We are happy to replace parts to ensure you have a fully functioning product.



Give us a Call:

309-278-5303

AVG. RESOLUTION TIME *(within office hrs)*: **5M 4S**



Chat Us:

www.vivo-us.com

AVG. RESOLUTION TIME *(within office hrs)*: **< 15 M**



Email Us:

help@vivo-us.com

AVG. RESPONSE TIME *(within office hrs)*: **1HR 8M**

- 23% within < 15m
- 38% within < 30m
- 61% within < 1hr
- 83% within < 2hr
- 92% within < 3hr

Package Contents

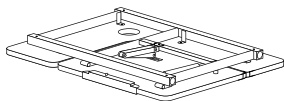

A (x1)
Desktop

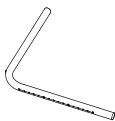

B (x4)
Connecting
Pipe

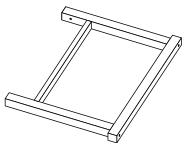

C (x2)
Leg



D (x4)
Caster



E (x1)
Pen Holder

Included Hardware & Tools



S-A (x8)
Knob

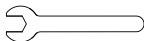

T-A (x1)
Wrench

Weight Capacity:



ASSEMBLY STEPS

STEP 1

Thread Casters (D) into Legs (C) using Wrench (T-A). Use Brake Levers on Casters to lock rotation.

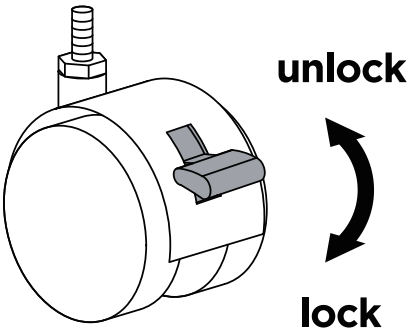
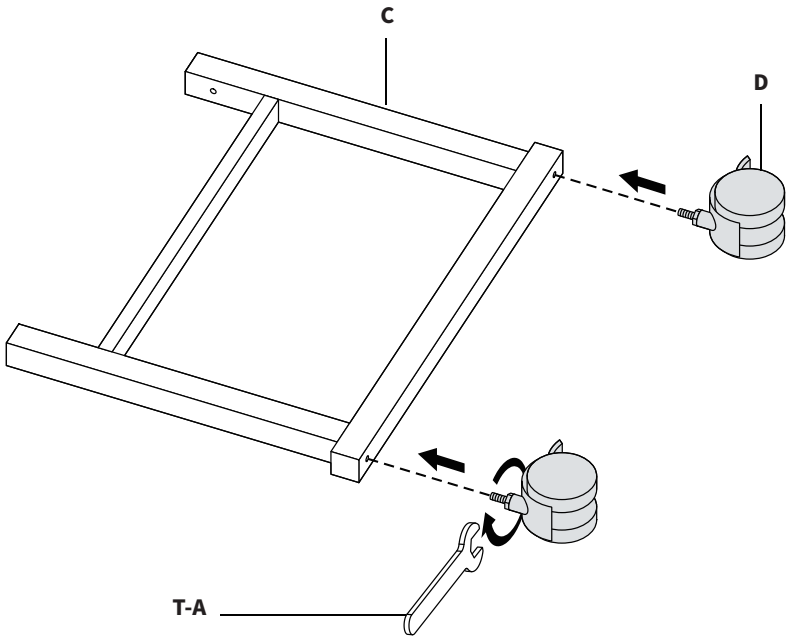

STEP 2

Insert the end of Connecting Pipe **(B)** with the printed scale marked 80cm to 130cm into Desktop **(A)** as shown.

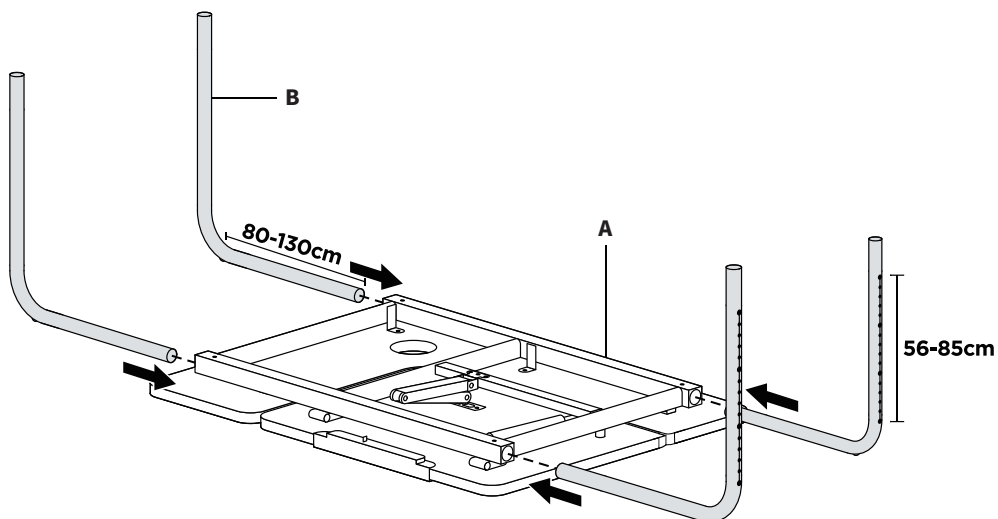

STEP 3

Slide Legs **(C)** over Connecting Pipes **(B)**. Adjust to desired height and secure using Knobs **(S-A)**.



S-A (x4)

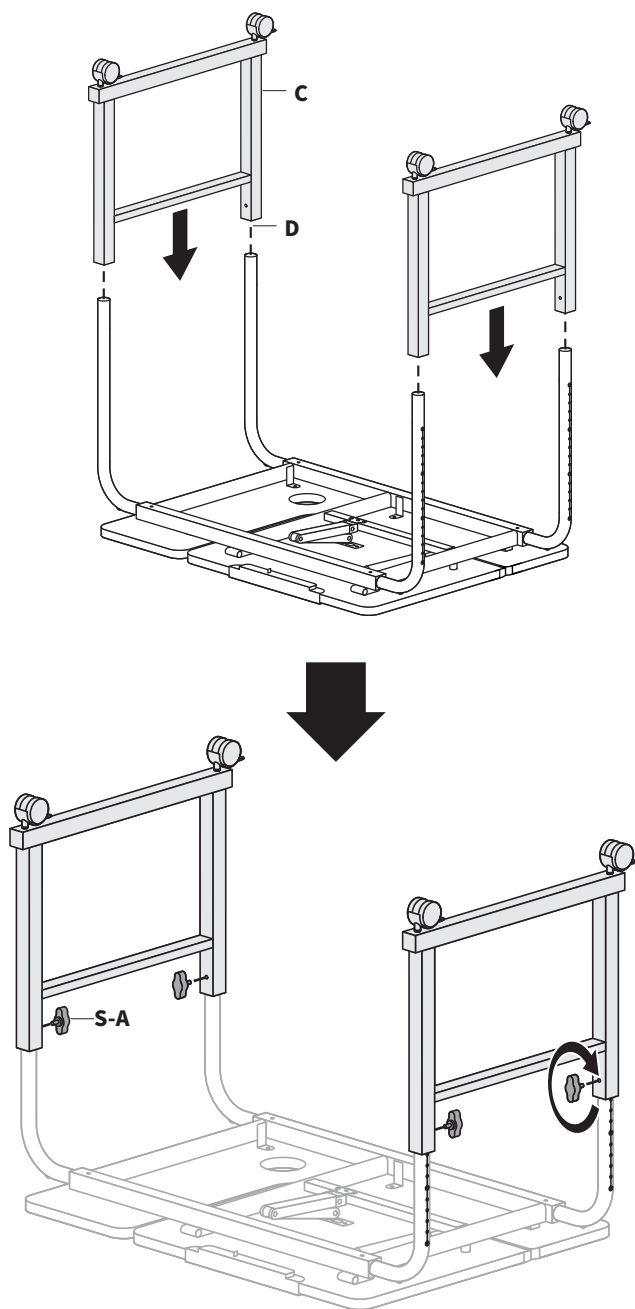

STEP 4

Secure Connecting Pipes (**B**) to Desktop (**A**) using Knobs (**S-A**).



S-A (x4)

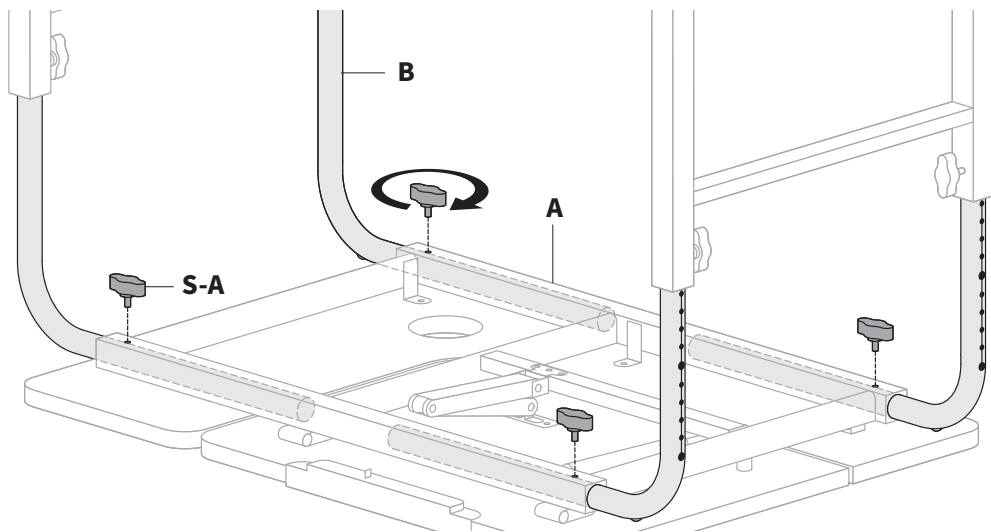

STEP 5

Flip assembled desk right side up. Insert Pen Holder (**E**) into Desktop (**A**). Raise the Retention Lip on Desktop (**A**) by releasing the button underneath. To lower the Retention Lip, press down until it locks into place.

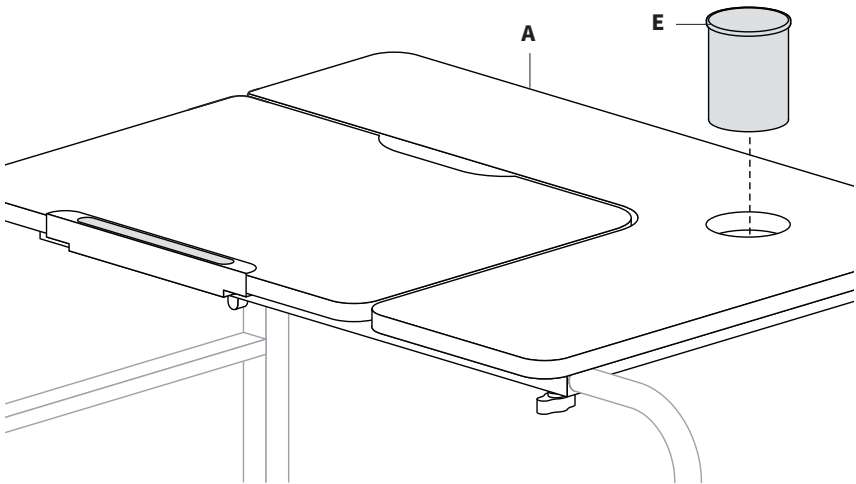
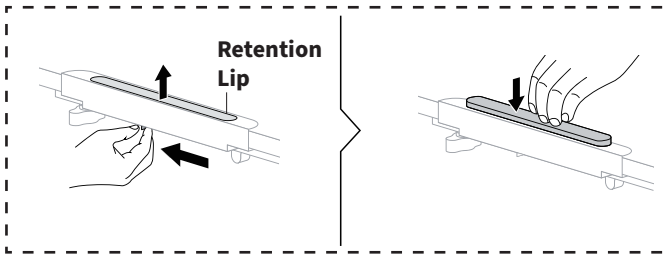

STEP 6

To lower, lift the desk surface past 80° to unlock, and lower it to the flush position.

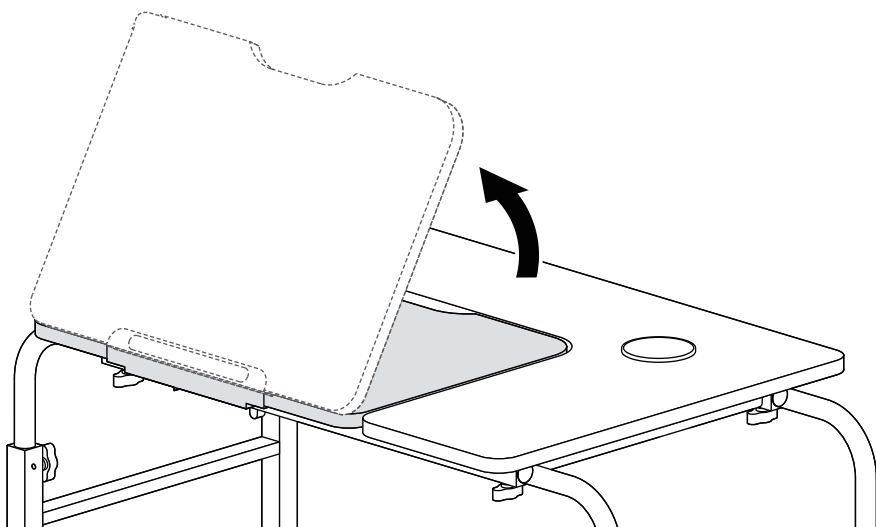

To lower, lift the desk surface past 80° to unlock, and lower it to the flush position.

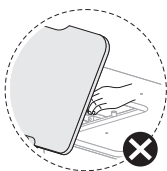
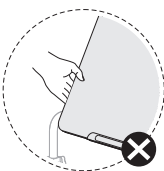
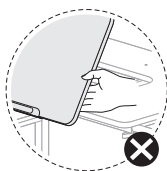
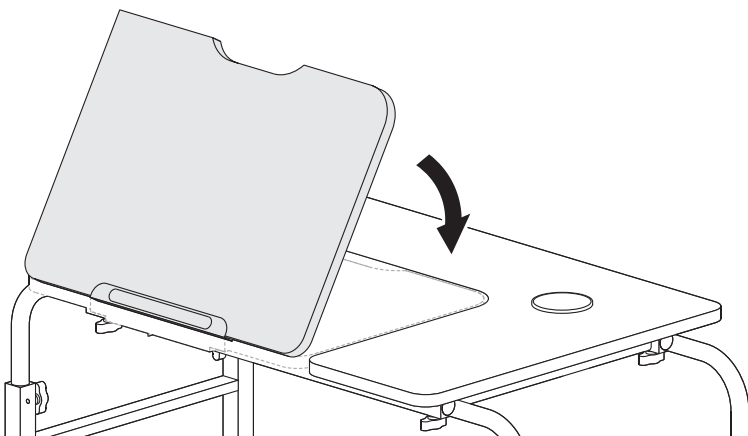

WARNING: PINCH POINT

DO NOT place hands on or near support bars. Pinch points are created during lifting and lowering desktop. Failure to follow this instruction may result in serious injury.

STEP 7

Loosen Knobs (**S-A**) under Desktop (**A**) to adjust the width of the desk assembly.

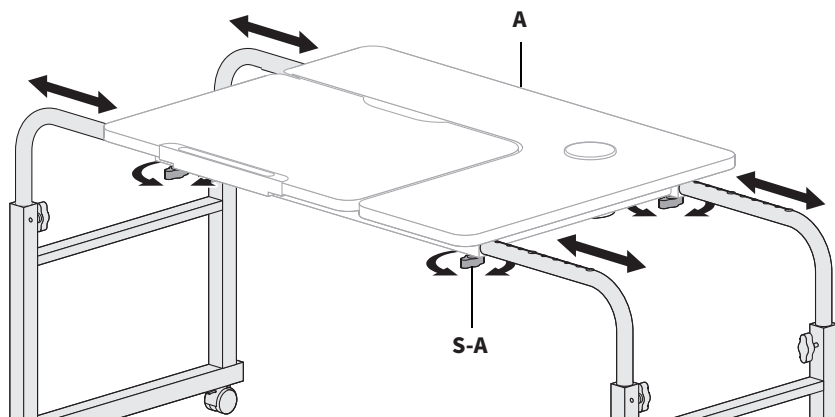

STEP 8

Loosen Knobs (**S-A**) on Legs (**C**) to adjust the height of the desk assembly.

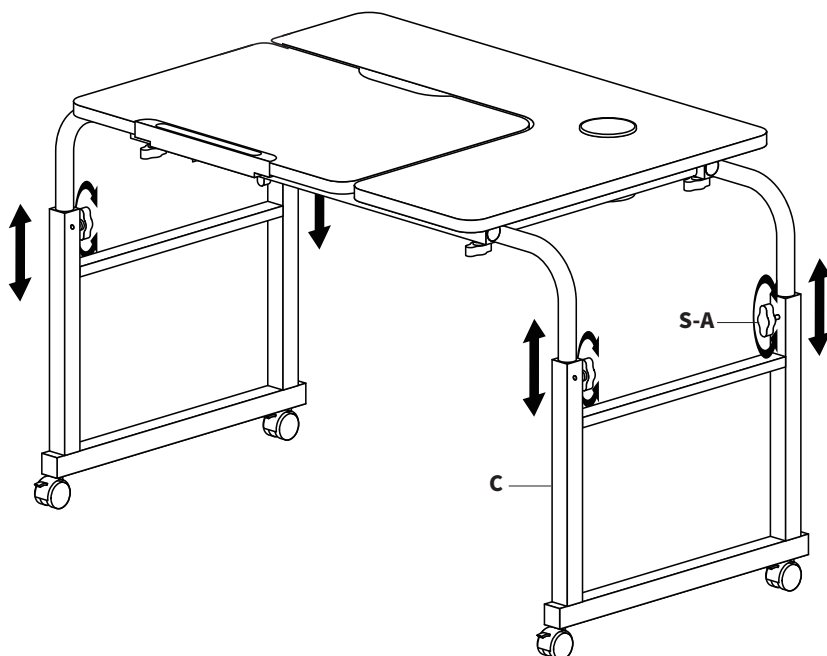

[THIS PAGE INTENTIONALLY LEFT BLANK]

LAST UPDATED: 10/25/23

REV3.1

v1.2



Need Help? Get In Touch

Monday-Friday from 7:00am-7:00pm CST



help@vivo-us.com



www.vivo-us.com

Chat live with an agent!



309-278-5303



VIVO-us



@vivo_us

FOR MORE GREAT VIVO PRODUCTS,
CHECK OUT OUR WEBSITE AT: [WWW.VIVO-US.COM](https://www.vivo-us.com)