

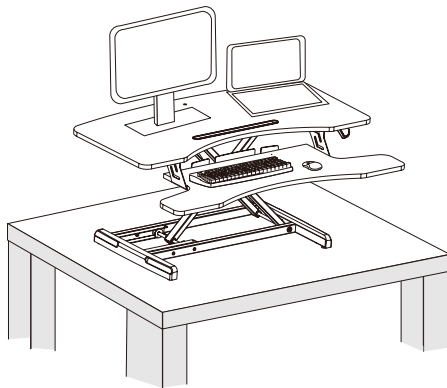

---

## Black 30" Desk Riser

### Instruction Manual



**SKU: DESK-V000M**



Scan the QR code with your mobile device or follow the link for helpful videos and specifications related to this product.

<https://vivo-us.com/products/desk-v000m>

---

**GET IN TOUCH** | Monday-Friday from 7:00am-7:00pm CST



help@vivo-us.com



www.vivo-us.com  
*Chat live with an agent!*



309-278-5303

# **WARNING!**

If you do not understand these directions, or if you have any doubts about the safety of the installation, please call a qualified technician. Check carefully to make sure there are no missing or defective parts. Improper installation may cause damage or serious injury. Do not use this product for any purpose that is not explicitly specified in this manual and do not exceed weight capacity. We cannot be liable for damage or injury caused by improper mounting, incorrect assembly or inappropriate use.

## PACKAGE CONTENTS



**A (x1)**  
Adjustable  
Desk



**B (x2)**  
Support  
Bracket



**C (x1)**  
Keyboard  
Tray



**D (x6)**  
M5x12



**E (x6)**  
M5x12



**F (x2)**  
Cable Tie

## TOOLS NEEDED



**Phillips  
Screwdriver**



**Scissors**

## **WARNING**

### **PINCH POINT**

DO NOT place hands on or near support bars. Moving parts can crush and cut. Pinch points are created during lifting and lowering the worksurface. Failure to follow these instructions may result in serious personal injury.



**DO NOT EXCEED WEIGHT CAPACITY.**

Failure to do so may result in serious injury.



**DESK**



**KEYBOARD TRAY**

## **WARNING: CHOKING HAZARD**

SMALL PARTS - NOT FOR CHILDREN UNDER 3 YEARS. ADULT SUPERVISION IS REQUIRED.

## ASSEMBLY STEPS

### STEP 1

Carefully remove adjustable desk and contents from packaging.

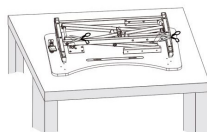
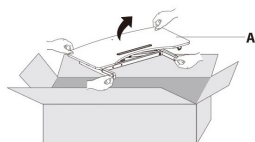

### STEP 2

Remove shipping strap from adjustable desk (A). Squeeze the handle on the right side to raise the desktop.

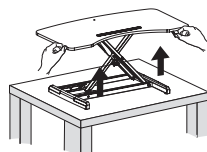
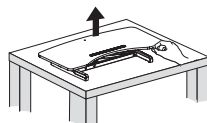
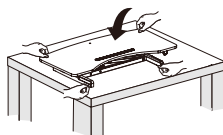

### STEP 3

Mount support brackets **(B)** to keyboard tray **(C)** using M5x12mm screws **(D)**.

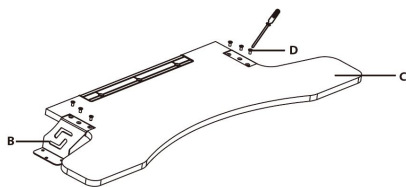

### STEP 4

Mount keyboard tray to desk using M5x12mm screws **(E)**.

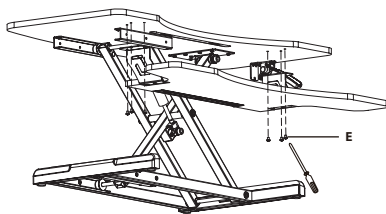

### STEP 5

Place laptop, monitor and other items on desk surface.

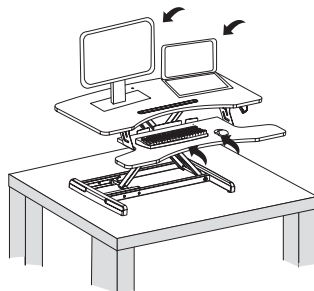

### STEP 6

Squeeze the handle on the right side, then raise or lower desktop to the desired height. Manage cables using cable ties **(F)**.

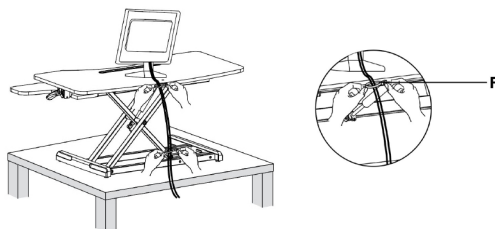

### CAUTION!



Keep monitor and laptop base fully on the desktop.



Follow the cable routing instructions to avoid the potential to pinch cables.



Leave enough slack in cable to allow for full range of vertical motion (19.3" / 49 cm).



Raise desktop slowly to keep items stable.

Failure to follow these instructions may result in property damage and/or personal injury.



Love your new VIVO setup and want to share?  
Tag us in your photo! **@vivo\_us**

LAST UPDATED: 03/04/2020



Open **Monday - Friday 7:00am - 7:00pm** CST,

our dedicated support team can offer immediate assistance with rapid response times. If any parts are received damaged or defective, please contact us. We are happy to replace parts to ensure you have a fully functioning product.



[help@vivo-us.com](mailto:help@vivo-us.com)

**AVG. RESPONSE TIME** (*within office hrs*): **1HR 8M**

- 23% within < 15m
- 38% within < 30m
- 61% within < 1hr
- 83% within < 2hr
- 92% within < 3hr



[www.vivo-us.com](http://www.vivo-us.com)  
*Chat live with an agent!*

**AVG. RESOLUTION TIME** (*within office hrs*): **< 15 M**



309-278-5303

**AVG. RESOLUTION TIME** (*within office hrs*): **5M 4S**

FOR MORE VIVO PRODUCTS, CHECK OUT OUR WEBSITE AT: [www.vivo-us.com](http://www.vivo-us.com)