

Black 2 Tier 75" x 63" Corner Table Top with Storage Instruction Manual

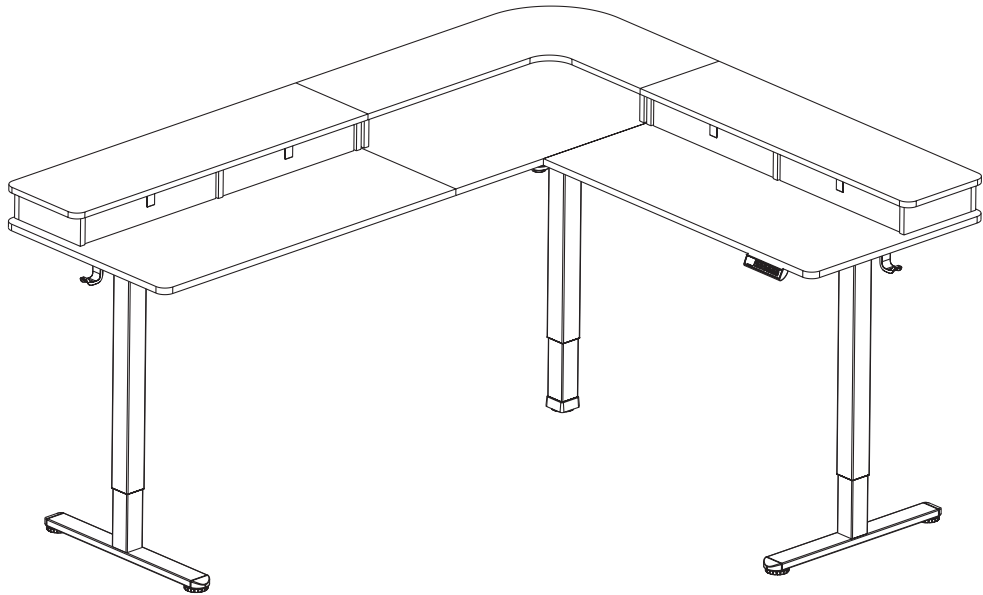

SKU: DESK-E3CVB-75 SERIES

Frame:
DESK-E375B

Table Top:
DESK-E3CVB-75-A



ASSEMBLY VIDEO AVAILABLE:

Follow along step-by-step with our video walk through by scanning the QR code with your mobile device or by following the product link: vivo-us.com/products/desk-e3cvb

Contact Us First!

DO NOT RETURN ITEM

Our friendly product support team is here to help!



PERSONABLE CUSTOMER SUPPORT

7AM - 7PM

Monday-Friday



Give us a Call:
309-278-5303



Chat Us:
www.vivo-us.com



Email Us:
help@vivo-us.com

We're Here for You!

Our customer-minded support team is here for YOU,

Monday-Friday 7am-7pm CST.

We offer immediate assistance with rapid response times from customer service agents and product technicians to help you every step of the way!



Missing a Part?

If any parts are received damaged / defective OR you are missing a part, please reach out to us ***within 30 days of product delivery to have it replaced at no cost.***

We are happy to replace parts to ensure you have a fully functioning product

PRE-ASSEMBLY | BEFORE YOU BEGIN



If you do not understand these directions, or if you have any doubts about the safety of the installation, please call a qualified technician. Check carefully to make sure there are no missing or defective parts. Improper installation may cause damage or serious injury. Do not use this product for any purpose that is not explicitly specified in this manual. Do not exceed weight capacity. We cannot be liable for damage or injury caused by improper mounting, incorrect assembly or inappropriate use.

WARNING: CHOKING HAZARD

SMALL PARTS - NOT FOR CHILDREN UNDER 3 YEARS. ADULT SUPERVISION IS REQUIRED.

ELECTRICAL WARNING :

THIS PRODUCT IS POWERED BY ELECTRICITY. IN ORDER TO AVOID BURNS, FIRE AND ELECTRIC SHOCK, PLEASE READ THE FOLLOWING INSTRUCTIONS CAREFULLY.

- DO NOT CLEAN PRODUCT WHILE POWER IS CONNECTED.
- DO NOT DISASSEMBLE OR REPLACE COMPONENTS WHILE POWER IS CONNECTED.
- NEVER OPERATE THE SYSTEM WITH A DAMAGED CORD OR PLUG. PLEASE CONTACT YOUR SELLER TO REPLACE DAMAGED PARTS.
- NEVER OPERATE SYSTEM IN DAMP ENVIRONMENTS OR IF ANY ELECTRICAL COMPONENTS HAVE MADE CONTACT WITH LIQUIDS.
- ALTERATIONS OF THE GIVEN POWER UNIT ARE NOT ALLOWED.
- OUTDOOR USE IS PROHIBITED.

WEIGHT CAPACITY

DO NOT EXCEED WEIGHT CAPACITY. Failure to do so may result in serious injury.



176lbs
(80kg)



Product Warranty

For the most up to date details on your product's warranty, please visit the product's listing on our website or reach out to customer support.

vivo-us.com/products/desk-e3cvb



Returns | Product Didn't Work Out?

We offer a hassle-free 30 day return on all products. Contact customer support at 309-278-5303 or help@vivo-us.com. Please note: For items ordered in error or no longer needed, the return shipping charges will be at the buyer's expense.

Package Contents

Desktop & Shelf Parts



A1 (x1)
Corner Panel



A2 (x1)
Right Panel



A3 (x1)
Left Panel



B1 (x1)
Corner Shelf Panel



B2(x1)
Left Shelf Panel



B3 (x1)
Right Shelf Panel



B4 (x8)
Shelf Divider



B5 (x1)
Short Corner
Shelf Panel

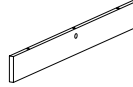

B6 (x1)
Long Corner
Shelf Panel



B7 (x2)
Rear Shelf Panel

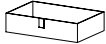

C (x4)
Drawer

Desk Frame Parts

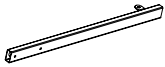

D (x1)
Straight Outer
Crossbar

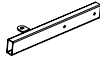

E (x1)
Short Corner
Crossbar



F (x1)
Long Corner
Crossbar

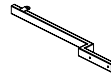

G (x1)
Angled Outer
Crossbar



H (x1)
Short Sync Rod



I (x1)
Long Sync Rod



J (x2)
Side Bracket

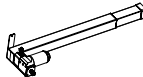

K (x1)
Motorized Leg

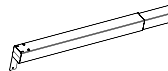

L (x1)
Right Leg

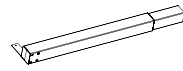

M (x1)
Left Leg

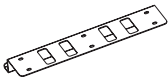

N (x1)
Crossbar Connector
Bracket



O (x1)
Inner Crossbar



P (x2)
Connector Bar



R (x2)
Foot

Misc Parts

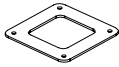

Q (x2)
Connector Plate



S (x1)
Control Panel

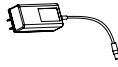

T (x1)
AC Adapter



U (x1)
Extension Cable



V (x21)
Anti-Vibration
Pads



W (x6)
Cable Clip



X (x5)
Locking Caster



Y (x2)
Hook

Included Hardware & Tools



S-A (x18)
M6x8mm Screw



S-B (x9)
M6x35mm Screw



S-C (x47)
ST5x15mm Screw



S-D (x26)
ST4.2x35mm Screw



S-E (x20)
Cam Lock Screw



S-F (x20)
Cam Lock Nut



S-G (x6)
M6x11mm Screw



S-H (x22)
Wooden Dowel



T-A (x1)
5mm Allen Wrench



T-B (x1)
2mm Allen Wrench



T-C (x1)
Wrench

NOTE: Extra hardware included.

Tools Needed:



**Phillips
Screwdriver**



Level

ASSEMBLY STEPS

STEP 1: Assemble Left Leg

Attach Straight Outer Crossbar (**D**) to Left Leg (**M**) using M6x8mm Screws (**S-A**) and 5mm Allen Wrench (**T-A**).

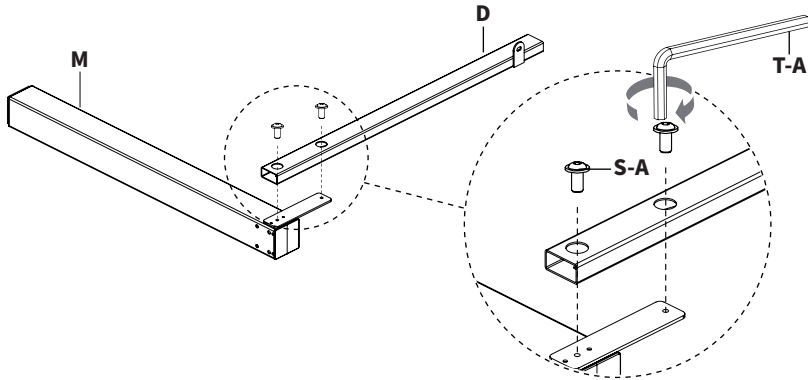

Attach Side Bracket (**J**) to Left Leg (**M**) using M6x8mm Screws (**S-A**) and 5mm Allen Wrench (**T-S**).

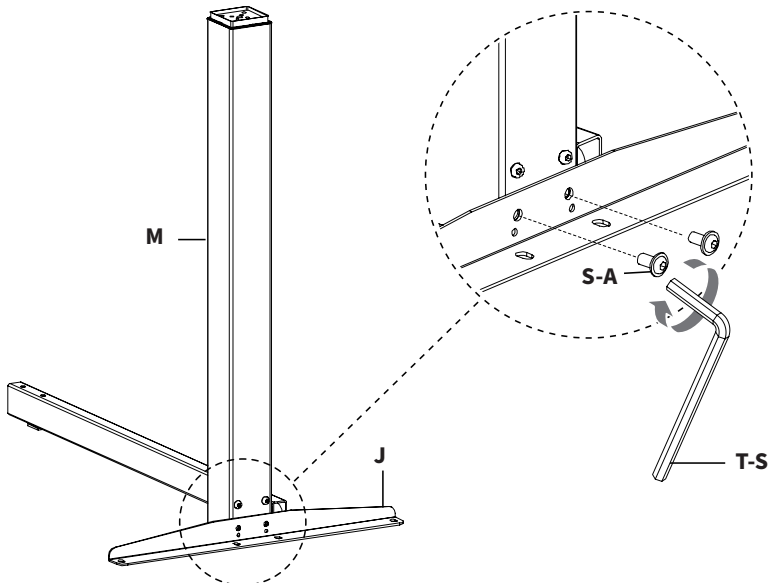

STEP 2: Assemble Right Leg

Attach Angled Outer Crossbar (**G**) to Right Leg (**L**) using M6x8mm Screws (**S-A**) and 5mm Allen Wrench (**T-A**).

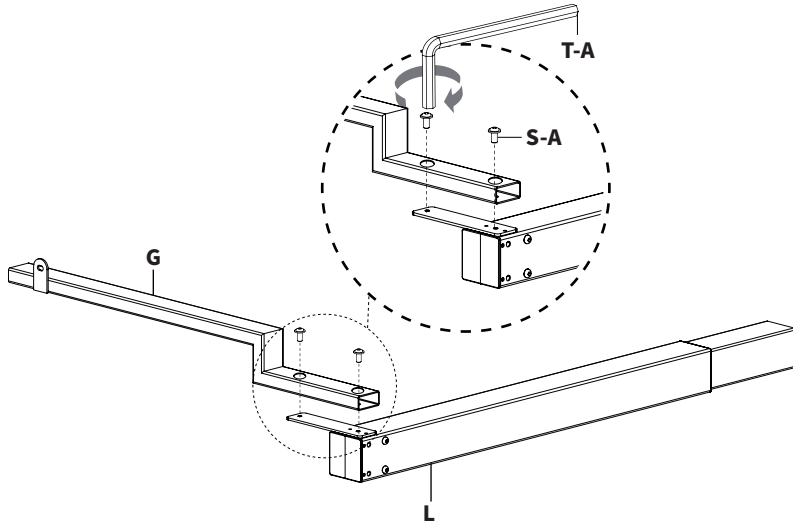

Attach Side Bracket (**J**) to Right Leg (**L**) using M6x8mm Screws (**S-A**) and 5mm Allen Wrench (**T-A**).

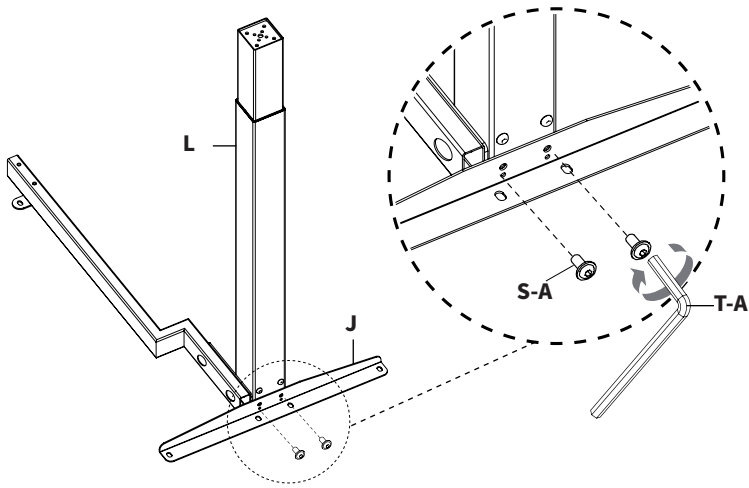

STEP 3: Install Feet & Connect Motorized Leg

Attach Feet (**R**) to Left and Right Legs (**M,L**) using M6x35mm Screw (**S-B**) and 5mm Allen Wrench (**T-A**).

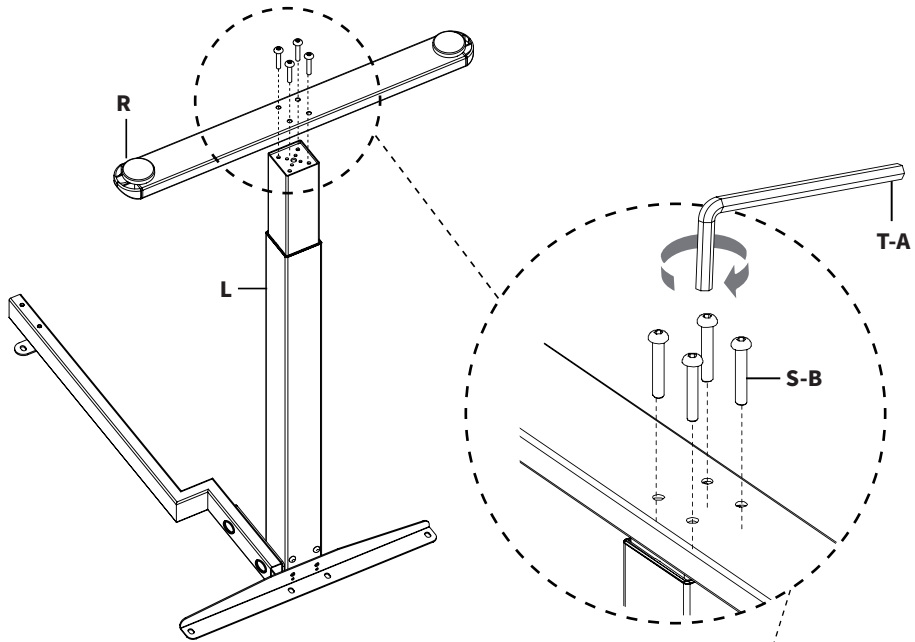

Optional: Add Casters

The preinstalled foot pads can be removed and replaced with Locking Casters (**X**). Tighten the Locking Casters using Wrench (**T-C**).

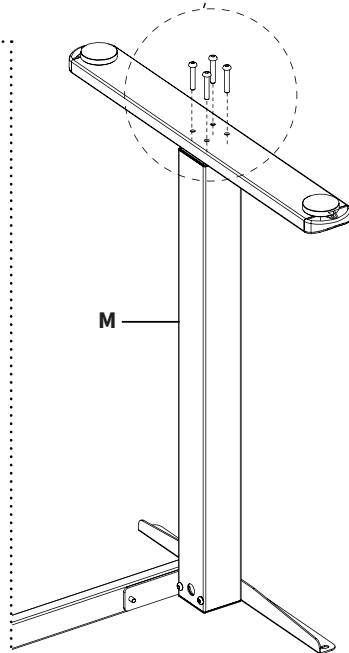
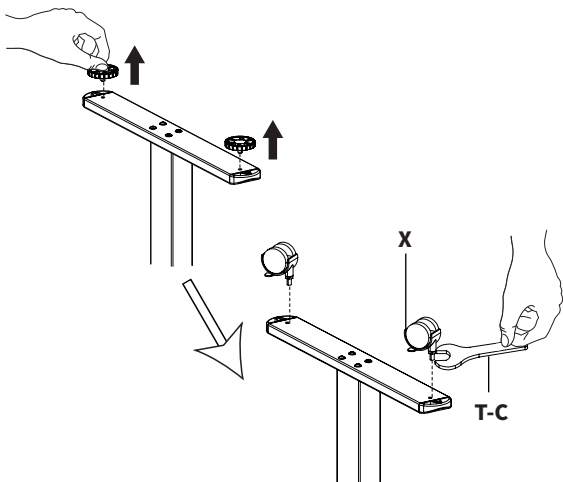

STEP 3.1: Install Feet & Connect Motorized Leg

Connect Short Corner Crossbar (E) and Long Corner Crossbar (F) to Motorized Leg (K) using M6x8mm Screws (S-A) and 5mm Allen Wrench (T-A).

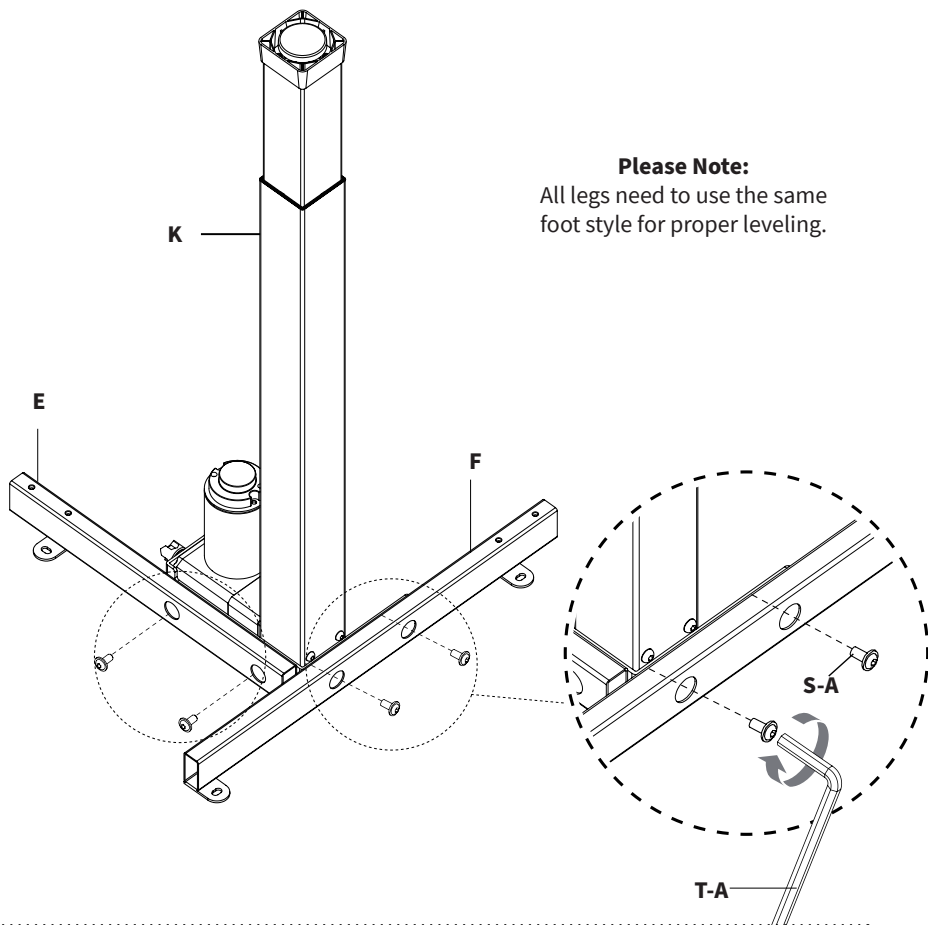

Optional: Add Casters

The preinstalled foot pads can be removed and replaced with Locking Casters (X). Tighten the Locking Casters using Wrench (T-C).

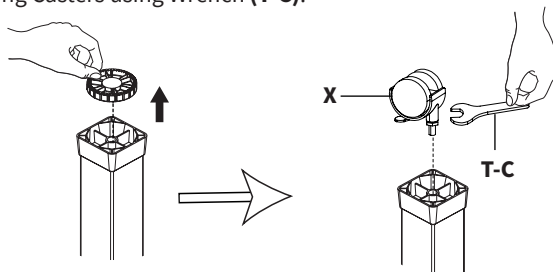

STEP 4: Install Anti-Vibration Pads

Affix Anti-Vibration Pads (**V**) to the desk frame and Connector Bracket (**N**).

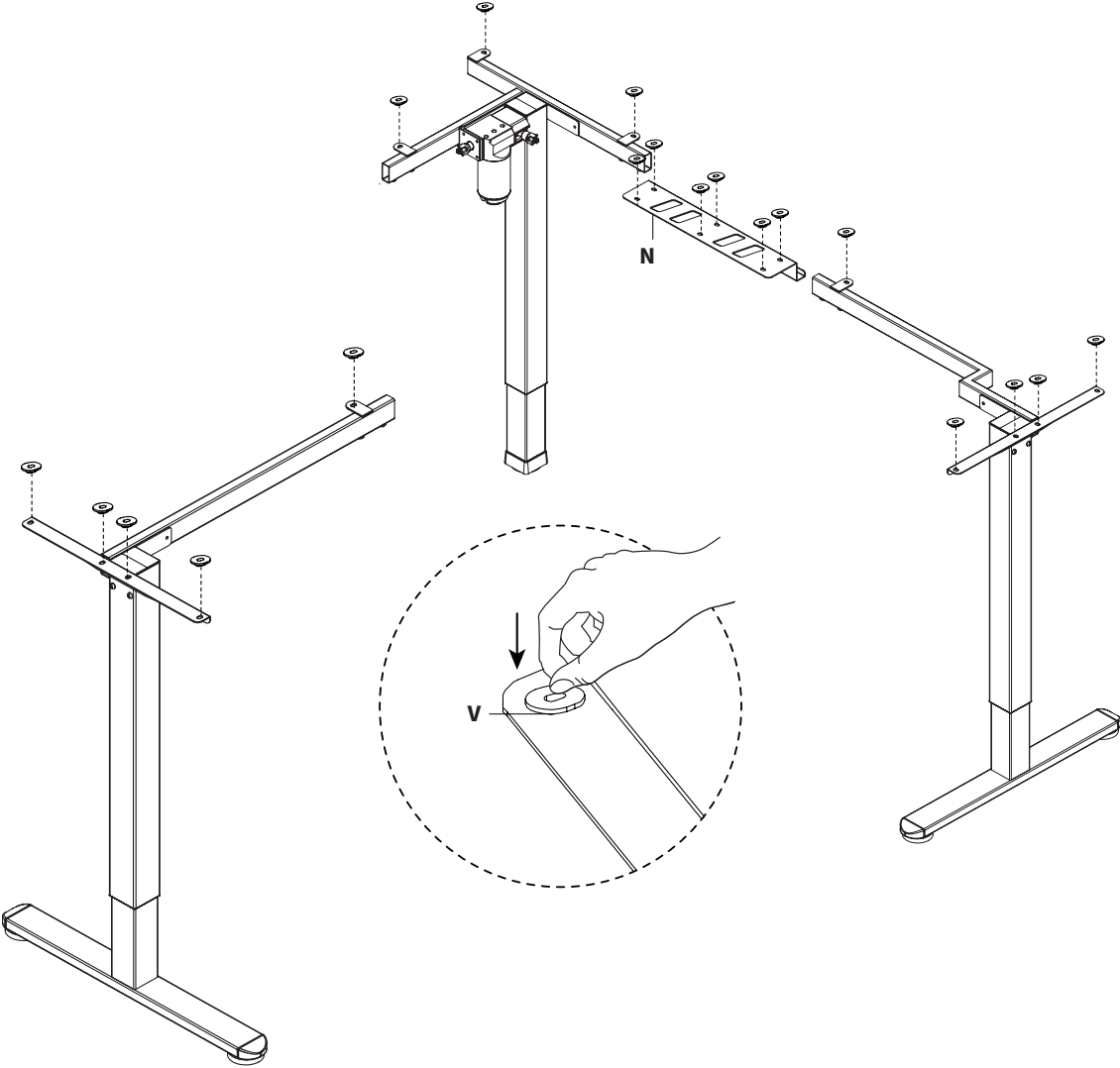

STEP 5: Assemble Desktop

Lay the Desktop Panels (**A1**, **A2**, **A3**) on a protective surface, following the pattern below, with the pilot holes facing up.

Join the Corner Panel (**A1**) and Right Panel (**A2**) using Connector Plate (**Q**) and ST5x15mm Screws (**S-C**).

Join the Corner Panel (**A1**) and Left Panel (**A3**) using the Long Connector Brackets (**P**) and ST5x15mm Screws (**S-C**). Tighten using a Phillips screwdriver or Power Drill.

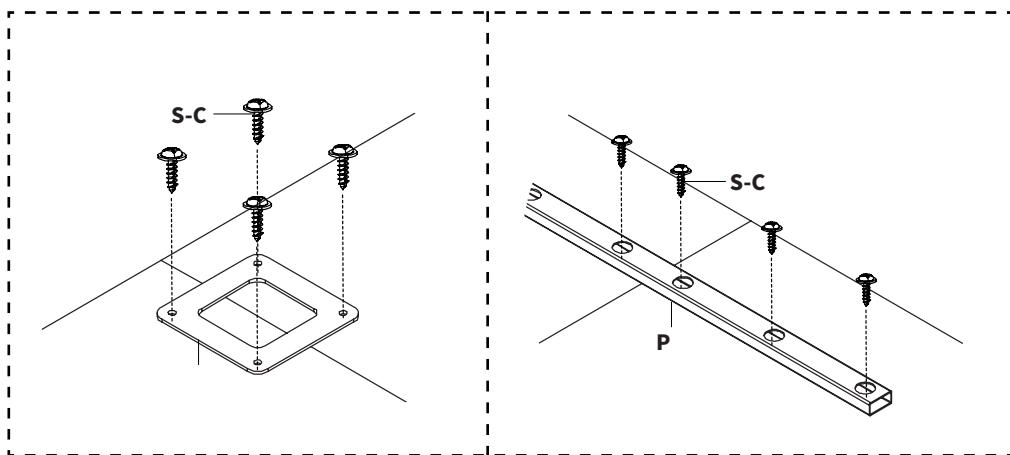
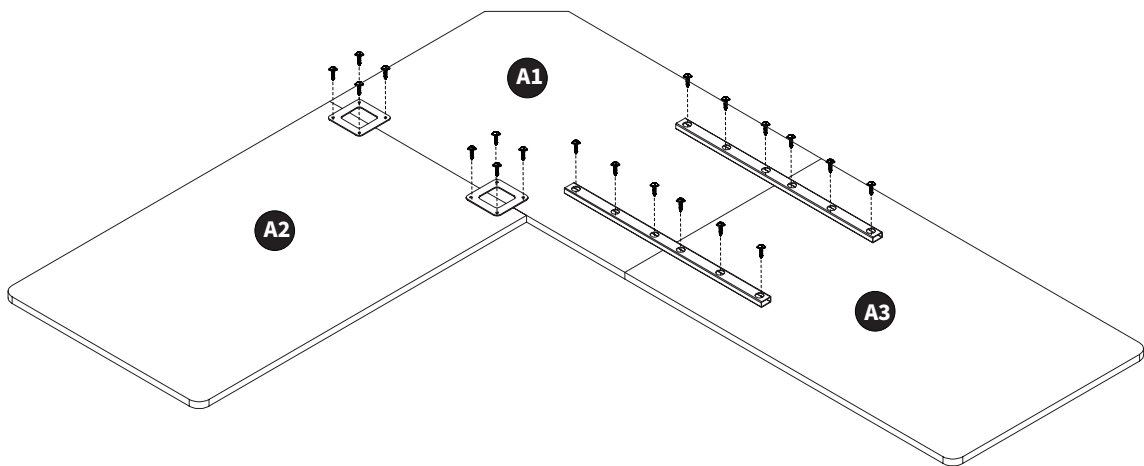

STEP 6: Install Connector Brackets

Place the Leg assemblies on the desktop as shown with the mounting holes aligned with the pilot holes on the desktop. Attach the Crossbar Connector Bracket (**N**) to the Angled Outer Crossbar (**G**) and Long Corner Crossbar (**F**) using M6x8mm Screws (**S-A**) and 5mm Allen Wrench (**T-B**).

Slide Inner Crossbar (**O**) into Short Corner Crossbar (**E**) making sure the slotted section is facing towards the motor.

Slide the leg assembly with Straight Outer Crossbar(**D**) over Inner Crossbar (**O**).

Make sure the frame mounting holes are aligned with the desktop pilot holes and fasten Inner Crossbar (**O**) using M6x11mm Screws (**S-G**) and 5mm Allen Wrench (**T-A**).

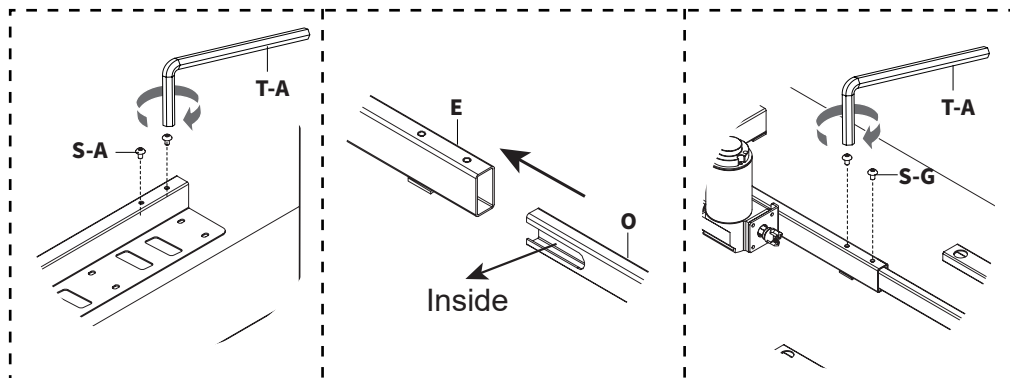
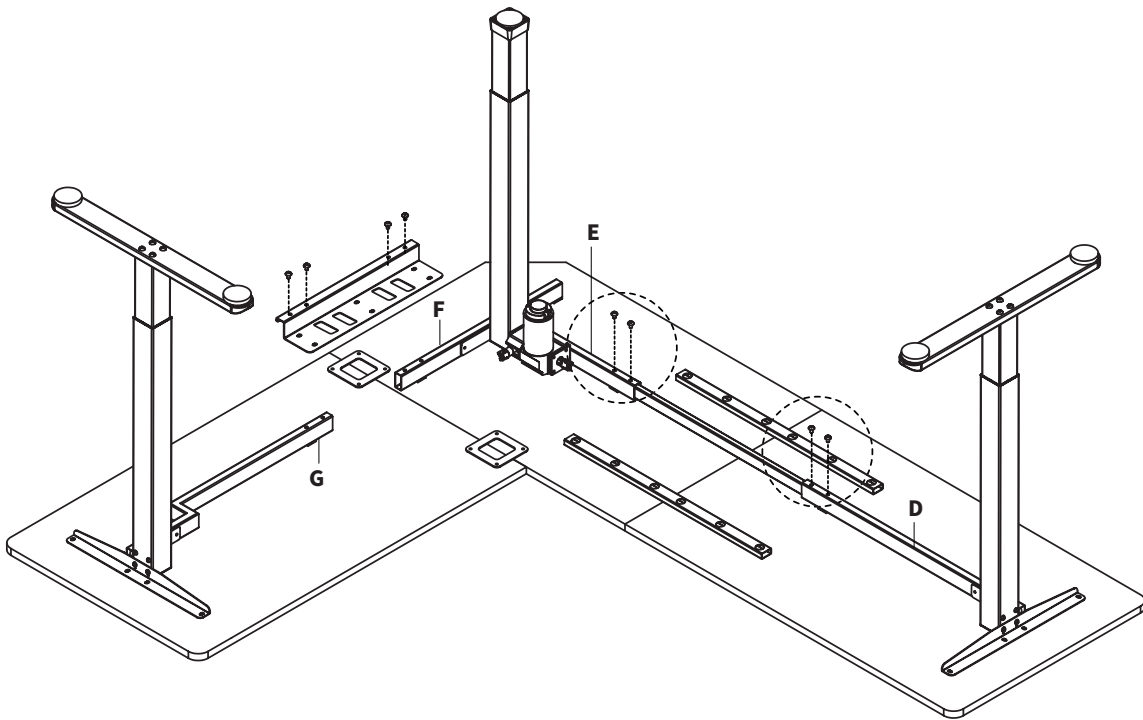

STEP 7: Secure Frame & Desktop

Secure the frame assembly, Hooks (**Y**), and Control Panel (**S**) to the desktop using ST5x15mm Screws (**S-C**) and a Phillips screwdriver or Power Drill.

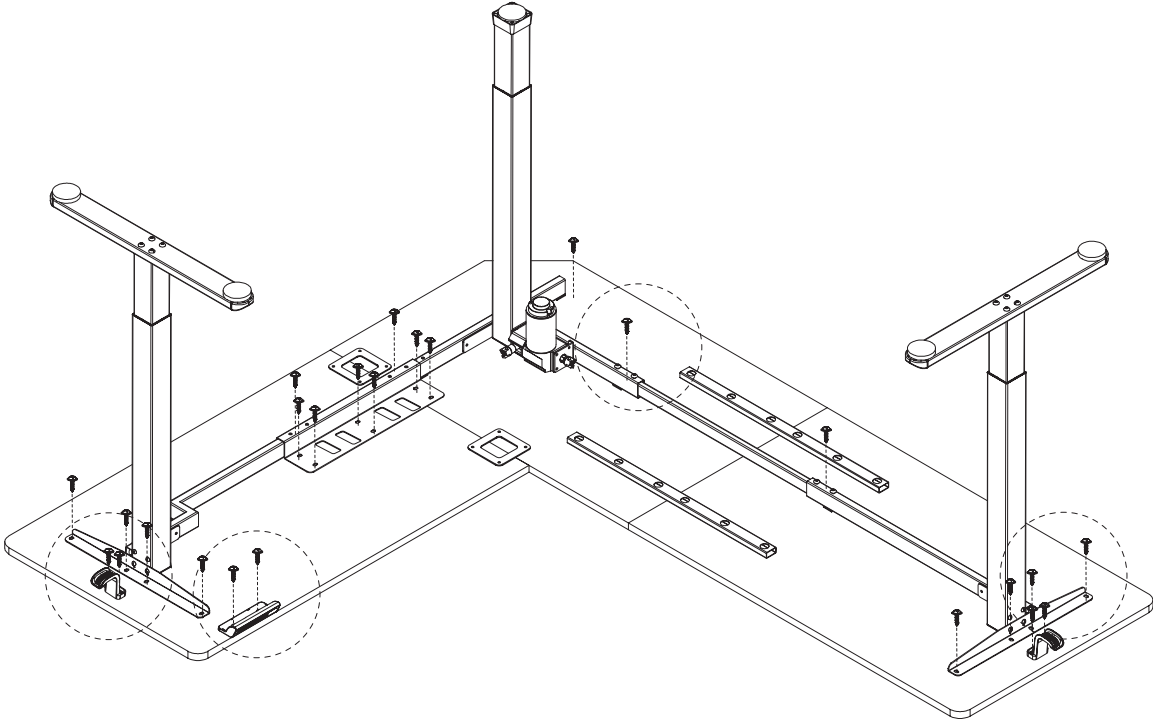
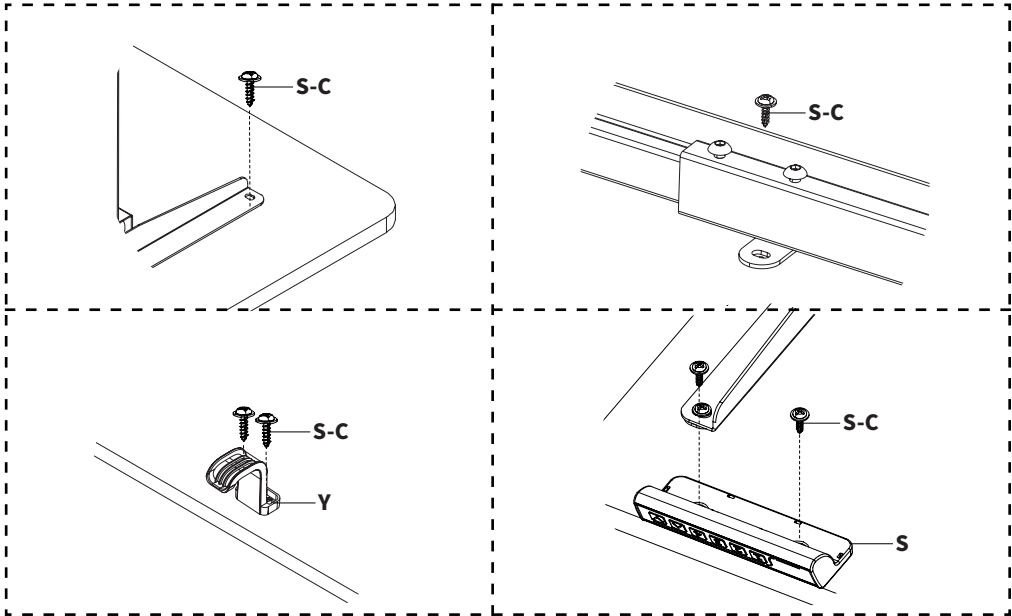

STEP 8: Install Sync Rod

Insert the hex shaft end on Long and Short Sync Rods (**H, I**) into Right and Left Legs (**L, M**) making sure the metal retaining ring makes contact with the leg.

Ensure all three legs are at the same height. If they are not, turn the sync rod clockwise to lower the legs (fig.1), and counterclockwise to raise the legs (fig. 2).

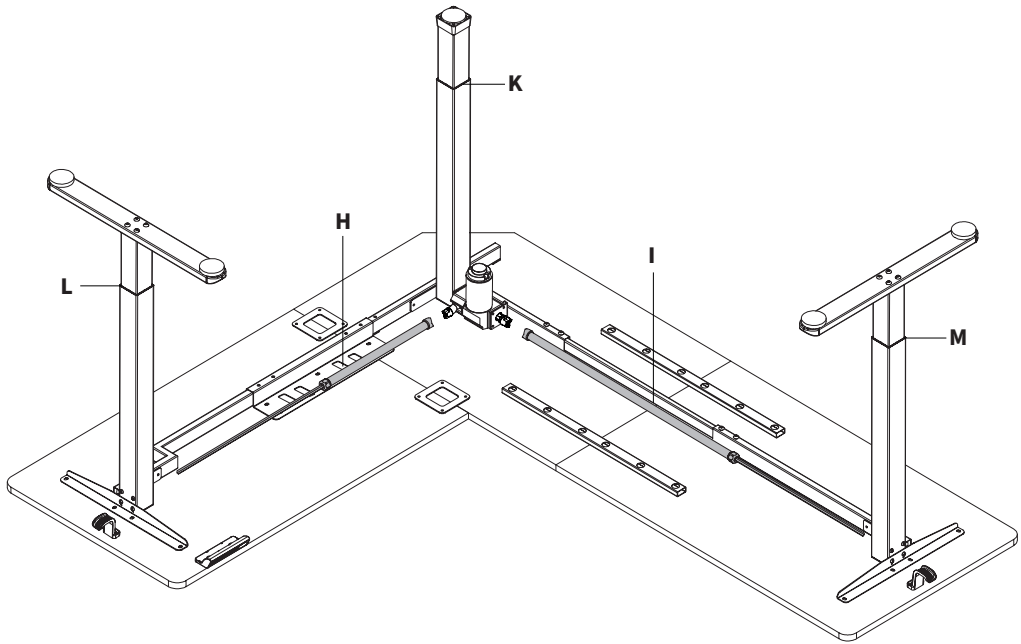

Fig. 1

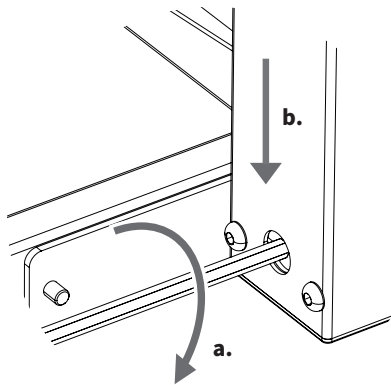
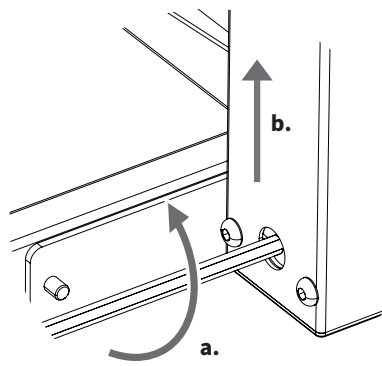
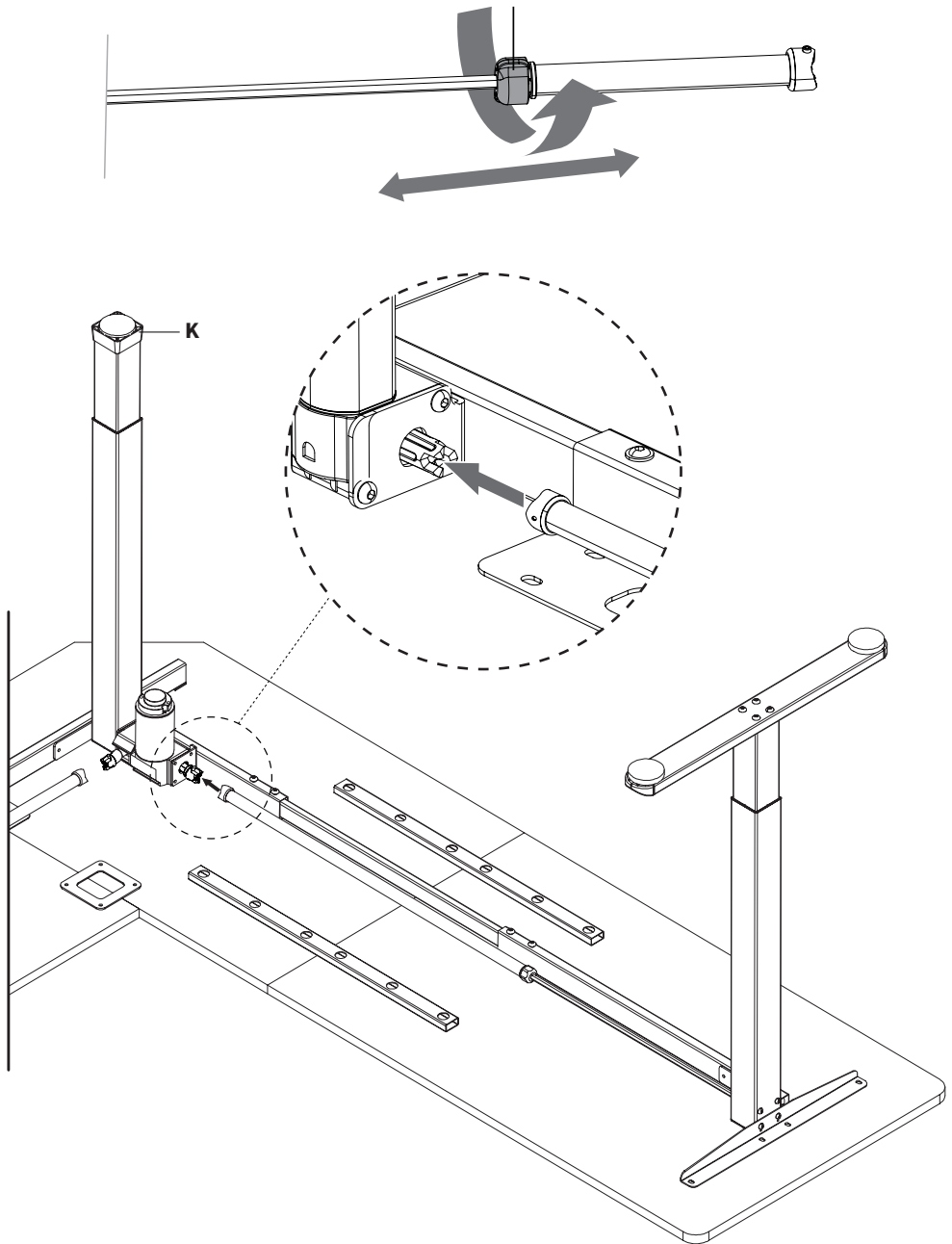

Fig. 2



Cont'd

Coupling Nut



STEP 8.2

Tighten coupling nuts, then tighten both set screws on the end of Sync Rods using 2mm Allen Wrench (**T-B**).

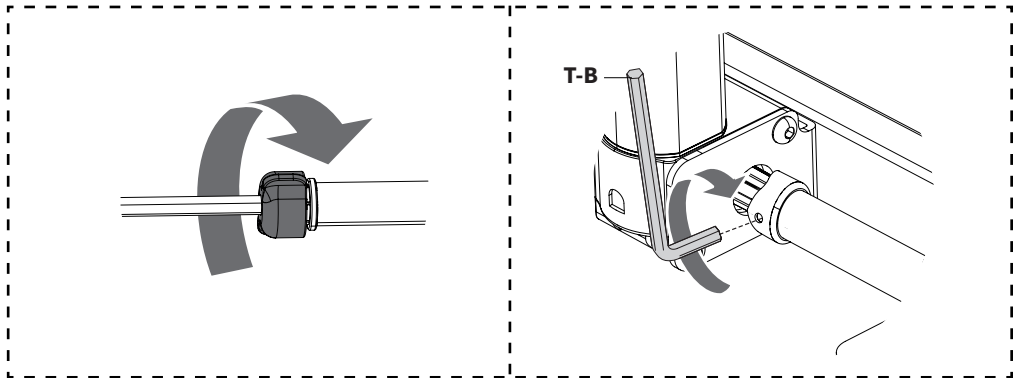
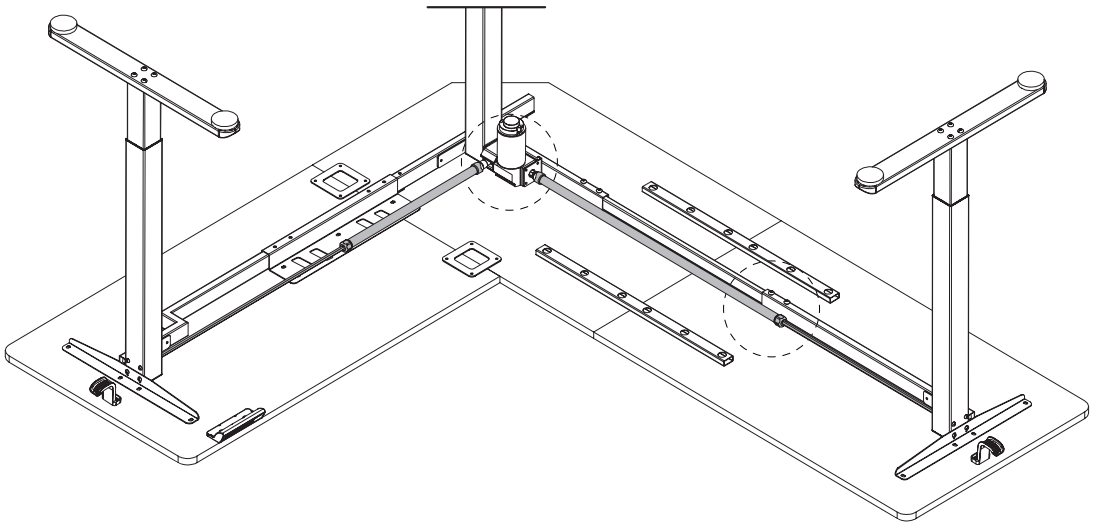

STEP 9: Connect Power Cords

Connect AC Adapter (**T**) and the cable from Motorized Leg (**K**) to the back of Control Panel (**S**). If needed, use the Extension Cable (**U**) to extend the cable coming off of Motorized Leg (**K**). Remove the protective film on Cable Clips (**W**) and attach them to the desktop to help organize cables.

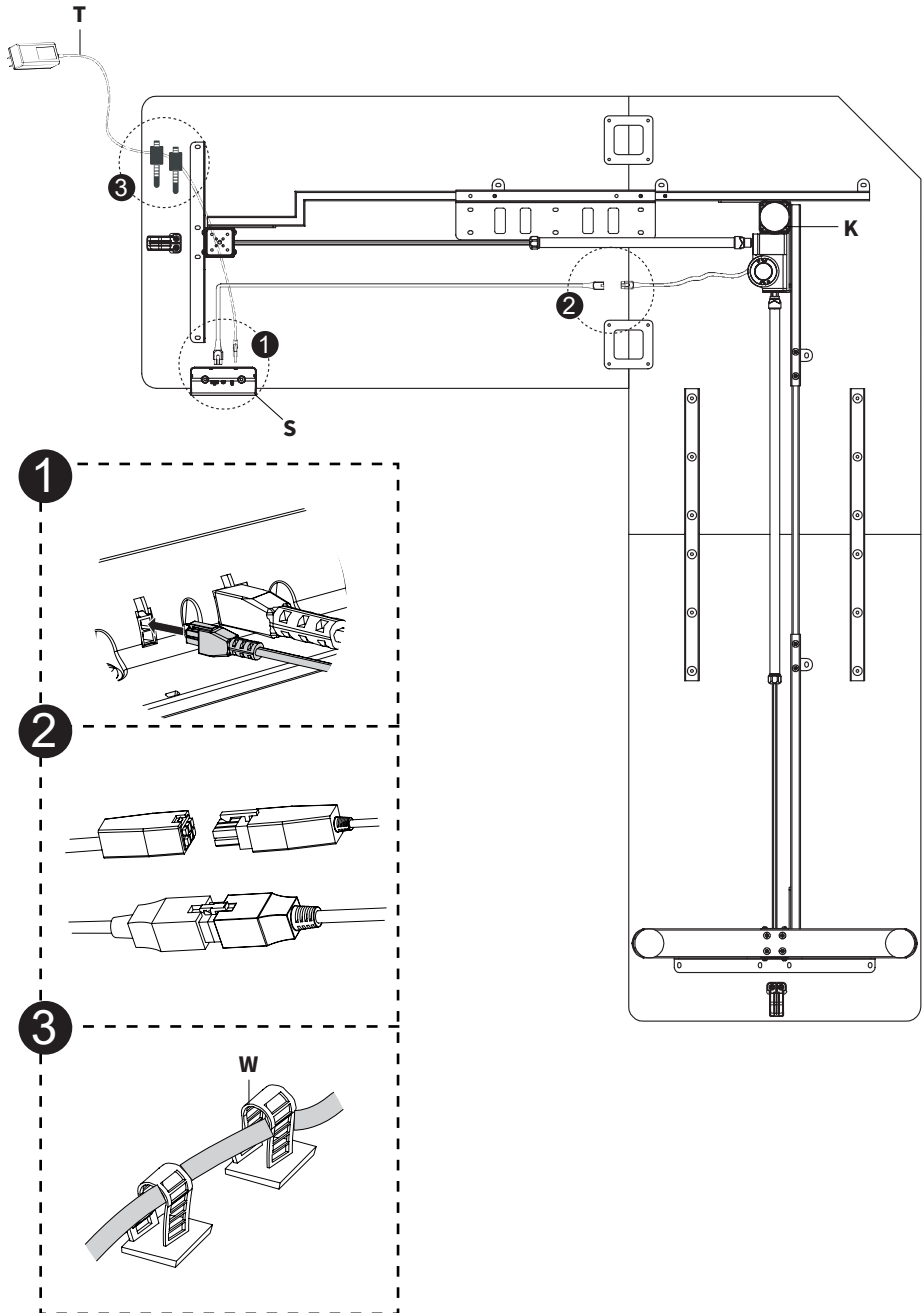

STEP 10: Assemble Shelf Dividers

Assemble Shelf Dividers (**B4**), Short Corner Shelf Panel (**B5**), Long Corner Shelf Panel (**9B6**, and Rear Shelf Panels (**B7**) to the desktop assembly using ST4.2x35mm Screws (**S-D**) and a Phillips screwdriver using all locations shown below.

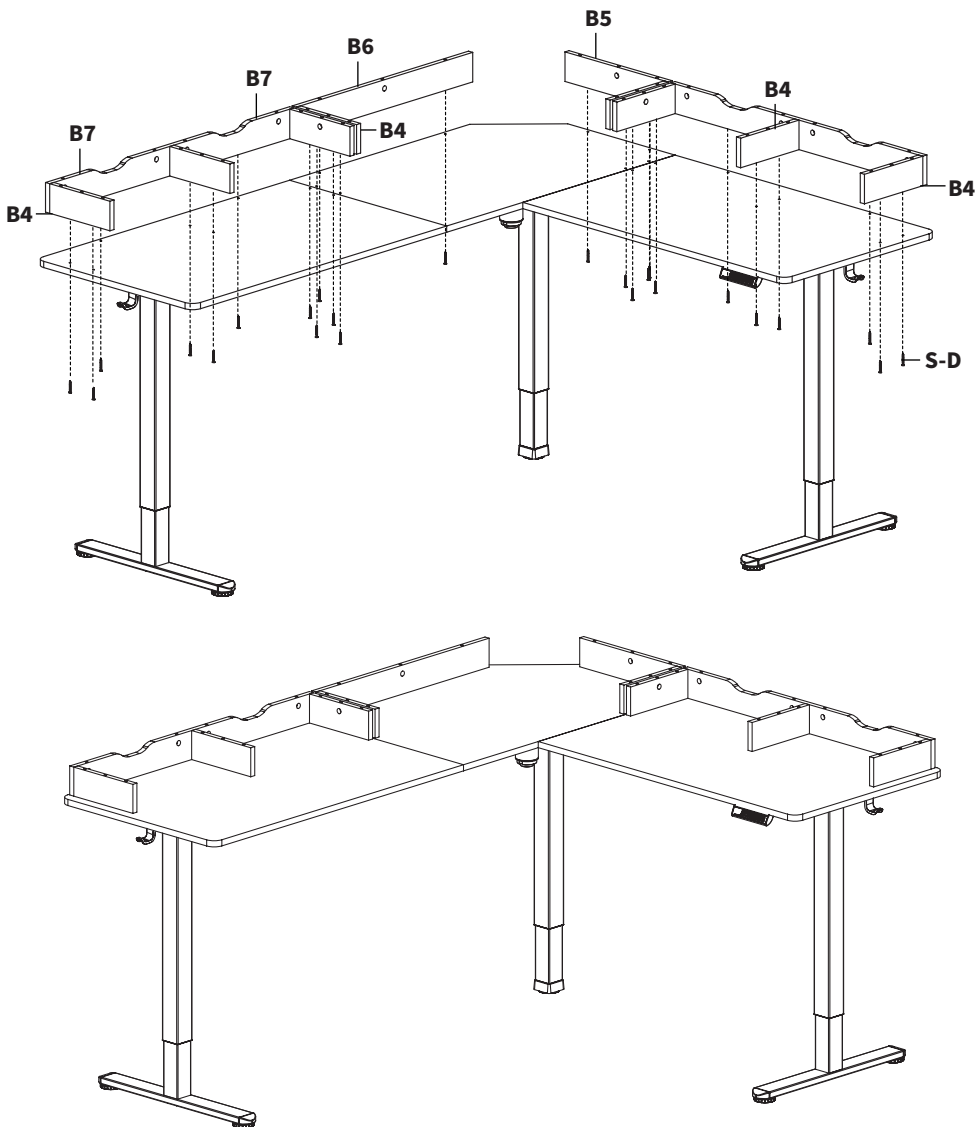

STEP 11: Connect Shelf Assembly

Insert Cam Lock Screws (**S-E**) using a Phillips screwdriver and Wooden Dowels (**S-H**) into Corner Shelf Panel (**B1**), Left Shelf Panel (**B2**), and Right Shelf Panel (**B3**). Place the Shelf Assembly on top of the divider assembly.

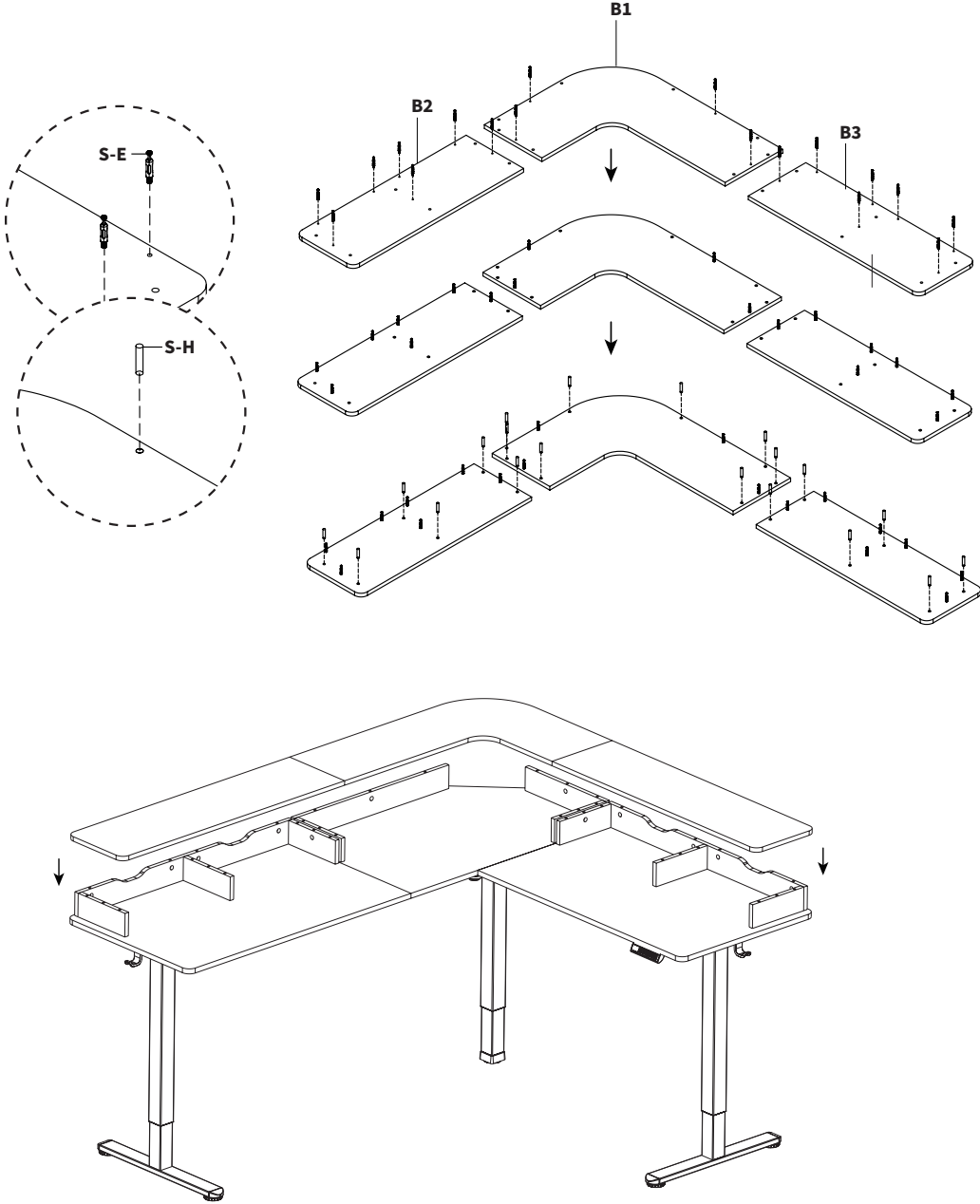

STEP 12: Secure Shelf

Insert Cam Lock Nuts (**S-F**) into Panels, making sure arrows are facing up. Using a Phillips screwdriver, turn Cam Lock Nuts (**S-F**) clockwise to secure the shelf assembly in place.

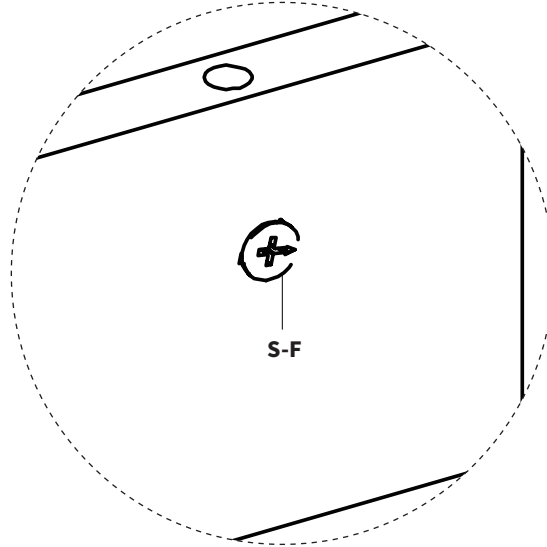
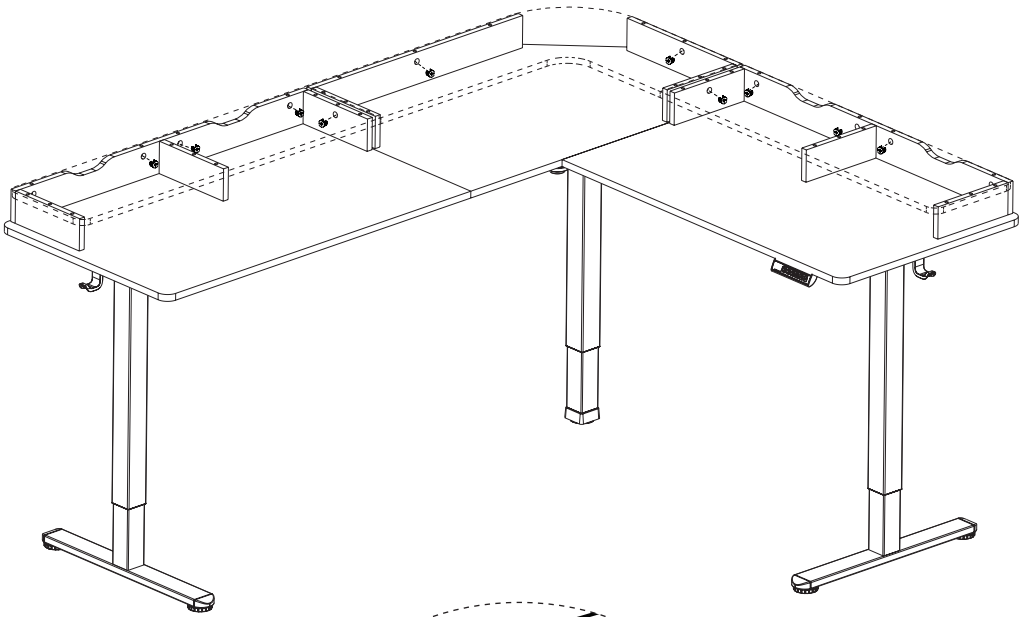

STEP 13: Unfold Drawers

Unfold Drawers (C) and place the drawer inserts inside.

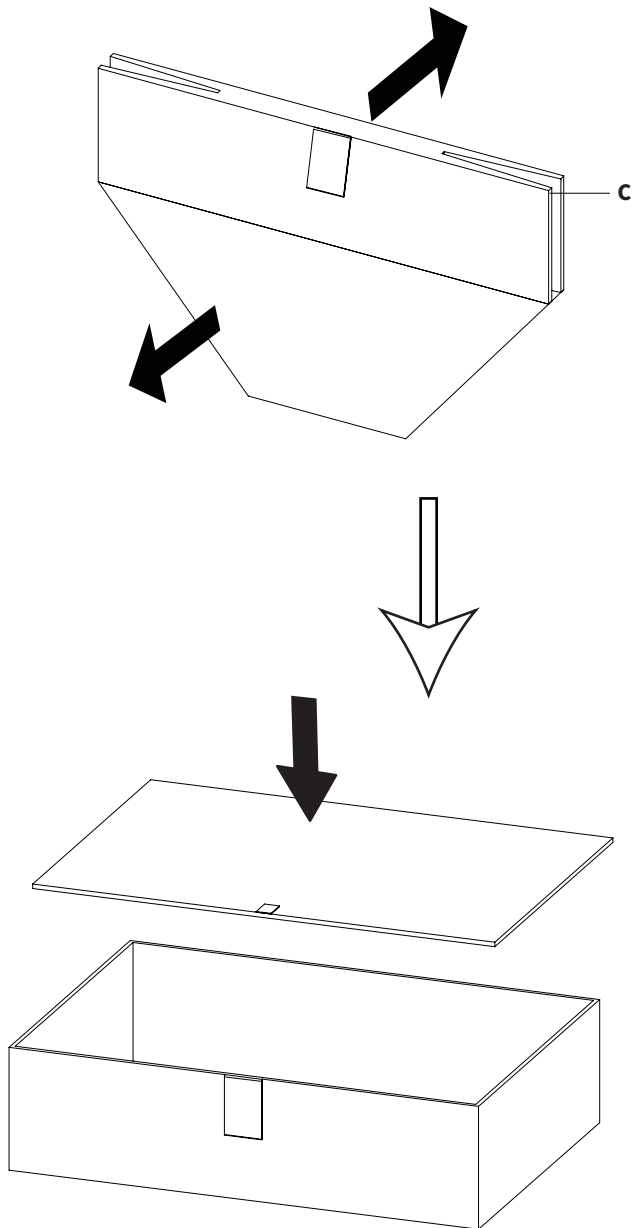

STEP 13.2

Slide drawers into shelf assembly.

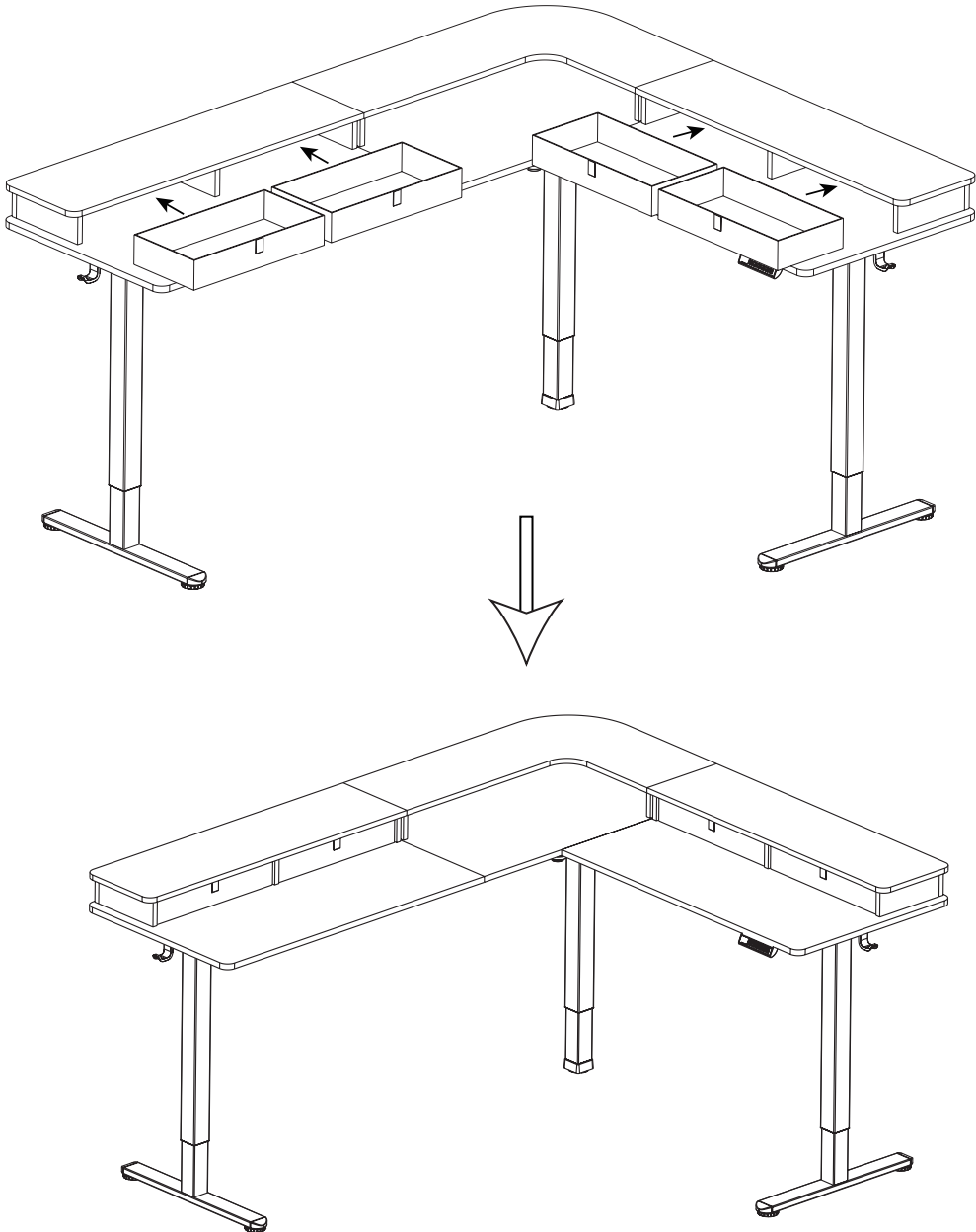

CONTROLLER - USER MANUAL

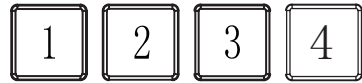
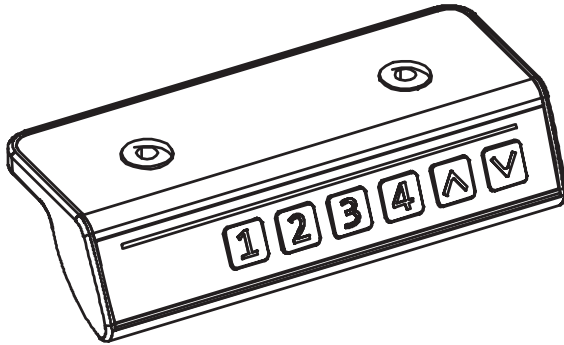

Memory Presets

Press any number and the desk will return to the programmed height. See *Programming Memory Presets* to program presets.

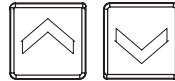

Arrow Keys

Press and hold the UP arrow for the desk to begin raising. Release when desk reaches desired height. Press and hold DOWN arrow to lower desk. Release button when desired height is reached.

Memory Mode

To save a set height, press and hold the "1" button for 5 seconds until "H1" appears. Your height setting is now stored. Follow steps for the other numerical buttons to save up to four height settings.

Reset Mode

If the height of the desk is incorrect, press the down arrow until the desk moves to the fully lowered position. Press and hold the down arrow. "RES" will be displayed and the leg will lower and rebound upwards. Release the down arrow and your frame has been reset.

Troubleshooting

Error Code	Description/Resolution
E10	Sensorless Alarm: This alarm triggered when the sensor cannot be detected. Power off desk and check the connection between the motor and control panel, then re-power.
E20	Overload Alarm: Remove desk items and try again.
E02	Rebound Protection: Check for desk vibration, obstacles, or desk incline. If no issues found, complete the reset process and try again.
E32	Overvoltage Alarm: Voltage is higher than allowed value. Power off desk and check connection between power and control panel. Power on again.
E31	Undervoltage Alarm: Voltage is lower than required value. Power off desk and check connection between power and control panel. Power on again.
HOT	Overheated Alarm: Power off and wait 18 minutes before use again.

CHECK OUT OTHER GREAT PRODUCTS FROM



EXPLORE MORE AT [VIVO-US.COM](https://www.vivo-us.com)

We offer a wide array of home & office products to fit your needs. From height adjustable desks to monitor mounts to keyboard trays and more!

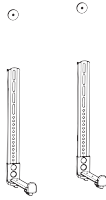

SPEAKER MOUNTS & STANDS

Whether you're mounting a soundbar or surround sound system, we've got a mounting solution to fit your needs

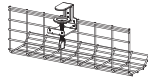

CABLE MANAGEMENT

From single monitor mounts to hex mount, grommet or clamp-ons, we've got a mounting solution for your setup.

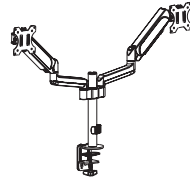

MONITOR MOUNTS

From single monitor mounts to hex mount, grommet or clamp-ons, we've got a mounting solution for your setup.



WHO WE ARE



VIVO is more than a brand of ergonomic office furniture. We are a team of creative and innovative individuals working together to offer high quality, affordable ergonomic solutions. We think and work outside of the box to serve you, our customer, to the best of our ability.



Need Assistance?

We Would Love to Help!



Personable Customer Support | **Mon-Fri 7am-7pm**

We offer immediate assistance with rapid response times from customer service agents and product technicians to help you every step of the way!



Call Us: **309-278-5303**

Average Resolution Time: **5m 4s**



Chat Us: **www.vivo-us.com**

Average Resolution Time: **< 15m**



Email Us: **help@vivo-us.com**

Average Resolution Time: **1HR 8M**

*23% within < 15m
38% within < 30m
61% within < 1hr
83% within < 2hr
92% within < 3hr*

[THIS PAGE INTENTIONALLY LEFT BLANK]

[THIS PAGE INTENTIONALLY LEFT BLANK]



LOVE YOUR NEW VIVO SETUP?

Ready to share that new amazing setup? Want to brag about that amazing new ergonomic solution?

Tag us in your photo!



VIVO-us @vivo_us

FOR MORE GREAT VIVO PRODUCTS,
CHECK OUT OUR WEBSITE AT: WWW.VIVO-US.COM