

Adjustable PC Cart with Storage

SKU: CART-PC03P

Instruction Manual

Assembly Video & Product Info
www.vivo-us.com/products/cart-pc03p



! CAUTION! !

If you do not understand these directions, or if you have any doubts about the safety of the installation, please contact our product support team at 309-278-5303 or help@vivo-us.com for further assistance. Check carefully to make sure there are no missing or defective parts. Improper installation may cause damage or serious injury. Do not use this product for any purpose that is not explicitly specified in this manual. Do not exceed weight capacity. We cannot be liable for damage or injury caused by improper mounting, incorrect assembly or inappropriate use.



WARNING: CHOKING HAZARD

SMALL PARTS - NOT FOR CHILDREN UNDER 3 YEARS. ADULT SUPERVISION IS REQUIRED.



DO NOT EXCEED WEIGHT CAPACITY

FAILURE TO DO SO MAY RESULT IN SERIOUS INJURY.

Package Contents

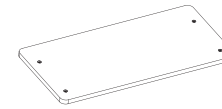

A (x2)
Shelf

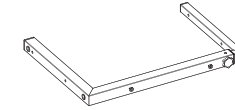

B (x2)
Frame

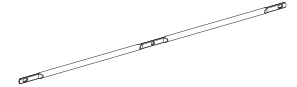

C (x2)
Strut



D (x1)
Shelf Pad

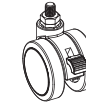

E (x2)
Locking Caster



F (x2)
Caster

We're Here for You

Open **Monday - Friday 7:00am - 7:00pm** CST, our dedicated support team can offer immediate assistance with rapid response times. If any parts are received damaged or defective, please contact us. We are happy to replace parts to ensure you have a fully functioning product.



Give us a Call:
309-278-5303

AVG. RESOLUTION TIME (*within office hrs*): **5M 4S**



Chat Us:
www.vivo-us.com

AVG. RESOLUTION TIME (*within office hrs*): **< 15 M**



Email Us:
help@vivo-us.com

AVG. RESPONSE TIME (*within office hrs*): **1HR 8M**

- 23% within < 15m
- 38% within < 30m
- 61% within < 1hr
- 83% within < 2hr
- 92% within < 3hr

Included Hardware & Tools



S-A (x4)
M6x8mm Screw



S-B (x1)
M6x12mm Screw

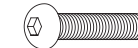

S-C (x4)
M6x30mm Screw

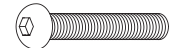

S-D (x4)
M6x40mm Screw



S-E (x1)
M6 Nut



T-A (x1)
4mm Allen Wrench



T-B (x1)
Wrench

Weight Capacity:



TOTAL



MAX Per Shelf

ASSEMBLY STEPS

STEP 1

Take note of the mounting holes on Shelf (A), which are slightly offset. There will be a small and large gap between the holes and the front/back edges of the shelf.

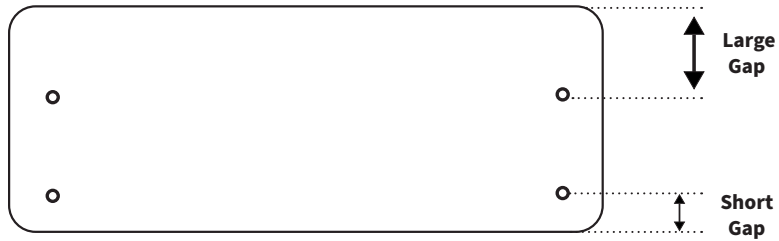

Install Frame (B) pieces onto the underside of one Shelf (A), with the Height Adjustment Knobs (B1) facing down and installed over the Large Gap section of Shelf. Secure using M6x30mm Screws (S-C) and 4mm Allen Wrench (T-A).

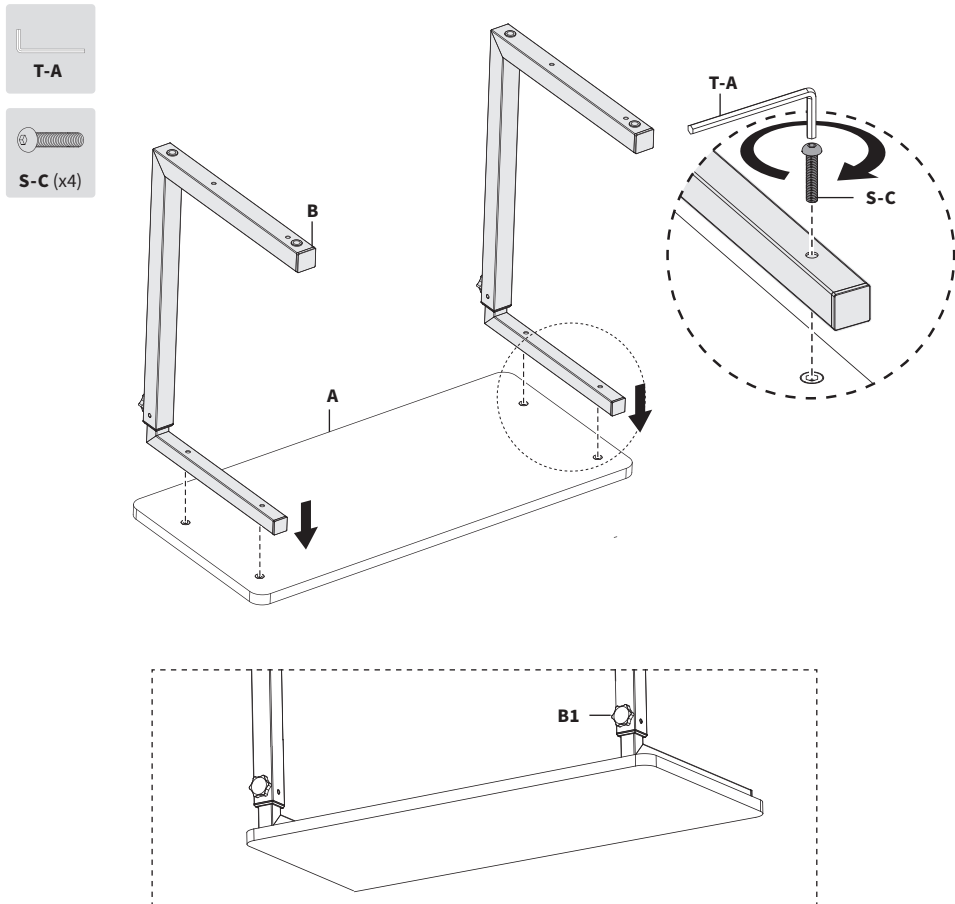

STEP 2

Flip assembly on it's back and secure the second Shelf (A) onto Frames (B) using M6x40mm Screw (S-D) and 4mm Allen Wrench (T-A).

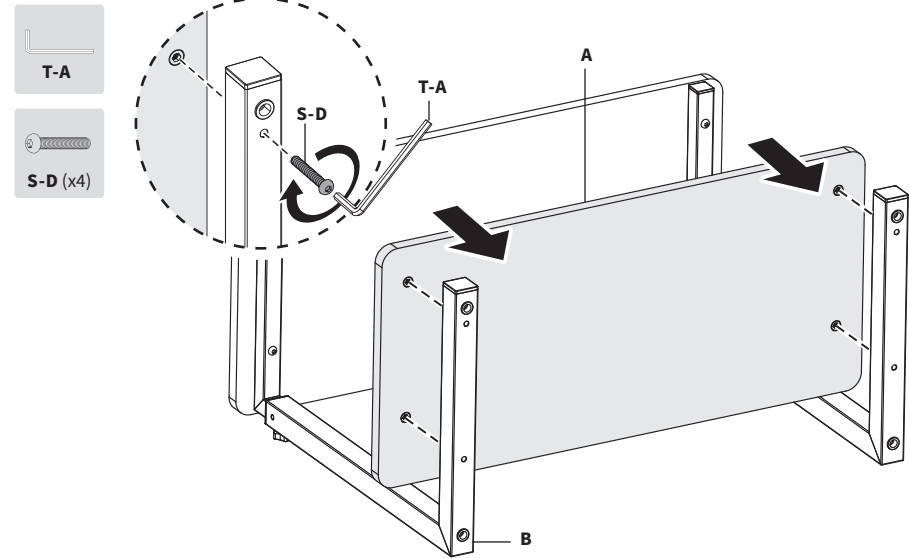

With assembled frame still on it's back, thread Locking Casters (E) into the bottom underside hole of the Frame (B) pieces, in line with the Height Adjustment Knobs (B1). Thread Casters (F) into remaining top holes. Secure all Casters using Wrench (T-B).

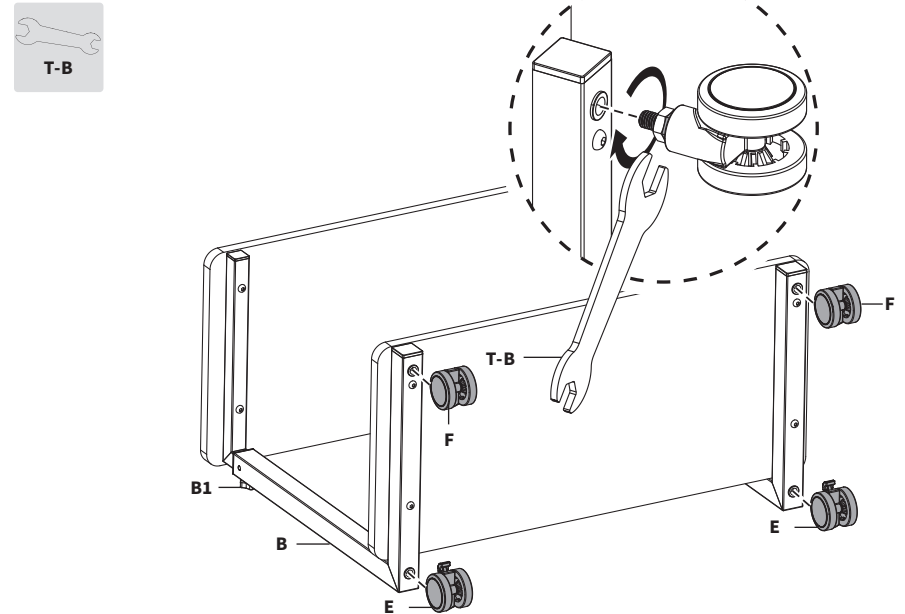

STEP 3

Place Struts (C) onto to the back of assembled Frame (B) as shown below. Secure Struts (C) in the center hole using M6x12mm Screw (S-B) and M6 Nut (S-E). Tighten with 4mm Allen Wrench (T-A) and Wrench (T-B). Then secure the Struts onto Frame pieces using M6x8mm Screws (S-A) and 4mm Allen Wrench (T-A).

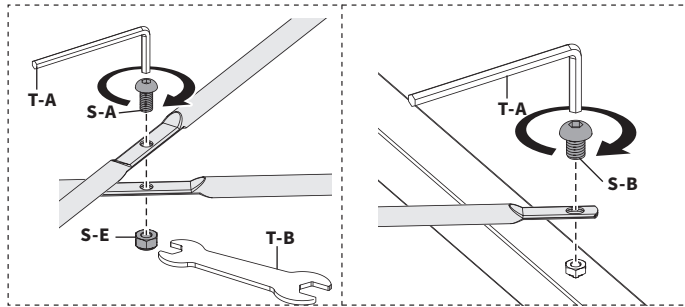
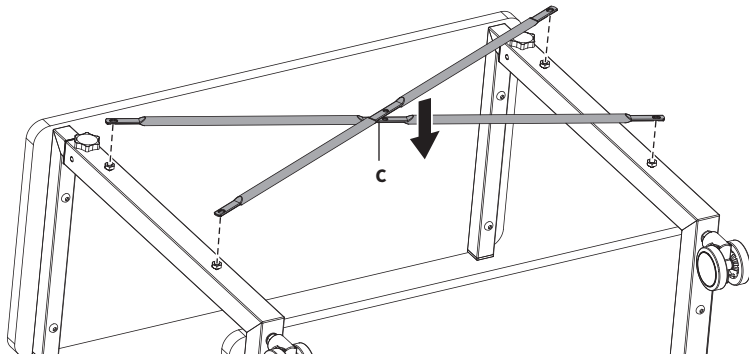

STEP 4

If cart appears unlevel, with some casters not touching the ground, casters will need to be adjusted. Use Wrench (T-B) to loosen the lifted casters. Then, tighten the nut only using Wrench until the nut is in contact with the assembled frame.

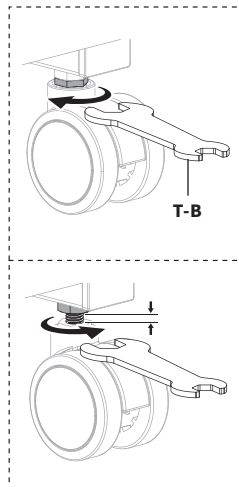
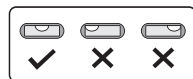
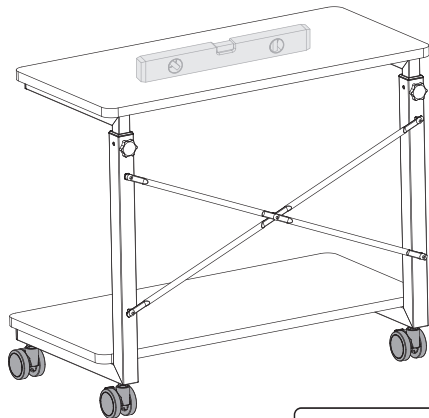

STEP 5

To adjust the height of the upper shelf, loosen and remove the Height Adjustment Knobs (B1) on the back of the assembled frame. Slide the upper frame piece to your desired shelf height. Making sure the frame sections are at the same height and then reinstall the Knobs.

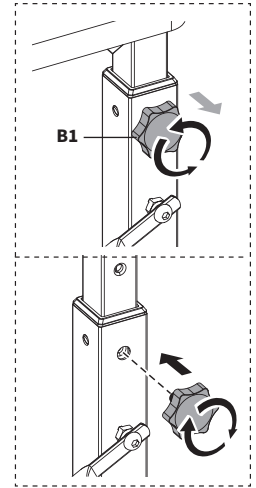
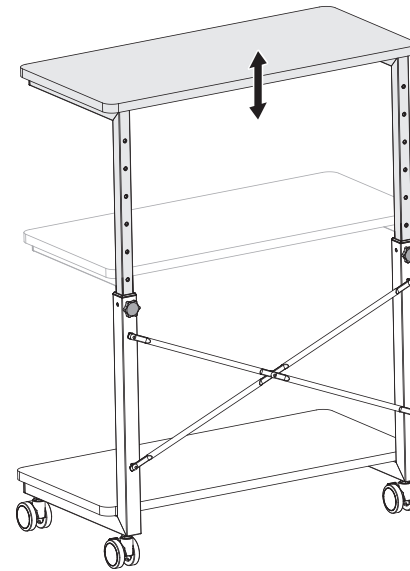

STEP 6

Unroll the Shelf Mat (D) onto the shelf. If the mat appears wrinkled or the edges do not lay flat, place a few weight objects over the Mat surface and let it sit for 24 hours to smooth out.

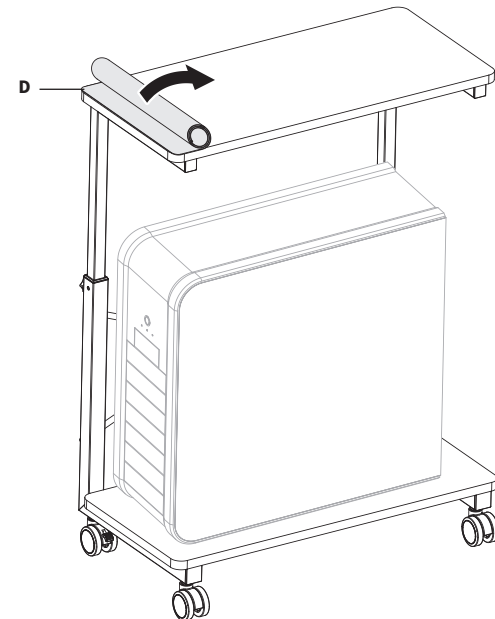



Need Help? Get In Touch

Monday-Friday from 7:00am-7:00pm CST



help@vivo-us.com



www.vivo-us.com

Chat live with an agent!



309-278-5303



VIVO-us



@vivo_us