

## NIGHT SKY STAR STENCIL APPLICATION INSTRUCTIONS

**CONGRATULATIONS!** You are now the owner of the most beautiful re-creation of the night sky money can buy - **Night Sky Star Stencil™**. Night Sky is easy to apply. All you need to do is put up the stencil sections, dab paint into the holes, and take down the stencil. The following instructions will help you do this in the most efficient way.

### BEFORE YOU BEGIN:

- Figure out if anything in the room should be moved out of the way.
- Cover furniture and other objects to protect against unlikely paint drips. The paint is water based - if drips do occur, a quick wipe with a wet rag provides easy clean-up.
- Decide where you want the stencil to be centered —over the bed, half on the wall and half on the ceiling—whatever you prefer.
- If you want the stencil to be aligned with the sky, unroll the stencil sections with the lettered ends at the NORTH end of the room and facing you (not the ceiling).

### TO START:

Pinch off pea-sized pieces of adhesive (about 50 for the 8-foot stencil, 100 for the 12-foot) and place separately on a plate.

**PLEASE NOTE:** Do not use adhesive on soft flocked surfaces, loose wallpaper, newly painted surfaces, or loose paint. The adhesive may pull off a layer of fiber or paint. Push pins can be used as an alternative to adhesive if preferred. If the adhesive is left on for an extended period of time and leaves an oily residue, remove residue with a solvent such as Trichloroethane.

- Place 3 balls of adhesive near the end of the stencil roll - one at either corner and one in the middle (**Illustration 1**).

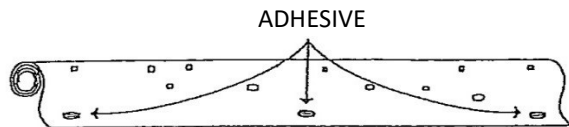
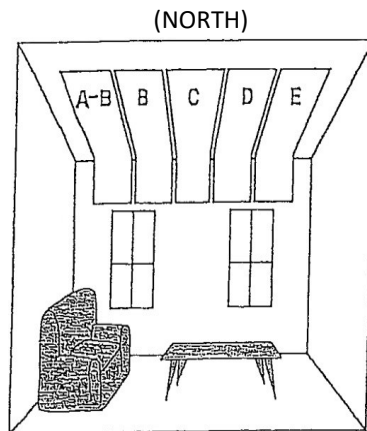

**ILLUSTRATION 1**

- Affix the end of stencil Section A to the ceiling, starting at the edge of the area to be covered by the stencil; the letter A should be on the readable side of the stencil (not the side against the wall), with the ->B pointing to where the next panel should be unrolled.

**Illustration 2** shows the correct alignment of a 12-foot stencil; the 8-foot is more condensed and has only A, B and C panels, but has the same number of stars and is done in the same way. Note that the A -> B shows where the B panel goes in relation to the A panel. Note, too, the straight ends and edges.

This illustration also shows how the stencil can be placed with part on the ceiling and part on the wall.



**ILLUSTRATION 2**

- Press on the paper and squash the adhesive between the paper and the surface.
- Unroll the rest of the A stencil sheet and affix it to the ceiling by putting balls of adhesive near the edge of the stencil as you unroll it, at intervals of about two feet. Pull the paper taut between adhesive balls to keep it flat; some sag is normal.
- Unroll the stencil to the end of section A and put three balls of adhesive at the end to hold it firmly.

- If you have a light fixture to go around, unroll the stencil as described until you get to the fixture. Cut the stencil from the edge to the fixture with scissors, avoiding the holes. Put extra pieces of adhesive on the loose flaps of the stencil to hold it flat.
- Follow the same procedure to attach the remaining sections of the stencil.
- Make sure the leading (lettered) edge of each stencil is even with the leading edge of the other sections and keep the long edges of each section straight and snug with the adjacent one.

### TO START PAINTING:

With your stencil on the surface, you're ready to begin painting. Use the paint liberally, but carefully. Push the stencil against the ceiling with your free hand and dab paint INTO the entire hole in the stencil; the thicker the dabs, the better. Smaller stars should take one dab, larger stars take two or more.

Release the stencil and allow it to sag away from the ceiling as you get more paint on your brush. When you think you're done, check to make sure you haven't missed any stars. (**NOTE: If you are going to paint the Milky Way, look at that section of the instructions before you pull down the stencil.**)

Pull the paper down. If the adhesive sticks to the ceiling, take a large piece of adhesive and dab the stuck pieces until they come off.

### TO MAKE THE SKY GLOW:

Turn on the lights and lamps in the room and leave them on for a few minutes. Then, turn them all off and view the stars for 2-3 minutes while your eyes adjust to the dark. The secret to good stargazing – outdoors OR with **Night Sky™** is to allow time for your eyes to adjust to darkness. Once you've been in the dark a few minutes, close your eyes, cover them with your hand, and turn the lights on again – but only for 10 seconds. Then turn the lights off and open your eyes – if the room is dark, the stars will be brilliant!

### PAINTING THE MILKY WAY:

For an extra spectacular version of **Night Sky™**, you will want to paint the Milky Way. The easiest way to do this is to draw the edges of the Milky Way on the stencil after you've painted the stars. Next, cut the lines with scissors or a mat knife. Remove the paper from where the Milky Way should be and add additional balls of adhesive to the remaining stencil to hold the newly cut loose ends.

Because the Milky Way is a galaxy made up of billions of stars too far away to be distinguished, you cannot stencil it. Therefore, to recreate it, you should first dilute some paint (2 parts water and 1 part paint). Dip the bristles of a toothbrush in the diluted paint, and, holding the brush 2-4 inches from the surface, rub your thumb or index finger across the bristles to flick hundreds of tiny droplets into place (**Illustration 3**).

**CAUTION:** You should flick the paint away from you and not directly overhead since droplets could fall into your eyes. This method can shower your floor with paint droplets, so it's best to hold a large piece of cardboard (12"x12") under the spray as you flick the brush.

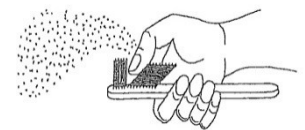

**ILLUSTRATION 3**

The **WinterSky™ Milky Way** is a band of stars stretching loosely from halfway between the lettered and unlettered ends of the stencil section A, to one-third of the way from the lettered end of Section C (8-foot stencil) or Section E (12-foot stencil). The width of the Milky Way varies between 7-14 inches on the 8-foot, and 10-20 inches on the 12-foot stencil, with the wider portions at the edges of the stencil.

The **SummerSky™ Milky Way** is a band of stars stretching loosely from the lettered end of Section B, through section A along the line joining sections A and B, to the unlettered end of Section A on the 8-foot stencil; on the 12-foot stencil, it stretches from the lettered ends of Sections B and C, through Section B to the unlettered end of Section B. The width varies between 5-14 inches on the 8-foot stencil and 8-20 inches on the 12-foot, with the wider portions at the ends.