

# sideclick™

Streamline your Streaming Experience

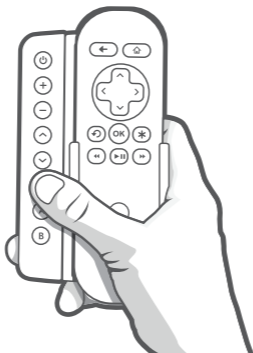

## Universal Remote Attachment for

### Roku® streaming devices:

Express | Express+ | Premiere | Premiere+ | Ultra

Roku1 | Roku 2 | Roku 3 | Roku 4 | Roku SE | Roku® Streaming Stick®

#### What's Included

- Sideclick Universal Learning Remote
- 2 AAA Batteries
- 4 Adapter Clips

#### Simple Setup

- 1 - Insert the included 2 AAA Batteries into your Sideclick Remote.
- 2 - Select and attach the Adapter Clip that corresponds to your Roku® remote. (directions on reverse)
- 3 - Snap your Roku® remote into Adapter Clip.
- 4 - Program Sideclick and you're ready to go.

#### Tips

Please visit our website, [www.sideclickremotes.com](http://www.sideclickremotes.com) for additional information including:

- Assembly videos
- Programming videos
- Troubleshooting
- Information on selecting the right Adapter Clip for your streaming remote
- Additional Sideclick products and accessories
- Registering your device

Sideclick products, True Bloom LLC, and any of Sideclick's or True Bloom LLC's investors, are not affiliated with Roku, Inc. or the Roku streaming products as a whole.

## Select Your Clip



### Clip RB

Express  
Express+  
Premiere

### Clip RC

Premiere+  
Ultra

For all other models, use the table below

Remote Shape	Remote Finish	Clip ID
Round Top	Gloss	RA
Round Top	Matte	RD
Flat Top	Gloss	RC
Flat Top	Matte	RB

ROUND  
TOP

FLAT  
TOP

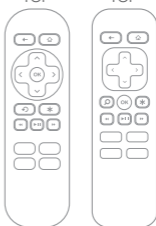

## Attach Your Clip

- 1 - Line up tabs on Sideclick remote with keyholes in clip.
- 2 - Press clip against Sideclick remote and slide clip up until it locks in place.

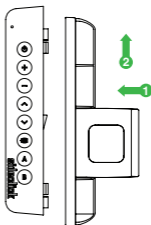

## Install Your Remote

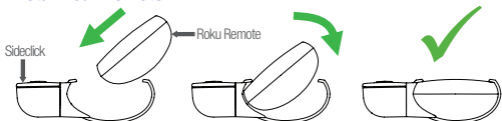

## Program Your Sideclick

- 1 - On Sideclick, hold down the **(P)** + **(B)** buttons simultaneously until the LED lights solid.
- 2 - Position your Sideclick remote and the device remote you are learning from on a table, head to head, approximately 1 inch apart.
- 3 - Press and release the Sideclick button you wish to program. The LED will start blinking.
- 4 - Press and release the button you want it to learn from on your device remote.
  - The LED will blink 3 times indicating a successful learn, then will return to solid indicating you are ready to program other buttons.
  - If the LED does not return to solid, a problem in programming has occurred. Exit programming mode via step 6 and try again.
- 5 - While LED is on solid, repeat steps 3 & 4 for each button you would like to program.
- 6 - To exit programming mode, press the **(P)** + **(B)** simultaneously and the LED will turn off. You can also wait approximately 10 seconds and it will exit programming mode automatically.
- 7 - Your Sideclick is now ready to use.

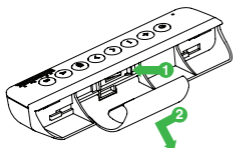

## Removing Your Clip

- 1 - Gently pull out on locking tab with index finger.
- 2 - While pulling out on the locking tab, slide clip down and then away from remote.