

sideclick™

Streamline your Streaming Experience

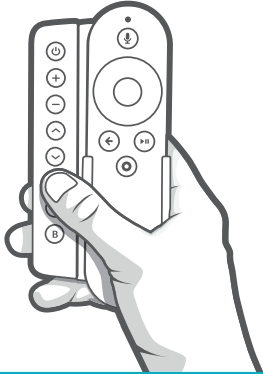

Universal Remote Attachment for

Google Nexus™ Player

What's Included

- Sideclick Universal Learning Remote
- 2 AAA Batteries
- 1 Adapter Clip

Simple Setup

- 1- Insert the included 2 AAA Batteries into Sideclick Remote.
- 2- Attach the Adapter Clip to the Sideclick Remote. (directions on reverse)
- 3- Snap your Nexus™ Player remote into Adapter Clip.
- 4- Program Sideclick and you're ready to go.

Tips

Please visit our website, www.sideclickremotes.com for additional information including:

- Assembly videos
- Programming videos
- Troubleshooting
- Information on selecting the right Adapter Clip for your streaming remote
- Additional Sideclick products and accessories
- Registering your device

All Rights Reserved. Sideclick Remotes operates under True Bloom LLC and is not affiliated with Google Inc.

Getting Started

Attach Your Clip

- 1- Line up tabs on Sideclick remote with keyholes in clip.
- 2- Press clip against Sideclick remote and slide clip up until it locks in place.

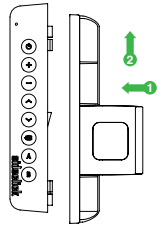

Install Your Remote

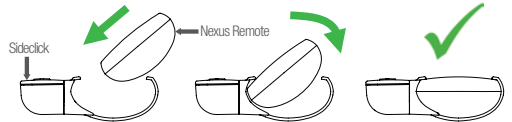

Program Your Sideclick

- 1- On Sideclick, hold down the **(P)** + **(B)** buttons simultaneously until the LED lights solid.
- 2- Position your Sideclick remote and the device remote you are learning from on a table, head to head, approximately 1 inch apart.
- 3- Press and release the Sideclick button you wish to program. The LED will start blinking.
- 4- Press and release the button you want it to learn from on your device remote.
-The LED will blink 3 times indicating a successful learn, then will return to solid indicating you are ready to program other buttons.
-If the LED does not return to solid, a problem in programming has occurred. Exit programming mode via step 6 and try again.
- 5- While LED is on solid, repeat steps 3 & 4 for each button you would like to program.
- 6- To exit programming mode, press the **(P)** + **(B)** simultaneously and the LED will turn off. You can also wait approximately 10 seconds and it will exit programming mode automatically.
- 7- Your Sideclick is now ready to use.

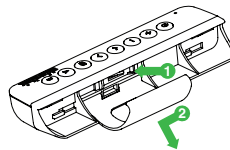

Removing Your Clip

- 1- Gently pull out on locking tab with index finger.
- 2- While pulling out on the locking tab, slide clip down and then away from remote.