



FEATURES

- 30 amp auto-reset circuit breaker
- Heavy duty momentary on/off switch
- Variable speed knob with built in on/off function
- LED power indicator light
- Reversible powder-coated mounting plate for left or right orientation
- Sealed Housing

SPECIFICATIONS

Part Number	DMC12V
Voltage	12 VDC
Max Amps	30 A
Working Temperature	-4°F - 104°F

For use with Motorized Hose Reel Kits: A5015012, A5030012, A5045012.
 For use with Motor Kit: 2100475

PARTS LIST

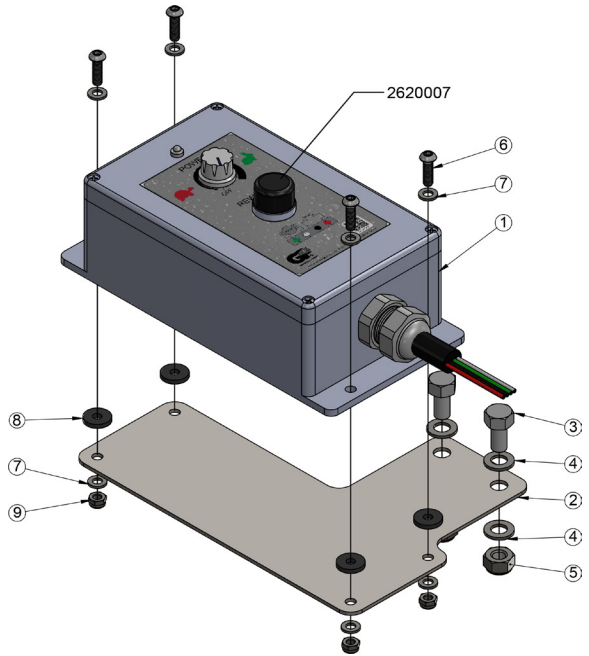

Pos.	Part No.	Description	QTY
1	2103132	Variable Motor Controller, Power Rewind, 12VDC	1
2	2530174	Mount Plate, Motor Controller to Hose Reel	1
3	2200104	Bolt, M10	2
4	2203413	Washer, Flat, M10	4
5	2203017	Nut, M10, Nylok, SST	2
6	2200157	Screw, M6x20, HHBS	4
7	2200018	Washer, M6	8
8	2702102	Washer, M6 Rubber	4
9	2200026	Nut, Nylok	4
	2620007	Switch, Replacement	

ASSEMBLY

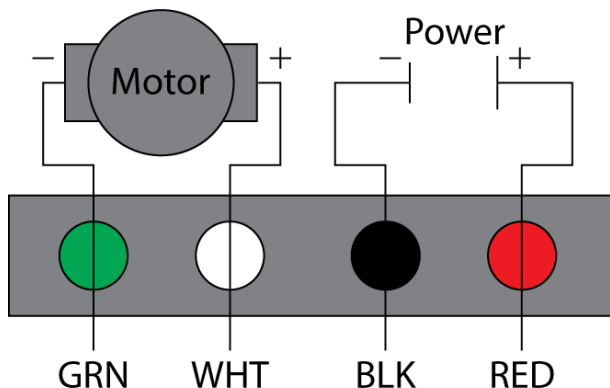

Shown mounted on DHRA50150

GAUGE	COLOR	OUTPUT CONNECTION	OUTPUT CONNECTOR
10	White	Motor Positive	Female Spade
10	Green	Motor Negative	Male Spade
10	Red	Battery Positive	Female Spade
10	Black	Battery Negative	Female Spade

TROUBLE SHOOTING

PROBLEM	CAUSE	REMEDY
MOTOR FAILS TO START	Be sure the speed control is rotated clock-wise and the LED is on	The momentary switch will not function unless this turned on
	Motor is wired incorrectly	Refer to the wiring diagram to verify the motor is wired correctly.
	Hose reel is locked in place	Release lock and verify the hose reel can freely turn
	Power supply issues	Measure voltage coming from battery, if there is no voltage then it needs to be charged or replaced.
	Faulty momentary switch (2620007)	Replace Switch

PROBLEM	CAUSE	REMEDY
MOTOR HAS BEEN RUNNING, THEN FAILS TO START	Motor or hose reel jammed	Inspect to see if the hose reel can rotate freely
	Motor has too high of load	Check to see if you can still wind the hose reel by hand, inspect hose reel and motor bearings.
	Worn motor brushes	Replace motor.
	Ambient temperature too high	Verify that the ambient temperature does not exceed the controller's temperature rating.
MOTOR RUNS BUT DIES DOWN	Voltage drop	If the voltage is less than 90% of the motor's rating then charge / replace battery.
	Load increased.	Verify the load has not changed and the hose reel has not become tighter.
MOTOR TAKES TOO LONG TO ACCELERATE	Hose reel brake	Verify it's not left on or too tight.
	Defective controller	Replace controller
	Bad bearings	See "Motor Vibrates".
	Voltage too low	Verify the voltage is within 10% of the motor's rating, charge / replace battery.
MOTOR RUNS IN THE WRONG DIRECTION	Incorrect wiring	Switch the Motor Positive and Motor Negative wires
MOTOR VIBRATES	Motor misaligned to gear	Realign the gear.
	Shaft is out of balance	Remove the motor from gear and inspect the motor by itself, verify that the motor shaft is not bent.
	Defective motor bearings	Test the motor by itself, if the bearings are bad, replace motor.
	Defective hose reel bearings	Test the hose reel by itself, if bearings are bad replace them.
	High voltage	Check the power supply to make sure voltage is accurate.

SAFETY / WARNING

- To be installed by a trained professional
- Refer servicing to a trained professional
- Disconnect all power and discharge all capacitors before performing service or maintenance.
- Always keep hands and clothing away from moving parts

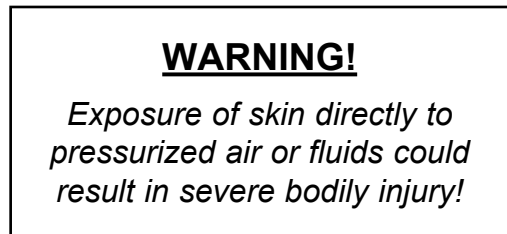

WARNING: High Pressure Systems require a primary pressure regulating device (i.e. regulator, unloader) and a secondary pressure relief device (i.e. pop-off valve, relief valve). Failure to install such relief devices properly could result in personal injury or damage to pump or property. GP does not assume any liability or responsibility for the operation of the user's high pressure system.

