

Q66 SERIES

MECHANICAL KEYBOARDS

We recommend that you read this manual thoroughly before using the product.

Start Reading →

LED Indicator Status Description

The indicator is located between **G** and **H**

Low Battery Level	Bluetooth Device #1 Re-Connecting / Pairing On	Bluetooth Device #2 Re-Connecting / Pairing On	Bluetooth Device #3 Re-Connecting / Pairing On	2.4GHz Device Re-Connecting / Pairing On	CapsLock On / Special Keys Combination Enabled

Hold **FN** first, then the corresponding keys to enable special keys combination.

Short Press: Hold FN first, then the corresponding key, and release both keys.

Long Press: Hold FN first, then the corresponding key. Hold for 5 seconds until the indicator starts blinking.

Three Ways of Connecting Devices

Bluetooth Mode

❶ Toggle the keyboard Mode Switch to the wireless side.

❷ Short Press **FN** + **Q** to make the indicator blink in blue, then Long Press **FN** + **Q** to make the indicator flash in blue.

❸ Select the pairing device [IQUNIX Q66 BT]. The indicator turns off when the keyboard is paired successfully.



In order to complete the pairing of the keyboard with a second or third new Bluetooth device, repeat the instructions from Step ❷ and replace the "FN+Q" with "FN+W" or "FN+E".

2.4GHz Mode

❶ Toggle the keyboard Mode Switch to the wireless side.

❷ Plug the 2.4GHz receiver into your computer.

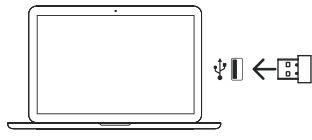

❸ Press **FN** + **R** to enter 2.4GHz connecting mode. The indicator turns off when the keyboard is connected successfully.

Wired Mode

❶ For Wireless Version, toggle the keyboard Mode Switch to the wired side.

❷ Plug the USB cable into your device.

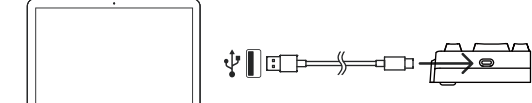

*When being plugged into the computer, the keyboard will start to charge automatically.
 *Caution: The rated power for the charger must not exceed 5V=1A.
 Connection to a higher power output will damage the keyboard.

Special Keys Combinations

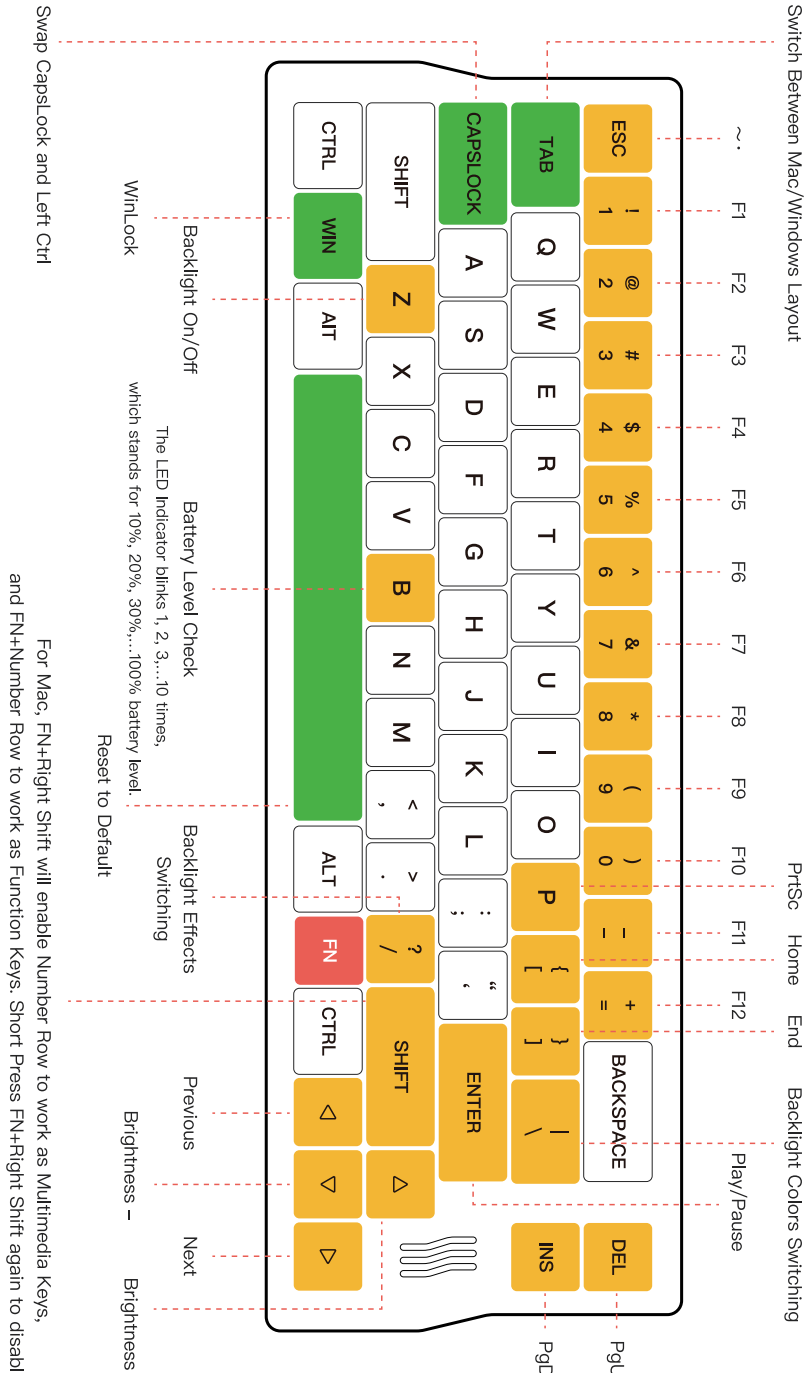
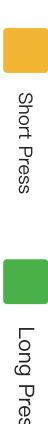

FCC Warning

This device complies with part 15 of the FCC Rules.
 Operation is subject to the following two conditions: (1) This device may not cause harmful interference, and (2) this device must accept any interference received, including interference that may cause undesired operation.
 Any changes or modifications not expressly approved by the party responsible for compliance could void the user's authority to operate the equipment.
 This equipment has been tested and found to comply with the limits for a Class B digital device, pursuant to part 15 of the FCC Rules. These limits are designed to provide reasonable protection against harmful interference in a residential installation. This equipment generates uses and can radiate radio frequency energy and, if not installed and used in accordance with the instructions, may cause harmful interference to radio communications. However, there is no guarantee that interference will not occur in a particular installation. If this equipment does cause harmful interference to radio or television reception, which can be determined by turning the equipment off and on, the user is encouraged to try to correct the interference by one or more of the following measures:
 – Reorient or relocate the receiving antenna.
 – Increase the separation between the equipment and receiver.
 – Connect the equipment to an outlet on a circuit different from that to which the receiver is connected.
 – Consult the dealer or an experienced radio/TV technician for help.

The device has been evaluated to meet general RF exposure requirements. The device can be used in portable exposure conditions without restriction.



Waste Electrical and Electronic Equipment Information

Correct Disposal of This Product (Waste Electrical & Electronic Equipment)
 (Applicable in countries with separate collection systems) This marking on the product, accessories or literature indicates that the product and its electronic accessories should not be disposed of with other household waste at the end of their working life. To prevent possible harm to the environment or human health from uncontrolled waste disposal, please separate these items from other types of waste and recycle them responsibly to promote the sustainable reuse of material resources.
 Household users should contact either the retailer where they purchased this product, or their local government office, for details of where and how they can take these items for environmentally safe recycling. Business users should contact their supplier and check the terms and conditions of the purchase contract. This product and its electronic accessories should not be mixed with other commercial wastes for disposal.

Follow us: IQUNIX



To learn more details, please reach out to us on official website or social media.
 Official website: www.IQUNIX.store