



THANK YOU for choosing **Boulder Tools!** We pride ourselves on making quality products and offering world-class customer service and we're excited to show you why we are considered among the best in off-road tools & accessories.

Many hours were invested into the research and design of your tire deflator to ensure it meets our top standards and reputation of High-quality, Heavy-duty tools. If this deflator does not meet your expectations in any way PLEASE CONTACT US DIRECTLY at **Support@BoulderTools.com**. We strive for perfection, but mistakes happen, so be sure to double check your order and let us know if something doesn't seem right.

WILL YOU TAKE 30 SECONDS & LEAVE A PRODUCT REVIEW?



The many fraudulent sellers and products on Amazon today make product reviews more important than ever. As a company dedicated to quality products and excellent customer support, we need your help.

Will you take 30 seconds and leave a product review on amazon? You can quickly leave a review using the button found on your order detail page on amazon.com THANK YOU!

REGISTER & BECOME A VIP

Register your product purchase at **www.BoulderTools.com/warranty** to receive your no-hassles warranty. You will also become a **VIP Member** of the Boulder Tools family. **VIP Members receive HUGE discount codes to use on Amazon anytime we launch a new product.** It's well worth the 1 minute you will spend registering your deflator purchase.

PRO TIP!: IF AIR IS RELEASING SLOWLY

THE VALVE CORE PROBABLY WAS NOT FULLY REMOVED FROM THE VALVE STEM. USE THE VALVE CORE REMOVAL ROD TO RE-ENGAGE THE VALVE CORE AND GIVE IT A FEW MORE TURNS COUNTER CLOCKWISE TO UNSCREW IT AND FULLY REMOVE IT FROM THE VALVE STEM.

IF YOU ARE STILL EXPERIENCING SLOWER THAN EXPECTED DEFLATION AFTER FULLY REMOVING THE VALVE CORE PLEASE CONTACT US AT SUPPORT@BOULDERTOOLS.COM.

SEE REVERSE SIDE FOR STEP BY STEP INSTRUCTIONS

HOW TO USE THE RAPID DEFLATOR

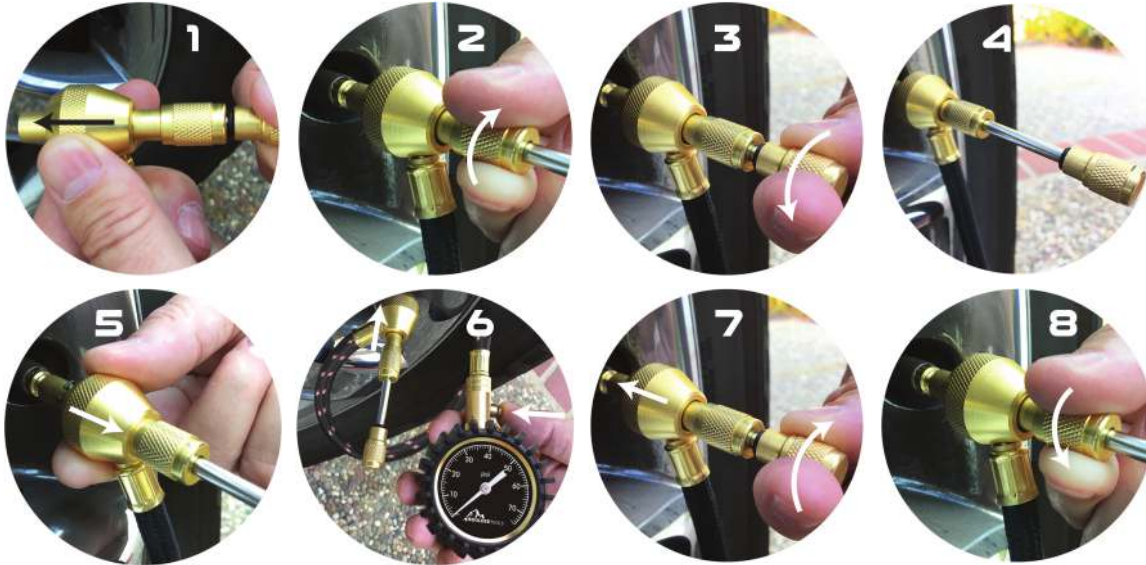
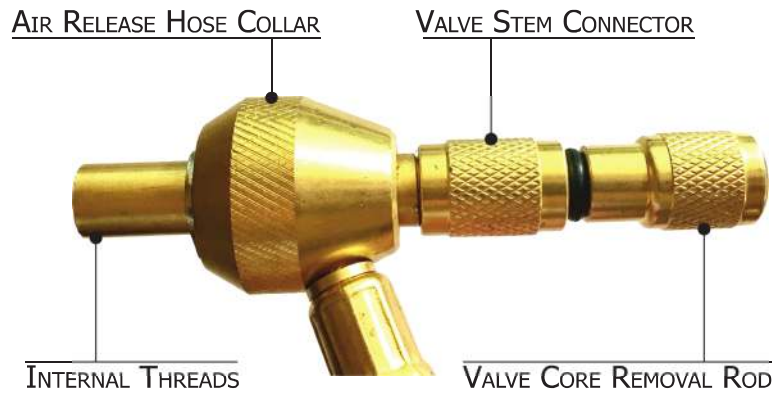

1. SLIDE THE AIR RELEASE HOSE COLLAR ALL THE WAY FORWARD TOWARD THE TIRE

2. REMOVE THE TIRE VALVE CAP. ATTACH THE DEFLATOR TO THE TIRE VALVE STEM BY TURNING THE VALVE STEM CONNECTOR IN A CLOCKWISE DIRECTION.

3. PUSH THE VALVE CORE REMOVAL ROD FORWARD UNTIL YOU FEEL IT MAKE CONTACT WITH THE TIRE VALVE CORE. LIGHTLY PUSH THE REMOVAL ROD INTO THE CORE WHILE SLOWLY ROTATING THE ROD COUNTERCLOCKWISE UNTIL YOU FEEL IT ENGAGE. ONCE ENGAGED, ROTATE COUNTERCLOCKWISE TO UNSCREW THE VALVE CORE FROM THE TIRE VALVE STEM.

4. WHEN YOU FEEL THE AIR PRESSURE PUSHING THE VALVE CORE REMOVAL ROD OUT AWAY FROM THE TIRE GIVE IT A FEW MORE TURNS TO ENSURE VALVE CORE IS FULLY REMOVED AND THEN LET THE PRESSURE PUSH THE ROD ALL THE WAY OUT.

5. SLIDE THE AIR RELEASE HOSE COLLAR AWAY FROM THE TIRE TO START DEFLATION.

If air is releasing slowly see PRO TIP on the reverse side.

6. CHECK YOUR TIRE PSI DURING DEFLATION BY SLIDING THE AIR RELEASE HOSE COLLAR ALL THE WAY IN TOWARDS THE TIRE UNTIL DEFLATION STOPS. SLIDE BACK OUT TO CONTINUE AIR RELEASE.

7. WHEN THE DESIRED PRESSURE IS REACHED PUSH THE AIR RELEASE HOSE COLLAR IN TOWARDS THE VALVE CORE TO STOP THE RELEASE OF AIR. REPLACE VALVE CORE BY PUSHING IN THE VALVE CORE REMOVAL ROD WHILE TURNING CLOCKWISE UNTIL TIGHT. **DO NOT OVERTIGHTEN.**

8. REMOVE THE DEFLATOR FROM THE TIRE VALVE STEM BY TURNING THE VALVE STEM CONNECTOR COUNTERCLOCK-WISE AND REPLACE THE TIRE VALVE CAP.