

InVue

CT200

Swivel Stand

CTK1P002

Fixed Stand

CTK1P003

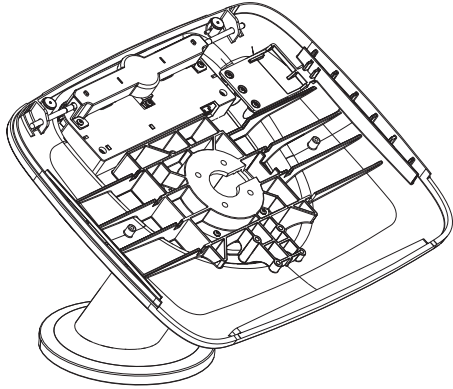

- 1** Feed tablet and/or peripheral power supply through stand. If using optional InVue 5V USB power supply (PS512), feed that cable through.

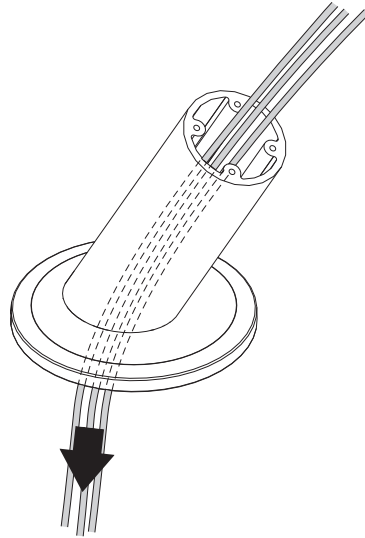

Bolt Mount:

- 2A** Use the Drill Template on the separate sheet. Drill two 8mm (.315") holes through the counter using the smaller guide holes. If routing power cable through fixture, drill a 19mm (.75") hole in the center.

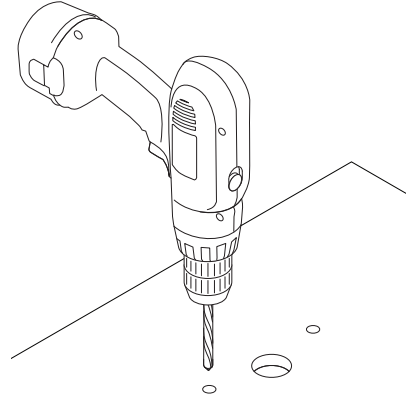

- 3A** Thread mounting bolts into bottom of stand.

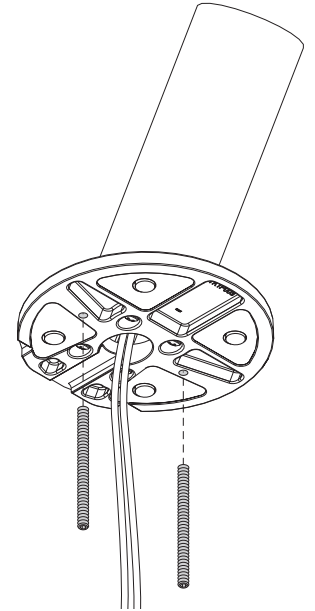

- 4A** Route power cables either through the 19mm hole in the display surface, or out of the back of the stand.

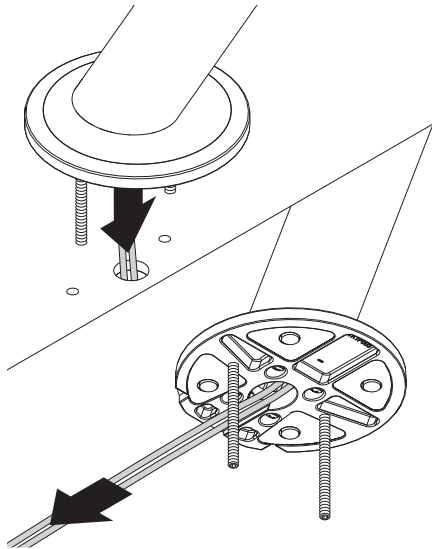

Note: If routing out of back, position cable into channel.

- 5A** Align mounting bolts into drilled holes and set stand onto display surface. From below, slide plastic security washers and tighten wingnuts onto mounting bolts.

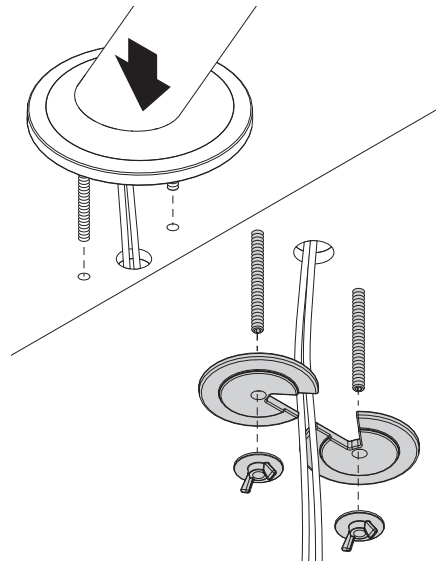

Adhesive Mount:

- 2B** Wipe display counter and bottom surface of stand with alcohol wipes provided. **Let dry completely.**

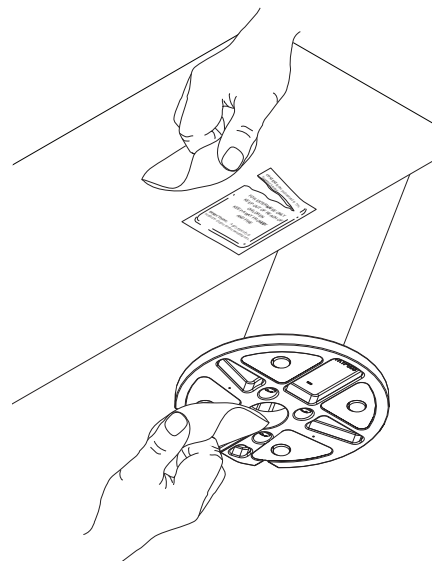

- 3B** Remove rubber feet from bottom of stand. Apply adhesive pads (ADH2101) to bottom surface of stand.

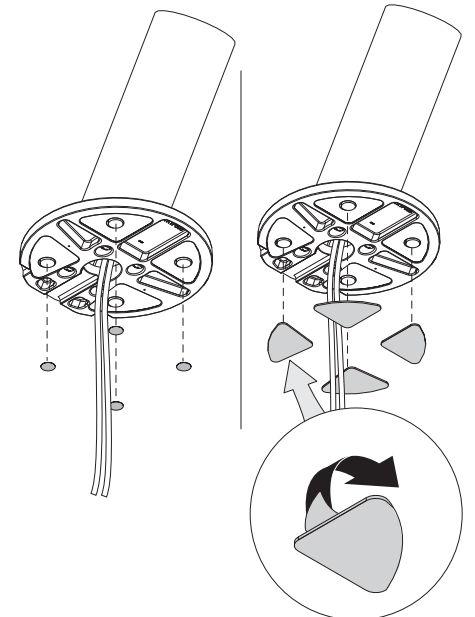

- 4B** Route cables out of back of stand, ensuring that cable falls into channel as shown.

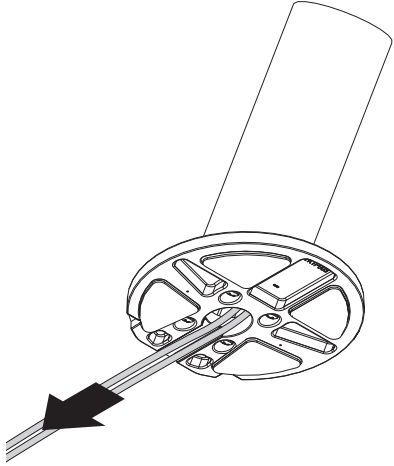

- 5B** Remove clear film from adhesives and place stand in desired position on display surface, pressing firmly for at least 10 seconds. Ready for use in 1 hour. Adhesive fully cured in 24 hours.

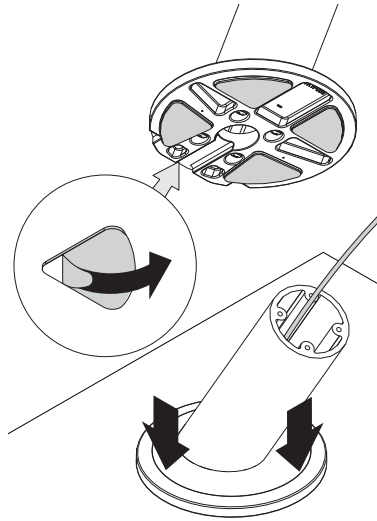

- 6** Pull power cable through center hole in tablet frame. **Note: if using audio jack extender option, see those instructions now.**

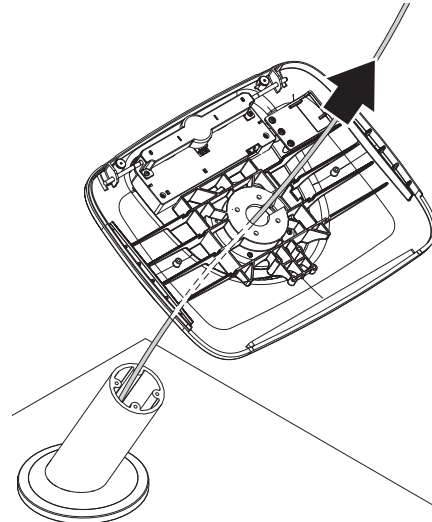

- 7** Align tablet frame onto stand, making sure frame holes are aligned with the stand holes. Rest stand on frame. See tablet frame instructions now.

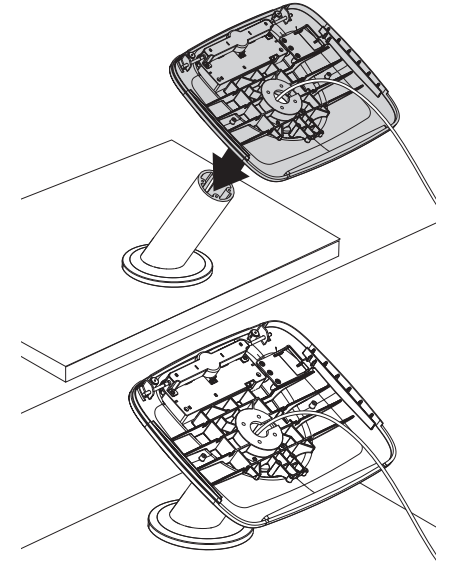

Adhesive Mount Removal (CTG2P002):

Position adhesive removal tool so that it wraps around cable exit in back of stand. Pull handle in a clockwise direction until the adhesive loosens.

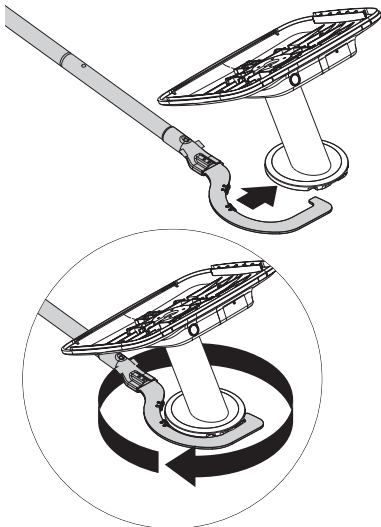

SD0355 Rev1 01/05/17

inVue

www.invue.com

NA / LATAM // 704.752.6513 • 888.55.INVUE

EMEA // +31.23.8900150

APAC // +852.3127.6811

© 2016 InVue Security Products Inc. All rights reserved.
InVue is a registered trademark of InVue Security Products.

Drill Template:

