

## Hybrid Assembly Instructions

Tools Required (supplied):

5/32" Hex Drive, 3/8" Socket or wrench

- 1) Locate hardware bag(s) – Screws, Acorn Nuts, Latches, Catches
- 2) Place Bottom Tray (3 holes at two ends) on work surface, attach two latches using 3 screws and nuts each. Screws go toward inside of tray.

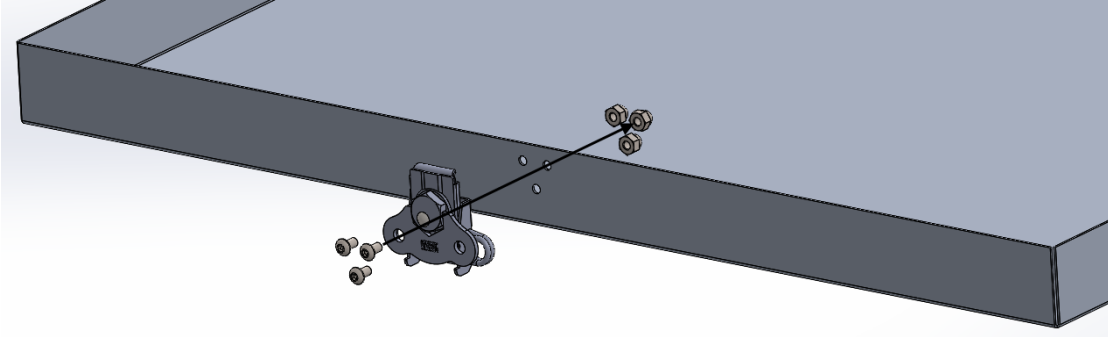

- 3) Place Top Tray upside down on work surface, place 1 side panel and front panel inside Top Tray.
  - a. Front/Rear panels will be in between two side panels.
  - b. Loosely install 2-3 screws/nuts per seam to hold panels in place.

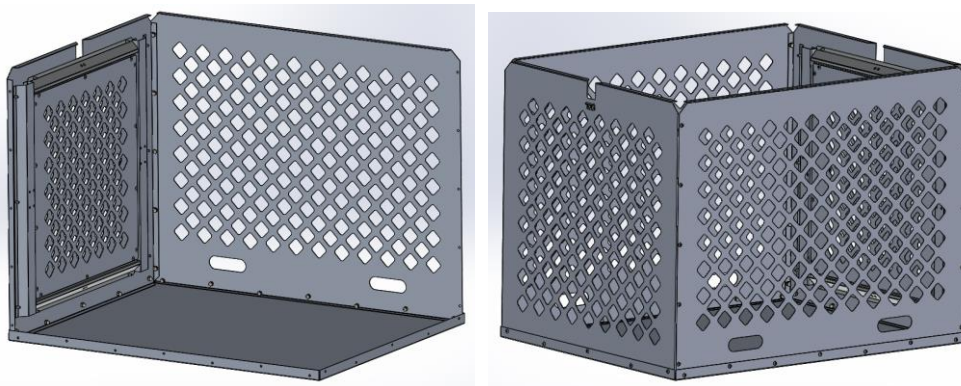

- 4) Place second side panel in top tray, loosely install 2-3 screws/nuts per seam.
- 5) Place remaining panel in top tray, loosely install 2-3 screws/nuts per seam.
- 6) Loosely install all remaining screws/nuts in remaining holes of crate.
- 7) Once all screws/nuts are in place, securely tighten all screws/nuts.
- 8) Turn over assembled Crate Top with attached panels, and set in Bottom Tray.
- 9) Secure Crate Top to Bottom Tray with butterfly latches.

