



ENTOURAGE™

CAR SEAT ADAPTER

FRONT FRAME - CYBEX®, MAXI-COSI®, NUNA®

austlen.com

WARNINGS & SAFETY INFORMATION

READ THIS USER MANUAL CAREFULLY AND UNDERSTAND ALL WARNINGS AND INSTRUCTIONS BEFORE USE. YOUR CHILD'S SAFETY MAY BE AT RISK IF YOU DO NOT FOLLOW THESE INSTRUCTIONS.

KEEP THESE INSTRUCTIONS AND WARNINGS FOR FUTURE REFERENCE.

DO NOT allow anyone to use this product unless that person has read and fully understood the warnings and instructions in this user manual prior to use.

Care & Maintenance

Inspect your Entourage™ car seat adapter periodically. Never use a product that is structurally unsound or in need of repair.

Only Austlen™ Baby Co. replacement parts should be used. It may be unsafe to use parts supplied by another manufacturer.

WARNING

- **NEVER LEAVE CHILD UNATTENDED!**
- When removing infant car seat from stroller, take care that car seat does not tip and fall.
- Always use infant car seat restraint system as recommended by car seat manufacturer.
- Audible “click” must be heard in order to determine that adapters are locked into stroller frame. To ensure proper locking engagement, pull on each adapter without pressing release button. It should stay attached to frame.
- ALWAYS position car seat so that it is securely placed down onto car seat adapters. Audible “click” must be heard in order to determine that car seat is locked into car seat adapters. To ensure proper locking engagement, pull up on car seat. It should remain attached to adapters.
- Weight and height limitations: DO NOT place a child in car seat that exceeds recommended height and weight specified by the car seat manufacturer.
- Only use car seats models approved by manufacturer with these adapters.

WARNING

- Dispose of plastic bags and packaging immediately to avoid danger of suffocation.
- Follow all car seat manufacturer's instructions when using an infant car seat with the Entourage™.
- Intended for use only with Austlen™ Entourage strollers.

Parts List

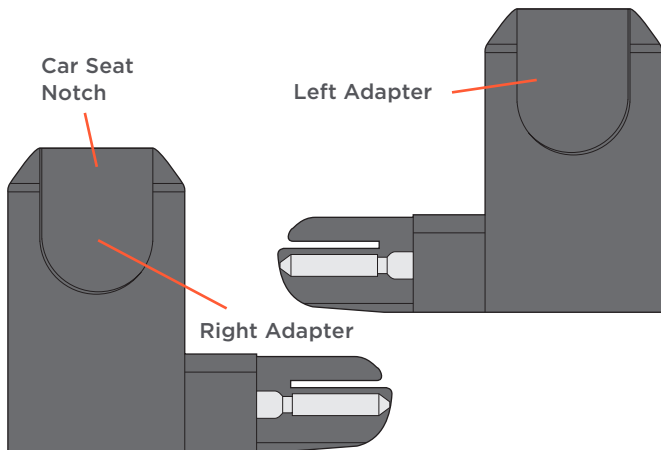

Installation

1 Attach / Remove Car Seat Adapters

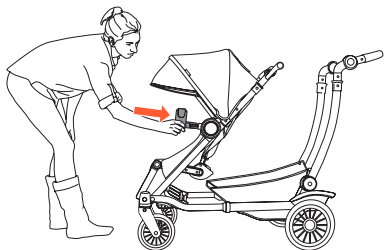

TO ATTACH ADAPTERS TO STROLLER:

STEP 1: Remove child's arm bar, and fully recline seat. Refer to Entourage™ User Manual for instructions.

STEP 2: Align adapter as shown with car seat notch facing up and hollow side facing inward. Insert metal post gently until adapter clicks into place. Repeat on opposite side. Ensure both car seat adapters are clicked fully into position before using with an infant car seat.

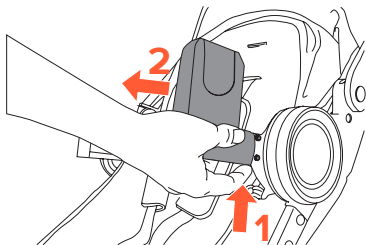

TO REMOVE ADAPTERS: Push button on underside of each adapter to release, pull out.

Compatibility

Car seat adapter is compatible with the following car seat models:

- **Maxi-Cosi® models: Mico, Mico AP, Mico NXT, Mico Max 30**
- **Nuna® models: Pipa**
- **Cybex® models: Aton, Aton 2, Aton Q**

Visit austlen.com for a current list of compatible car seats.

Use With Infant Car Seat

1 Insert / Remove Infant Car Seat

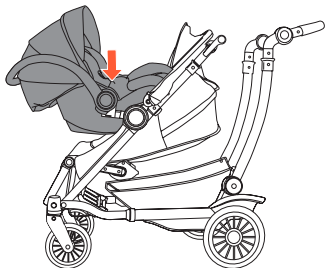

INSERT CAR SEAT:

STEP 1: Position car seat in a rear-facing position and align round car seat handlebar hubs with car seat adapter notches on both sides.

STEP 2: Slide car seat into car seat adapter notches until they lock in place.

NOTE: Make sure car seat is locked in place by pulling up on car seat. Car seat should remain attached.

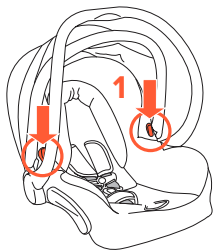

REMOVE CAR SEAT:

STEP 1: Press release buttons on right or left of car seat above hubs.

STEP 2: Pull upward.

NOTE: Infant car seat must be removed before folding stroller.

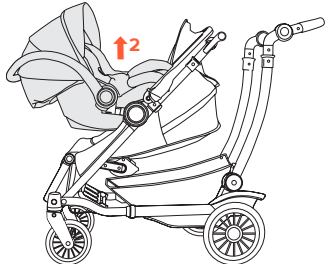

Stroller will fold with front frame car seat adapters attached.

SUPPORT & CONTACT INFORMATION

Austlen™ Baby Co.
P.O. Box 49589
Austin, TX 78765

844.AUSTLEN
support@austlen.com
austlen.com

Model SA-ICFM-BK
Manual P7700 version 1.0

All rights reserved. © 2016 Austlen™ Baby Co. Austlen, Entourage, and all associated logos are trademarks.

All product specifications are correct at time of print. Austlen Baby Co. reserves the right to alter parts that will not affect product functionality.