

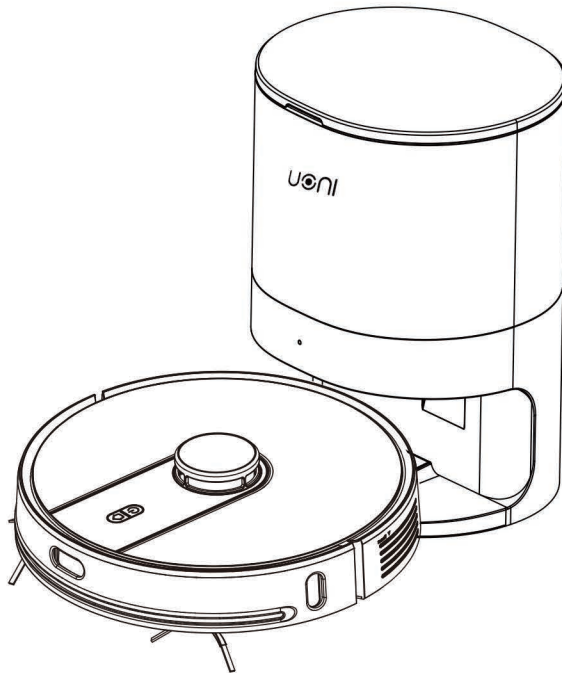

UONI LASER NAVIGATION ROBOT VACUUM CLEANER V980 Plus (Including Self-emptying Dustbin)



User Guide

Safety Information

General Warning

- Your robot is not a toy. Small children and pets should be supervised when your robot is operating.
- Do not sit or stand on your robot or charging station.
- Do not use unauthorized chargers. Use of an unauthorized charger could cause the battery to generate heat, smoke, catch fire, or explode.
- Your robot comes with a region approved power supply cord and is designed to be plugged into a standard household AC power outlet only. Do not use any other power supply cord. For replacement cords, please contact Customer Support to ensure proper selection of country specific power supply cord.
- Do not open your robot or charging station. There are no user serviceable parts inside. Refer servicing to qualified service personnel.
- Risk of electric shock, use indoors in dry location only.
- Do not handle your robot or charging station with wet hands.
- Store and operate your robot in room temperature environments only.
- If the room to be cleaned contains a balcony, a physical barrier should be used to prevent access to the balcony and ensure safe operation.

Safety Information

Battery & Charging Warnings

- Do not use a charging station with a damaged cord or plug. If the cord or plug is damaged, it must be replaced.
- Always disconnect your robot from the charging station before maintenance.
- Charge your robot only with the power supply provided. The provided power supply delivers safety extra low voltage corresponding to the input marking on the robot which is required to maintain safe operation.
- Do not open, crush, heat above 176°F/80°C, or incinerate. Follow manufacturer's instructions.
- Do not short-circuit the battery by allowing metal objects to contact battery terminals or immerse in liquid.
- Do not subject batteries to mechanical shock.

Cautions

- Do not operate the robot in areas with exposed electrical outlets in the floor.
- If the device passes over a power cord and drags it, there is a chance an object could be pulled off a table or shelf. Before using this device, pick up objects like clothing, loose papers, pull cords for blinds or curtains, power cords, and any fragile objects.
- Be aware that the robot moves on its own. Take care when walking in the area that the robot is operating in to avoid stepping on it.
- Do not use this device to pick up sharp objects, glass, or anything that is burning or smoking.

Package Includes

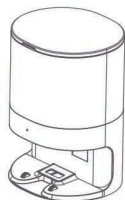

Self-Emptying Dustbin*1



Robot Vacuum*1



User Guide*1

Accessories:



Side Brush*2

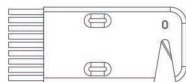

Cleaning Brush*1
(next to the dust box on the robot)

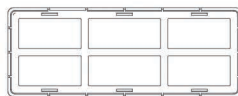

HEPA Filter*1



Water Tank*1



Remote Control*1

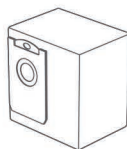

Dust Bag*2

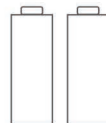

Battery *2
(for remote control)





Mop Cloth*2

Note: If you find something missing in your package, please contact customer support via service@uoni.jp in time.

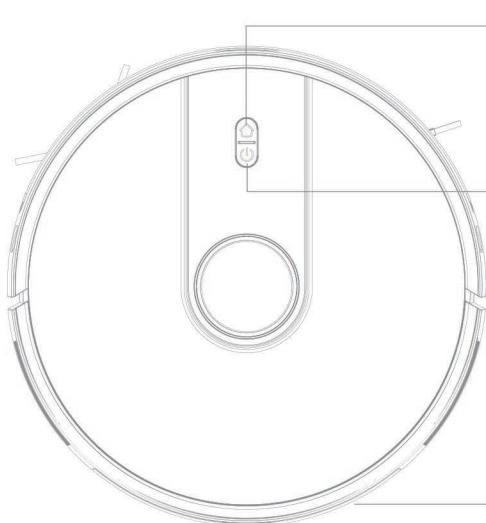

About Your Robot Vacuum

Front View



-  **Recharge Button**
 - Short press to start/pause recharging
 - Solid purple light: low battery/recharging
 - Solid purple light: charging
 - Solid purple light: fully charged
-  **Start/Stop Button**
 - Extended press to turn on/short press to turn off
 - Start/pause cleaning
 - Solid blue light: normal working/pause/standby
 - Blue light flash: powering on/configuring network/upgrading firmware
 - Red light flash quickly: abnormal/error
 - Light off: off/sleep

Wi-Fi Connection

- While the power is on, press and hold the “” and “” keys simultaneously for 5 seconds

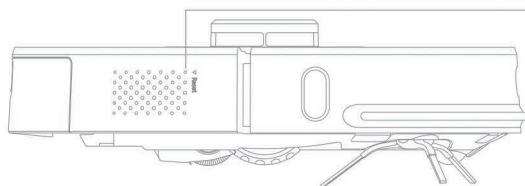

Forced Shutdown Button

- Short press to turn off

About Your Robot Vacuum

Top View

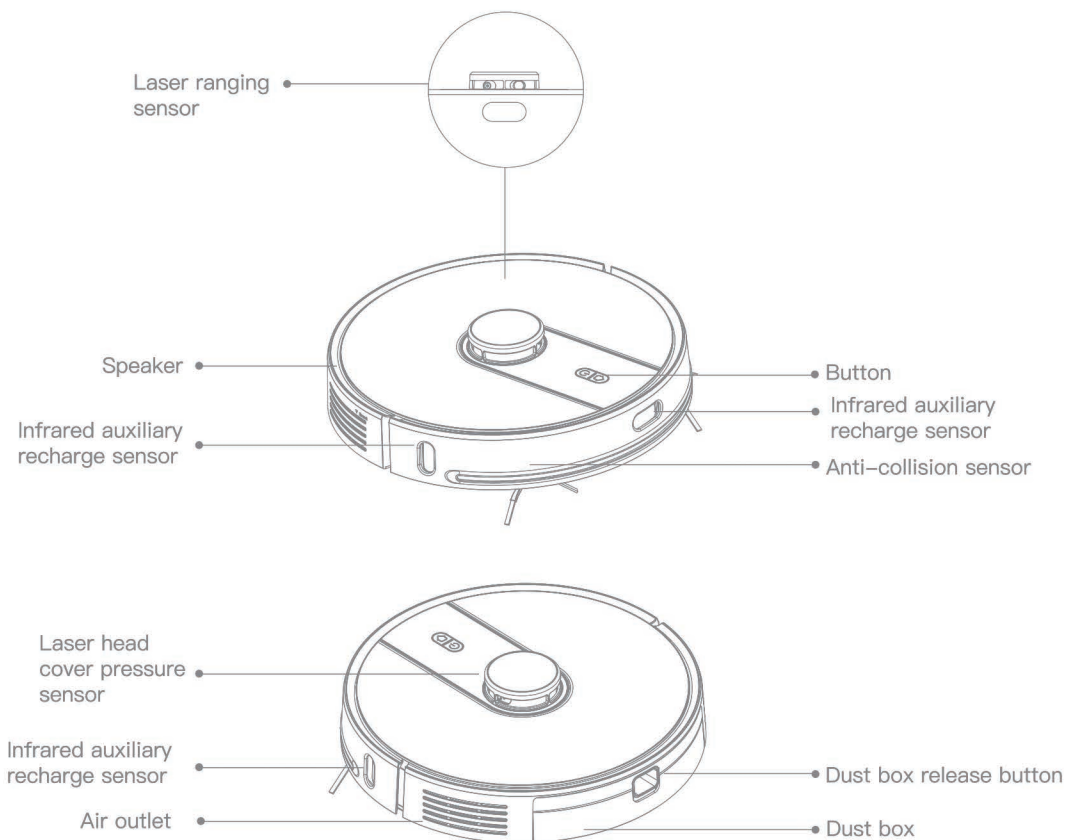

About Your Robot Vacuum

Side View

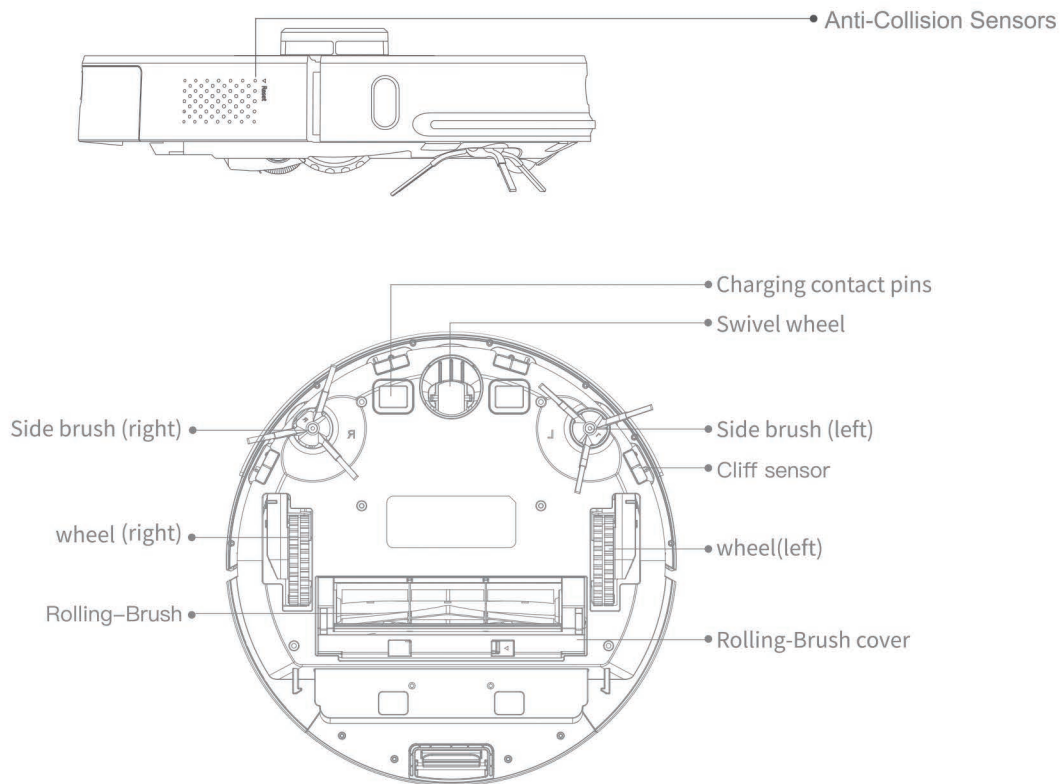

About Your Robot Vacuum

About Your Dust box

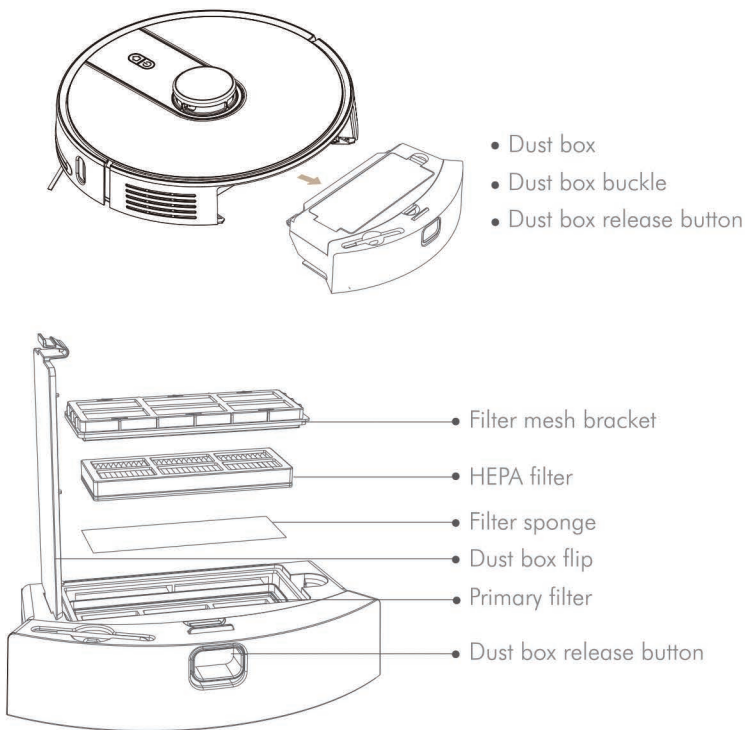

Water Tank

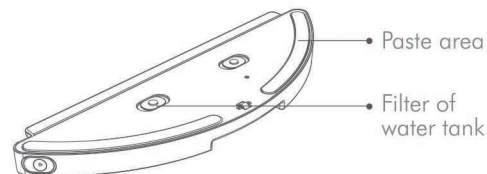
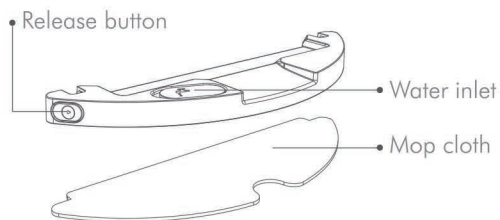

About Your Robot Vacuum

Remote control

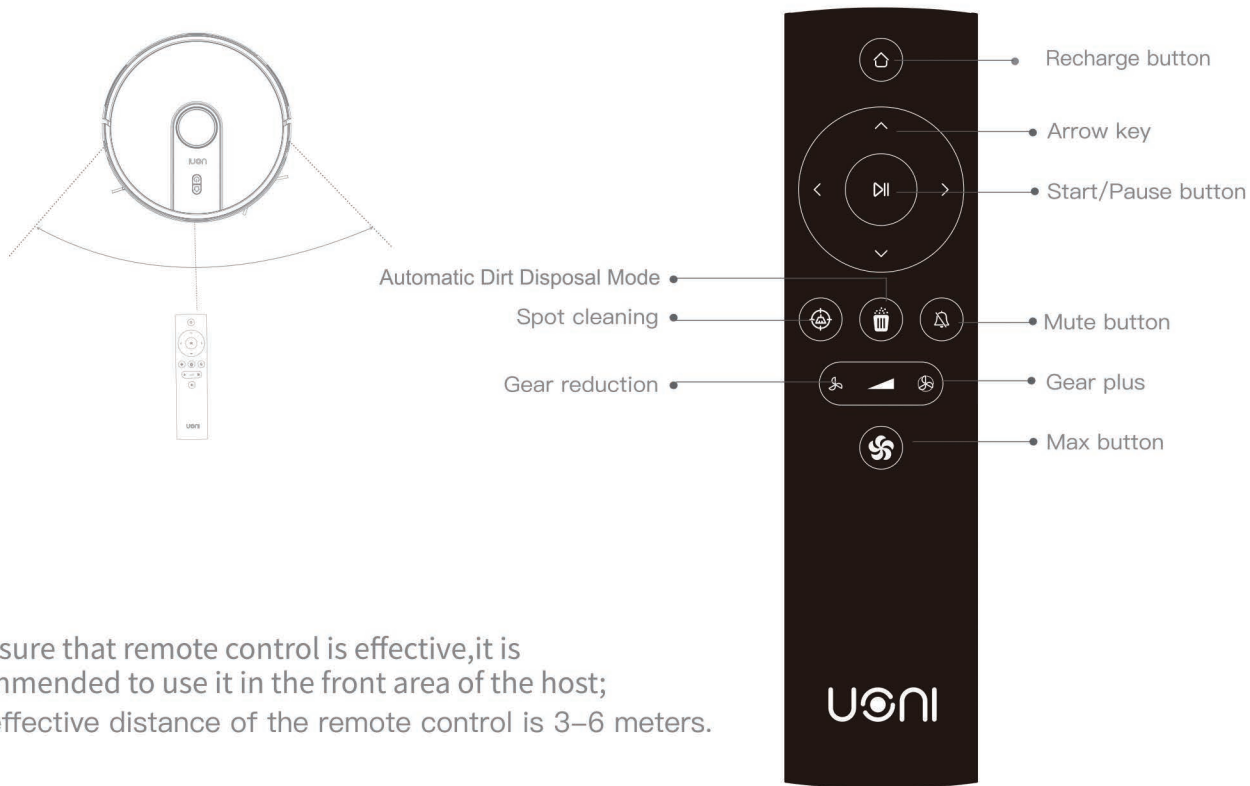

Note:

1. To ensure that remote control is effective, it is recommended to use it in the front area of the host;
2. The effective distance of the remote control is 3–6 meters.

About Your Self-Emptying Dustbin

Front View

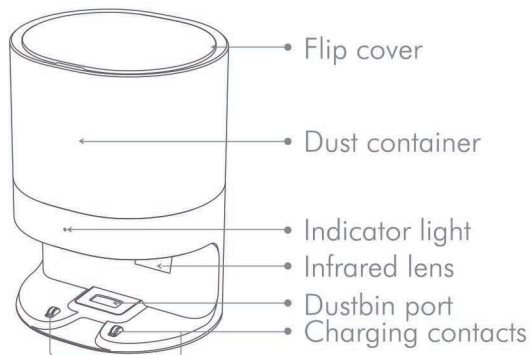

Top View

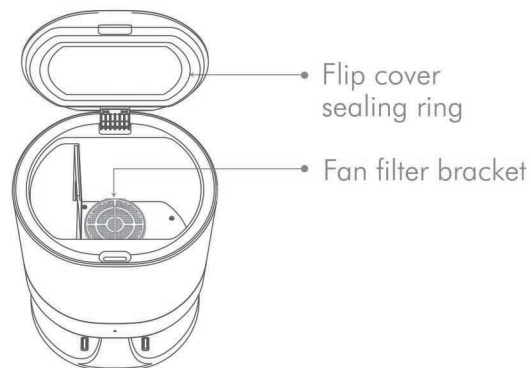

Back View

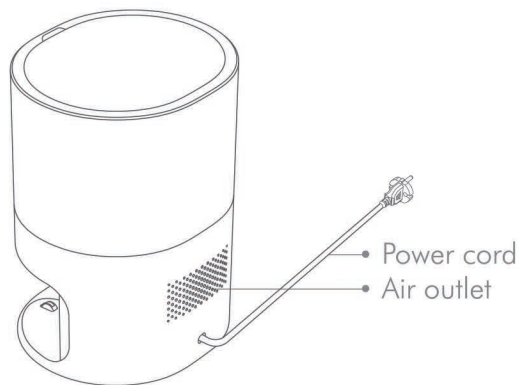

Bottom View

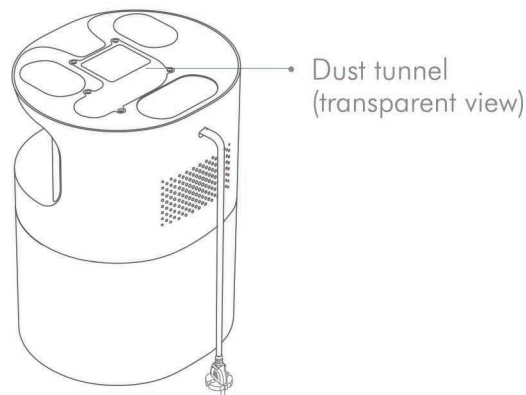

About Your Self-Emptying Dustbin

About Your Dust Bags

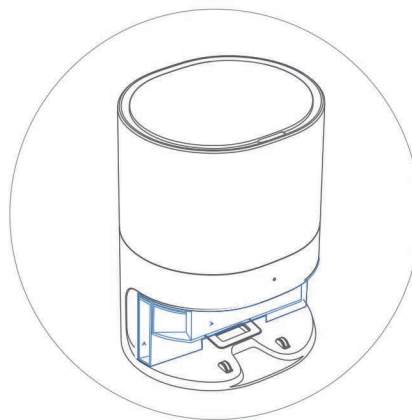
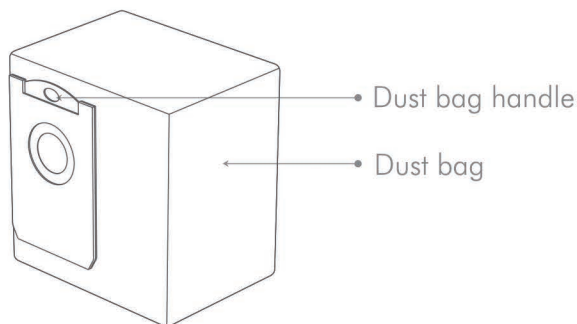

Note: If the indicator light on the dustbin flashes orange, the dust bag is probably not installed correctly.

Get Started

1. Get Ready

To start, you'll need your robot, self-emptying dustbin. Set other accessories aside for later.

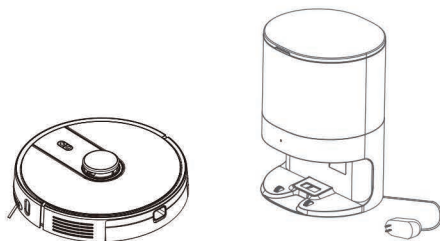

2. Position of the self-Emptying Dustbin

Place self-emptying dustbin near an outlet in an area with good Wifi-coverage.

The Dustbin should be placed on flat ground more than 6cm/2.4inch away from the wall.

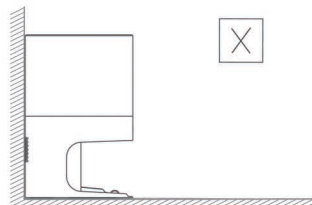
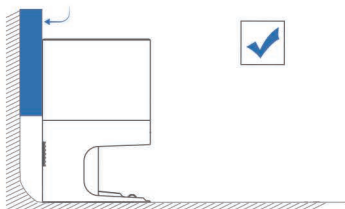

Get Started

Ensure there is a space of more than 1.2m/4ft at the front, and more than 0.5m/1.6ft on both sides of the dustbin.

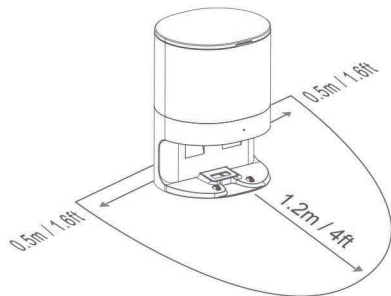

3. Plug in

Plug the power cord into the wall. Wrap the cord back so it won't get in the way of the robot as it comes and goes.

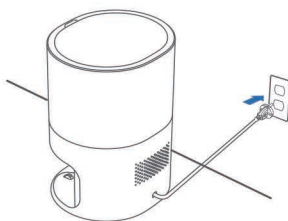

Note: Do not place the charging station in direct sunlight

Get Started

4. Wake up V980 Plus

Place your robot on the self-emptying dustbin by lining up the metal contacts.

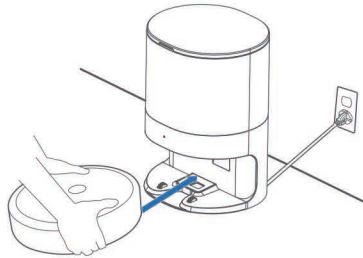

5. App Setup Uni Robot

Scan the QR code below, or search for "Uni Robot" in the mobile App store to download the App.



Q Uni Robot

Download on the
App Store

GET IT ON
Google Play

Get Started

- ① The phone is connected to WiFi;

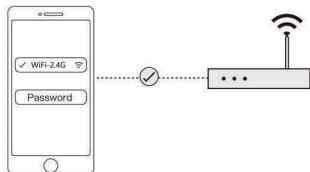

- ② Scan the QR code below, or search for “Uoni Robot” in the app store to download the app, register and login to the account;





- ③ Add device on the home page choose robot vacuum cleaner “V980 Plus”;

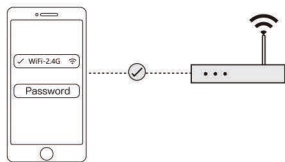

- ⑤ Select the connected WiFi of the phone and enter the WiFi password;



- ④ press the “” and “” for 5 seconds to enter the network configuration;

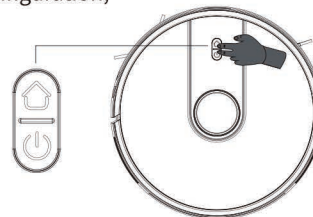

- ⑥ In the mobile phone WLAN list, connect the “SL-Uoni-xxx”;



- ⑦ Return to the APP and wait for the connecting finished.

Get Started

6. Cleaning

You can use the app, press the start button on the robot or use the remote control to make your robot work.

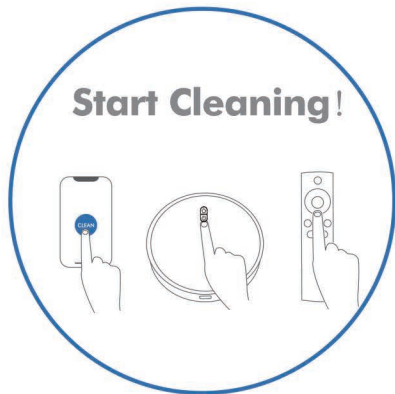

Cleaning All

After start-up, the robot will explore and create a real-time map of your house and then plan the best cleaning path.

Choose Areas

With the Uoni Robot app, you can switch between cleaning modes, schedule cleaning, select room cleaning, create virtual No-go zones, set zones to clean.

7. Recharge & Self-Empty

- Once the cleaning is done, your robot will automatically return to the self-emptying dustbin to empty its bin and recharge as needed.
- Please make sure that V980 Plus starts cleaning from the charging station.
- The robot vacuum will return to charge automatically when the battery gets low, and resume cleaning from where it left off until the job is complete.
- Manual charging: When the V980 Plus is powered off, you can manually put it back into the charging station to charge.

Note: It takes V980 Plus up to 4 hours to reach a full charge. The battery will typically last 190 mins. This also depends on the power mode you use and the floor type in your home.

8. Sleep-Mode

If there is no operation for more than 20 minutes, the robot will automatically enter into sleep-mode.

Note: The robot will not enter sleep-mode while charging.

Get Started

9. Water Tank

1. Wet the mop with water, attach the mop cloth to the velcro and tighten it.

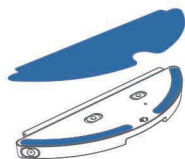

2. Fill in the water through the water inlet, and close the rubber cover.

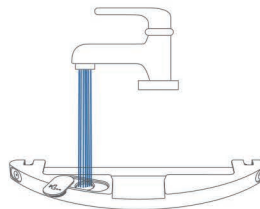

3. Put the water tank into V980 Plus.

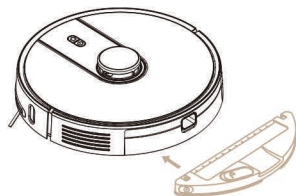

4. Start mopping in the App.

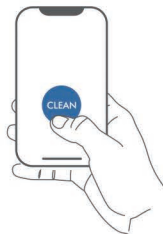

Note: Don't attempt to mop carpeted floors.

If the water-flow is too low or no water released, it's recommended to replace the tank filter.

1. Pull out two old filters.

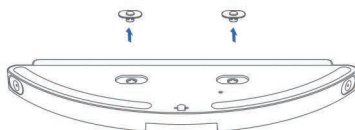

2. Press the new filter element down firmly until it is fastened.

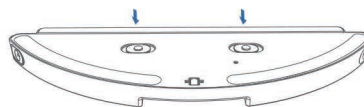

Trouble Shooting

Your robot will tell you something is wrong by playing an audio alert and turning the lighting indicator red. Further support and instructional videos are available in the Uoni Robot App and www.Uoni.com

Customer Support

If you have other questions or comments about your robot vacuum, you can start by visiting www.Uoni.com for support tips, frequently asked questions and information about accessories. This information can also be found in the Uoni Robot. If you need further assistance, contact us via service@uoni.jp

Care and Maintenance

Care and Maintenance Instructions

To keep your robot running at peak performance, perform the procedures on the following pages. If you notice the robot picking up less debris from your floor, empty the bin, clean the filter and clean the brushes.

Part	Care Frequency	Replacement Frequency*
Dust Bags		Bags should be replaced when prompted by the LED indicator (Yellow light flashes) It is recommended to replace every 3-6 weeks
Dust tunnel	If the yellow light indicator flashes but the dust bag is not full	
Main Brush	Clean every week	Every 6-12 months
Side Brush	Clean every week	Every 3-6 months
Dustbin	Wash bin as needed	
Filter	Clean once a week (twice a week if you have a pet). Do not wash.	Every 3-6 months
Front Caster Wheel	Clean every week	Every 12 months
Sensors and Charging Contacts	Clean once a month	

Note: Uoni manufactures various replacement parts and assemblies. If you think you need a replacement part, please contact us via service@uoni.jp or visit [Uoni.com](https://uoni.com)
Replacement frequency may vary. Parts should be replaced if visible wear appears.

Care and Maintenance

Replacing Bags

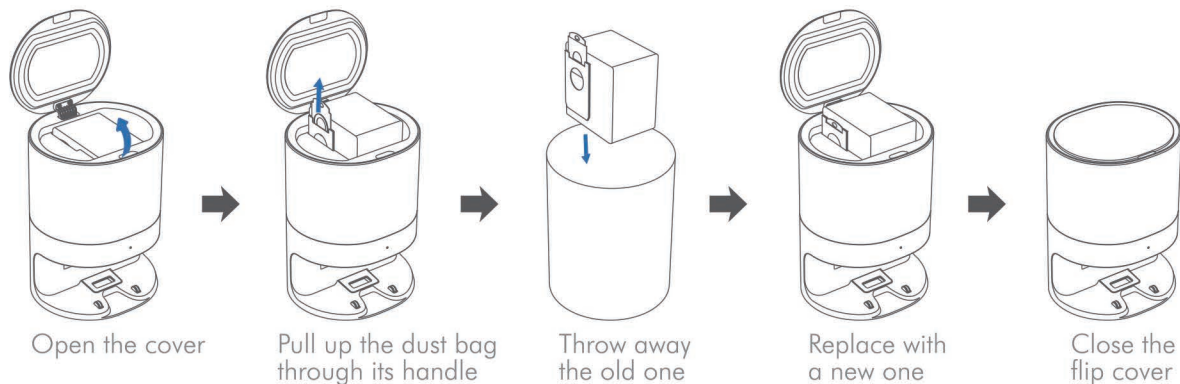

Cleaning Dust Tunnel

If the yellow light indicator flashes but the dust bag is not full, unplug the power supply of the dustbin and turn it upside down. Check if the transparent cover of the dust tunnel at the bottom shows any **debris** causing a blockage. If it is blocked, use a screwdriver to remove the screws and open the transparent cover as shown in the figure and clean out the **debris**.

Note: Do not remove it by force, please use a screwdriver.



Care and Maintenance

Cleaning the Main Brush (recommended weekly)

1. Turn the robot, press the left and right buckles, and remove the brush guard.

2. Remove the main brush upwards and clean the entangled hair and debris with a cleaning brush.

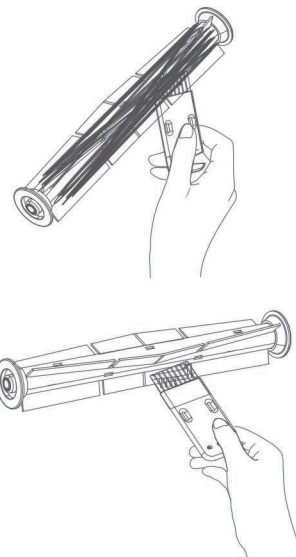
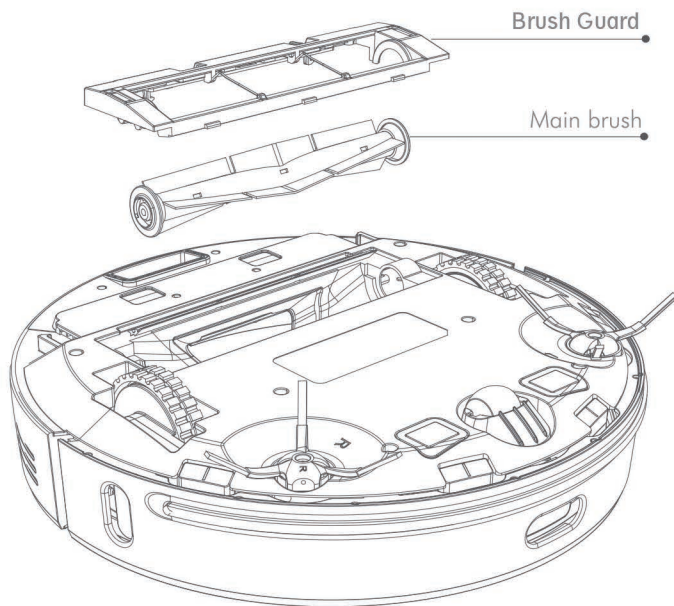

Note: If you hear abnormal sound from the main brush during cleaning process, please check if the main brush is stuck. Remove the obstacle and reinstall the main brush. You may need to reinstall multiple times to let it perform normally.

Care and Maintenance

Cleaning Side Brush

1. Use a small screwdriver to remove the screw, holding the side brush in place.

2. Remove any hair or debris, then reinstall the side brushes.

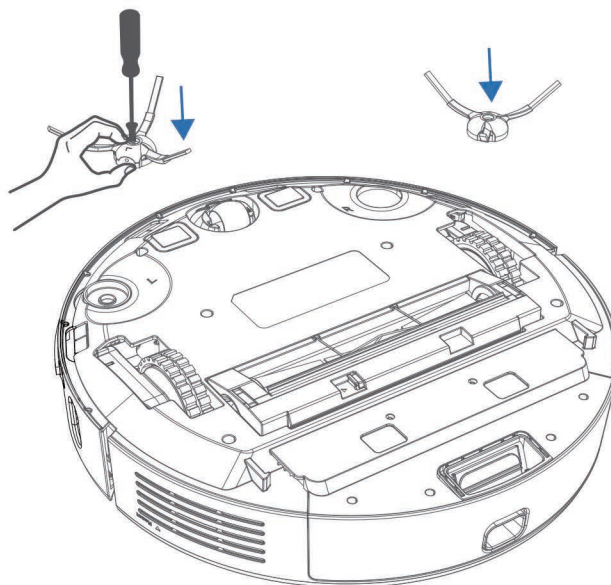
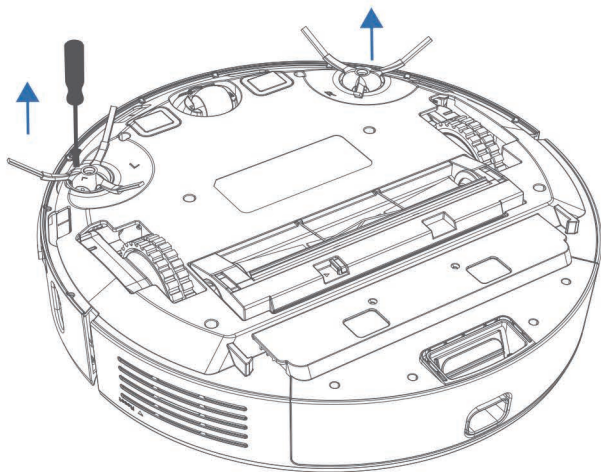

Note: When you hear the side brush report an error, please first check whether the side brush is entangled with hair or something, and then move the side brush by hand to check whether there is any abnormality, and then remove the side brush for inspection.

Care and Maintenance

- ① Press the dust box release button to remove the dust box;

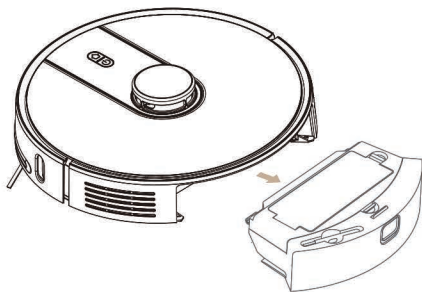

- ② Open the dust box, and dump out the garbage;

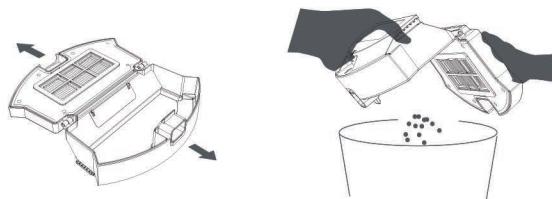

- ③ Open the dust cover and remove the filter such as HEPA and sponge;

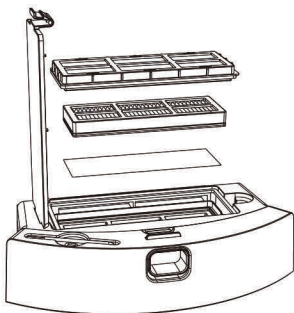

- ④ Shake off the trash on the filter net and use a cleaning brush to clean the dust box and filter;

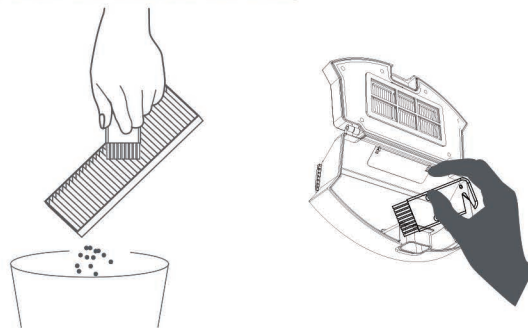

Care and Maintenance

Water Tank (maintenance required after each use)

1. Press the release button to remove the water tank.

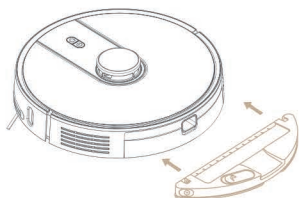

2. Remove the mop cloth, rinse with water and dry it. (if using a disposable mop, discard it directly after use)

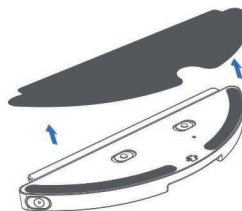

3. Pour out the remaining water in the water tank and dry the water tank.



4. When the rag and the water tank are dry, put them back for use.

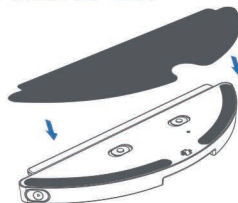

Note: If you don't remove water from the water tank after each use and let it install on the robot, water might come out and damage the robot. So please make sure you remove the water tank after each use.

Care and Maintenance

Cleaning the Front Caster Wheel

- Pull firmly on the front wheel module to remove it from the robot.
- Pull firmly on the wheel to remove it from its housing. (see illustration below)
- Remove any debris from inside the wheel cavity.
- Reinstall all parts when finished. Make sure the wheel clicks back into place.

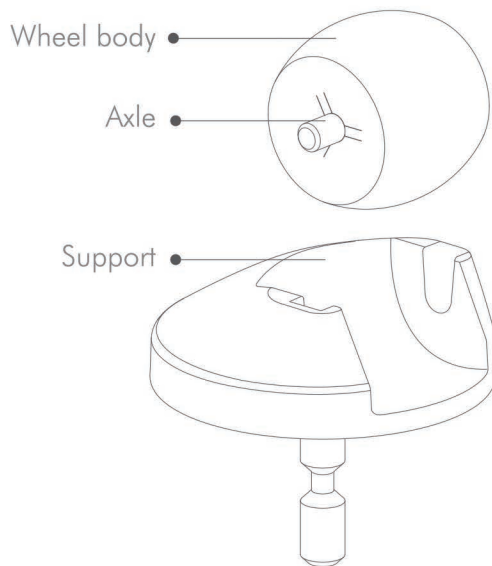

Care and Maintenance

Wipe sensors with a clean, dry cloth, including:

1. 4 cliff sensor at the bottom of the robot.
2. Wall sensor on the right side of the robot.
3. Infrared auxiliary recharge sensor.
4. Charging contacts at the bottom of the robot.

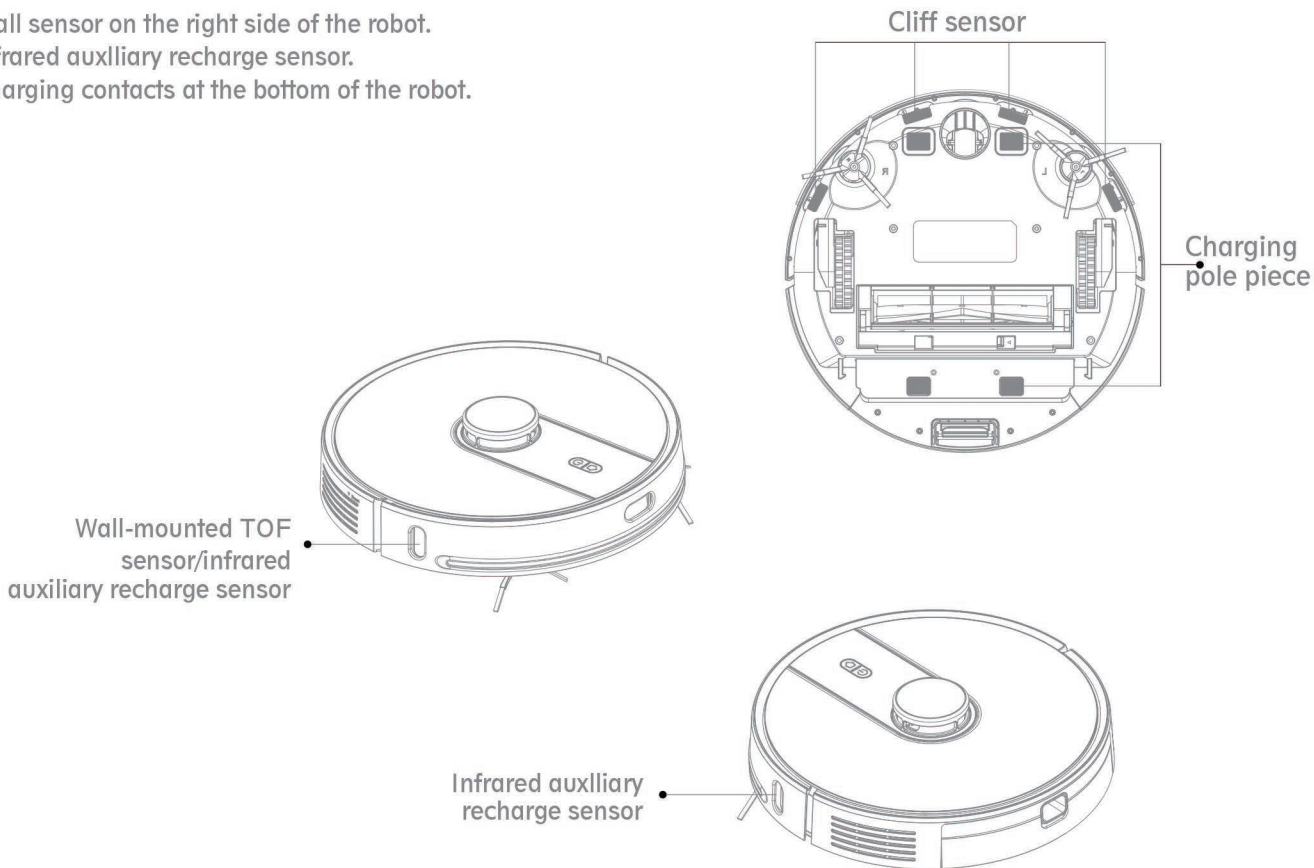

Care and Maintenance

Cleaning the Self-Emptying Dustbin

Inspect the sensors and charging contacts to make sure they are clear of debris. Wipe with a clean, dry cloth.

Note: Do not spray cleaning solution directly onto sensors or into sensor openings.

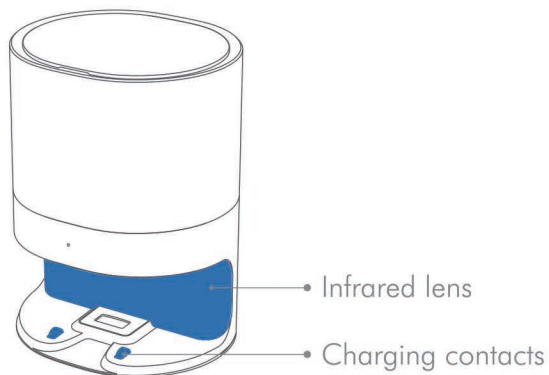

Removing debris from blower cover: Inspect blower cover for any lint or debris built-up, and wipe with a clean dry cloth to remove.

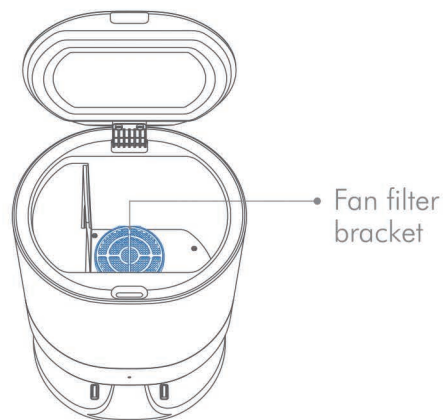

Warranty

Warranty Overview

Uoni ('We', 'Our', 'Us') warrants that, subject to the exclusions and limitations set out below, this Product (including batteries if applicable) shall be in good working order during the period of one (1) year from the date of purchase (the 'Warranty Period'). In the event that the Product fails to meet the warranty standard to our reasonable satisfaction, we will within a commercially reasonable time, free of charge, either repair or replace the Product as described below.

Note: As far as applicable laws permit, the Warranty Period will not be extended or renewed or otherwise affected due to subsequent exchange, resale, repair or replacement of the Product.

Making a Claim under the Limited Warranty

If you wish to make a warranty claim, please contact us via service@uoni.jp

Note: Please provide your order information in the mail.

Limitation of Uoni's Liability

To the extent permitted by applicable law, **Uoni's** liability shall be limited to the purchase value of the Product. The above limitations shall not apply in case of gross negligence or intentional misconduct of **Uoni** or in case of death or personal injury resulting from **Uoni's** proven negligence.

Warranty

What Is Not Covered?

Unless agreed in writing, the limited warranty will not apply if the defect(s) relate to:

- Normal wear and tear (including, without limitation, wear and tear of batteries if applicable).
- Defects caused by rough or inappropriate handling or use or damage caused by accident, misuse, neglect, fire, water, lightning or other acts of nature.
- If the product contains a battery and the fact that the battery has been short-circuited, if the seals of the battery enclosure or the cells are broken or show evidence of tampering or if the battery has been used in equipment other than those for which it has been specified,
- Non-compliance with the product instructions.
- Wilful or deliberate damage, neglect or negligence.
- Use of spare parts, an unauthorized cleaning solution if applicable, or other replacement items (including consumables) which are not provided or recommended by us.
- Any alteration or modification to the product which has been carried out by you or a third party not authorised by us.
- Any failure to adequately package the product for transportation.
- Extreme or external causes beyond our reasonable control including, but not limited to, breakdowns, fluctuations, or interruptions in electric power, ISP (internet service provider) service, or wireless networks.