

# Forney® 40 P PLASMA CUTTER



<b>ITEM# 440 SPECS</b>	<b>APPLICATIONS:</b> Light Industrial Automotive Farm / Ranch Maintenance & Repair	<b>PROCESS:</b> Plasma Arc Cutting  <b>INPUT VOLTAGE:</b> 110-120V / 208-240V	<b>AMPERAGE RANGE:</b> 120V - 15A-20A 240V - 15A-40A	<b>CUTTING CAPACITY:</b> Clean: 1/2" Sever: 3/4"  <b>WEIGHT:</b> 30 lbs. (13,63 kg)
----------------------------	--	---	--	--



ITEM# 440

### INCLUDES:

- ITEM# 440 Forney® 40 P Plasma Cutter
- 40 P Power Source
- FPT-40 Plasma Torch 20'
- Ground Clamp w/Cable and Connector
- 120V to 240V Adapter
- Spare Consumables
- Forney Expert-Tech™ Tool

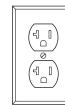

120-Volt



240-Volt

**Dual-Voltage:** Operates on 120V and 240V input power.



**Cutting Capacity:**  
 3/16" Aluminum  
 1/2" Mild and Stainless Steel

**Intuitive Controls:** Easy to understand controls allow beginner and professional users a faster parameter set-up.

**All Metal Cabinet:** Forney welders are built to take the day to day. No plastic to worry about breaking.

**Large Control knobs:** No more taking off your gloves to make adjustments. Feedback controls allow you to feel the adjustments as you make them.



**Temperature Controlled Fan:** Helps reduce dust particles from entering machine, cuts down on noise and saves money on energy.



**Euro Torch Connection:** Allows for quick torch attachment and removal, ensuring a proper torch alignment every time the torch is connected.

SP® CC/DC/1ph



**FORNEY INDUSTRIES**

2057 VERMONT DRIVE, FORT COLLINS, COLORADO 80525  
 1-800-521-6038 • FORNEYIND.COM

Amperage Range	Rated Output	Input Amperage at 60 Hz	Air Requirement	Cuts	Cut Capacity	Dimensions	Weight
120V	120V: 35% @ 20A	120V @ 18.5A	4.5 CFM	Mild Steel Stainless Steel Aluminum Copper	Clean - 1/4" Sever - 3/8"	H: 12.375" (314,33mm) L: 18" (457,2mm) W: 7.375" (187,33mm)	30 lbs. (13,63 kg)
120V: 15A - 20A							
240V	240V: 50% @ 40A	240V @ 25.5A			Clean - 1/2" Sever - 3/4"		
240V: 15A - 40A							

**CONSUMABLES:**

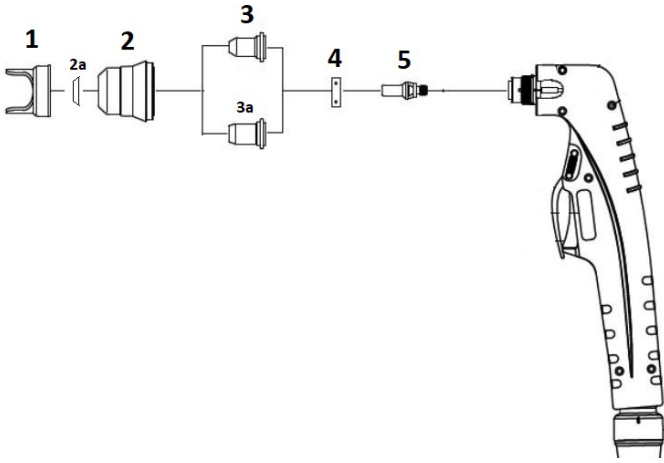

Number	ITEM#	Description
1	85682	Stand Off Guide
2	85681	Shield Cup, Drag Tip (40A)
	85685	Shield Cup, Stand Off (40A)
2a	85686	Shield Cup, Stand Off (40A)
3	85678	Drag Tip, 20-30A
	85679	Drag Tip, 30-40A
3a	85684	Stand Off Tip, 30-40A
4	85393	Swirl Ring
5	85755	Electrode

**ACCESSORIES:**



**ITEM# 85676**  
40 P Plasma Parts  
Kit Max Versatility



**ITEM# 85677**  
40 P Plasma Parts  
Kit Max Performance



**ITEM# 85667**  
Ground Cable Assembly 150A



**ITEM# 85680**  
Plasma Torch

Distributed by: