

AIRPLUS DEHUMIDIFIER USER MANUAL

CONTACT US

We guarantee a replacement or a full refund to you if you have any problems with your dehumidifier in the future! Please keep this manual for future reference.



Customer Service Email
us.airplus@gmail.com

ATTENTION

Contact us to get **A FULL REFUND** or **A REPLACEMENT** if you have any problems with this product.



WARNINGS

This appliance can be used by children aged from 8 years and above and persons with reduced physical, sensory or mental capabilities or lack of experience and knowledge if they have been given supervision or instruction concerning use of the appliance in a safe way and understand the hazards involved. Children shall not play with the appliance. Cleaning and user maintenance shall not be made by children without supervision.

CONTENTS

01	Notice of Compressor Running Status Notice of Full Tank Detection	02
03	Important Safety Instructions Product Details	04
05	Care & Cleaning Cleaning Tips • Clean The Filter Storage	06
08	Troubleshooting	09
	About Warranty	

Notice of Compressor Running Status

It's a normal phenomenon that the compressor and fan keep running when the ambient humidity reaches the preset RH. The fan stops 5 minutes after the preset RH is reached. The compressor stops when the ambient humidity is 4% lower than the preset RH, and it starts automatically when the ambient humidity level is 4% higher than the preset level. The Return Difference design featuring 4% error range is for better protecting and prolonging lifespan of the appliance.

Notice of Full Tank Detection

1. There may be a few residual water in the water collecting tray while the tank full indicator light is on. Please wait for several minutes before take out the water tank.
2. The fan will keep working for 5 minutes and the compressor will auto shut off when the tank full indicator light is on for protection. The fan will auto shut off after extra 5-minute work if the water tank is still full.

BEFORE FIRST USE

To prevent any unintended damage, please leave the appliance **standing upright** and outside the box for **2 HOURS** before plugging it in. It is very important to keep the appliance upright on a **flat surface** during use.

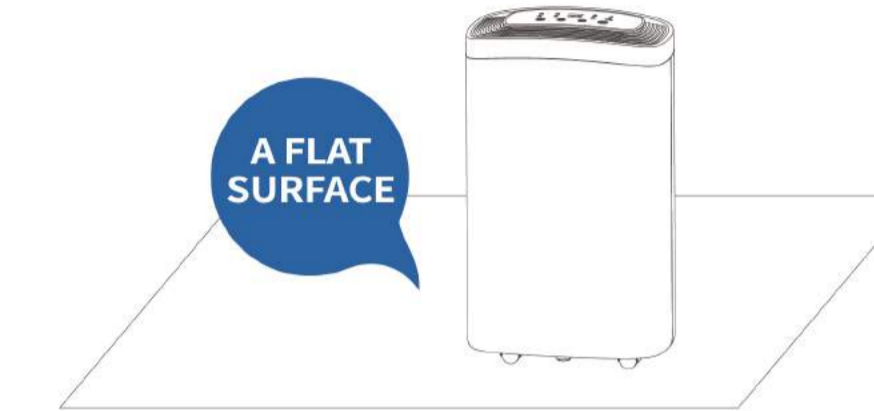

IMPORTANT SAFETY INSTRUCTIONS

1. Keep the dehumidifier upright and make sure there is at least 10-inch space around it.
2. After being carried or tilted, the dehumidifier needs to stop for 2 hours until used again.
3. Keep foreign objects away from the air inlet and outlet.
4. Please turn the dehumidifier off and empty the water tank before moving it.
5. Do not clean the dehumidifier with bad sprays or other flammable detergents.
6. Please turn the dehumidifier off and unplug it if it breaks down.
7. If the power cord is broken, please contact us at us.airplus@gmail.com immediately. We will send you a free replacement or a full refund.

PRODUCT DETAILS

- 1 Air Outlet
- 2 Power Cord
- 3 Control Panel
- 4 Handle
- 5 Filter
- 6 Water Tank
- 7 Air Inlet
- 8 Continuous Drainage Outlet
- 9 Handle of Water Tank
- 10 Caster

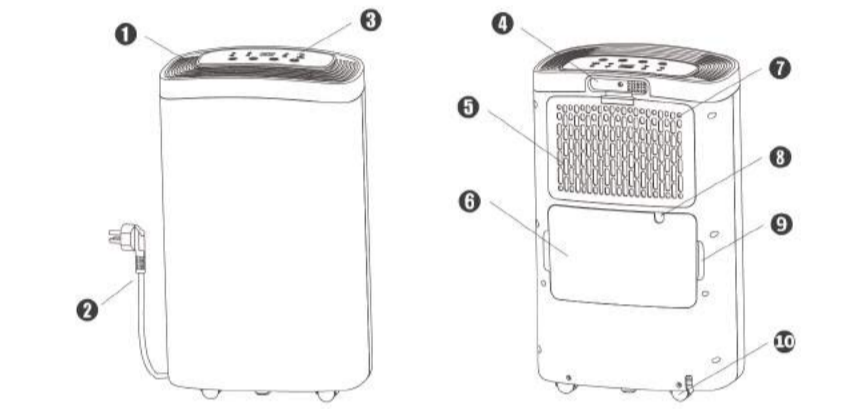

OPERATION CONTROL PANEL

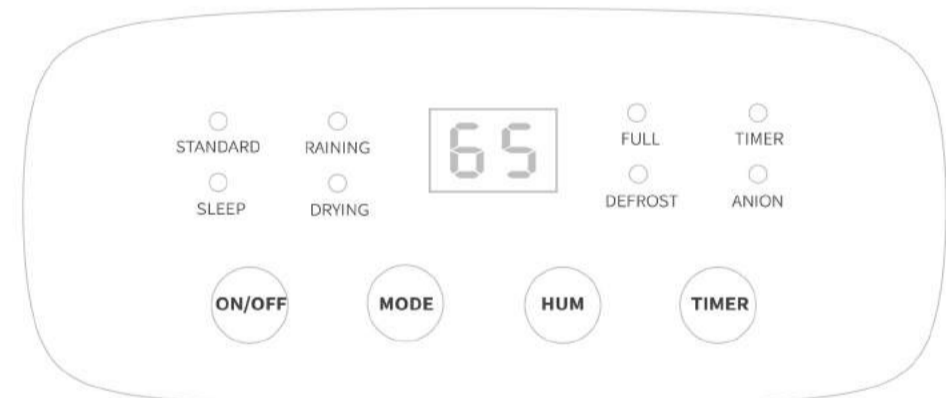

ON/OFF Plug in the power cord, and the alarm sound indicates the appliance is ready. Press "ON/OFF" to turn on/off the dehumidifier.

Press "MODE" to choose the desired mode.
DRYING: Continuous operation **SLEEP:** Automatic setting, RH=50%
RAINING: Automatic setting, RH=45% **STANDARD:** Artificial setting of RH

HUM Press "HUM" to set your desired humidity (RH 40%-80%) or CO (continuous operation) in standard mode.

Press "TIMER" to predetermine the 24 hrs auto shut-off/turn-on timing switch.

Others:
Anion Function: Please keep pressing the "MODE" button for at least 3 seconds to turn on/off the function.
Frost Removal Function: Auto detection of frost and auto defrosting. Keep the appliance remain a good performance in dehumidifying. The indicator light will be on until the frost disappears.
Detection of Full Water: When the tank is full, the dehumidifier will stop working. P.S. The alarm and the indicator light will be on.

04

DRAINAGE

There are two methods of drainage to choose from.

01 Manual Drainage
When the tank gets full, the dehumidifier will alarm and stop working automatically. Meanwhile, the "FULL" indicator light will turn on. It is suggested to pour out the water in the tank.

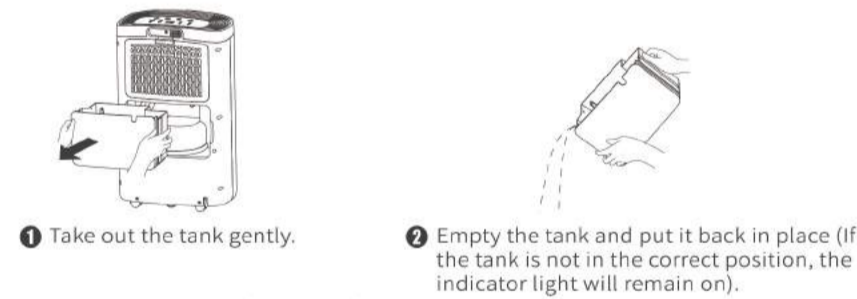

02 Continuous Drainage (optional)



CARE & CLEANING

Attention:
Keep the machine unplugged before maintaining or washing.
1. Please clean the dehumidifier after turning it off for 1 hour.
2. Please use slightly water-dampened cloth to clean the dehumidifier.
3. Please do not use volatile chemicals, gasoline, detergent, chemical processed fabrics or other cleaning solutions, which may be harmful to the dehumidifier.
4. Please do not wash the dehumidifier with water directly.

CLEAN THE FILTER

Experiment shows that a dry and clean filter is great for dehumidifying effect. Therefore, it is suggested to clean and dry up the filter every two weeks.



05

STORAGE

If you do not need to use the dehumidifier for a long time, please store it in the following ways:
1. Turn off the dehumidifier, cut off the power and sort out the power cord.
2. Empty the water tank and keep it dry.
3. Clean the filter and dry it out.
4. Put away the dehumidifier and place it in the position unexposed to sun.

NOTICE OF CONTINUOUS DRAINAGE Wrong Use Methods

1. If there is a U shape or a V shape between two ends of the hose, the increasing accumulation of water in the valley may stop water from draining to the water collecting vessel. It eventually leads to a backflow to water tank or a water leak from other lower parts of the appliance.

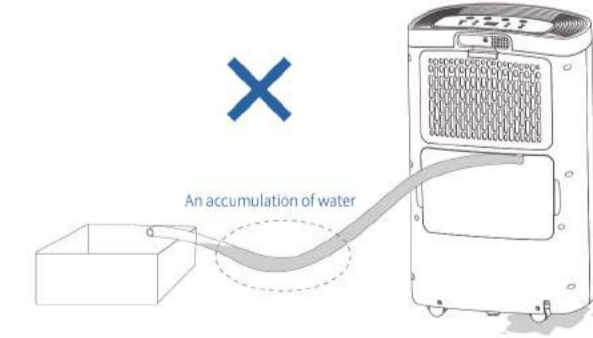

2. If there is no space between the outlet of hose and the water collecting vessel, the increasing pressure of water caused by raising water level may result in a failure of drainage from the appliance. It eventually leads to a backflow to water tank or a water leak from other lower parts of the appliance.

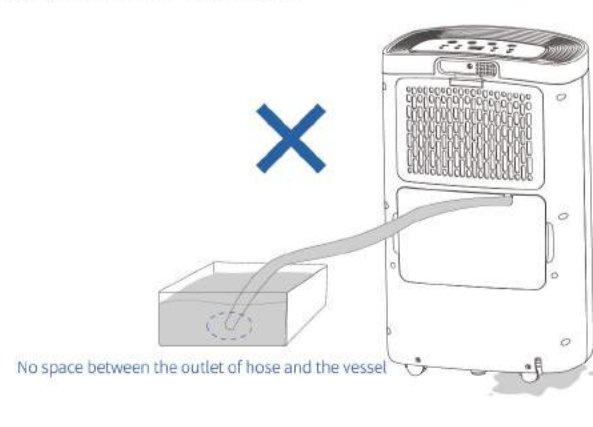

06

Advised Use Methods

1. This method is applicable for external water collecting vessel, please note the following:

1. Keep the hose downward.
2. Make sure the drainage outlet of the appliance is always higher than the maximum water level of the water collecting vessel or water may flow backward.
3. Make sure there is always a height difference of 5.5 in between the outlet of hose and the drainage outlet of the appliance. The outlet of hose should be 5.5 in lower all the time.

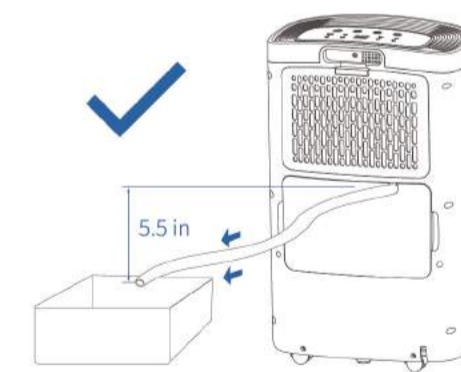

2. This method is applicable for floor drain. Well connect the hose to the appliance and place the other end to the floor drain.

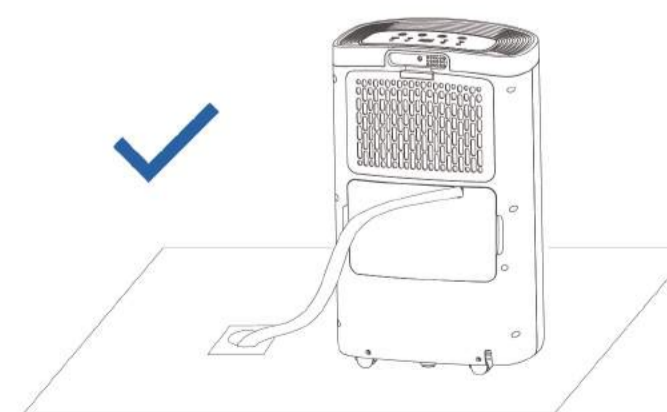

07

TROUBLESHOOTING

PROBLEMS	PROBABLE REASONS	SOLUTIONS
The dehumidifier does not work.	The socket is loose.	Please check the socket to ensure the machine is charged.
	The light of "FULL" is on.	Please remove the water from the tank or replace the tank in its place.
Dehumidifying effect is not obvious. Or the dehumidifier is not removing moisture.	The room humidity is lower than setting.	Please reset the humidity setting of the machine to ensure it is lower than the humidity of the room.
	The filter is dusty.	Please clean the filter and make sure there is at least 10-inch space around the dehumidifier.
	The inlet or outlet is blocked.	Check that all doors and windows are securely closed.
The dehumidifier is a little noisy.	The room temperature or humidity is too low.	This is normal.
	The vibration may be caused by uneven placement.	Please put the machine in a flat place.
The air turbine does not work.	The filter is clogged.	Please clean the filter.
	The air turbine does not work.	Please reassemble the air turbine or remove the foreign objects.
	The filter is clogged.	Please clean the filter.

The display shows "E1", "E2", "H1" or "LO"

E1/E2	The component inside dehumidifier is under open circuit or short circuit.
H1	The indoor temperature is higher than 167°F.
LO	The indoor temperature is lower than 32°F.

1. If you have any other problems, please contact us to get a replacement or a full refund.

2. Customer Service Email: us.airplus@gmail.com

08

AIRPLUS

ABOUT WARRANTY

Q: Do you have warranty for this product?

A: We strictly abide by the Amazon regulations which cover a full refund or a free replacement within 30 days if this product breaks under normal use or unintended damage. You may also get additional 2-year warranty after register your order information in our warranty system.

Q: How can I get the additional warranty?

A: Please enter www.getprize.net/airplus to register in AIRPLUS warranty system. And we promise our team always stands behind our product, we will try our best to help you get a better experience on the product.

09

AIRPLUS
Customer Service Email
us.airplus@gmail.com