

5. CANOPY INSTALLATION



1. Pull up the canopy rods
2. Tighten the screw to secure the canopy rods in place
3. Place canopy tubes over the canopy rods to hold canopy in place

6. BRAKE OPERATION



- Step down on the brake pedal to lock
- Test the brake to ensure it is locked by trying to push the stroller
- Push the brake pedal upwards with your foot to release it

WONDERFOLD
— WAGON —



Please scan the QR code for more product information.
www.wonderfoldwagon.com

WONDERFOLD
— WAGON —



X2 USER MANUAL

WWW.WONDERFOLDWAGON.COM

⚠ WARNING

- Never exceed the maximum person limit on the product
- The product may become unstable if the manufacturer's recommended load is exceeded:
Product maximum weight limit: 150 lbs, Rear basket maximum weight limit: 10 lbs
- The product is intended for children in the 6-36 months age group
- During unpacking and assembly, make sure all parts and plastic storage bags are accounted for and kept away from children. All fasteners should be fully tightened
- The seat is not suitable for children under 6 months
- Ensure all locking mechanisms are correctly engaged before use
- Keep your children away from the product when folding and unfolding to avoid injuries
- There are pinch points between the product supports and frame that may injure fingers.
Stay clear of pinch points when opening or closing the product or when making adjustments
- Avoid serious injury from falling or sliding out. Always use 5-point harness to secure children
- Never leave children unattended
- Always apply brake when taking children in or out
- Brake must always be engaged when the product is idle to avoid injuries and accidents
- Do not allow children to play unsupervised next to the product
- Do not let your children play with the product
- This product is not a jogger. The product is not suitable for running or skating or any similar activities
- Never leave children in the product while ascending or descending stairs
- Always use caution on uneven surfaces. Contents may become unstable and children could be injured by them
- Do not hang items on the product and place anything on top of the canopy at any time.
The product may become unstable
- Do not make any alterations or modifications to the product or use products, hardware or parts that have not been supplied by WonderFold Wagon
- Regularly check hardware and parts. Do not use the product if any hardware or parts are damaged or broken

💡 Warnings in this manual can not cover all instances and unforeseen situations that may occur. It must be understood that common sense, general caution and care are factors that can not be incorporated into a user manual. It is important that everyone who uses the wagon understands the warnings. This product must not be operated by children under the age of 12.

Contact WonderFold Wagon customer service for replacement parts or service questions at <http://www.wonderfoldwagon.com> or call (888) 681-1526

- Do not make any alterations or modifications to the product or use products, hardware or parts that have not been supplied by WonderFold Wagon
- Do not use accessories which are not approved by the manufacturer
- Only use replacement parts supplied and recommended by the manufacturer
- Any violations will void your warranty and may cause instability or structural damage to the product or personal injuries

WONDERFOLD
WAGON

1. PRODUCT ASSEMBLY

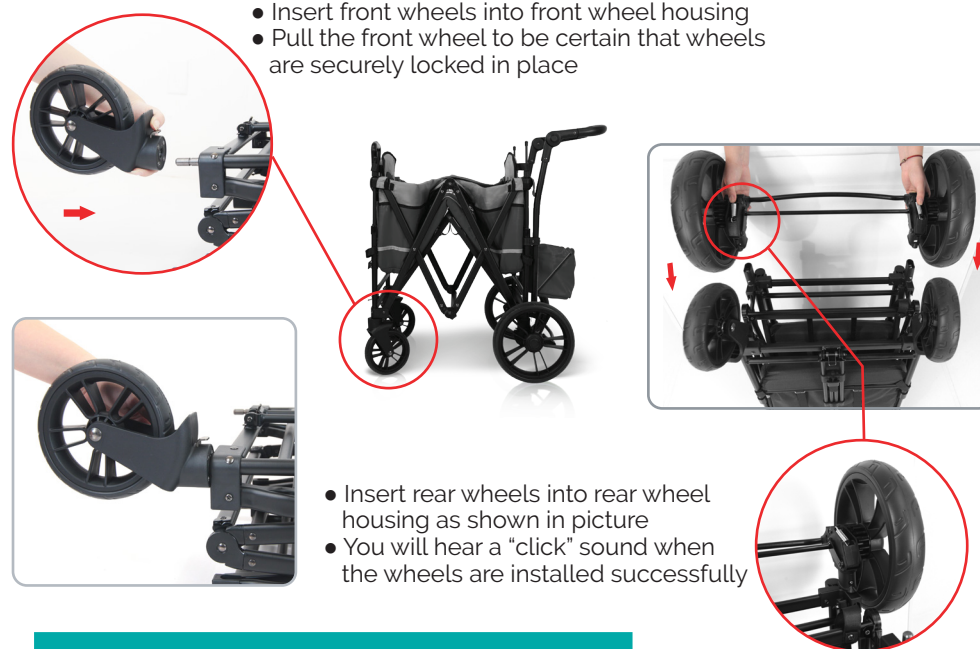

2. PRODUCT PARTS



3. UNFOLD THE STROLLER

- Unfold the stroller as shown in picture below



4. ADJUST THE HANDLE HEIGHT

