

DOLCECLIMA FRESCO

12AC & 15AC WI-FI

Models: 2261 & 2262

MANUAL FOR USE **EN**



Wi-Fi Setup Quick Start Guide



OS Home



 **OLÍMPIA
SPLENDID**
HOME OF COMFORT

1 Install OS Home App for iOS or Android

iOS Devices



1. Tap the  icon on your Apple device.
2. Type OS Home in the search window and search for the app.
3. Tap INSTALL button. If asked, enter your Apple iTunes® password, and then tap OK to proceed.
4. When the app is finished installing, an OPEN button is displayed on the screen.

If you are ready to begin registration, tap OPEN to launch the app.



Android Devices



1. Tap the  Google Play icon on Android device.
2. Type OS Home in the search window and search for the app.
3. Tap the INSTALL button.
4. Tap the ACCEPT button on the App permissions screen.
5. When the app is finished installing, an OPEN button is displayed on the screen.

If you are ready to begin registration, tap OPEN and the app will start.



2 Register an account with OS Home App

Make sure your mobile phone or tablet is connected to the internet before proceeding with user registration.

Open OS Home App

1. Click on **“Sign Up”**. (Fig. 1)
2. Enter your E-mail, check **“I Agree”** box, then click on **“Get Verification Code”**.
 **If the email with the code does not arrive, check your “Spam” folder in your mailbox.**
3. Enter the verification code sent to the email you previously used to register. If email still hasn't arrived, click on **“Didn't get a code?”** to resend. (Fig. 2)
4. Set your desired password, click **“Done”**.

Figure 1

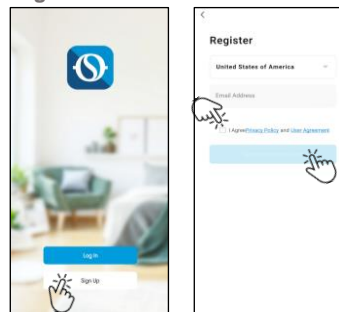
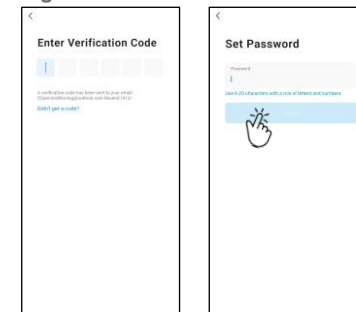

Figure 2



3 Activate/reset WiFi function using FRESCO touch panel display

Connect the power cord of the appliance to the power socket; then turn on WiFi function for network configuration.

Activate or **reset** the WiFi function by pressing & holding Fan/Wifi Mode (SW6) button for approximately **5 seconds** until the LED (S10) starts to blink. (User's Manual sec. 3.12)

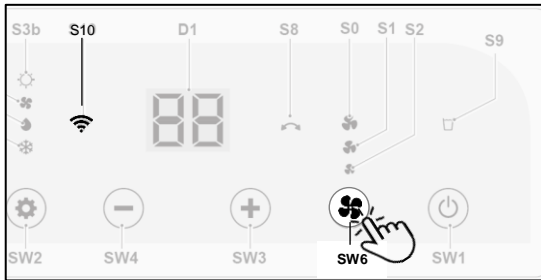

Follow step-by-step directions on the **OS Home App** to connect to FRESCO for network setup.

4 Connecting FRESCO to your network using OS Home App

Make sure your mobile device is connected to the **same Wi-Fi network** you want to use to connect the **FRESCO** portable AC.

 **Please connect using 2.4GHz network. To set router to 2.4GHz, please click on "Common router setting method" in the following step to select network and provide password.**

1. **"Log-in"** to the OS Home app using previously setup email and password, then agree to Privacy Policy and User's Agreement. (Fig. 3)
2. Choose device to add in OS Home App
 - 1) Click on **"Add Device"** or **"+"** in the top right-hand corner. (Fig. 4)
 - 2) Select **"Dolceclima Fresco"**. (Fig. 5)

Figure 3

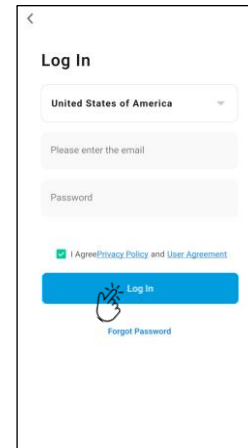

Figure 4

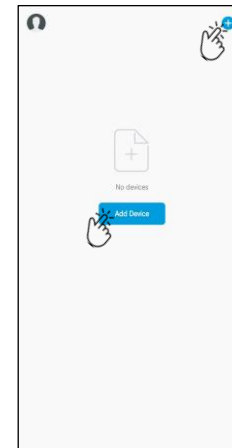



Figure 5



4 Connecting FRESCO to your network using OS Home App

3. Confirm network and enter network password then “Next”. (Fig. 6)

4. Confirm that Wifi indicator  (S10) on the Fresco touch panel is on and blinking rapidly.



 **If resetting is necessary, refer to step 3 on previous page to perform a reset for the FRESCO.**

5. Click on “Confirm indicator rapidly blink”, then click “Next”. (Fig. 7)

6. OS Home connects & configures Fresco Wifi air conditioner. (Fig. 8)

 **When the FRESCO is connected to the WiFi network, the Wifi indicator (S10) stops blinking and remains switched ON steadily on the display.**

 **Fresco will be listed in OS Home app under “All Devices”**

Figure 6



Figure 7

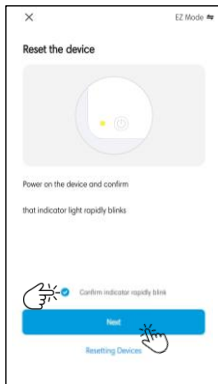



Figure 8



4A Connecting FRESCO using OS Home App – Alternate Method

If unable to add FRESCO to OS Home App, follow directions below to connect using “AP Mode” option.

Do not cycle power by unplugging power cord from outlet.

1. Reset Wifi indicator  (S10) to **blink slowly** by pressing & holding Fan/Wifi Mode (SW6) button for approximately 5 seconds.

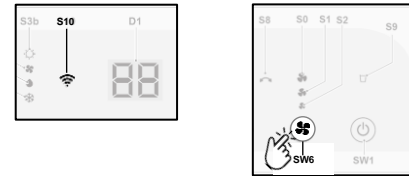

2. Switch to “AP Mode” by tapping upper right corner. (Fig. 9)

3. Click on “Confirm indicator slowly blink”, then click “Next” (Fig. 10)

Figure 9

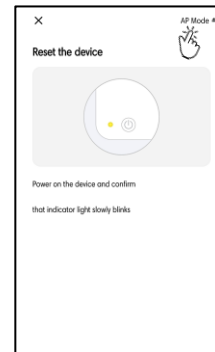

Figure 10



4A Connecting FRESCO using OS Home App – Alternate Method

4. Click **“Go to Connect”** to be directed to mobile device’s Wifi settings. (Fig. 11)
5. Select FRESCO network name **“Smartlife-XXXX”** in mobile device Wifi settings. (Fig. 12)
6. Select **“Connect only this time”** if prompted (*Android only*). (Fig. 12)

Figure 11



Figure 12

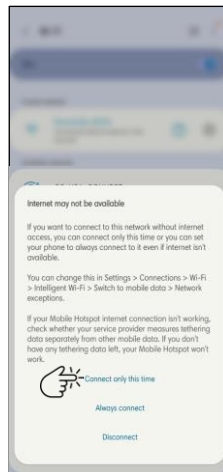

4A Connecting FRESCO using OS Home App – Alternate Method

7. Return to OS Home App to finish setup;

 **When the FRESCO is connected to the WiFi network, the Wifi function LED (S10) stops blinking and remains switched ON steadily on the display.**

For iOS Device

Click back to **“< OS Home”**.

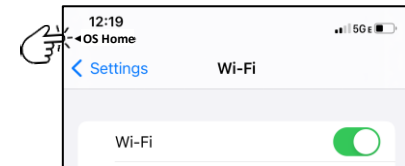

For Android Device

- 1) Click **“< Wi-Fi”** back button, then
- 2) Click **“< Connections”** back button, then
- 3) From open app screen select **“OS Home App”**.

