

ST SWITCH

SMART AUTOMATIC PORTABLE TRANSFER SWITCH

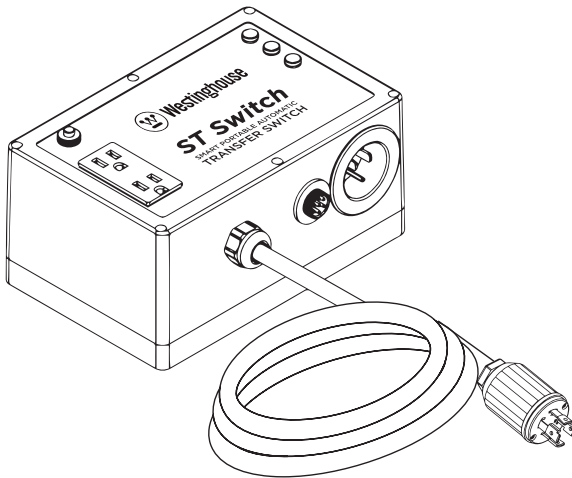

**Thank you for choosing Westinghouse!
PLEASE READ BEFORE RETURNING
THIS PRODUCT FOR ANY REASON.**

If you have a question or experience a problem with your Westinghouse purchase, call us at 855-944-3571 to speak with an agent.

SAVE THIS MANUAL FOR FUTURE REFERENCE.

HOW TO REGISTER YOUR WESTINGHOUSE PRODUCT

To register your new product, call 855-944-3571 or visit
www.westinghouseoutdoorpower.com/register
MAKE SURE TO HAVE SERIAL NUMBER ON HAND

 **WARNING**

This product can expose you to chemicals including Lead, which is known to the State of California to cause cancer, birth defects or other reproductive harm. For more information, go to www.P65Warnings.ca.gov.

DISCLAIMERS:

All information, illustrations and specifications in this manual are based on the latest information available at the time of publishing. The illustrations used in this manual are intended as representative reference views only. Moreover, because of our continuous product improvement policy, we may modify information, illustrations and/or specifications to explain and/or exemplify a product, service or maintenance improvement. We reserve the right to make any change at any time without notice. Some images may vary depending upon which model is shown.

ALL RIGHTS RESERVED:

No part of this publication may be reproduced or used in any form by any means – graphic, electronic or mechanical, including photocopying, recording, taping or information storage and retrieval systems – without the written permission of Westinghouse Outdoor Power Equipment, LLC.

 **DANGER**



This manual contains important instructions for operating this product. For your safety and the safety of others, be sure to read this manual thoroughly before operating the ST Switch. Failure to properly follow all instructions and precautions can cause you and others to be seriously hurt or killed.

ST SWITCH SPECIFICATIONS

Compatible Generators	Output Running Wattage	ST Switch Output Power	Max Utility Input Power	Generator Input Power	ST Switch Outlets	Generator Power Cord
Must have Smart Switch Port	2,400W	120V 20A 60Hz	120V 20A 60Hz	120V 20A 60Hz	120V 5-20R 20A Duplex	L14-30P MAX 120V 20A

FOR YOUR RECORDS:

Date of Purchase:	
Model Number:	
Purchased from Store/Dealer:	
Serial Number:	

**HAVE QUESTIONS? Email us at service@wpowerreq.com
or call 1-855-944-3571**

IMPORTANT: KEEP YOUR PURCHASE RECEIPT TO ENSURE TROUBLE-FREE WARRANTY COVERAGE.

PRODUCT REGISTRATION

To ensure trouble-free warranty coverage, it is important you register your Westinghouse ST Switch. You can register your ST Switch by either:

1. Filing in the product registration form below and mailing to:
Product Registration
Westinghouse Outdoor Power Equipment
777 Manor Park Drive
Columbus, Ohio 43228
2. Registering your product Online at wpowereq.com/register
To register your ST Switch you will need to locate the serial number:

WHERE IS MY SERIAL NUMBER?

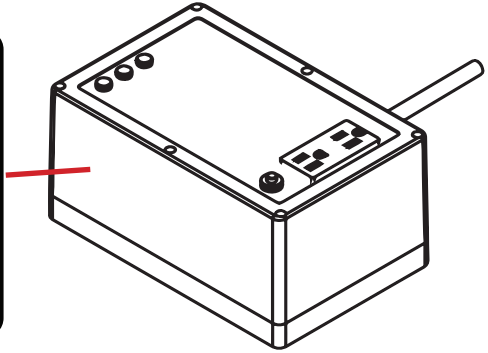
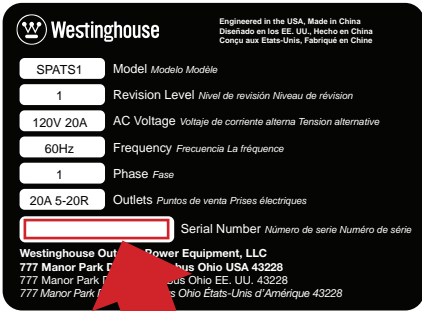

WESTINGHOUSE PRODUCT REGISTRATION FORM

PERSONAL INFORMATION

First Name: _____

Last Name: _____

Street Address: _____

Street Address: _____

City, State, ZIP: _____

Country: _____

Phone Number: _____

E-Mail: _____

ST SWITCH INFORMATION

Model Number: _____

Serial Number: _____

Date Purchased: _____

Purchased From: _____



TABLE OF CONTENTS

Product Registration	2
Safety Definitions	5
Generator Safety	6
General Safety Rules	7
Safety Labels and Decals.	8
ST Switch Features	9
Before Using the ST Switch	10
Set Up Instructions.	11
How it Works	12
ST Switch Indicator Lights	13
How to Test the ST Switch	14
Using Extension Cords.	15
Storage and Maintenance	15
Warranty.	16

SAFETY

SAFETY DEFINITIONS

The words DANGER, WARNING, CAUTION and NOTICE are used throughout this manual to highlight important information. Be certain that the meanings of these alerts are known to all who work on or near the equipment.



This safety alert symbol appears with most safety statements. It means attention, become alert, your safety is involved! Please read and abide by the message that follows the safety alerts symbol.

DANGER

Indicates a hazardous situation which, if not avoided, will result in death or serious injury.

WARNING

Indicates a hazardous situation which, if not avoided, could result in death or serious injury.

CAUTION

Indicates a hazardous situation which, if not avoided, could result in minor or moderate injury.

NOTICE

Indicates a situation which can cause damage to the ST Switch, personal property and/or the environment, or cause the equipment to operate improperly.

NOTE: Indicates a procedure, practice or condition that should be followed in order for the ST Switch to function in the manner intended.

SAFETY SYMBOL DEFINITIONS

Symbol	Description
	Safety Alert Symbol
	Asphyxiation Hazard
	Burn Hazard
	Burst/Pressure Hazard
	Don't leave tools in the area
	Electrical Shock Hazard
	Explosion Hazard
	Fire Hazard
	Lifting Hazard
	Pinch-Point Hazard
	Read Manufacturer's Instructions
	Read Safety Messages Before Proceeding
	Wear Personal Protective Equipment (PPE)

SAFETY

GENERATOR SAFETY RULES

DANGER



Never use the generator in a location that is wet or damp. Never expose the generator to rain, snow, water spray or standing water while in use. Protect the generator from all hazardous weather conditions. Moisture or ice can cause a short circuit or other malfunction in the electrical circuit.



Make sure generator is in an open, secure location and at least 15ft away from the house. Never operate the generator in an enclosed area. Engine exhaust contains carbon monoxide. Only operate the generator outside and away from windows, doors and vents.

WARNING



Voltage produced by the generator could result in death or serious injury.

- Never operate the generator in rain or a flood plain unless proper precautions are taken to avoid being subject to rain or a flood.
- Never use worn or damaged extension cords.
- Always have a licensed electrician connect the generator to the utility circuit.
- Never touch an operating generator if the generator is wet or if you have wet hands.
- Never operate the generator in highly conductive areas such as around metal decking or steel works.
- Always use grounded extension cords. Always use three-wire or double-insulated power tools.
- Never touch live terminals or bare wires while the generator is operating.
- Be sure the generator is properly grounded before operating.

WARNING



Gasoline and gasoline vapors are extremely flammable and explosive under certain conditions.

- Always refuel the generator outdoors, in a well-ventilated area.
- Never remove the fuel cap with the engine running.
- Never refuel the generator while the engine is running. Always turn engine off and allow the generator to cool before refueling.
- Only fill fuel tank with gasoline.
- Keep sparks, open flames or other form of ignition (such as match, cigarette, static electric source) away when refueling.
- Never overfill the fuel tank. Leave room for fuel to expand. Overfilling the fuel tank can result in a sudden overflow of gasoline and result in spilled gasoline coming in contact with HOT surfaces. Spilled fuel can ignite. If fuel is spilled on the generator, wipe up any spills immediately. Dispose of rag properly. Allow area of spilled fuel to dry before operating the generator.
- Wear eye protection while refueling.
- Never use gasoline as a cleaning agent.
- Store any containers containing gasoline in a well-ventilated area, away from any combustibles or source of ignition.
- Check for fuel leaks after refueling. Never operate the engine if a fuel leak is discovered.

WARNING



Never operate the generator if powered items overheat, electrical output drops, there is sparking, flames or smoke coming from the generator, or if the receptacles are damaged.



Never use the generator to power medical support equipment.



Always remove any tools or other service equipment used during maintenance from the generator before operating.

NOTICE

Never modify the generator.

Never operate the generator if it vibrates at high levels, if engine speed changes greatly or if the engine misfires often.

Always disconnect tools or appliances from the generator before starting.

SAFETY

GENERAL SAFETY RULES

DANGER



Read and understand the ST Switch and generator owner's manual before using.



Electrical Shock Hazard:

- Never connect ST Switch when generator is running.
- Equipment starts automatically, beware of shock hazard.
- Turn the generator to the OFF position while attaching the ST Switch connections.
- Only use with compatible generators that have ST Switch outlet. Never modify or rewire the ST Switch. Modifying this product in any way could result in death or serious injury.
- Do not connect to any other transfer switches.
- Disconnect ST Switch if you do not plan on using it.
- Store in dry area away from flammable items.



Never put the ST Switch box in a location that is wet or damp. Never expose the ST Switch to rain, snow, water spray or standing water while in use. Protect the ST Switch from all hazardous weather conditions. Moisture or ice can cause a short circuit or other malfunction in the electrical circuit.



To ensure proper operation of this unit, test the generator and ST Switch as described in the owner's manual before leaving equipment unattended.

WARNING



Improper set up of the ST Switch could lead to death or serious injury.

- Make sure generator control cable is plugged into generator and ST Switch.
- Always make sure generator RUN switch is on when leaving ST Switch run while unattended.
- Always use grounded extension cords.
- Never touch live terminals or bare wires while the ST Switch is powered.
- Be sure the ST Switch is inside away from any flammable materials.
- Never leave on basement floor or any floor that could experience flooding.
- Never use the ST Switch to power medical support equipment.
- Make sure extension cords are never frayed or damaged.
- Never run the generator indoors. If the cable is not long enough make sure to use an approved adapter. It is recommended to use a CO detector in living spaces when running generator outdoors.
- Do not plug in utility power to a GFCI outlet.
- Do not use outlet adapter with generator input cord.
- Never plug in appliances that would exceed the power output of the ST Switch.
- Never use ST Switch if indicator lights are not working properly.
- When setting up always connect utility power first before the generator control cable.

NOTICE

Always add up the wattage of the appliances you are going to power and do not exceed the power output of the ST Switch.

The power output of the ST Switch must match your utility power output. Plug devices directly into utility power to test and confirm that the outlet can provide enough power.

SAFETY

SAFETY LABELS AND DECALS

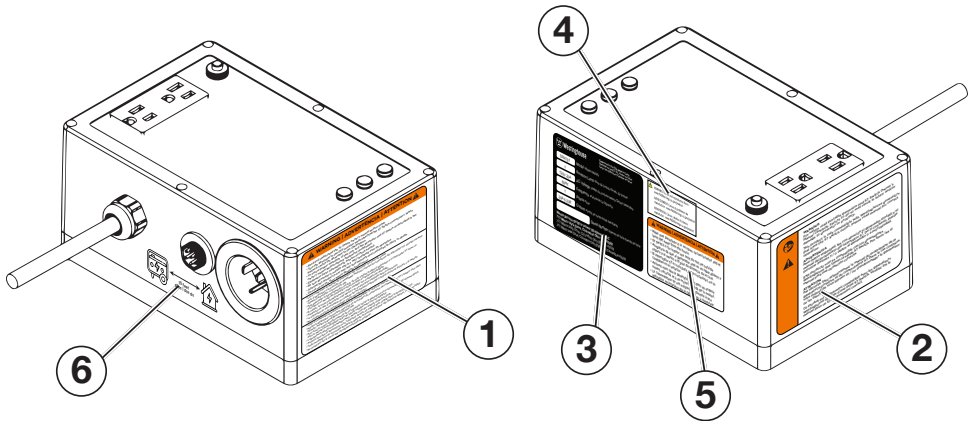

1 **⚠ WARNING | ADVERTENCIA | ATTENTION ⚠**

- Read and understand the ST Switch owner's manual before using.
- Turn the generator to the OFF position while attaching the ST Switch connections. When finished, switch the generator to the ON position.
- To ensure proper operation of this unit, test the generator and ST Switch as described in the owner's manual before leaving equipment unattended.
- Equipment starts automatically, beware of shock hazard.
- Be sure generator is outside and in a well ventilated area for operation.
- Altering this product in any way will void warranty and could lead to injury or death.
- Do not set on the floor where flooding could occur.
- Lea y comprenda el manual del propietario del interruptor ST antes de usarlo.
- Gire el generador a la posición de APAGADO mientras conecta las conexiones del interruptor ST. Cuando termine, cambie el generador a la posición ON.
- Para garantizar el funcionamiento correcto de esta unidad, pruebe el generador y el interruptor ST como se describe en el manual del propietario antes de dejar el equipo desatendido.
- El equipo se inicia automáticamente, tenga cuidado con el peligro de descarga.
- Asegúrese de que el generador esté afuera y en un área bien ventilada para la operación.
- La alteración de este producto de cualquier forma anulará la garantía y podría provocar lesiones o la muerte.
- No coloque en el piso donde puedan ocurrir inundaciones.
- Lisez et comprenez le manuel d'utilisation du commutateur ST avant de l'utiliser.
- Mettez le générateur en position OFF tout en raccordant les connexions du commutateur ST. Lorsque vous avez terminé, mettez le générateur en position ON.
- Pour assurer le bon fonctionnement de cet appareil, testez le générateur et le commutateur ST comme décrit dans le manuel du propriétaire avant de laisser l'équipement sans surveillance.
- L'équipement démarre automatiquement, méfiez-vous des risques d'électrocution.
- Assurez-vous que la génératrice est à l'extérieur et dans un endroit bien ventilé pour le fonctionnement.
- Toute modification de ce produit annulera la garantie et pourrait entraîner des blessures graves, voire mortelles.
- No pases por sur lo sol-o una inundación podría ser producto.

2 **⚠ WARNING**

For safety, read portable generator and ST Switch Owner's Manual carefully. Failure to do so may result in injury and/or damage to generator or property.

This product is only compatible with Westinghouse generators that have the ST Switch outlet. Please read manual for correct operation.

ADVERTENCIA

Para mayor seguridad, lea con atención el generador portátil y el manual del propietario del interruptor ST. De lo contrario, puede provocar lesiones y / o daños al generador o a la propiedad.

Este producto solo es compatible con los generadores Westinghouse que tienen la salida ST Switch. Por favor, lea el manual para una operación correcta.

ATTENTION

Par sécurité, lisez attentivement le manuel du propriétaire de la génératrice portable et du commutateur ST. Dans le cas contraire, vous risquez de vous blesser et / ou d'endommager le générateur ou les biens.

Ce produit est uniquement compatible avec les générateurs Westinghouse équipés d'une prise ST Switch. Veuillez lire le manuel pour un fonctionnement correct.

3 **Westinghouse** Engineered in the USA, Made in China
Diseñado en los EE. UU., Hecho en China
Conçu aux États-Unis, Fabriqué en Chine

SPATS1	Modelo Modelo Modelo
1	Revision Level Nivel de revisión Niveau de révision
120V 20A	AC Voltage Voltaje de corriente alterna Tension alternative
60Hz	Frequency Frecuencia La fréquence
1	Phase Fase
20A 5-20R	Outlets Puntos de venta Prises électriques
Serial Number Número de serie Número de serie	

Westinghouse Outdoor Power Equipment, LLC
777 Manor Park Drive, Columbus Ohio USA 43228
777 Manor Park Drive, Columbus Ohio EE. UU. 43228
777 Manor Park Drive, Columbus Ohio États-Unis d'Amérique 43228

4 **⚠ WARNING: Cancer and reproductive harm -**
www.PSCWarnings.ca.gov/product

ADVERTISSEMENT: Cancer et problèmes de
reproduction - www.PSCWarnings.ca.gov/product

ADVERTENCIA: Cáncer y daños al sistema
reproductor - www.PSCWarnings.ca.gov/product

5 **⚠ WARNING | ADVERTENCIA | ATTENTION ⚠**

- Make sure generator is in an open, secure location and at least 15ft away from the house.
- ST Switch is for indoor use only, do not set outside.
- Asegúrese de que el generador esté en un lugar abierto y seguro y al menos a 15 pies de distancia de la casa.
- El interruptor ST es solo para uso en interiores, no lo configure en el exterior.
- Assurez-vous que la génératrice est dans un endroit ouvert, sécurisé et à au moins 15 pieds de la maison.
- Le commutateur ST est uniquement destiné à une utilisation en intérieur. Ne le réglez pas à l'extérieur.



FEATURES

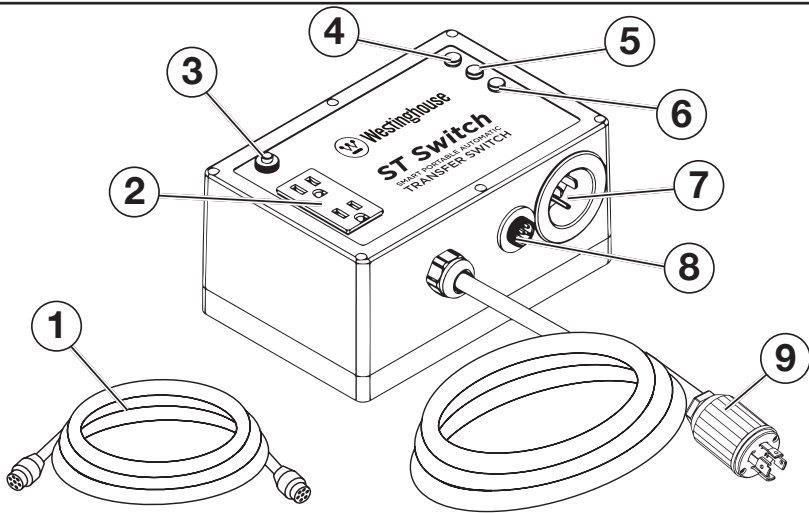

① 25' Generator Control Cable

This cable connects the ST Switch to the portable generator and controls the generator start up and shutdown sequences. The generators battery is charged by this cable when the ST Switch is being powered by utility.

② 120V 20A 5-20R Outlet

Plug appliances you want to keep powered to this outlet. Make sure total wattage of these appliances does not exceed the rated output of the ST Switch.

③ 20-Amp Circuit Breaker

Circuit breaker limits the current that can be delivered through the 120V duplex outlets to 20A.

④ Utility Power Indicator (Green)

Steady green light indicates utility is powering box.

⑤ Generator Power Indicator (Green)

Steady green light indicates generator is powering box.

⑥ Utility Loss Indicator (Red)

Steady red light indicates loss of utility power.

⑦ Utility Power Input

Use extension cable with ground (not included) to connect to household outlet. Do not connect to GFCI outlet.

⑧ Control Cable Outlet

Attach one end of the generator control cable to this port and the other to the corresponding port on the generator.

⑨ 25' Generator Power Input Cord

Provides power from generator to ST Switch when utility power is lost. Plug is L14-30P.

OPERATION

BEFORE USING THE ST SWITCH

COMPATIBLE GENERATORS

The ST Switch will only work with generators that have this Smart Switch Ready outlet. This product will not work with any other generators. Please see Smart Switch outlet below.



UNDERSTANDING POWER OUTPUT AND DEMAND OF APPLIANCES

120 Volt AC devices have two different electric power demands that must be taken into consideration, namely the running power and the starting/peak power. Both are measured in Watts (typically abbreviated as “W”).

The steady state continuous load is the running power demand and this is often marked on the device near its model number or serial number. Sometimes the device might only be marked with its voltage (i.e. 120V) and current draw (e.g. 6 Amp or 6A), in which case the running power demand in Watts can be obtained by multiplying the voltage times the current, e.g. $120V \times 6A = 720W$.

Simple resistive 120 Volt AC devices such as incandescent bulbs, toasters, heaters, etc. have no extra power demand when starting, and so their starting power demands are the same as their running power demands.

More complex 120 Volt AC devices containing inductive or capacitive elements such as electric motors have a momentary extra power demand when starting, which can be up to seven times the running power demand or more. Manufacturers of such devices rarely publish this starting power demand and so it's often necessary to estimate it. A rule of thumb for devices fitted with an electric motor is to apply a starting power multiplier of 1.2 for small hand-held or portable devices and a value of 3.5 for larger stationary devices. For example, a 900W angle grinder can be assumed to have a starting power demand of at least $1.2 \times 900W$, which equals 1,080W.

To prevent overloading of the ST Switches 120 Volt AC system add up the running power demand of all the 120 Volt AC devices that will be connected to the ST Switch at one time. This total must not be greater than the power output of the utility power.

RECOMMENDED USE

NOTICE

The list of appliances below is a general guideline. Always check the wattage of the devices you are trying to power as ratings may vary. Always test to confirm ST Switch is not overloaded by appliance power demands.

When adding up power demands of appliances do not exceed the rated output of your utility power.

The table below are common appliances that can be individually powered by the ST Switch. Wattages are estimations.

TABLE 1: RECOMMEND APPLIANCES

Appliance	Typical Running Wattage
Refrigerator or Freezer	700W
Sump Pump (1/3 HP)	1300W
Sump Pump (1/2 HP)	2200W
Space Heater	1500W
Gas or Fuel Furnace (1/8 HP)	300W
Gas or Fuel Furnace (1/6 HP)	500W
Gas or Fuel Furnace (1/4 HP)	600W
Gas or Fuel Furnace (1/2 HP)	700W
10,000 BTU Air Conditioner	700W
15,000 BTU Air Conditioner	1500W

OPERATION

SET UP



READ ALL SAFETY INFO IN THIS ST SWITCH MANUAL AND GENERATOR MANUAL. GENERATOR MUST BE OFF WHILE SETTING UP ST SWITCH

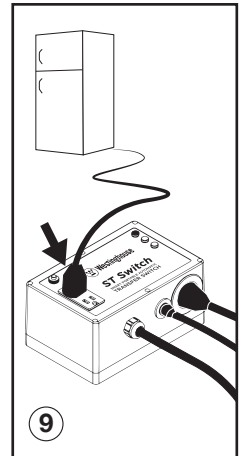
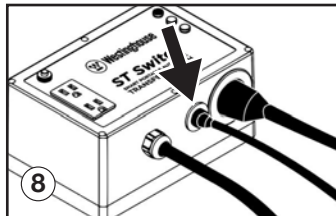
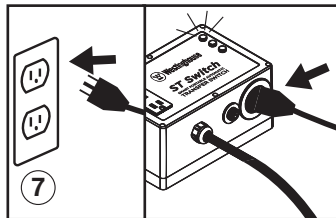
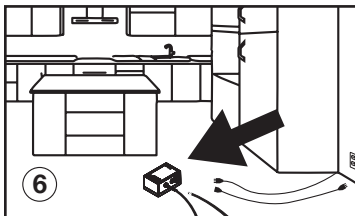
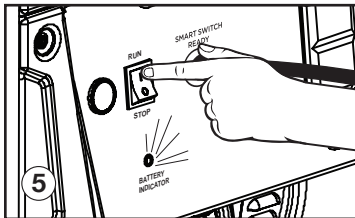
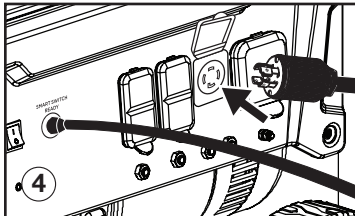
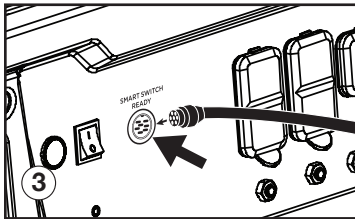
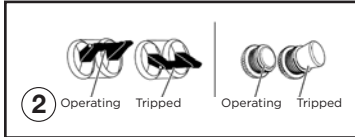
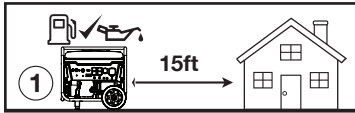

1. Place compatible generator outside in well vented area at least 15ft away from any doors or windows. **NOTE:** Confirm generator works properly, battery is connected, and oil and fuel levels are correct. **Make sure generator is off before connecting ST Switch.**
2. **IMPORTANT:** Confirm breakers on generator and ST Switch are in operating position.
3. Attach one end of the generator control cable to the Smart Switch Ready outlet on the generator.
4. Plug in the L14-30 plug on the generator power input cord to the L14-30R outlet on the generator.
5. Switch the generator engine control switch to RUN and confirm the battery indicator light illuminates on the generators control panel.
6. Place the ST Switch inside away from damp areas. **Do not leave outside.**
7. Plug grounded extension cord (not provided) into household 120V outlet and plug in other end into the utility power input on the ST Switch box. The green utility power indicator will light up.
8. Attach the other end of the generator control cable to the control cable outlet on the ST Switch.
9. Connect the appliances you want to run to the 5-20R 120V 20A outlet on the ST Switch.

OPERATION

HOW IT WORKS



BEFORE USING ST SWITCH PLEASE REVIEW ALL SAFETY INFORMATION AND CONFIRM ST SWITCH AND GENERATOR ARE WORKING CORRECTLY

WHEN UTILITY POWER IS ON:

When home utility power is on it will provide power to the appliances plugged into the 5-20R duplex on the ST Switch box up to 120V at 20A. The green utility power indicator light will illuminate on the ST Switch box when utility power is on. The generator will remain off with the engine control switch in the RUN position and the utility power will charge the battery through the generator control cable. See image below for flow of electricity when utility power is on.

Power -----

No Power -----



MUST BE 15 FEET AWAY FROM HOUSE

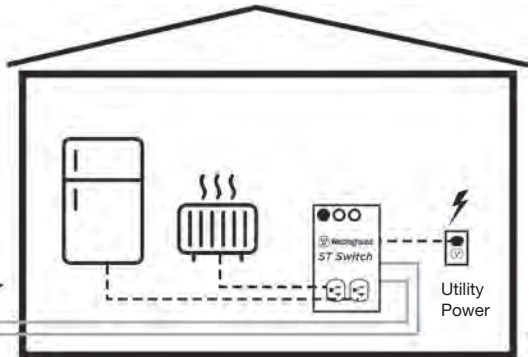

WHEN UTILITY POWER IS LOST:

As soon as utility power is lost the utility loss indicator light will illuminate red. 5-10 seconds after utility loss the ST Switch will turn the generator on. Once the generator has successfully started the ST Switch will transfer input power from utility to generator power. The generator power indicator will illuminate green when appliances that are plugged into the ST Switch are being powered by the generator. The utility loss indicator will remain red as long as utility power is off. See image below for flow of electricity when utility power is off and generator power is on.

Power -----

No Power -----



MUST BE 15 FEET AWAY FROM HOUSE

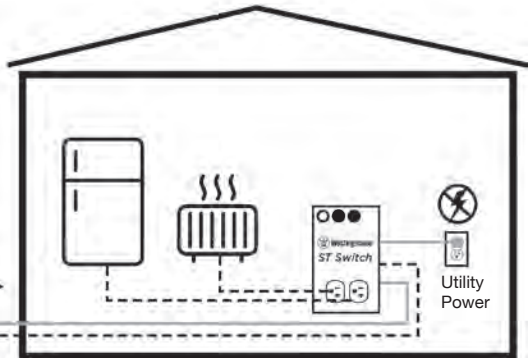





OPERATION

WHEN UTILITY POWER COMES BACK ON:

After an outage when utility power returns the ST Switch will run a quick diagnostic to confirm there are no spikes or flickering in the utility power before transferring input power back to utility. Once utility is returned the red utility loss indicator light will turn off and the utility and generator power indicator lights will remain on. After power has been transferred back to utility power, the ST Switch will allow the generator 45-50 seconds to cool down before shutting it off. Once the generator has shut down the green generator power indicator light will turn off.

NOTE: If utility power is lost during the generator cool down phase the ST Switch will wait a couple of seconds and transfer input power back to generator power until utility power is restored.

ST SWITCH INDICATOR LIGHTS

Lights Displayed	Description
	Input power for appliances plugged into the ST Switch is being provided by utility power.
	Utility power has been lost and there is no power being provided to appliances plugged into the ST Switch. In 5-10 seconds of this light being on the ST Switch will turn the generator on.
	Utility power is off and power to appliances plugged into the ST Switch is being provided by generator.
	Utility power has come back on but ST Switch is running diagnostic to make sure power is steady before transferring. This diagnostic usually takes 5-10 seconds and then the red utility loss light should turn off.
	Generator is in cool down stages before shutting off. This takes 45-50 seconds after the red utility loss indicator turns off.

OPERATION

HOW TO TEST THE ST SWITCH



BEFORE TESTING ST SWITCH PLEASE REVIEW ALL SAFETY INFORMATION AND CONFIRM CORRECT SET UP PROCEDURE

WARNING



The ST Switch **MUST BE TESTED** before use to confirm proper set up and operation. Never leave the ST Switch unattended if you have not first tested to confirm it works correctly. Never exceed the total power output of the utility power. **GENERATOR MUST BE OFF WHEN SETTING UP ST SWITCH.**

1. Start generator following the instructions of the generator owners manual and test to make sure it is operating correctly. Turn generator off once test is complete.
2. With **GENERATOR OFF AND COOL**, correctly set up the ST Switch and generator as outlined in *SET UP* section.
3. Plug a small appliance into the 120V outlets on the ST Switch. Confirm that the appliance is powered on.
4. Unplug the utility power input cord to simulate an outage and confirm that the red utility loss indicator light illuminates.

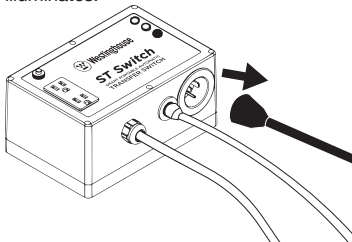

5. Confirm generator starts successfully. Once the green generator power indicator light comes on make sure the appliance is on.
6. Plug the utility power input cord back into the ST Switch and confirm the red utility loss indicator light turns off in 5-10 seconds.

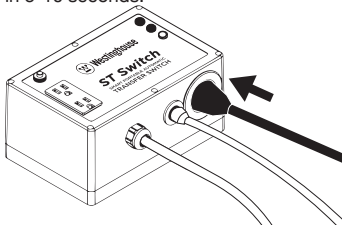

7. Wait 45-50 seconds for generator to cool down and shut off. Confirm generator power indicator light turns off when generator shuts down.

OPERATION

USING EXTENSION CORDS

WARNING



Using damaged or frayed extension cords could result in death or serious injury

It is recommended to use no longer than a 30ft extension cord for utility power. The cord must have a ground and cannot be damaged or frayed.

NEED LONGER GENERATOR CORDS?

WARNING



Never move generator closer to home to compensate for cords/cables being too short. Only use Westinghouse power cable extenders for proper operation. Never use longer than 50ft total of generator control or power cables as it may affect performance.

Westinghouse offers extension cords for generator power input cord and generator control cable. Part numbers are below:

Part Number	Description
3021225C	25' Generator Power Input Cord: 30A 120V L14-30P to L14-30R
STCORD25	25' Generator Control Cable: 7 Pin ST Outlet Connector

STORAGE AND MAINTENANCE

WARNING



Always store in a dry location away from any flammable liquids or materials. Do not store in temperatures lower than 50° F and higher than 95° F

Be sure to test the ST Switch every 6 months to make sure the unit is in good working order.

WARRANTY

ONE YEAR WARRANTY

Warranty Terms

Westinghouse Outdoor Power Equipment LLC warrants its products to be free from defects in materials and workmanship for a period of one year from the date of purchase. The obligation of Westinghouse Outdoor Power Equipment LLC under this warranty is limited to repairing, at its sole discretion, any such defective products. This warranty does not apply to equipment that has been damaged by accident, negligence or misapplication or has been altered or modified in any way. Repair of a defective product or part thereof does not extend the original warranty period. Any parts furnished under this warranty may be new or factory-remanufactured.

Non-Transferable Warranty

This warranty extends only to the original purchaser who must have properly registered the product. The product may be registered at the Westinghouse Outdoor Power Equipment web site: www.westinghouseoutdoorpower.com.

Exclusions

Westinghouse Outdoor Power Equipment LLC shall not be liable under the warranty if its testing and examination disclose that the alleged defect in the product does not exist or was caused by end user or any third person misuse, negligence, improper installation or testing. Further, Westinghouse Outdoor Power Equipment LLC shall not be liable under the warranty for unauthorized attempts to repair or modify wrong or inadequate electrical voltage or connection, inappropriate on-site operation conditions, corrosive atmosphere, repair, installation, start-up by non-Westinghouse Outdoor Power Equipment LLC designated personnel, a change in location or operating use, exposure to the elements, Acts of God, fire, theft, or installation contrary to Westinghouse Outdoor Power Equipment LLC recommendations or specifications or in any event if the Westinghouse Outdoor Power Equipment LLC serial number has been altered, defaced, or removed, or any other cause beyond the range of the intended use.

THERE ARE NO WARRANTIES, EXPRESS OR IMPLIED, BY OPERATION OF LAW OR OTHERWISE, OF PRODUCTS SOLD, SERVICED OR FURNISHED UNDER THIS AGREEMENT OR IN CONNECTION HERewith. WESTINGHOUSE OUTDOOR POWER EQUIPMENT LLC DISCLAIMS ALL IMPLIED WARRANTIES OF MERCHANTABILITY, SATISFACTION AND FITNESS FOR A PARTICULAR PURPOSE. WESTINGHOUSE OUTDOOR POWER EQUIPMENT LLC'S EXPRESS WARRANTIES WILL NOT BE ENLARGED, DIMINISHED, OR AFFECTED BY AND NO OBLIGATION OR LIABILITY WILL ARISE OUT OF, WESTINGHOUSE OUTDOOR POWER EQUIPMENT LLC RENDERING OF TECHNICAL OR OTHER ADVICE OR SERVICE IN CONNECTION WITH THE PRODUCTS. THE FOREGOING WARRANTIES AND REMEDIES ARE EXCLUSIVE AND IN LIEU OF ALL OTHER WARRANTIES AND REMEDIES. THE WARRANTIES SET FORTH ABOVE CONSTITUTE WESTINGHOUSE OUTDOOR POWER EQUIPMENT LLC'S SOLE LIABILITY AND PURCHASER EXCLUSIVE REMEDY FOR ANY BREACH OF SUCH WARRANTIES. WESTINGHOUSE OUTDOOR POWER EQUIPMENT LLC'S WARRANTIES EXTEND ONLY TO PURCHASER AND ARE NOT EXTENDED TO ANY THIRD PARTIES.

WARRANTY

IN NO EVENT SHALL WESTINGHOUSE OUTDOOR POWER EQUIPMENT LLC, ITS OFFICERS, DIRECTORS, AFFILIATES OR EMPLOYEES BE LIABLE FOR ANY FORM OF INDIRECT, SPECIAL, CONSEQUENTIAL OR PUNITIVE DAMAGES, ARISING OUT OF THE USE, SERVICE OR INSTALLATION, OF THE PRODUCTS, WHETHER SUCH DAMAGES ARISE IN CONTRACT OR TORT, IRRESPECTIVE OF FAULT, NEGLIGENCE OR STRICT LIABILITY OR WHETHER WESTINGHOUSE OUTDOOR POWER EQUIPMENT LLC HAS BEEN ADVISED IN ADVANCE OF THE POSSIBILITY OF SUCH DAMAGES. SPECIFICALLY, WESTINGHOUSE OUTDOOR POWER EQUIPMENT LLC IS NOT LIABLE FOR ANY COSTS, SUCH AS LOST PROFITS OR REVENUE, LOSS OF EQUIPMENT, LOSS OF USE OF EQUIPMENT, LOSS OF SOFTWARE, LOSS OF DATA, COSTS OF SUBSTITUENTS, CLAIMS BY THIRD PARTIES, OR OTHERWISE.

NO SALESMAN, EMPLOYEE OR AGENT OF WESTINGHOUSE OUTDOOR POWER EQUIPMENT LLC IS AUTHORIZED TO ADD TO OR VARY THE TERMS OF THIS WARRANTY. WARRANTY TERMS MAY BE MODIFIED, IF AT ALL, ONLY IN WRITING SIGNED BY AN OFFICER OF WESTINGHOUSE OUTDOOR POWER EQUIPMENT LLC.

Warrant Claims

Customers with warranty claims issues may access the Westinghouse Outdoor Power Equipment LLC customer support network through the “Support” page of the Westinghouse Outdoor Power Web site, www.westinghouseoutdoorequipment.com/support.



WestinghouseOutdoorPower.com

Service Hotline: (855) 944-3571

777 Manor Park Drive Columbus, OH 43228

®, WESTINGHOUSE, and INNOVATION YOU CAN BE SURE OF
are trademarks of Westinghouse Electric Corporation. Used under
license by Westinghouse Outdoor Power Equipment.
All Rights Reserved.

Version SPATS1R1KWD