

VEVOR[®]

TOUGH TOOLS, HALF PRICE

Technical Support and E-Warranty Certificate www.vevor.com/support

ICE CREAM MACHINE

MODEL:CKX400PRO-A19-B

We continue to be committed to provide you tools with competitive price.

"Save Half", "Half Price" or any other similar expressions used by us only represents an estimate of savings you might benefit from buying certain tools with us compared to the major top brands and does not necessarily mean to cover all categories of tools offered by us. You are kindly reminded to verify carefully when you are placing an order with us if you are actually saving half in comparison with the top major brands.

MODEL:CKX400PRO-A19-B

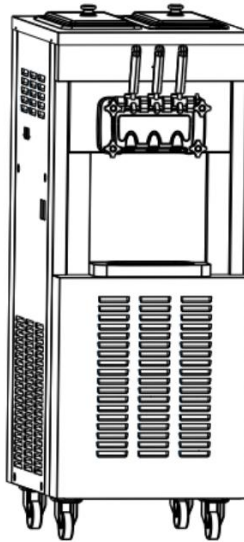

NEED HELP? CONTACT US!

Have product questions? Need technical support? Please feel free to contact us:

Technical Support and E-Warranty Certificate
www.vevor.com/support

This is the original instruction, please read all manual instructions carefully before operating. VEVOR reserves a clear interpretation of our user manual. The appearance of the product shall be subject to the product you received. Please forgive us that we won't inform you again if there are any technology or software updates on our product.



Warning-To reduce the risk of injury, user must read instructions manual carefully.



CORRECT DISPOSAL

This product is subject to the provision of European Directive 2012/19/EC. The symbol showing a wheellie bin crossed through indicates that the product requires separate refuse collection in the European Union. This applies to the product and all accessories marked with this symbol. Products marked as such may not be discarded with normal domestic waste, but must be taken to a collection point for recycling electrical and electronic devices

I . Safety precaution

◆Before using the appliance, please read this user manual to ensure that you gain the maximum benefit from it.

WARNING:

- ◆This appliance is not intended for use by persons (including children) with reduced physical, sensory or mental capabilities, or lack of experience and knowledge, unless they have been given supervision or instruction concerning use of the appliance by a person responsible for their safety.
- ◆Children should be supervised to ensure that they do not play with the appliance.
- ◆This appliance can be used by children aged from 8 years and above and persons with reduced physical, sensory or mental capabilities or lack of experience and knowledge if they have been given supervision or

instruction concerning use of the appliance in a safe way and understand the hazards involved. Children shall not play with the appliance. Cleaning and user maintenance shall not be made by children without supervision.

- ◆ If the supply cord is damaged, it must be replaced by the manufacturer, its service agent or similarly qualified persons in order to avoid a hazard.

- ◆ To avoid a hazard due to instability of the appliance, it must be fixed in accordance with the instructions.

- ◆ When positioning the appliance, ensure the supply cord is not trapped or damaged.

- ◆ Do not locate multiple portable socket-outlets or portable power supplies at the rear of the appliance.

- ◆ Keep ventilation openings, in the appliance enclosure or in the built-in structure, clear of obstruction.

- ◆ Do not damage the refrigerant circuit.

- ◆ Do not store explosive substances such as aerosol cans with a flammable propellant in this appliance.

- ◆ Children aged from 3 to 8 years are allowed to load and unload refrigerating appliances.

- ◆ Note: This appliance contains flammable refrigerant R290 and foaming agent cyclopentane.

- ◆ Please avoid contact fire when you transport and use it.

- ◆ Please ask professional for servicing when the machine broke down.

Please send it to your local appointed disposal station when you discard it.



During using, service and disposal the appliance, please pay attention to symbol similar as left side, which is located on rear of appliance (rear panel or compressor) and with yellow or orange color. It's risk of fire warning symbol. There are flammable materials in refrigerant

pipes and compressor. Please be far away fire source during using, service and disposal.

NOTE:

- ◆ Please keep the water or other conductive liquids away from the machine;
- ◆ Don't stick clubs into the machine;
- ◆ During the movement of the machine, it should be carefully carried at an angle of less than 45 degrees.
- ◆ Prohibit water discharge pipe or water supply pipe from being bend, in order that the pipes are damaged and water leak out from the pipes.
- ◆ The distance between the air outlets and the wall should be more than 20 cm. Besides. keep good ventilation, also, make sure the machine is dry and clean.

Warning:

- ◆ This machine should be operated by professionals or trained personnel;
- ◆ Make sure the machine is reliably connected to the ground in order to keep safe;
- ◆ Use the power which is consistent with the one in the nameplate, and the bias voltage is less than $\pm 10\%$ of rated voltage. The wiring must be done by the professionals;



WARNING

- ◆ The wire must be replaced by the manufacturers or its repair department or workers of the similar field;
- ◆ Before maintaining the machine, make sure you have cut off the power;
- ◆ Don't wet or sprinkle the liquid onto the plugs, motors or other electrical parts so as to avoid electric shock;

◆The materials of the bubble tier are easy to catch fire, so the customers mustn't discard them at random or handle them by themselves. The materials should be recycled and dealt with by some specified departments according to related rules by the country.

WARNING: Changes or modifications to this product not expressly approved by the party responsible for compliance could void the user's authority to operate the product.

Note: This product has been tested and found to comply with the limits for a Class B digital device pursuant to Part 15 of the FCC Rules, These limits are designed to provide reasonable protection against harmful interference in a residential installation.

This product generates, uses and can radiate radio frequency energy, and if not installed and used in accordance with the instructions, may cause harmful interference to radio communications. However, there is no guarantee that interference will not occur in a particular installation. If this product does cause harmful interference to radio or television reception, which can be determined by turning the product off and on, the user is encouraged to try to correct the interference by one or more of the following measures.

- Reorient or relocate the receiving antenna.
- Increase the distance between the product and receiver.
- Connect the product to an outlet on a circuit different from that to which the receiver is connected.
- Consult the dealer or an experienced radio/TV technician for assistance.

II.Exploded Diagram

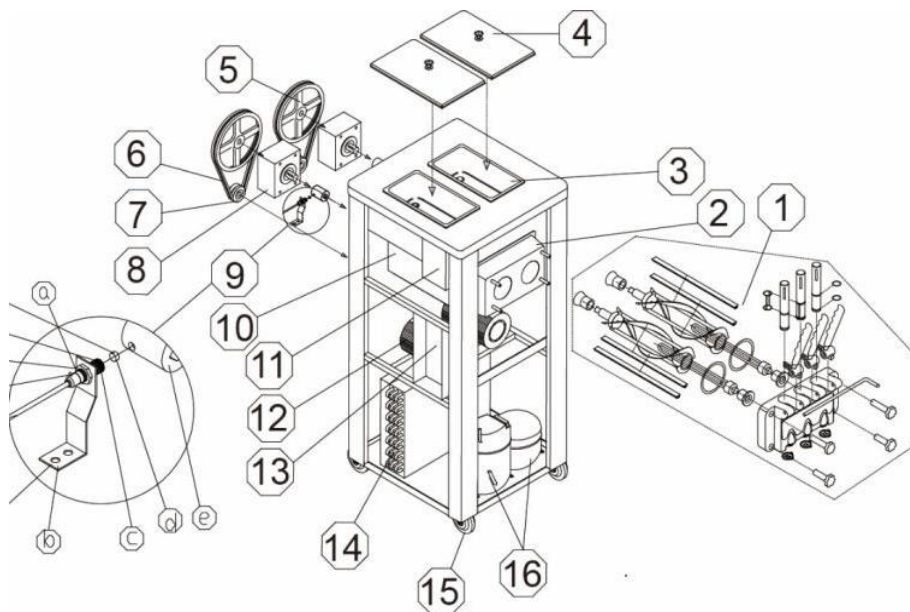

No.	Part name	No.	Part name
1	Dispenser and agitator assembly	9	Proximity switch
2	Dispenser valve seat	10	evaporator
3	Hopper	11	Vertical mixing assembly
4	Hopper cover	12	Beater motor
5	Driven pulley	13	Electric box
6	Belt	14	condenser
7	Drive pulley	15	Caster
8	Gear reducer	16	compressor

III. Installations & Adjusting

A、unpack & inspect

- 1) Open the wooden case by nipper pliers.
- 2) Remove the foam.
- 3) Inspect carefully whether there is defective appearance or not.
- 4) Check the accessories with packing list.

B、Installation

1) SELECTING LOCATION

- a. Place the machine on a level counter that is stable and strong enough to safely support its weight.
- b. Place the machine in a location that allows adequate space at the back and each side for proper ventilation. Keep 50cm space from all sides for ventilation. The machine should be shaded from the sun and should not be located too close to the units that radiate excessive heat.

2) POWER SUPPLY

- a. Select the proper power supply according to the voltage and power on the nameplate.
- b. Connect the power wire and the power supply, ensuring the yellow and green wire was connected with the ground wire firmly.



Caution

- a. For safety, ensure the ground connection is in good condition.
- b. All the exterior wires and other appliances must confirm with national standard.

C、Testing Running

Step 1: Place the main switch in “on” position, you can hear a long sound

“di” and see the corresponding indicating pattern lightens in fluorescent screen.

Step 2: Press the key of “clean”, you can see the corresponding indicating pattern lightens and hear the beater works.

Step 3: Press the key of “auto”, you can see the corresponding indicating pattern lightens as well as hear the beater works. 3 seconds later, the refrigerating system starts to work.

a) Clearing & Sterilizing

Step 1: Prepare 5-6 liters of warm water, mix with food detergent according to manufacturer’s specifications. And this is the sterilizing solution.

Step 2: Pour the solution into the two hoppers. While the solution is flowing into the freezing cylinder, brush and clean the mix hoppers.

Step 3: Press the key of “wash”, and let the machine running for about 5 minutes.

Step 4: Place an empty pail beneath the draw spout and pull down the handle. Draw off all solution.

Step 5: Repeat this operation for 2-3 times with clean water only.



Notice

- a、 The temperature of the sterilizing solution can not overpass 60°C, or else it will damage the spare parts.
- b、 Draw off all the water in the hopper after clearing, or else it will damage the beater while the compressor is running.
- c、 While press the key of “wash”, pay attention to the indicating pattern in order to avoid pressing the wrong key.

D、 Feed Tube Installation

◆ Charge the feed tube with one end having a hole into the hopper, (every time dispensing product, new mix flow into freezing cylinder from small

hole on the tube, while the air flow into the freezing cylinder from tube. This will keep the cylinder properly loaded and maintain overrun).

◆Charge the mix feed tube with the end does not having a hole if necessary, in order to prevent the mix flowing into the freezing cylinders.

No.	Name	
1	Feed Tube Plug	Optional
2	Plug Seal	
3	Feed Tube O-ring	
4	Feed Tube	
5	Feed Hole	



Notice

When adding mix to the hopper tank, please do not flood the top of the feed tube with the mix.

Feed Tube (II) Installation

- a. Place the sealing ring in the groove of the feed joint. Use a small amount of vaseline to lubricate it during installation to facilitate installation.
- b. Insert the inner tube of the feed tube into the outer cylinder of the feed

tube in the direction shown in the figure. Pay attention to the alignment of the air inlet and feed hole of the inner tube and the outer cylinder.



c. Insert the outer cylinder of the feed tube into the feed port in the barrel. When using the feed tube, you can adjust the size of the feed hole and air inlet by rotating the inner tube to adjust the overrun rate of the ice cream.

Note: When adjusting the aperture size of the feed tube, do not completely block the feed port and air inlet to prevent the machine from freezing due to lack of material in the refrigeration cylinder.

No.	Name	
1a	Air inlet	
2	Expanded tube	
3a	Feeding inlet	
1b	Air inlet	
4	Extruder tube	
3b	Feeding inlet	
5	O-ring	

IV. Operation Instruction

A. Key Instruction

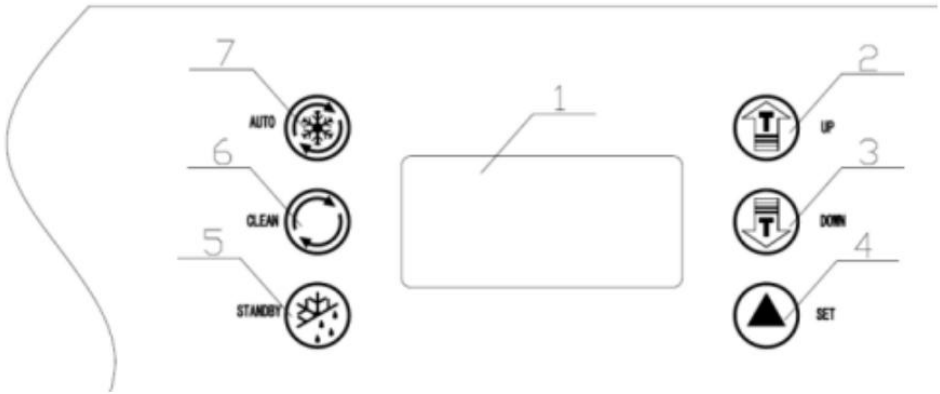

1—digital displayer	5—keep fresh key
2—adjust key (up)	6—clean key
3—adjust key (down)	7—auto key
4—set up	

a. Hardness setting

In the mode of standby or working, Press the “” or “” key, hold for 2 seconds, the hardness setting number flashes, just press “” or “” to adjust the hardness level(range: 1-10), if you don’t operate “” or “” within 5 seconds, the hardness level will stop flashing, Automatically go back to the hardness level that set and reserve the value.

b. Test on line

In the mode of cleaning, Press the “CLEAN KEY”, the digital screen will display “END” which means it has tested the speed. And the buzzer beeps and saves the speed value.



Cup number display:

In the mode of standby, long press “” 5S, enter the cup number query interface, the display hardness percentage digital tube is thousands of digits, the display gear position display window digital tube is ten digits, automatically return to standby after 10 seconds.

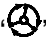

c. Clean

In the standby mode, press the  key then the “Clean” indicator shines, Clean pattern is in the dynamic rotate mode, the whole machine comes to the “Clean” mode, the beater motor begin to work, press the key, the clean pattern is off and stop rotating, the beater motor stop working, exit the Clean mode and the standby pattern is on.

d. Standby

Press ”, “STANDBY” and “FRESH” key are on, the display hardness percentage display window shows the cylinder temperature, the display gear display window shows the temperature of the hopper, press “ ”, “STANDBY” and “FRESH again” ” key is off

e. Auto

Press ”, “AUTO” and “FRESH” key are on, the display gear display window displays the gear position, the display hardness percentage window is from “00” to “99”, then press ”, “AUTO” and the “FRESH” key is off.

B. Fault and Alarm Description

a、 When the temperature sensor is open, the hardness percentage window of the display screen flashes alternately the "RL" (cylinder)/ "bL" (mix hopper) alarm, and the buzzer stops buzzing after the intermittent buzzer of 5S. The temperature control sensor is normal, and the alarm state is cancelled.

b、 When the temperature sensor is short-circuiting, the hardness percentage window of the display screen flashes alternately to display "RH" alarm (cylinder)/ "bH" (mix hopper), and the buzzer stops buzzing after 5S. The temperature control sensor is normal, and the alarm state is cancelled.

c、 In the mode of auto, when the temperature of left or right cylinder is

lower than the setting temperature of too low temperature, the hardness percentage window of the display screen displays "LL" (parameter F5), and the corresponding cylinder stops working.

d、 In the process of automatic or cleaning, when the rotation speed of left or right cylinder is 0 (that is the switch is open), the hardness percentage window of the display screen displays "--", the whole machine stops, the buzzer keeps ringing, and the alarm state can only be lifted when the power is on again after troubleshooting.

e、 In the automatic or cleaning process, when the rotation speed of the left or right cylinder is too low, the hardness percentage window of the display screen will display low "nL", the whole machine will stop and the buzzer will keep ringing, and the alarm state can only be cancelled after the fault is removed and the power is switched on again.

f、 The discharging switch is open for too long, the hardness percentage display window shows "Cb", the buzzer buzzes, and the whole machine stops.

g、 Under automatic state and overnight state, when there is a mix shortage in the mix hopper, the hardness percentage of the display screen and the window percentage of the display screen will be displayed alternately (left)/ the display window tap position and the CL position will be displayed alternately (right).

h、 Voltage level alarm



A. When the voltage is 252V (C5), the display screen displays "UH" alarm, and the buzzer sounds intermittently.

B. When voltage and low voltage is 187V (C6), the display screen displays "UL" alarm, and the buzzer sounds intermittently.

i、 Poor or not refrigeration, machine refrigeration timeout (1 hour), the display screen displays "ERR", the buzzer intermittent buzz.

C. The method of making ice cream

1. Pour the mix into the mix hopper, and make sure there isn't any big solid in the mix so that the mix can flow into the freezing cylinder from the inlet hole of the feed tube smoothly.

2. Press , the machine will run in auto position; or press  first and let the mix even agitates, then press the key of "auto".

◆ **SETTING FIRMNESS:** Pressing "UP" or "DOWN" button till the number "SET" on the display screen flashes and the number "SET" indicates the setting point of hardness, don't set a high level for the first setting, start from level 2, if the ice cream is too soft, press "UP", till the hardness is appropriate.

◆ The hardness level on the display screen can be observed while the machine is working, the number increases gradually, and when the hardness reaches 95% of setting value, the machine will stop working, then ice cream is ready to serve.

◆ Draw off ice cream. Put a cone under the dispensing door, pull down the handle, the ice cream draw off, after the cone is full of ice cream, push back the handle, it will stop drawing.



V. Use & Maintenance

Different machines must be used and maintained according to their different using conditions and environment conditions.

◆ **Washing refrigeration cylinders**

Clean the refrigeration cylinders once everyday for a longer useful life and for the health of customers.

A. Cleaning methods are as follow:

- Press , draw off all the rest mix in the refrigeration hoppers, and then press .
- Prepare two gallons of approved sterilizing solution, and pour the

solution into the hoppers.

- Press , and let the beater works for five minutes, draw off all the sterilizing solution.
- Repeatedly clean the hopper with rinse water for two to three times as above.
- Turn off the power, take apart and wash the parts.

a, unscrew the four fastening screws in front of the dispensing door, remove the dispenser door;

b, remove the components as follow: pin of handle, handle, piston, O-ring for piston and O-ring for dispenser door from the dispenser door;

c, draw the beater from the refrigeration cylinder, then remove the gasket for beater.

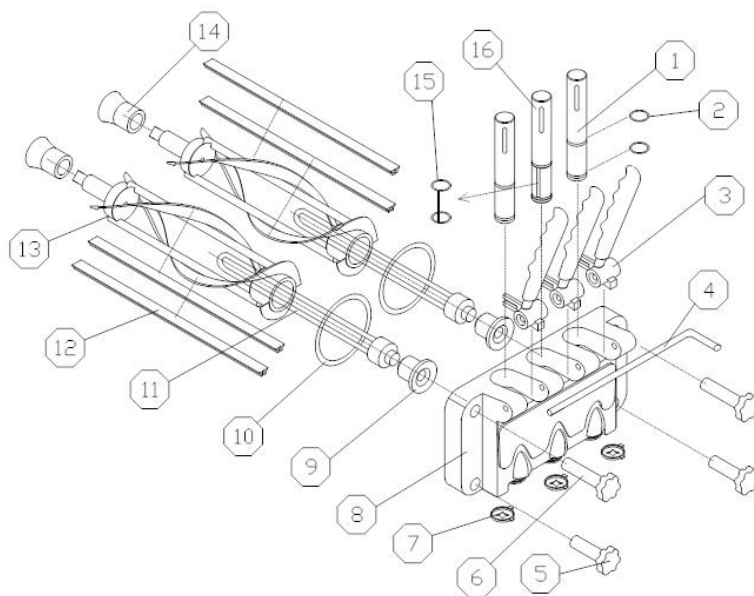

1.Piston	9.supporting sleeve
2.O-ring for piston	10.gasket for dispensing valve
3.Handle	11.flow plug
4.pin of handle	12.blade

5.screw nut (down)	13.beater
6.screw nut (up)	14.gasket for beater
7.Modelling cap	15.New design middle piston O-ring
8.dispensing valve	16.New design middle piston

d, put the components into disinfecting solution to clean, check the beater, gasket for beater, O-ring for dispensing door, supporting sleeve and O-ring for piston, if they are worn oldy, they should be replaced;

e, After cleaning, lubricate the parts with Vaseline, then install the parts according to the method of taking apart.

Notice: Before installing the piston, O-ring for piston, beater and gasket for beater, you should lubricate Vaseline (lubricating Vaseline onto the groove of the gasket, do not onto the beater's end), using the Vaseline frequently can extend the serving life of components.

B.Cleaning machine cabinet

Keep the machine cabinet clean, use wet towel to clean the cabinet, and do not flush the machine with water directly.

C.Cleaning condenser

After being used over a period of time, the condenser maybe thick with dust, and this will affect radiating heat and cause refrigeration difference, so it needs periodic cleaning (every half year)

Cleaning methods:

Step 1: Disconnected the main power switch.

Step 2: Remove the back panel and side panels.

Step 3: Clean dust with tools such as vacuum cleaner, high-pressure air and hairbrush, be careful while cleaning to avoid damaging the fins of the condenser.

D.Belt adjustment

After be used over a period of time, the belt of the machine maybe elongated, so it needs to be adjusted. Disconnected the main power of the machine, remove the back panel and side panels, adjust the tension bolt of beater motor and make sure the belt is in appropriate tension.

VI.Trouble Shooting Guide

Problems	Probable cause	Remedy
Machine does not run	Machine is not plugged into the wall receptacle	Plug machine in
	The circuit breaker switch is open	Find and solve the problem, then restart machine
	Protect circuit	Remove the trouble and restart machine
Machine in clean position does not run	The tie wire of function switch is unfastened	Check and fasten the wire.
	The beater motor broke	Repair or change the beater motor
	The circuit breaker switch is open	Find and solve the problem
Machine in clean position does not run	The tie wire of function switch is unfastened.	Check and fasten the wire.
	There is some problem with control panel.	Replace the control panel.

Compressor does not run	Low voltage	Solve the problem of low voltage
	Contactor broke	change contactor
	The relay of the compressor broke	Change the relay.
	There is some problem with control panel.	Change the control panel.
	The self-protection of the compressor because of overload.	Find and solve the problem
	The compressor broke	Change the compressor
	The capacitor of the compressor broke	Change the capacitor
Machine do not freeze down	Leakage of the refrigerant	Find and repair the leak in the pipe, then vacuum and recharge the refrigerant
	Solenoid valve broke	Change the solenoid valve
	Fan motor do not run	Repair or change the fan motor
	The capacitor of the fan motor broke	Change the capacitor of fan motor
Machine non-stop	The setting value of hardness is too low	Increase the setting value
	There is some problem with control panel.	Change the control panel
	Bad cooling	Check and repair the refrigerating system

Product does not dispense	The proportion of mix is incorrect, and causes the freezing cylinders frozen	Make up a proper proportion of mix.
	No mix in the hopper	Pour the mix into the hopper
	Limited switch broke or the tie wire is unfastened.	Change the switch or fasten the wire
	The belt is unfasten or skid around	Change or adjust the belt
	The bearing sleeve or the beater shaft is worn	Change the bearing sleeve or the beater shaft.
The product too soft	The proportion of the formula is wrong	Compound the mix according to the formula given by the supplier.
	The setting hardness is too low	Increase the setting value
Leakage	Drawing piston leaking	Reassemble or change the O-ring.
	Dispensing door leaking	Tighten the screws or change the O-ring
	Drip tray leaking	Fix well or change the gasket for beater
Buzzer rings	Low voltage protection	Stop the machine, solve the problem and restart 5 minutes later.

	Stop working for protection	Stop the machine, solve the problem and restart 5 minutes later.
--	-----------------------------	--

VII.Schematic wiring diagram

- Technology parameters are on the nameplate
- The electrical schematic diagram is on the board inner

Address: Baoshanqu Shuangchenglu 803long 11hao 1602A-1609shi
Shanghai

Imported to AUS: SIHAO PTY LTD, 1 ROKEVA STREETEASTWOOD
NSW 2122 Australia

Imported to USA: Sanven Technology Ltd. Suite 250, 9166 Anaheim
Place, Rancho Cucamonga, CA 91730



SHUNSHUN GmbH
Römeräcker 9 Z2021,76351
Linkenheim-Hochstetten, Germany
euvertreter@gmail.com
+49 1727041930



Pooledas Group Ltd
Unit 5 Albert Edward House, The
Pavilions Preston, United Kingdom
pooledas123@gmail.com
01772418127

Made In China

VEVOR[®]

TOUGH TOOLS, HALF PRICE

Technical Support and E-Warranty Certificate

www.vevor.com/support