





-  Power
-  Fault
-  Charge
-  AC Output

USER MANUAL

Skysword Electric Vehicle AC Charger

CONTENT

IMPORTANT SAFETY INSTRUCTIONS	1
WARNING	2
PRODUCT DESCRIPTION	3
CHARGING YOUR VEHICLE	3-4
LED LIGHTS INSTRUCTIONS	5
PRODUCT SPECIFICATIONS	6
WARRANTY AGREEMENT	7

IMPORTANT SAFETY INSTRUCTIONS

Please read these Important Safety Instructions and the charging instructions in your vehicle owner's manual before charging your electric vehicle. Failure to do so can result in death or serious injury. Save this user manual for future reference. There are many safety features built into the charger. Read all the safety information and warnings in this manual to be aware of any hazards and risks associated with using this charger.

WARNING

When using electric products, basic precautions should always be followed. This manual contains important instructions, including the following, that must be followed during installation, operation and maintenance.

- ⚠ Do not install or use the charger near flammable, explosive, corrosive, combustible materials, chemicals, or vapors.
 - ⚠ Turn off the input power of the charger before maintaining the charger.
 - ⚠ The device is designed only for vehicles that are compatible with the SAE J1772 standard.
 - ⚠ Do not use the charger if it is defective, appears cracked, frayed, broken or damaged.
 - ⚠ Do not attempt to open, disassemble, repair, tamper with, or modify the charger. Contact our Customer Service for any requirement of repairing.
 - ⚠ Do not use the charger when the charger is exposed to severe rain, snow, or other severe weather.
 - ⚠ When transporting the charger, handle with care and do not drag or step on the device.
 - ⚠ Do not touch the charging connector terminal with sharp metallic objects for preventing damage.
 - ⚠ Do not forcefully pull the charging cable, damage it with sharp objects, put fingers, or insert foreign objects into any part of the charging connector.
- Incorrect installation and testing of the charger could potentially damage either the vehicle's battery and/or the device itself. Any resulting damage is excluded from the warranty for the device.
- ⚠ Do not use this charger with a frayed charging cable that has damaged insulation or any other sign of damage.
 - ⚠ Ensure that the charging cable is well positioned during charging, so it will not be stepped on, tripped over, or subjected to damage or stress.
 - ⚠ Risk of electric shock. Do not remove cover or attempt to open the enclosure of the device. No user serviceable parts inside. Refer servicing to qualified service personnel
 - ⚠ According to the local electrical requirements, confirm the wire diameter and wire type corresponding to the current rating and the temperature rating must meet the requirements.

PRODUCT DESCRIPTION

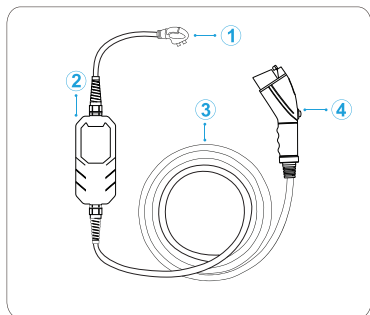

- ① Optional Plug
N6-20/N5-15/N10-30
N14-30/N14-50/N6-50
- ② Control Box
- ③ Charging Cable
- ④ SAE J1772 Connector 

CHARGING YOUR VEHICLE

⚠ Please Note Before Start Charging

- Make sure that the charger is free from any abnormal conditions, such as laceration, rust, rupture, breakage of charging ports, cables, control boxes, wires, and plug surfaces.
- Please do not use this charger if the socket is damaged, rusted, cracked, or loosely connected. Do not start using if the plug is dirty or wet.
- Wipe with a clean and dry cloth to make sure it is dry and free of dirt.
- Make sure that the plug at the power supply end is consistent with the power supply socket before charging.

How to start charging

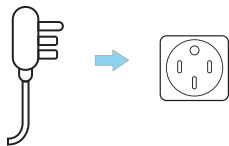

(1) Insert the plug in

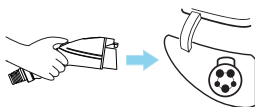

(2) Connect the charging connector to the ev

1. Firmly insert the power plug into the outlet.
2. Take off the cap and then insert the charger connector into your vehicle.

How to stop charging

When charging has completed, unplug the power plug.

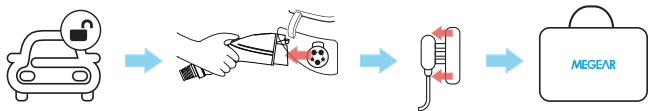

1. Unlock the vehicle.
2. Press the button and pull the charger connector out of your vehicle.
3. Pull the plug out.
4. Put the charger into the carry case.

LED LIGHTS INSTRUCTIONS

Condition	Power (Green)	Fault (Red)	Charge (Green)	AC Output (Green)
Initial Status	On	Flash 2s	Flash 2s	Flash 2s
Ready for Charging	On	Off	Off	Off
Contact	On	Off	On	Off
Charging	On	Off	Flash 0.5s	On
Charge Complete	On	Off	Off	Off
NG1: AC Voltage Error	On	Flash Once	Off	Off
NG2: AC Current Error	On	Flash Twice	Off	Off
NG3: CP Function Error	On	Flash 3 Times	Off	Off
NG4: Leakage Error	On	Flash 4 Times	Off	Off
NG5: FG/PE Error	On	Flash 5 Times	Off	Off



NOTE: Charging will not be interrupted when FG/PE error occurs, please contact your electrician to check the ground wire.

PRODUCT SPECIFICATIONS

Rated Input Voltage	100-265Vac
Output Current	16A
Max. Output Power	3.84KW
Input Frequency	50-60Hz
Meets Standards	SAE J1772
LED Indicator	Green/Red
Operation Temperature	-30°C to +50°C
Storage Temperature	-40°C to +85°C
Working Humidity	5%~95% No condensation
Working Altitude	≤2000m
Multiple Protection	Leakage Protection Over-Voltage Protection Under-Voltage Protection Lightning Protection Overheat Protection Over-Current Protection Grounding Detection
Ground Fault Detection	When ground fault is detected,the red indicator light will flash.The charging function will still work.

WARRANTY AGREEMENT

1. The scope of warranty refers to the product itself.
2. The warranty period is 12 months. During the warranty period, the company will repair the product free of charge in case of failure or damage (determined by the company's technical personnel) under normal use.
3. The starting time of warranty period is the date of product purchase.
4. Even in the warranty period, a certain maintenance fee will be charged in case of the following situations
 - Equipment failure caused by not following the user's manual.
 - Equipment damage caused by fire, flood, abnormal voltage, etc.
 - Equipment damage caused by using the product for abnormal functions.
 - Equipment damage caused by foreign matter entering.
 - Equipment damage caused by other human external factors.
5. If you have any questions, please contact customer@menewenergy.com

