

RUKKET ARMD BATTING TEE ASSEMBLY INSTRUCTIONS

Our video instructions provide the best guidance for setting up your Rukket ARMD Batting Tee.
They can be viewed online at



Please call us if you have any questions or concerns at **1-855-4RUKKET**
Please read our product safety warnings before setup

PARTS INCLUDED

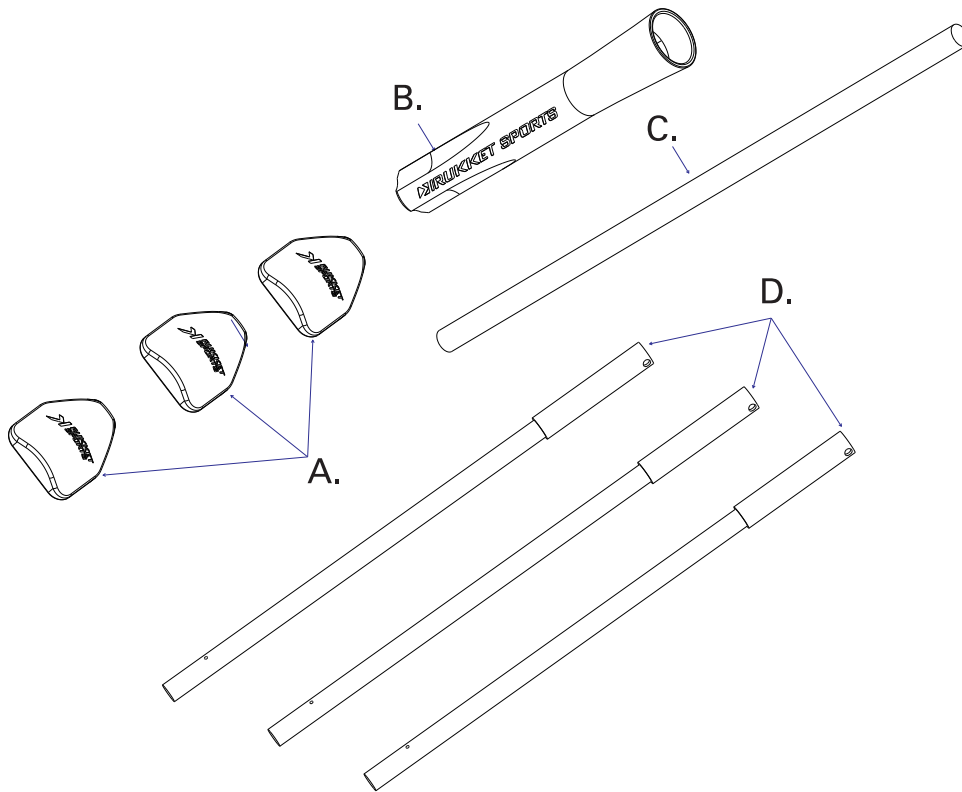

- A. Foot Pads
- B. Rubber Tee Head
(Replaceable Part)
- C. Fiberglass Rod for
Rubber Tee Head
- D. Leg Poles

QUESTIONS? GIVE US A CALL! (1-855)-478-5538



RUKKET ARMD BATTING TEE

ASSEMBLY INSTRUCTIONS

1

To deploy your ARMD Batting Tee, stand it upright on the silver metal attaching collar and splay out the three legs until they lock into place. To unfold the legs, hold onto the red aluminum pipe with one hand while pushing a leg down. Be careful to keep your fingers away from the pinch-points on the base when folding the legs.

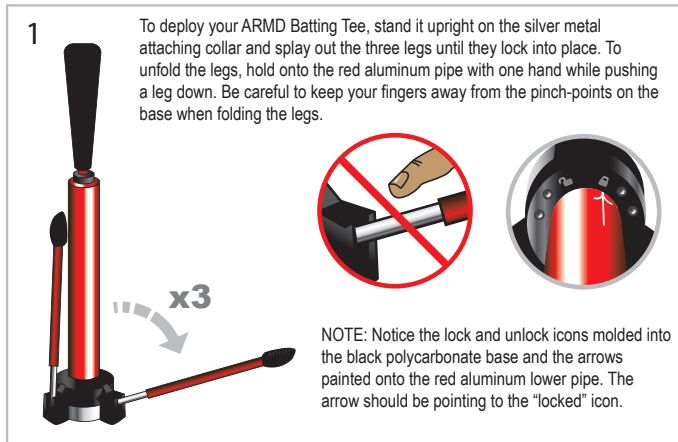

NOTE: Notice the lock and unlock icons molded into the black polycarbonate base and the arrows painted onto the red aluminum lower pipe. The arrow should be pointing to the "locked" icon.

2

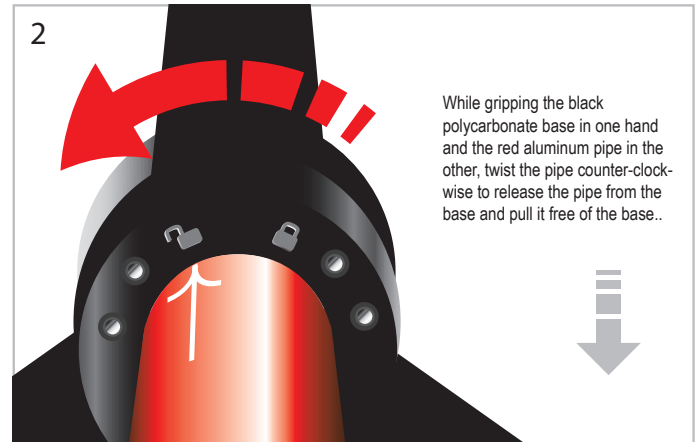

While gripping the black polycarbonate base in one hand and the red aluminum pipe in the other, twist the pipe counter-clockwise to release the pipe from the base and pull it free of the base..

3

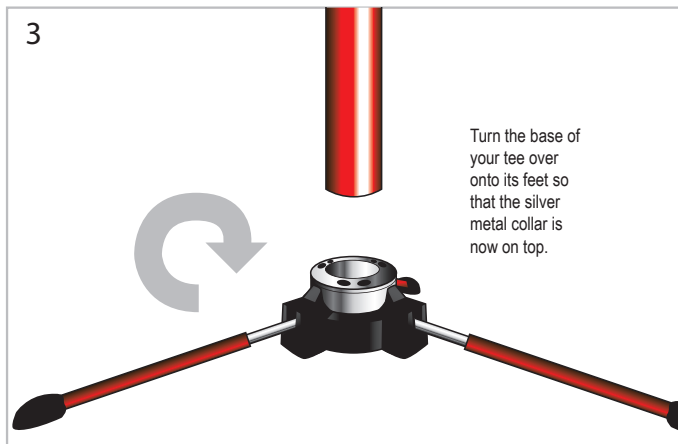

Turn the base of your tee over onto its feet so that the silver metal collar is now on top.

4

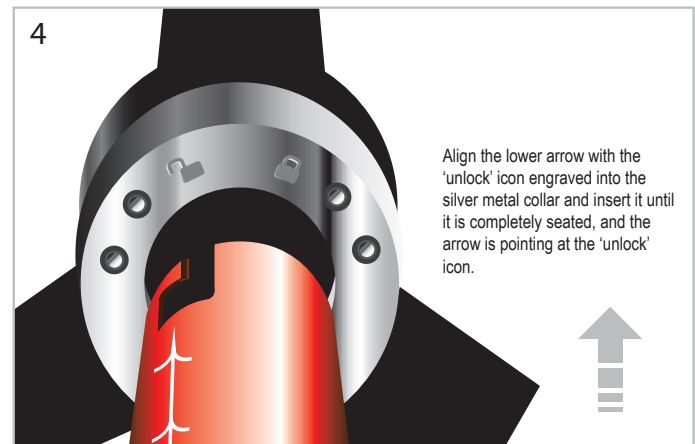

Align the lower arrow with the 'unlock' icon engraved into the silver metal collar and insert it until it is completely seated, and the arrow is pointing at the 'unlock' icon.

5

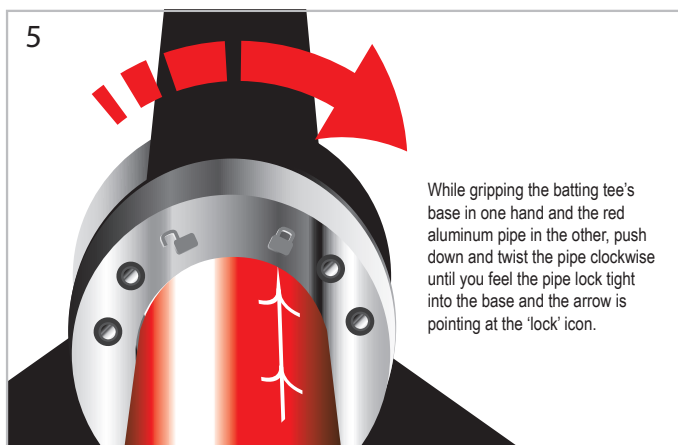

While gripping the batting tee's base in one hand and the red aluminum pipe in the other, push down and twist the pipe clockwise until you feel the pipe lock tight into the base and the arrow is pointing at the 'lock' icon.

6

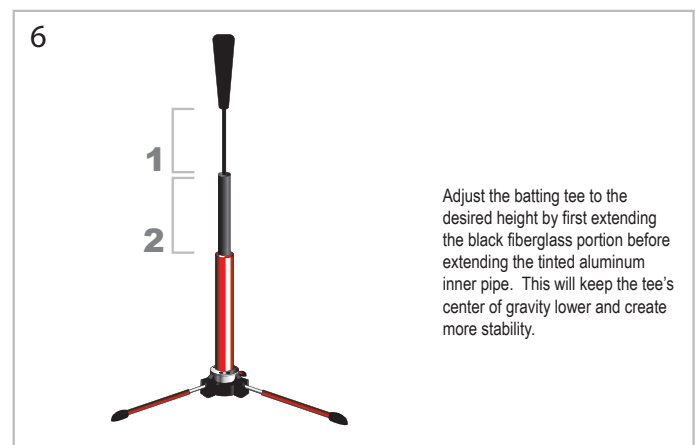

Adjust the batting tee to the desired height by first extending the black fiberglass portion before extending the tinted aluminum inner pipe. This will keep the tee's center of gravity lower and create more stability.

QUESTIONS? GIVE US A CALL! (1-855)-478-5538

RUKKET
SPORTS

RUKKET ARMD BATTING TEE

STOWING INSTRUCTIONS

1

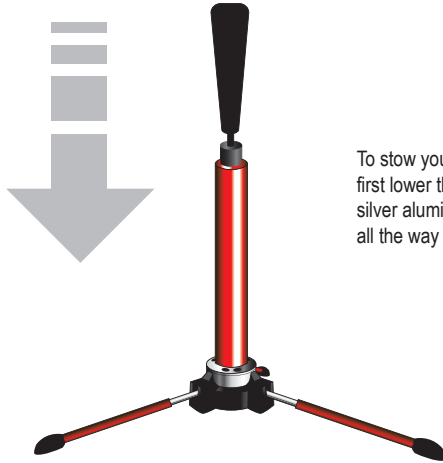

To stow your ARMD Batting Tee, first lower the fiberglass and tinted silver aluminum pipe extensions all the way down.



While gripping the tee's base and red aluminum pipe, push down and twist the pipe counter-clockwise until you feel it loosen internally, and the arrow is pointing at the 'unlock' icon.

2

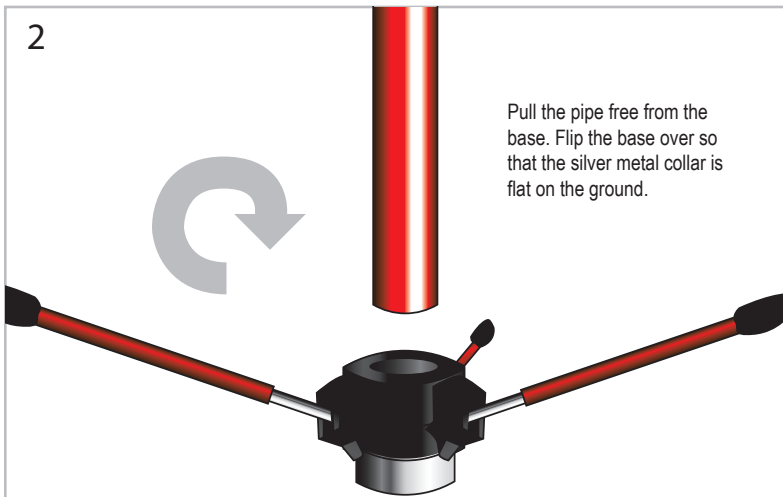

Pull the pipe free from the base. Flip the base over so that the silver metal collar is flat on the ground.

3

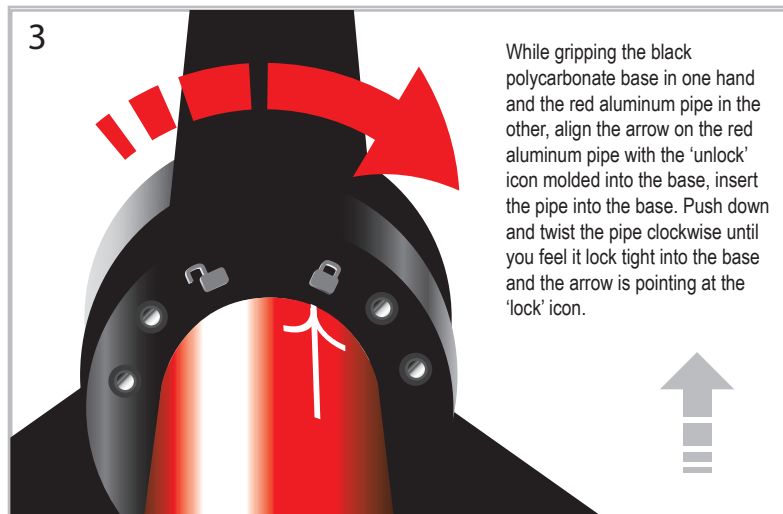

While gripping the black polycarbonate base in one hand and the red aluminum pipe in the other, align the arrow on the red aluminum pipe with the 'unlock' icon molded into the base, insert the pipe into the base. Push down and twist the pipe clockwise until you feel it lock tight into the base and the arrow is pointing at the 'lock' icon.

4

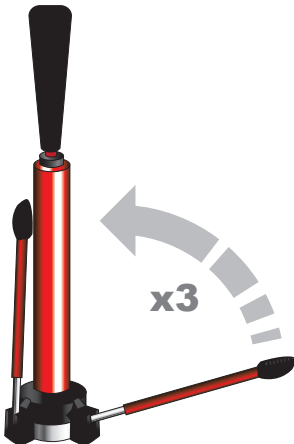

When folding the legs back up, hold onto the red aluminum pipe with one hand while folding the leg with another. Be careful to keep your fingers away from the pinch-points on the base when folding the legs back. Pull up on the three self-locking legs to unlock them and fold them up along the pipe.



WARNING! It is very important that the pipe is locked securely into the base before you attempt to move it, as the base is very heavy and can cause injury or damage if it becomes unattached and falls from the upper portion when you are holding it!



NOTE: To keep your ARMD Batting Tee in top shape, keep it out of inclement weather and lubricate the leg joints from time to time with a drop of machine oil.

QUESTIONS? GIVE US A CALL! (1-855)-478-5538

RUKKET
SPORTS