

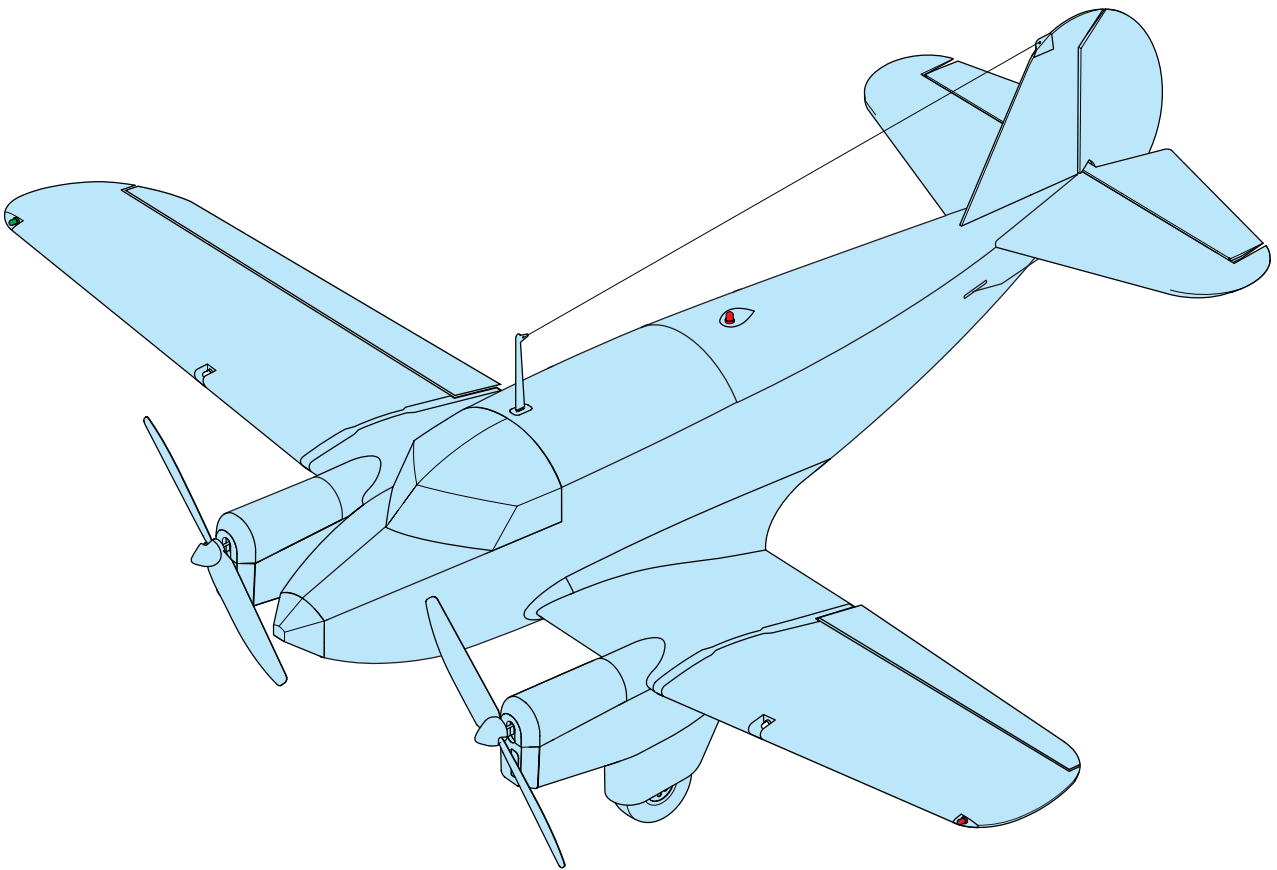

# LED Installation Guide

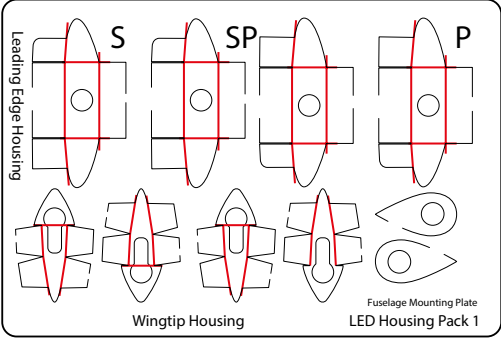

**LED HOUSING PARTS**



**LENSE PARTS**

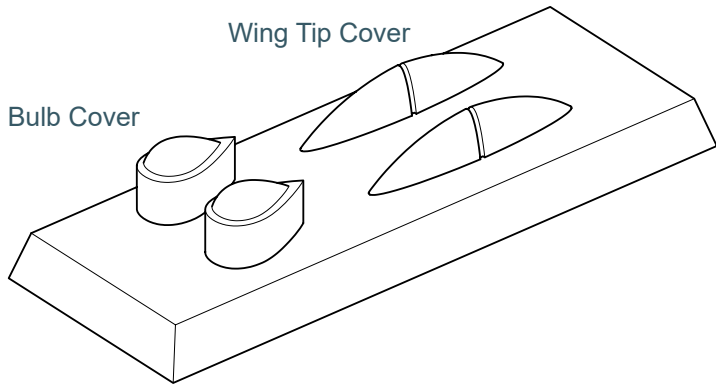

**CLEAR PARTS**

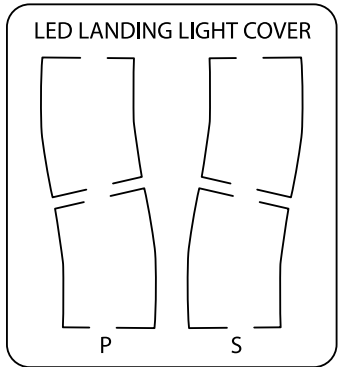

**LOOSE PARTS**

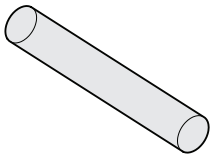

1 x 5mm Ø x 140mm plastic tube (Clear)

# STAGE 1 ANTI COLLISION LIGHT

**i** From page 31 of main Assembly Guide

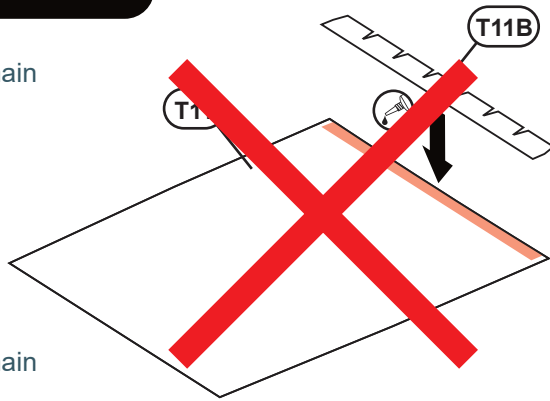

Do NOT attach T11 until Stage 8 in this guide.

**i** From page 32 of main Assembly Guide

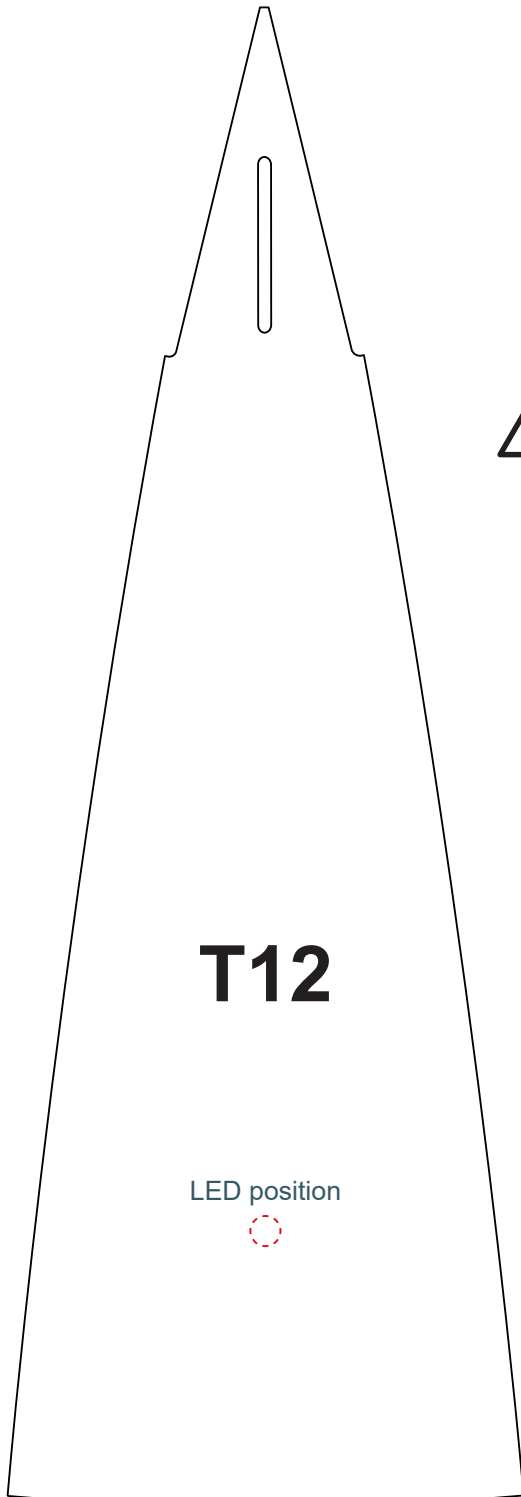

Drawn to scale

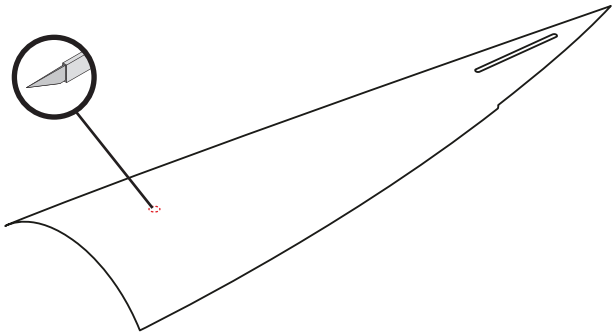

See Important Information on gluing Tyvek before proceeding

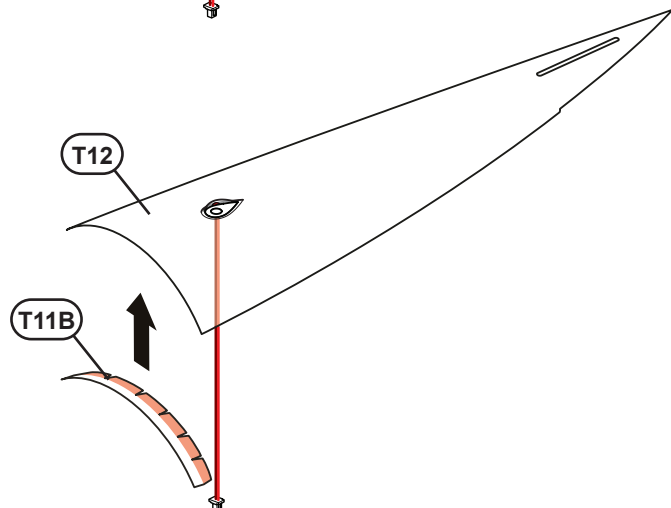
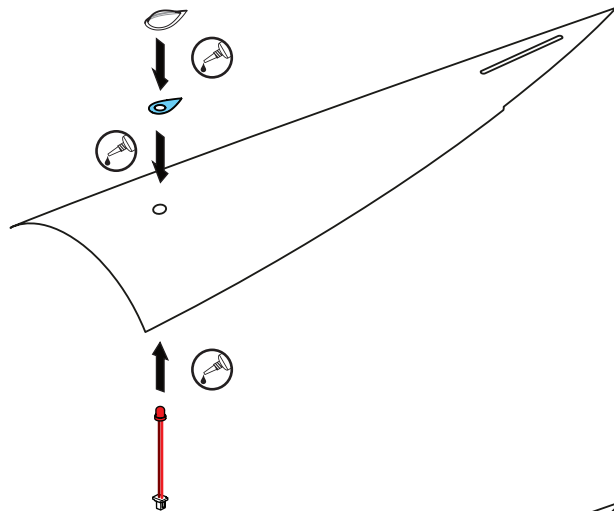

**STAGE 1 ANTI COLLISION LIGHT**

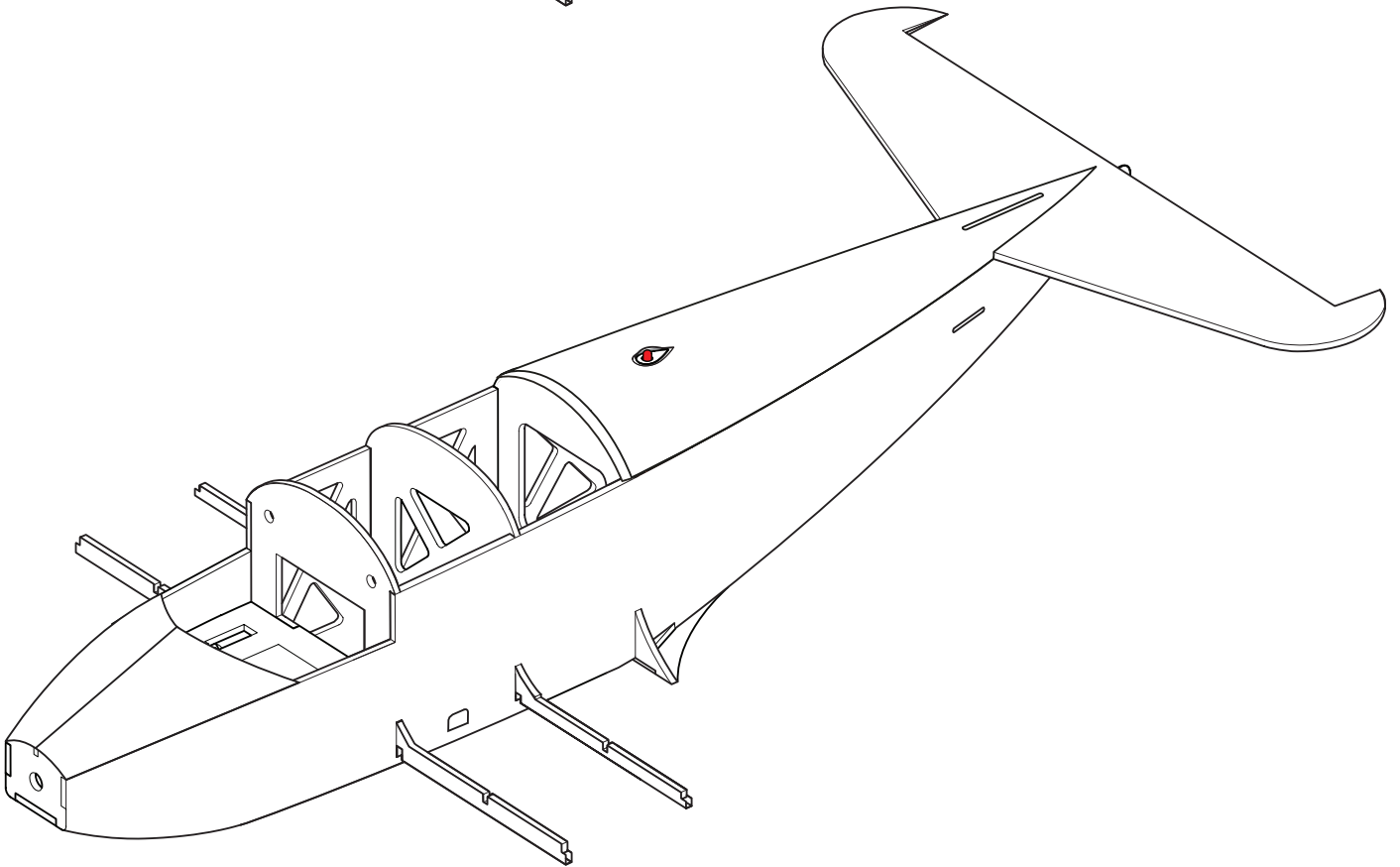
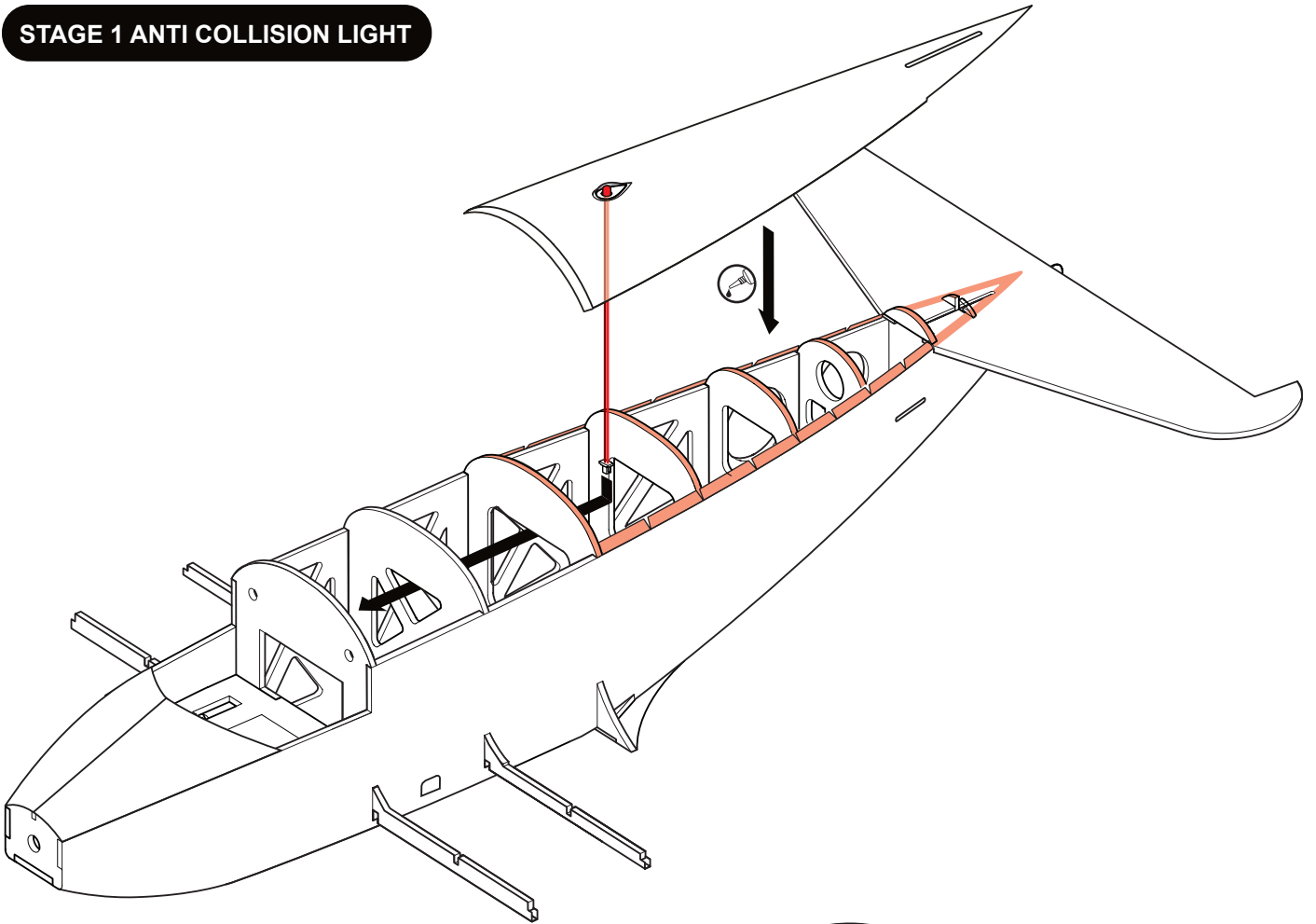

Return to page 33 of main Assembly Guide

## STAGE 2 CABLE INSTALLATION

 From page 33 of main Assembly Guide

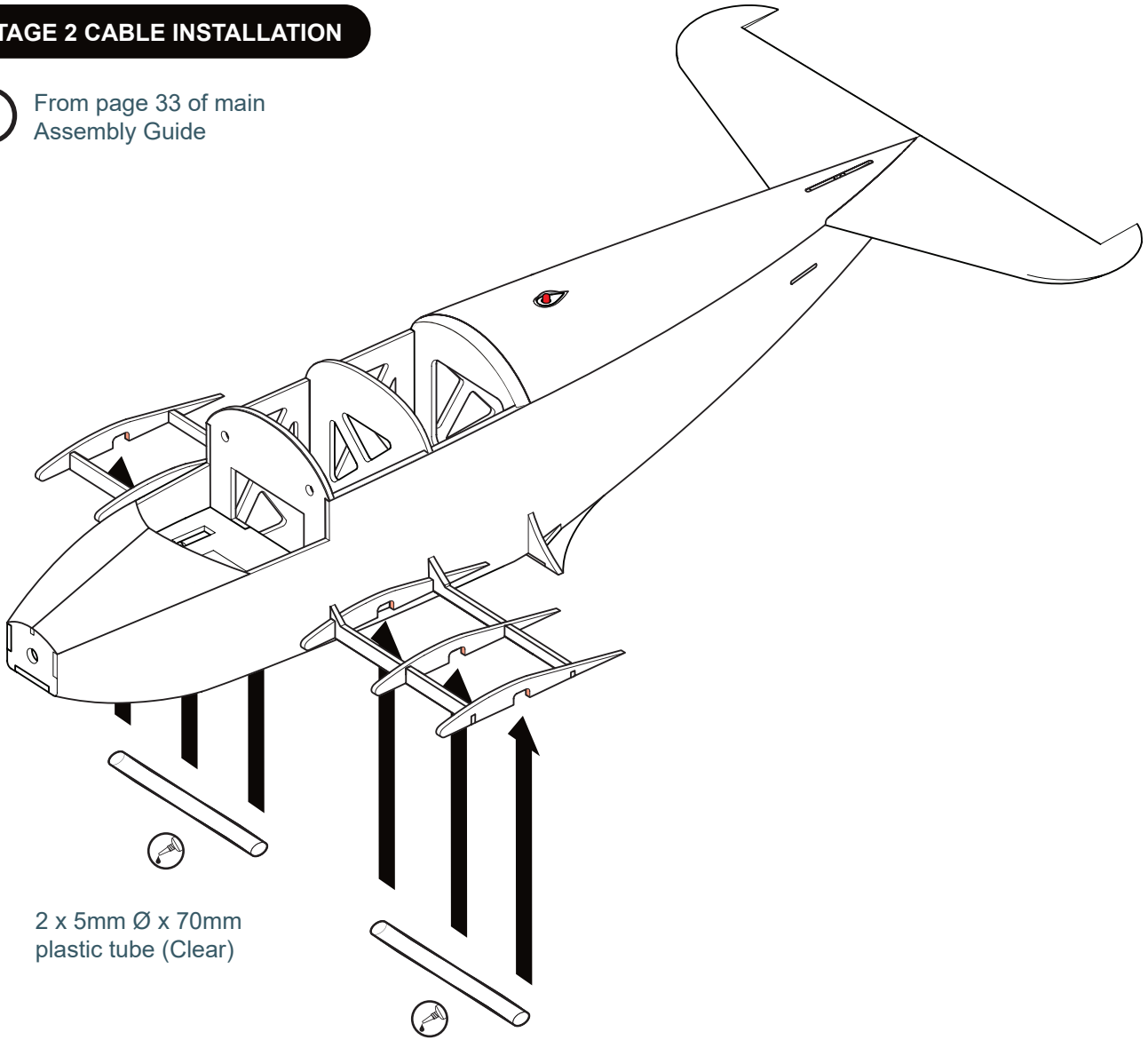

\*  Run motor extension cables **OUTSIDE** of the plastic tube. Run servo 'Y' cable **INSIDE** plastic tubes.

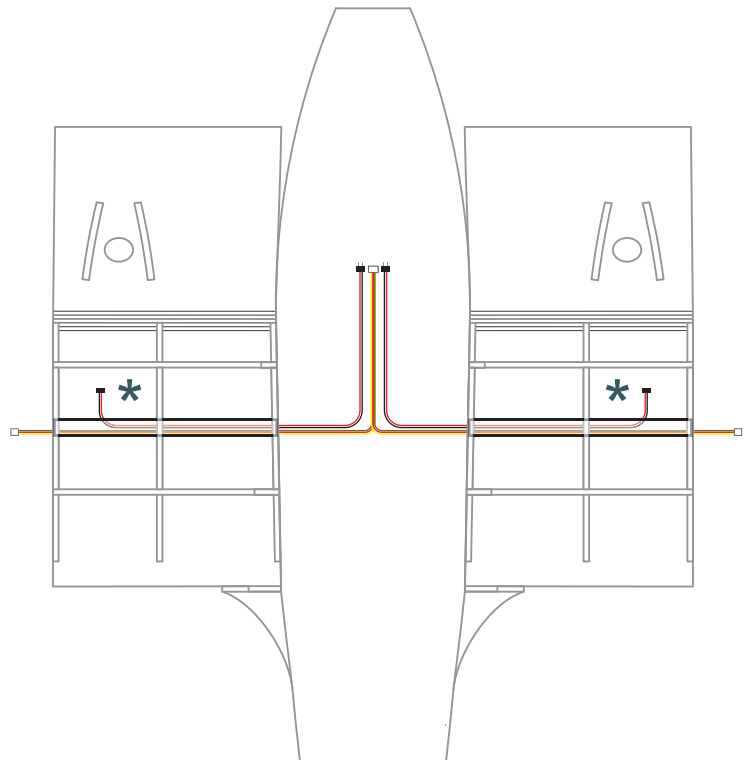

 Return to page 34 of main Assembly Guide

### STAGE 3 NAVIGATION LIGHTS

**i** From page 43 of main Assembly Guide

Wingtip Housing

**i** Starboard side illustrated

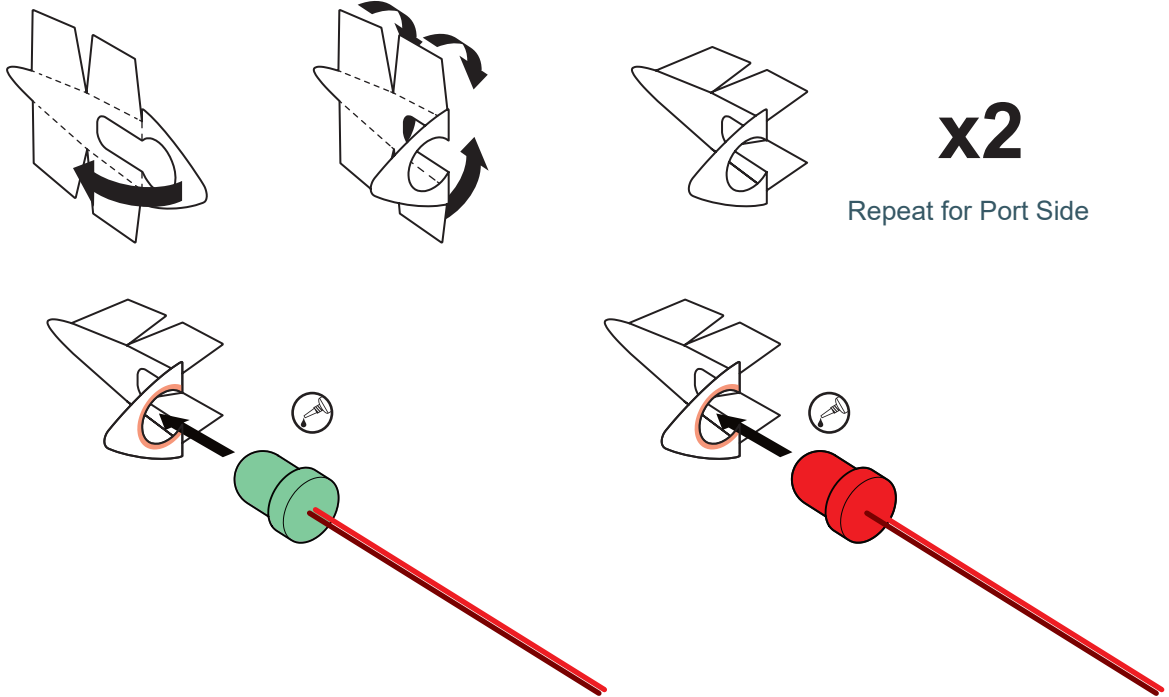

### STAGE 4 LANDING LIGHTS

Leading Edge Housing S

**i** Starboard side illustrated

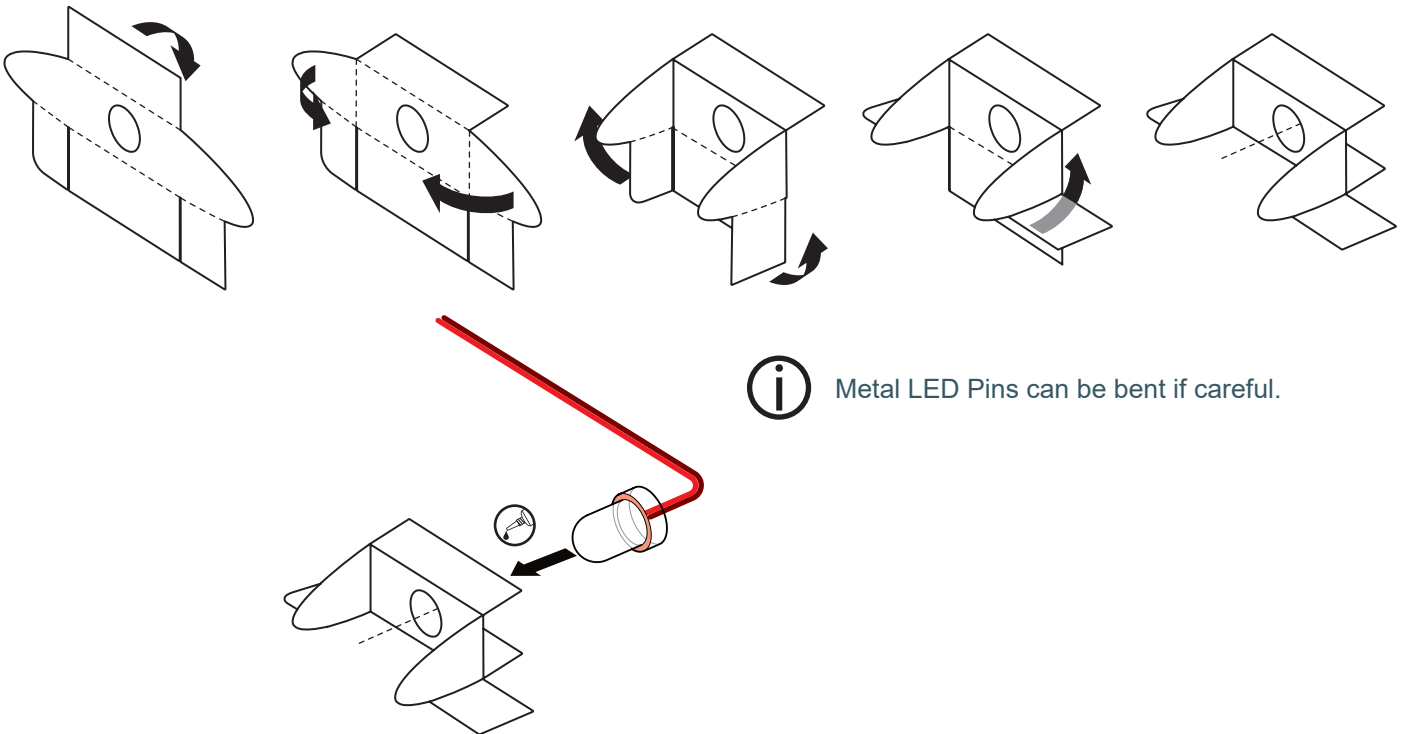

**i** Metal LED Pins can be bent if careful.

**i** Repeat Leading Edge housing assembly for PORT SIDE. (Use plastic housing part labelled 'P')

**STAGE 5 WINGS + LEDS**

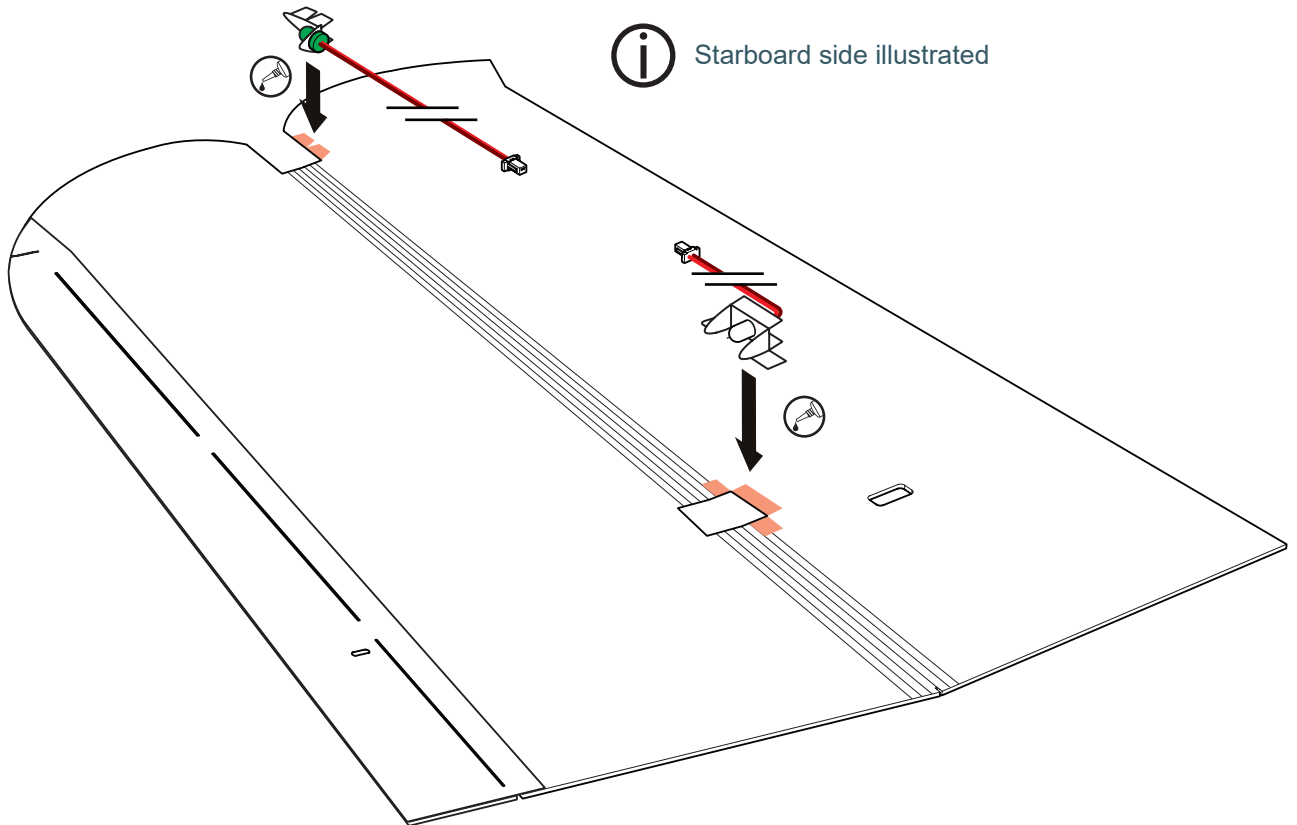

**i** Starboard side illustrated

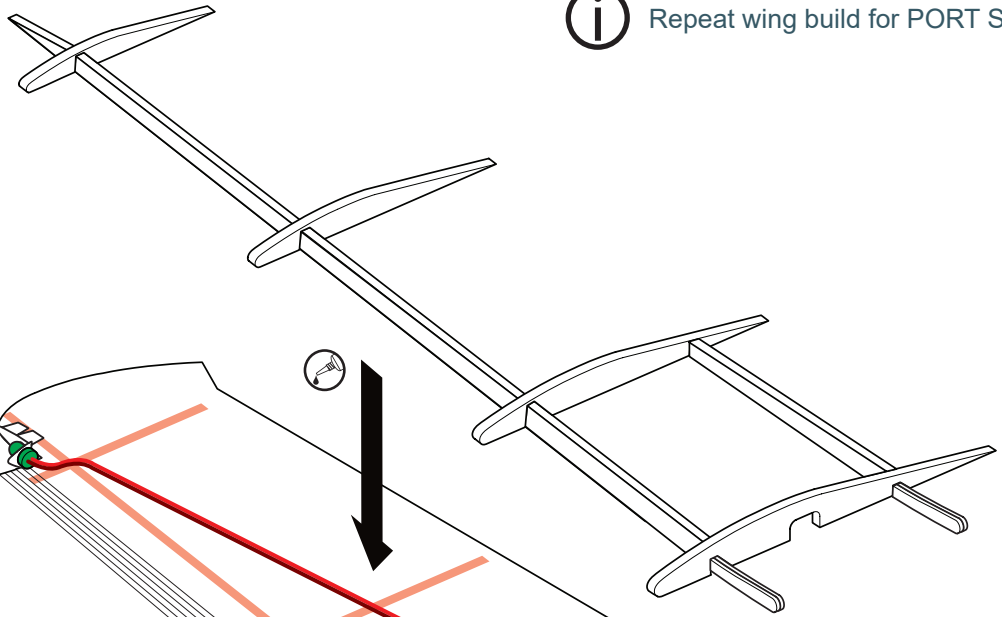

**i** Repeat wing build for PORT SIDE.

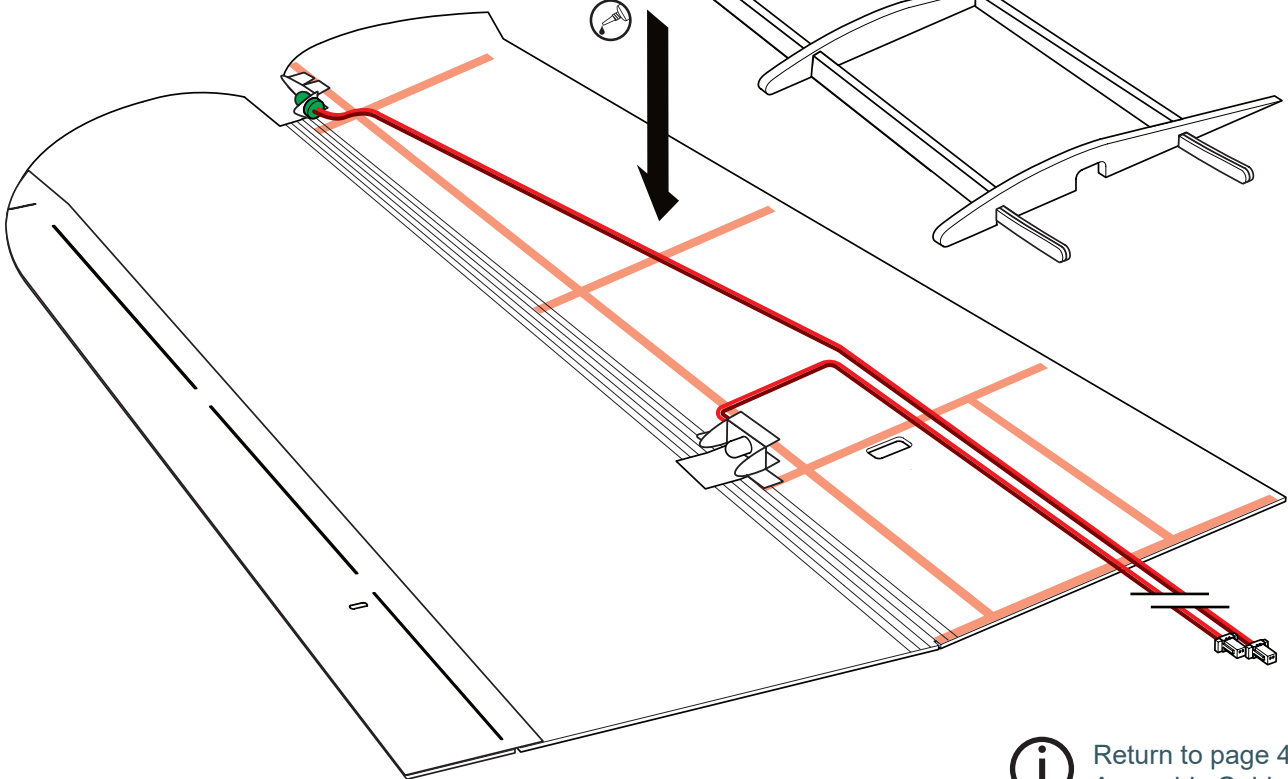

**i** Return to page 44 of main Assembly Guide

## STAGE 6 WINGS

**i** From page 44 of main Assembly Guide

**i** Route both LED connectors through plastic tube into fuselage interior during installation of wing

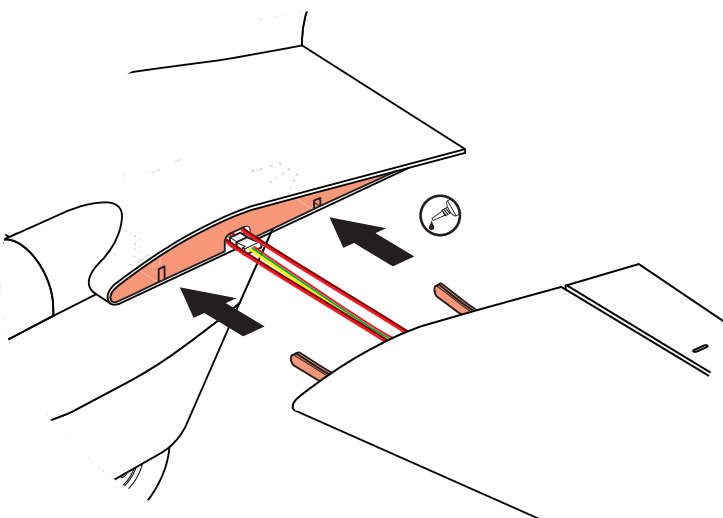
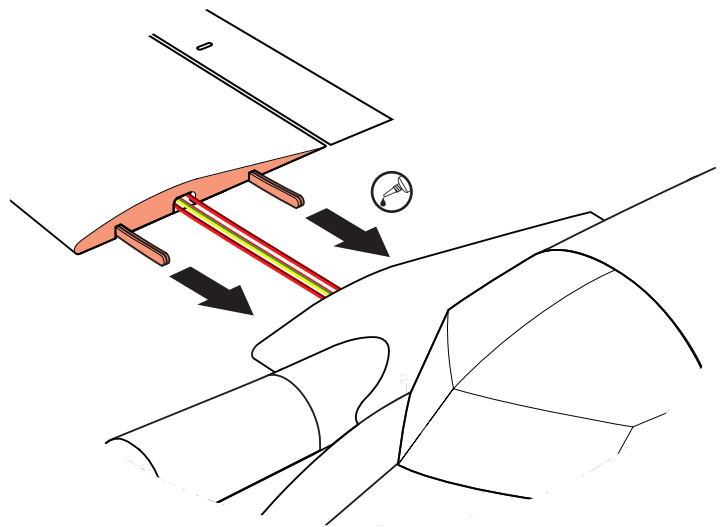
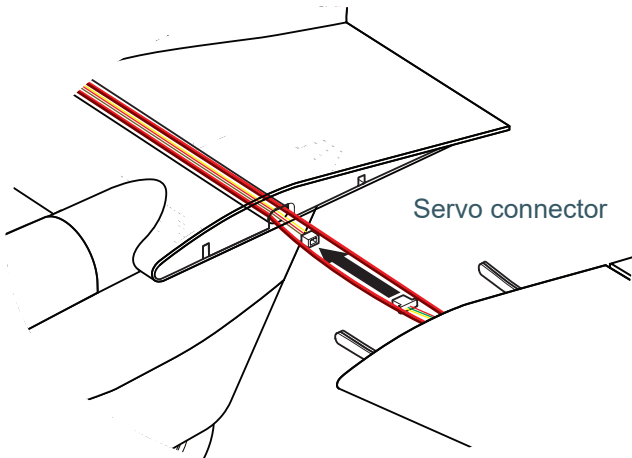
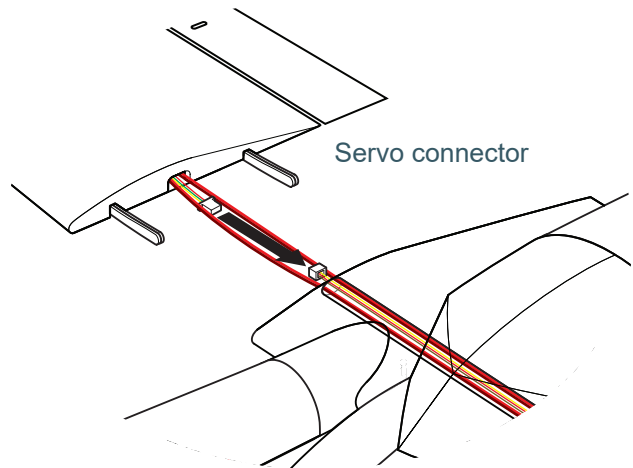

**i** Return to page 45 of main Assembly Guide



# STAGE 7 LED LIGHT COVERS

**i** From page 51 of main Assembly Guide

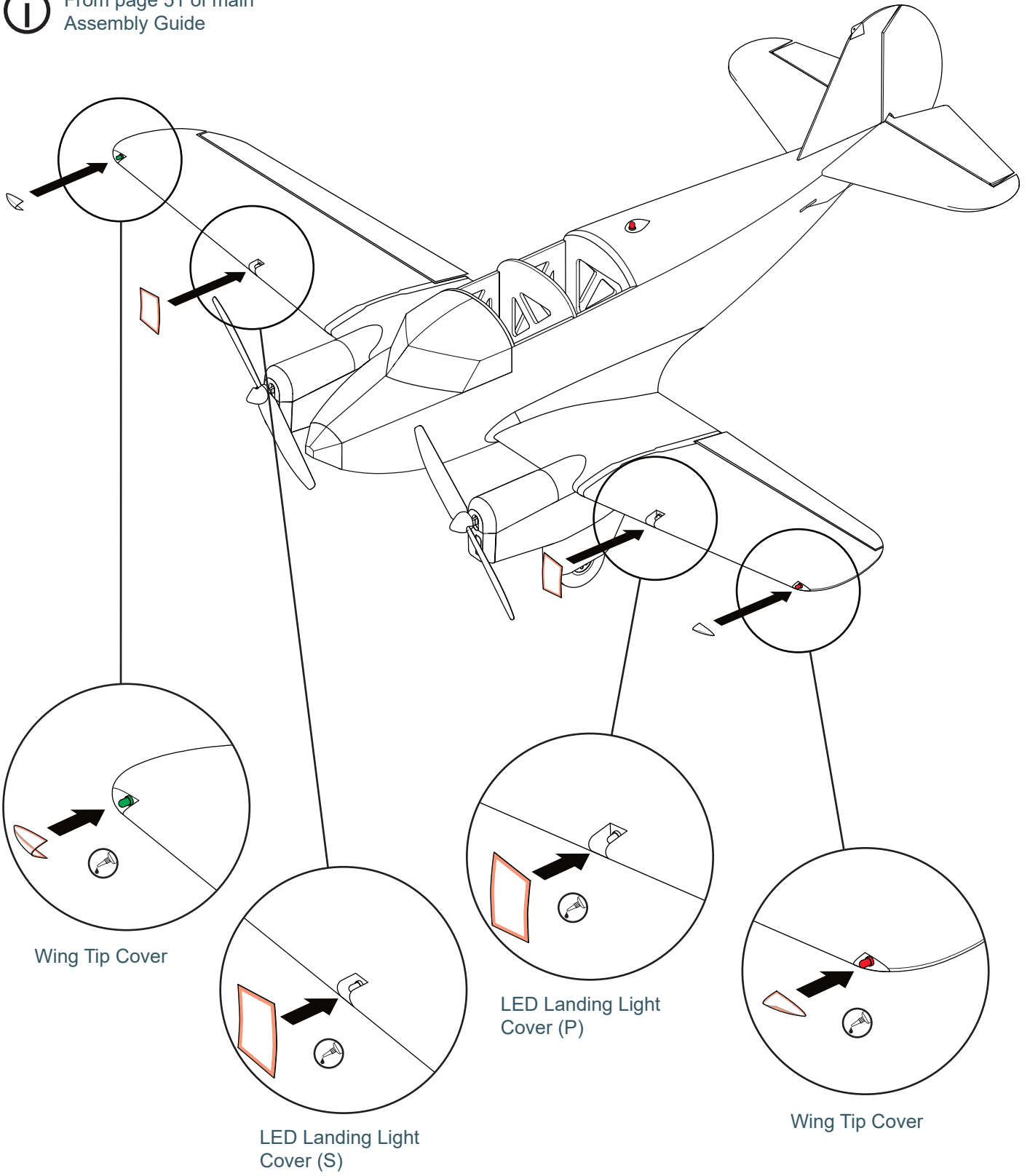

**STAGE 7 LED CONNECTIONS**

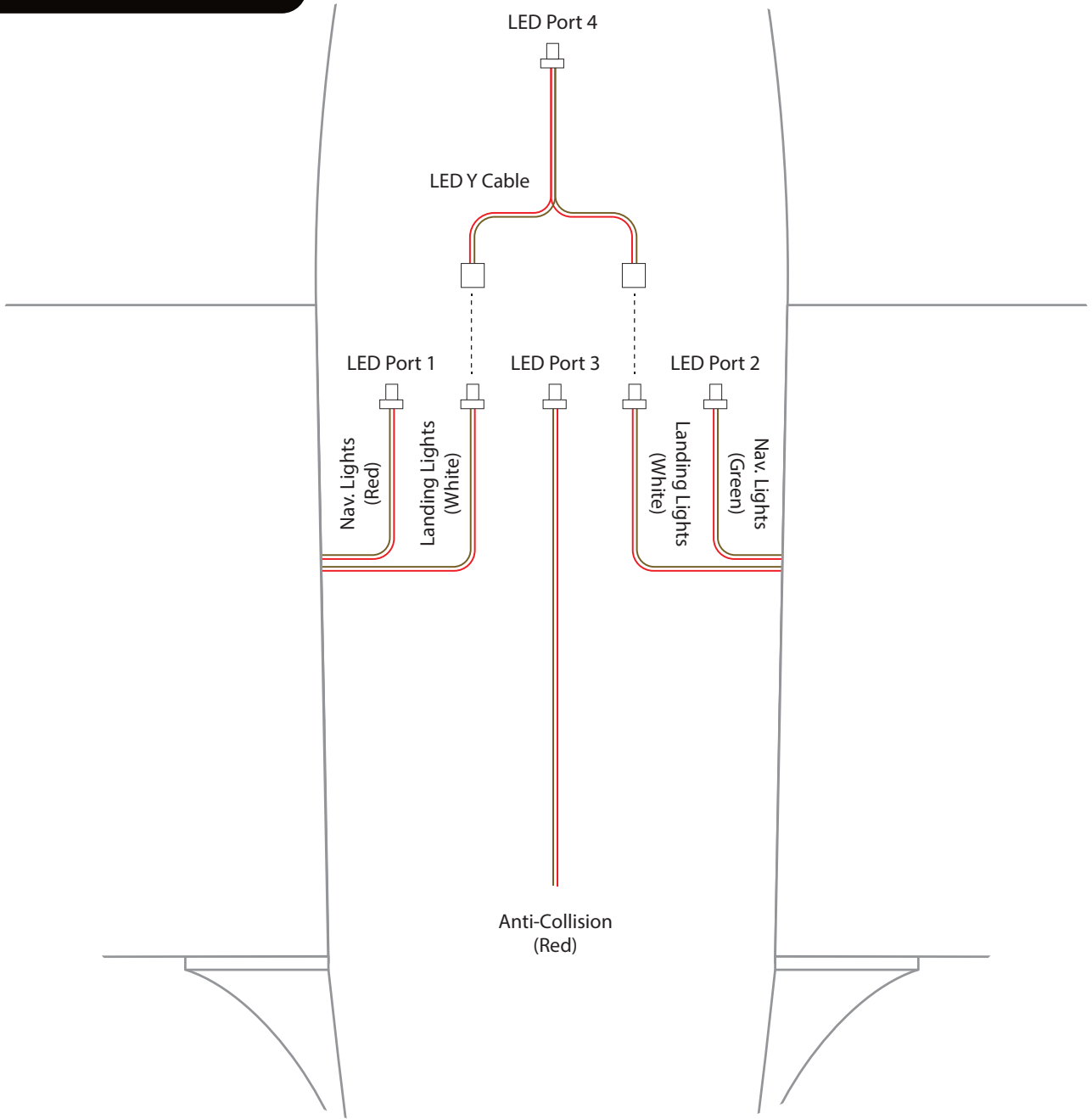

## RECEIVER SETUP

### Receiver Setup for LED operation from Transmitter Switch.

Using the Crossover RX Configuration Tool for PC and the USB Programming Interface Module (UPIM), connect the Percee Twin ESC Receiver to your computer and connect. (Refer to the Receiver Guide for detailed instructions)

From the menu in the Crossover RX app, select the 'Ports' tab. Using the drop-down menu, change Port3 from its default (THR) to AUX1. See image below.

Click save within the Crossover RX app and disconnect before physically unplugging the receiver from the PC.

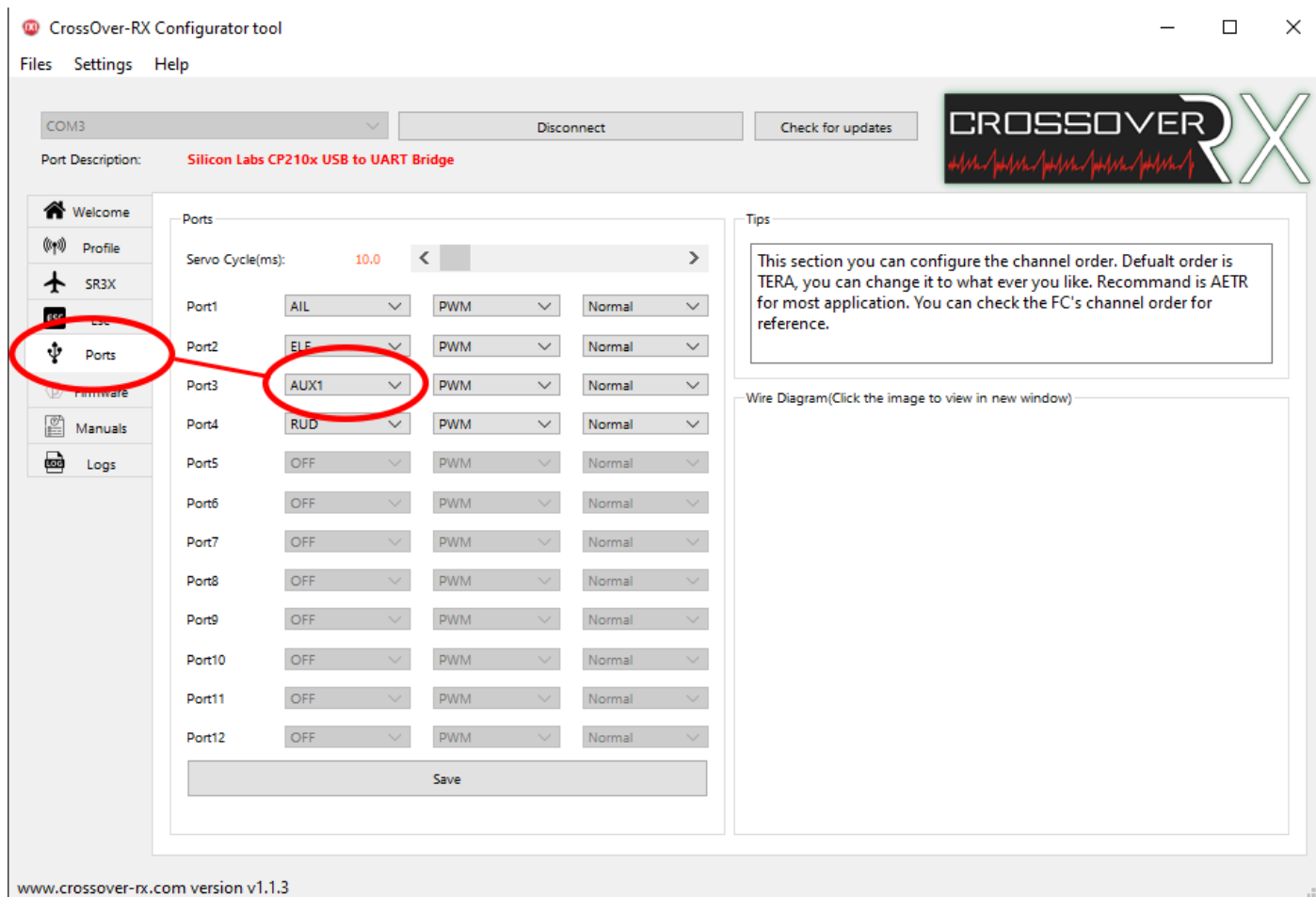

### Connecting LCU to Twin ESC Receiver

Plug the 3 pin JST-SH connector on the LED Control Unit to the THR port on the Twin ESC Receiver.

The LCU can then be placed in the fuselage, behind the bulkhead. It should not need to be secured in place.

### Setting up your transmitter to operate the LEDs.

Within your transmitter setting, allocate AUX1 to a 3-way switch on your transmitter. Refer to your transmitter guide for assistance.

To switch between LED modes, change the position of the switch accordingly.

For assistance and enquiries contact: [support@microaces.com](mailto:support@microaces.com)

**STAGE 8 HATCH INSTALLATION**

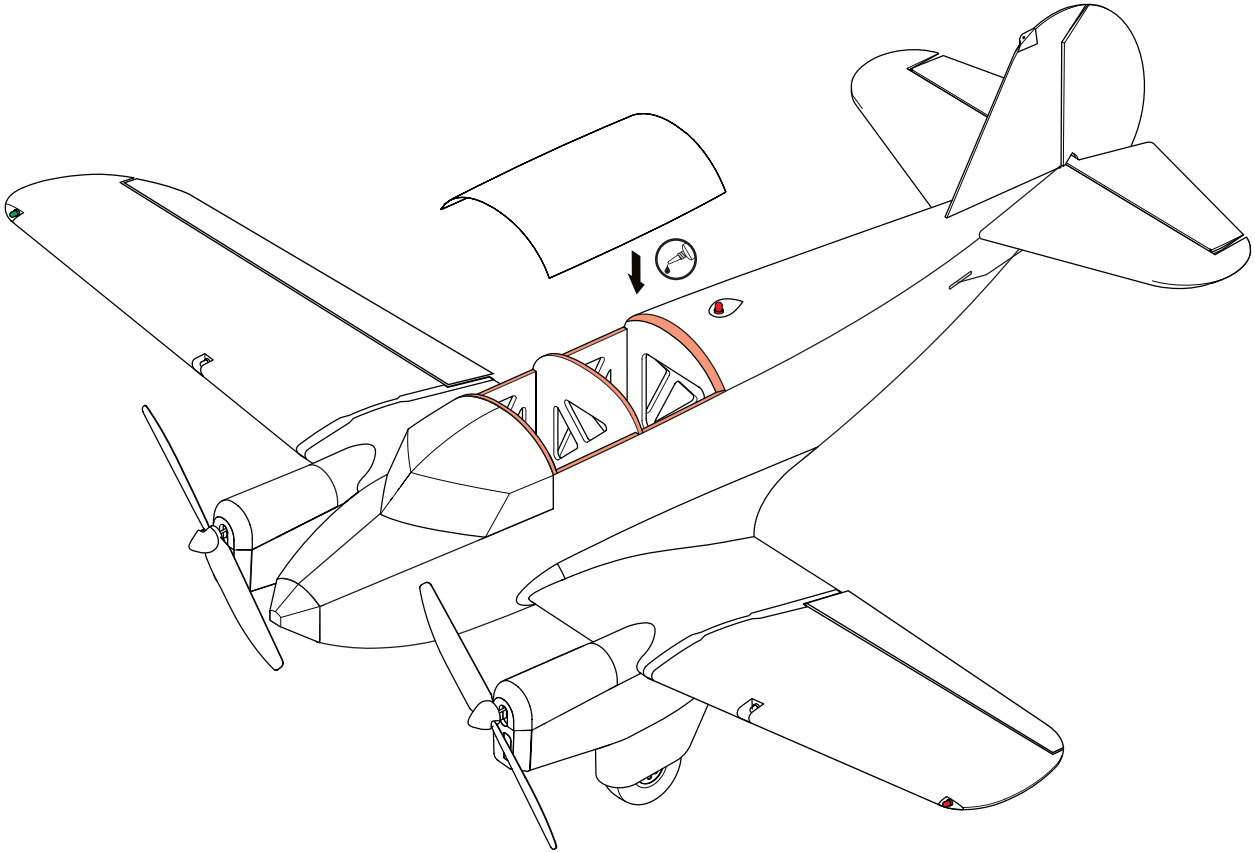

 Return to page 51 of main Assembly Guide