

REQUIRED TOOLS:

- Flat Head Screwdriver

INCLUDED HARDWARE:

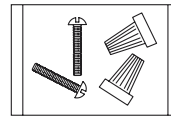

Wiring Kit (x1)

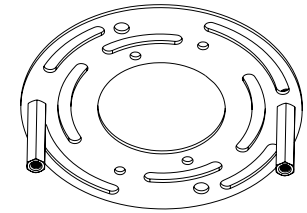

Circle Bracket Assembly (x1)



8-32 x 3/8" Screws (x2)

INSTALLATION INSTRUCTIONS

1. Detach Circle Bracket Assembly from Fran Fixture by removing 8-32 x 3/8" Slotted Screws with a flat head screwdriver. Reserve screws for final step of installation.
2. Attach Circle Bracket Assembly to the junction box using provided Screws in Wiring Kit.
3. Wire Fixture to Junction Box using provided Wiring Kit. Ensure Wire Nuts are behind the fixture Circle Bracket Assembly and inside the electrical Junction Box. Consult electrician if necessary.
4. Slip the fixture over the Circle Bracket Assembly and align holes on fixture with the holes on the Bracket Stand Offs. Attach the fixture to the Circle Bracket Assembly using reserved 8-32 x 3/8" Screws. Tighten securely.
5. Install bulb.
6. Attach shade using included fitter screws and enjoy.

