

STEP 1

Lay out all 6 Joovv devices on a scratch-free surface.

STEP 2

Set the Elite bracket and connection bars on the Joovv Elite system, making sure to line up all screw locations, as shown in [Figure A](#).

STEP 3

Hand-tighten the screws with the included Allen screwdriver.

STEP 4

After setting up the mobile stand using separate instructions, hang your Joovv Elite and proceed to the next step.

STEP 5

Connect the power and patch cables, as shown in [Figure A](#).

STEP 6

Set the pairing switches to the appropriate lead and follow modes, as shown in [Figure A](#).

STEP 7

Plug in the power cords and you're ready to start Joovvin'!*

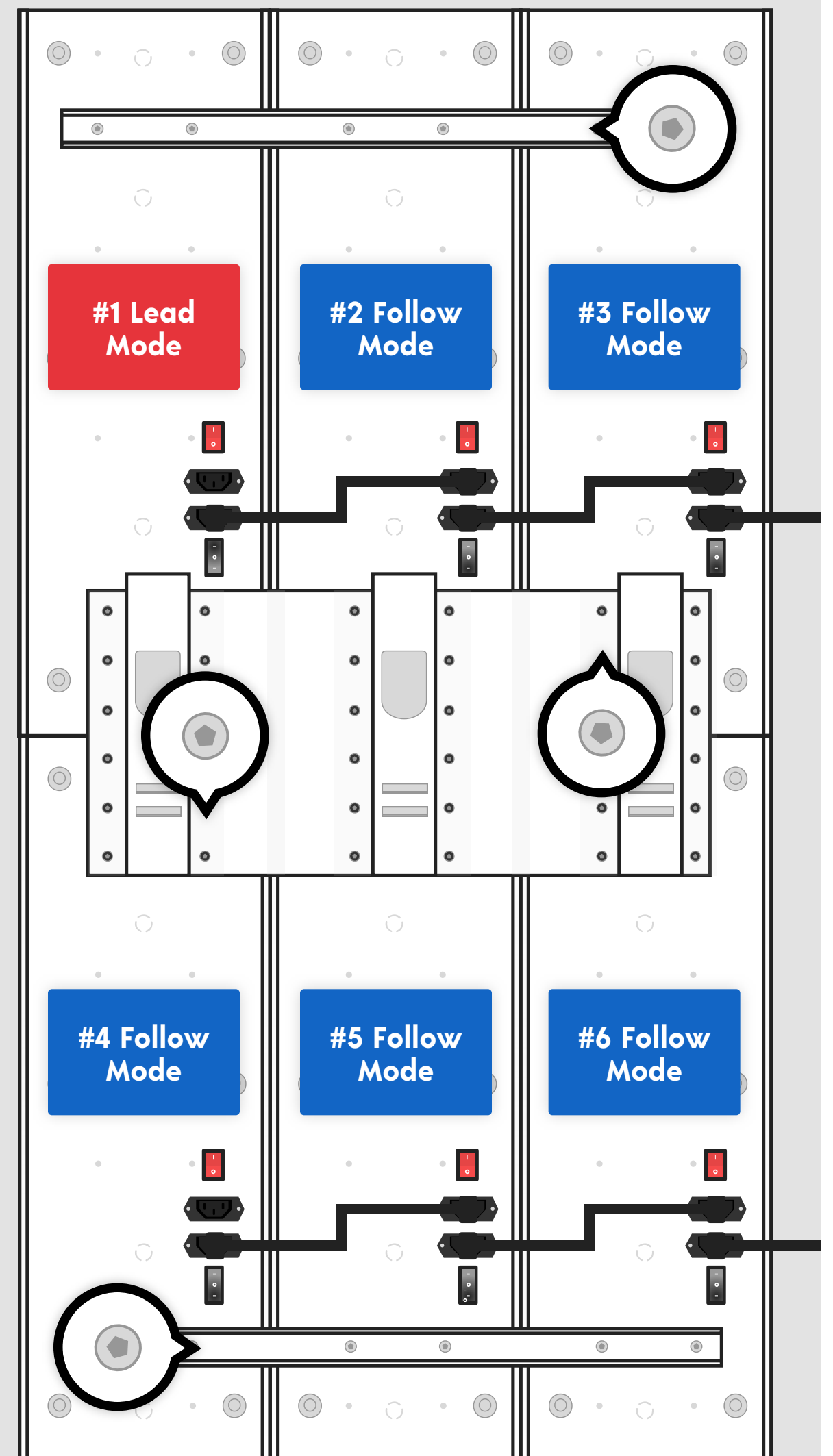

FIG. A



If you'd prefer instructional setup videos, please visit: www.joovv.com/setup



For comprehensive instructions, please review the product manual that was included with your Joovv devices.

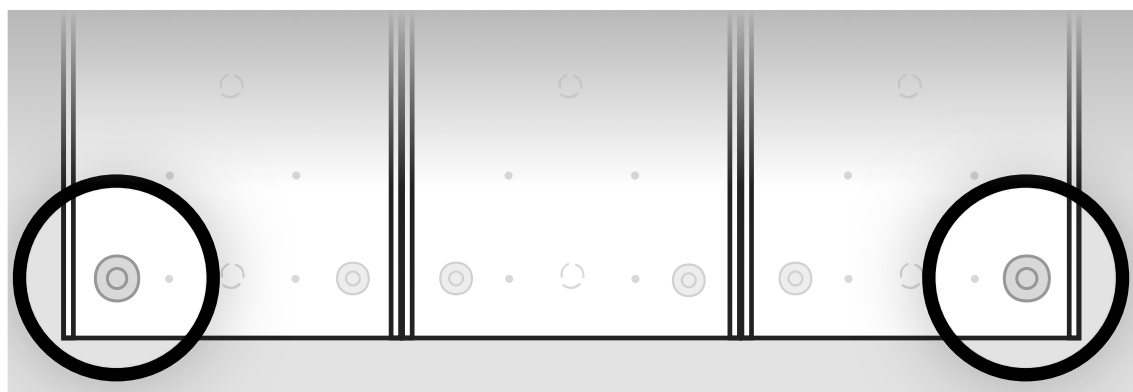
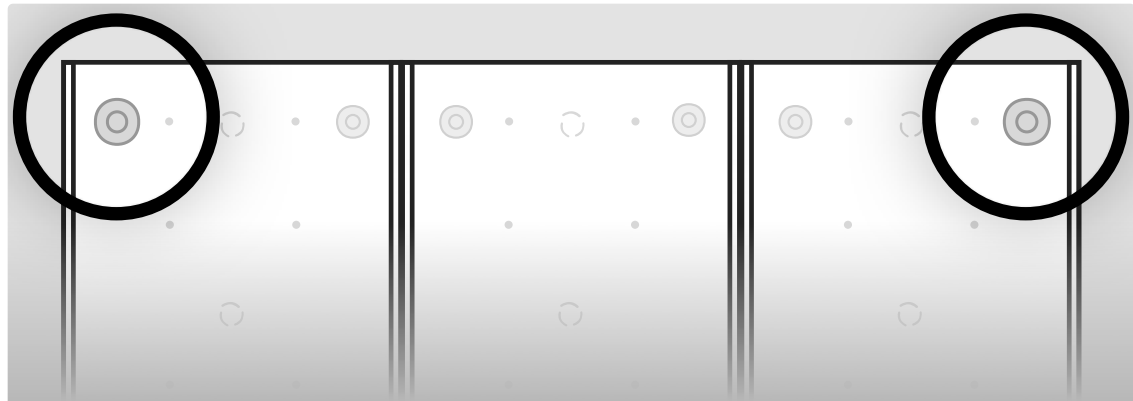

FIG. A

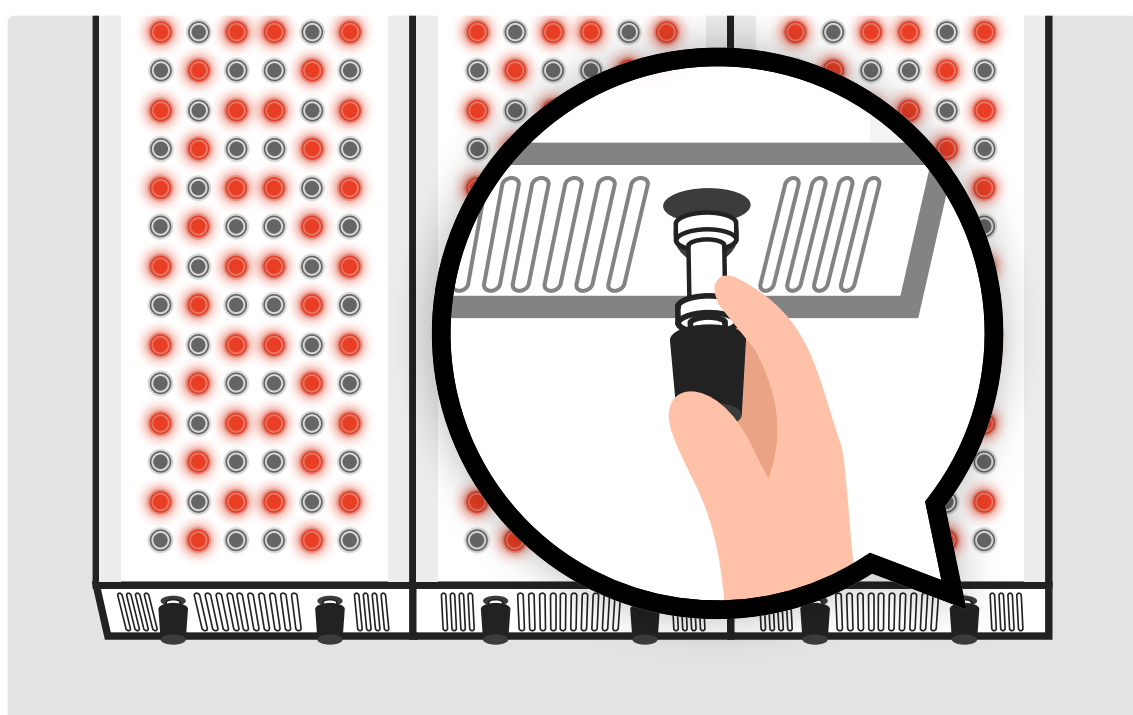

FIG. B

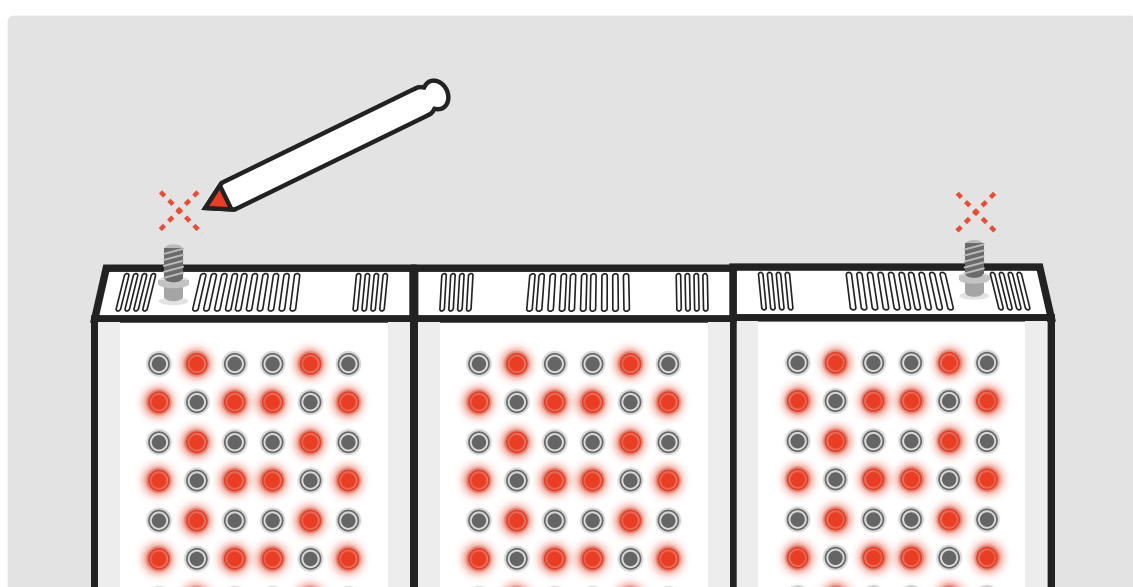

FIG. C

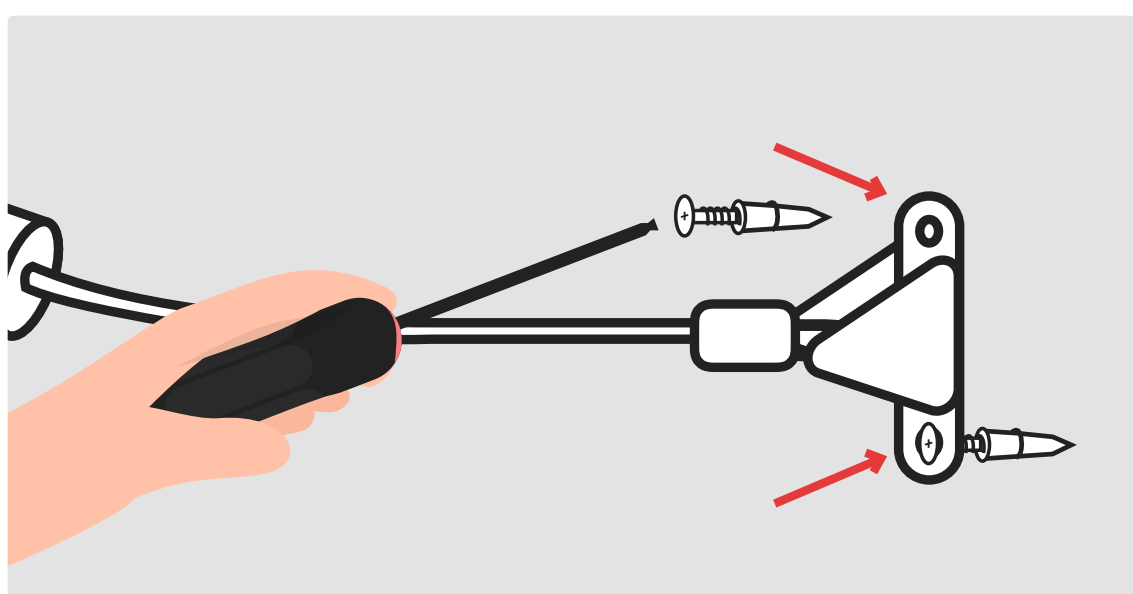

FIG. D

STEP 1

After assembling your Elite following the steps on the opposite side, replace the bumpers on the 4 corners with the included 35mm bumpers using the included Allen wrench, as shown in [Figure A](#).

STEP 2

Then, attach the included floor bumpers on the bottom end caps. First, insert the end with the nut into the slotted hole and slide back into position. Then, while pulling to hold the nut in position, twist the bumper clockwise to lock it in place, as shown in [Figure B](#).

STEP 3

Insert the threaded posts into the far left and far right positions on your Joovv Elite. Place the Joovv Elite in position on the wall at the desired location. Then, with a pencil, mark the spot directly behind the threaded posts, as shown in [Figure C](#).

STEP 4

Next, install the anti-tip bracket to the wall. Place the bracket on the wall with the upper hole aligned with the previously-marked location. Then mark the lower hole position. Drill a 7/32" hole for all 4 locations for the included drywall anchors. Use a hammer to tap the anchors into position, then attach the brackets to the wall using the included screws, as shown in [Figure D](#).

STEP 5

Place your Joovv Elite back into position and screw in the end of the steel cables to the threaded posts. Plug in the power cords and you're ready to start Joovvin'!