



Little Martin's Baby Hair Clipper

# User Manual

For Model BHC1706

In order to ensure you and your child's safety, please be sure to read this manual before using the product, and use it correctly.

- Please keep this manual in a safe place.
- Carefully read the manual and follow instructions on charging, operation and cleaning.
- If giving as a gift, please be sure to include this manual.

## Contents

Features .....	1
Name of Parts .....	2
Operating Instructions.....	3
Comb Replacement .....	3
Cutting Guide .....	4
Cleaning .....	5
Washing .....	6
Specifications.....	7
Caution .....	7
Treatment .....	7
Charging .....	8
Warranty Certificate.....	on the back cover

## Features

- Blade specially designed for use on babies
- Detachable blade convenient for cleaning
- Waterproof design
- 3 hours quick charge
- 100-240V universal voltage

## Name of Parts

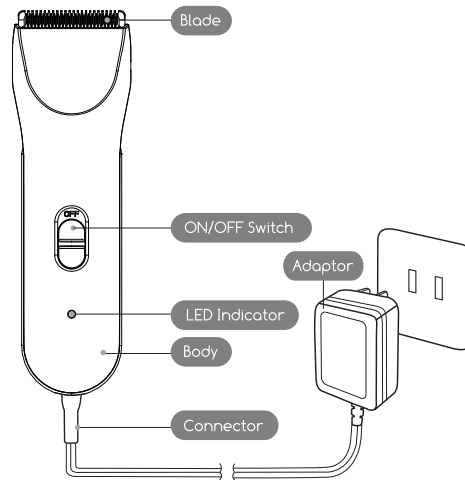

## Attachments



Lubricant Oil Bottle



Cleaning Brush



Attachment Comb 3/6mm



Attachment Comb 9/12mm

## Operating Instructions

### Main-Use

1. Insert the connector into the slot at the base of the clipper body.
2. Make sure the clipper is switched off before plugging in.
3. Switch on to use.

\*Please charge prior to first use

### Cordless-Use

1. Insert the connector into the slot at the base of the clipper body.
2. Make sure the clipper is switched off before plugging in.
3. Remove plug from power outlet after fully-charged, switch on to use.

## Comb Replacement

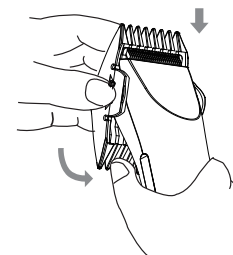

Installation of Comb: To install attachment comb, push comb downward following the orientation slot

Detachment of Comb: To detach attachment comb, push comb up following the orientation slot

## Cutting Guide

### How to Cut with Attachment Comb

- ① We recommended using the 12mm comb when trimming for the first time, cutting just a little hair with each stroke. Once you become familiar with using the device, you can use other comb sizes.

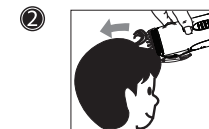

Hold the clipper up to steadily trim the hair from the front.

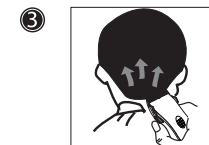

When cutting the hair on the back of the head, install 3/6/9mm comb. Slightly tilt the head face down and start from the middle in upward strokes.

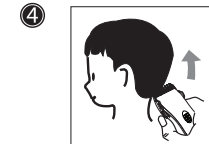

When cutting the hair near ears, install 3/6/9mm comb to cut hair



## Warranty Certificate

This certificate promises our customers that they will receive free repair. If you notice any problems listed below within the warranty period, please contact our customer service with this certificate.

- Once you have used this product, we basically will not offer exchange.
- When the product is damaged (after proper use) within the warranty period which is a year from the purchase date, we will repair it for free. Contact us via email [support@littlemartinsdrawer.com](mailto:support@littlemartinsdrawer.com), and send the product over to our customer center.
- Even within the warranty period, in the following situation the repair process will come with a fee.
  - Natural discoloration of the plastic area.
  - Damage due to misuse of the product.
  - Damage due to fire, water, earthquake and other natural disasters.
  - Damage due to commercial or business usage.
  - The shipping fee for paid repair.
- This service will apply only inside United States.
- Once the product is out of production and certain parts are out of stock, we will not be able to offer certain repairs.



BATCH CODE  
SEE THE LOT LABEL AT THE BACK  
OF THE DEVICE



CONSULT INSTRUCTIONS FOR USE



100% RECYCLEABLE



WASTE FROM  
ELECTRICAL AND  
ELECTRONIC  
EQUIPMENT (WEEE)



## How to Cut with the Help of Comb or Finger

- Detach the attachment comb

- Raise hair with comb or fingers



- Keep the hair that you want to cut above the blade



- Use clipper to cut this part of hair until desired length



- Clean off cut hair periodically to observe overall look

## Cleaning

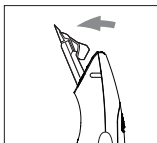
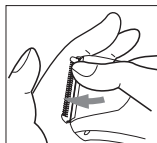

Remove blade by pushing it off as shown in the illustrations above

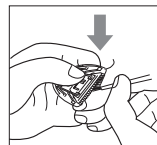
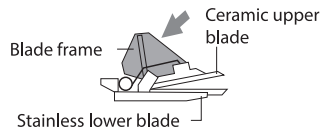

Use cleaning brush to clean the blade. Press the frame down as shown in the picture above, and clean the remaining hair between the upper and lower blades.

DO NOT attempt to remove the spring in blade.

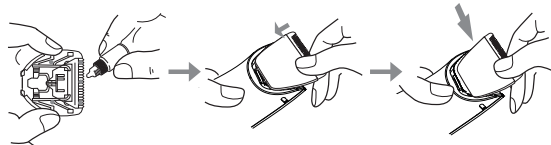

Apply 2 to 3 drops of oil between the upper and lower blades after cleaning (There will be a clear sound when the blade is installed correctly)

## Washing

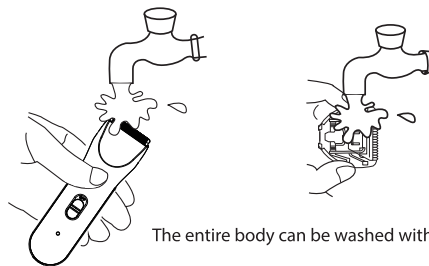

The entire body can be washed with water

## Specifications

Adapter Input:	AC 100-240V 50/60 Hz
Adapter Output:	DC 5.0V 1000mA
Battery:	1.2V 600mAh x2
Battery Type:	Ni-MH
Charging Time:	Approximately 3 hours
Usage Time:	Approximately 60 minutes

## Cautions

- Do not attempt to disassemble, repair, or alter the product
- Keep out of reach of children
- Use a damp cloth with plain water or very mild liquid soap to clean the unit
- Batteries contain substances that may pollute the environment. Do not throw away with normal household waste, but dispose at an official collection point for batteries

## Treatment

### Warning

- To avoid fire or electrocution, DO NOT use this product near water or in damp conditions.
- Always turn the unit off and unplug when not in use.
- No parts of the unit can be repaired by the customer. If product needs repairing, please return it to an authorized service center or contact Little Martin's Drawer customer service team for help.

## Disposal of Used Electrical Devices

Little Martin's Drawer supports environmentally-friendly and conservation activities. This symbol on the product or in the packaging means the product must NOT be disposed of in household waste. If needed, please dispose of the product at your local authorized disposal or collection facility for recycling. With proper disposal you can assist Little Martin's Drawer in efforts to help prevent negative impact on the environment and health. Recycling materials contribute to protection of natural resources. For more detailed information, please contact your local authorities or any company involved in dealing with electronic waste.

- If the supply cord is damaged, it must be replaced by the manufacturer, its service agent or similarly qualified persons in order to avoid a hazard.
- This appliance is not intended for use by persons (including children) with reduced physical, sensory or mental capabilities, or lack of experience or knowledge, unless they have been given supervision or instruction concerning use of the appliance by a person responsible for their safety.
- Children should be supervised to ensure that they do not play with the appliance.

## Charging

- Charge time is approximately 3 hours.
- The battery will reach its best status after it is fully charged and discharged 3 to 4 times.
- Battery lifetime will decrease if product is overcharged for long periods of time.
- Charge the product only when the power is out.
- The best working temperature of the product is 5°C to 40°C.