

# Biomax

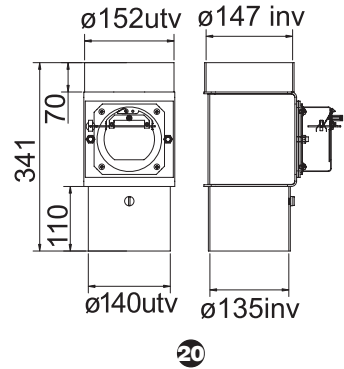
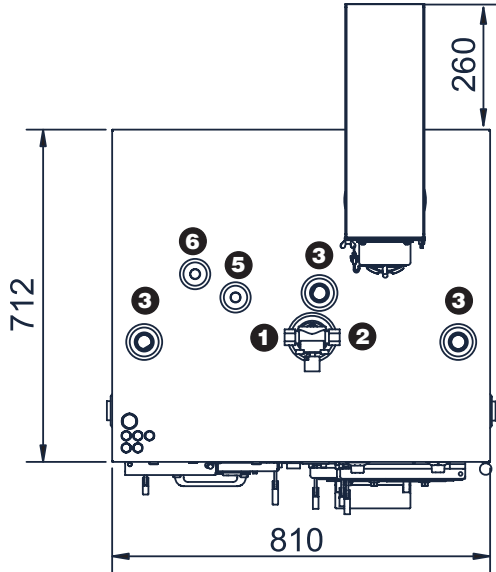
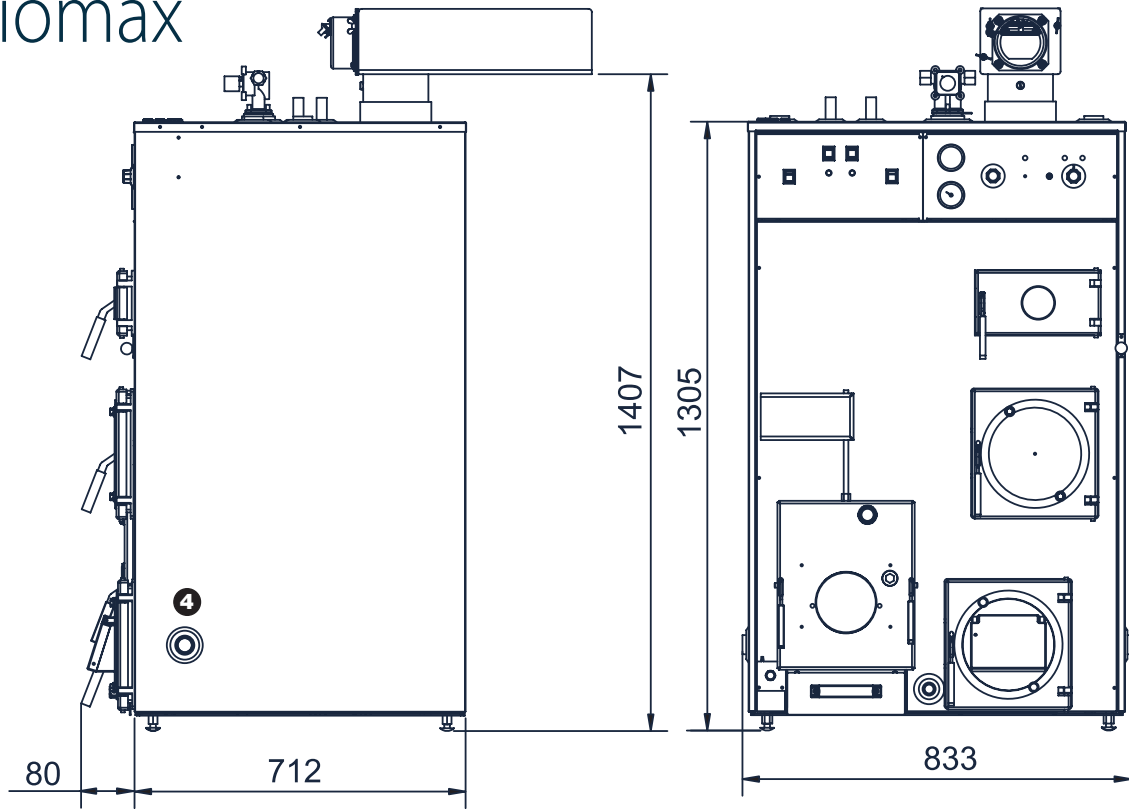

Biomax	Art No. 2207	
Weight	empty	350 kg
	water-filled	640 kg
Volume		190 litres
Hot water heater		100 litres
Design pressure		1.5 bar
Max. operating temperature		95 °C
Power output	wood	20 kW
	pellet	20 kW
Electric		9 kW
Hearth	volume	55 litres
	depth	400 mm
Log length		380 mm
Log hatch	w x h	185 x 235 mm
Chimney requirements	height	≥7 m
	flue	Ø ≥150 mm
	suction	-20 Pa
Voltage	400V 3N~, 50 Hz	
Power	13.1 A	
Enclosure class	IP 21	

1. Feed pipe, clamp ring Ø 22mm
  2. Return pipe, clamp ring Ø 22mm
  3. Lift, Expansion, Safety connection, G 25 int.
  4. Hot water outlet, G 25 int., provided on both sides of the boiler.
  5. Incoming cold water, clamp ring – Ø 22mm.
  6. Hot tap water, clamp ring Ø 22mm.
20. Straight flue, accessory. Art No. 2936

#### Complete delivery

- Flue with lockable backdraught hatch
- Sweeping tool with bracket
- LPG igniter (bottle excluded)
- Flue gas thermometer
- Drainage valve
- Pressure and temperature gauges
- Load monitor inc. transformers

#### Accessories

- Flue, several designs
- Pellet hatch kit (for burners from other manufacturers)
- Conversion kit for oil burners

No liability can be accepted for any printing or typographical errors