



INSTALLATION GUIDE

S-TECH JEEP JK 4 Switch System



Developed, Designed, Manufactured and
Assembled in Colorado by



Team Tech Offroad introduces the **S-TECH Switch System**

DEVELOPED, DESIGNED, MANUFACTURED and Assembled in the Rocky Mountains of Colorado, known to many as JEEP COUNTRY. Trail riding at 10,000 feet at night requires great lighting and a well-engineered switch system. That is where S-TECH was developed and tested. Simple solutions to Off-Road challenges results in reliability, safety and convenience. Our made in the USA injection molded

switch housing abd plug and play wire harness has a pure OEM look and feel second to none. Please take a moment to read the following instructions and procedures. Since you will be drilling and cutting one of your OEM trim pieces above the rear view mirror, we highly suggest that you use consider using either a service professional or use professional techniques and practices while installing your **S-TECH Switch System**.

REMEMBER: Be a Pro!
Always measure twice and cut once.

Custom Plug and Play Harness

Dual LED Blue Lights

With Driving Lights "ON"

With Driving Lights/Accessories "ON"

Shown with optional dual blue LED; Dual LED option is available in Blue, Red and custom imprint.

Included in kit **#TTO-STECH**

- One (1) TTO custom switch housing (above rear view mirror)
- Four (4) LED rocker switches
- One (1) TTO Jeep JK control box with Plug and Play wiring
- One (1) TTO control box cover
- One (1) Custom powder coated bracket
- Eight (8) Nylon HD cable ties 50# tensile 7" black
- Two (2) grade 5 $\frac{1}{4}$ -20 \times $\frac{1}{2}$ " hex cap screw
- Two (2) $\frac{1}{4}$ -20 stainless steel nylon insert hex lock nuts
- Two (2) 6-32 \times $\frac{1}{4}$ " black hex set screws
- Two (2) 6-32 304 stainless hex keys lock nuts
- Instructions and link to installation video
- Made in the USA sticker
- TeamTech Offroad sticker
- S-TECH Switch System sticker

01

Open the S-TECH box and familiarize yourself with all of the parts that you will be using during the install. Remove the S-TECH Black Powder Coated Bracket



02

Remove the S-TECH Switch Housing



03

Remove the S-TECH Wire Harness and Control Box



04

Cut Cable Ties on S-TECH Wire Harness



05

Attach the bracket to the control unit using the $\frac{1}{4}$ "x20 hardware supplied with the S-TECH kit



06

Install the Control Box/Harness by loosening the 10mm bolt on the drivers side fender and remove the 10mm bolt in front of it as shown. Slide the bracket into the 10mm bolt that was loosened and re insert the bolt on the other. Tighten both bolts to original factory specifications



07

Locate the 10mm bolt about 6 inches forward of the bracket and attach the ground wire as shown

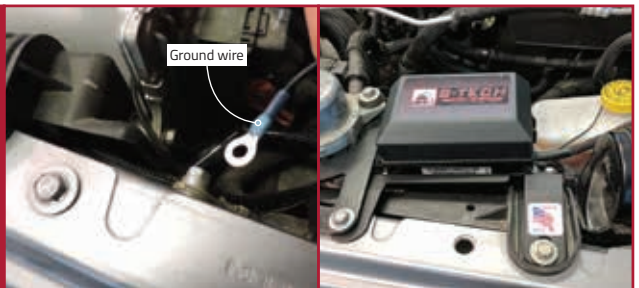

OUTPUT CIRCUITS (A):

Yellow wire is Switch position #1, Orange is #2, Brown is #3 and Grey is #4

These outputs relate to the switch positions Left to Right as you look at the Housing.

Blue Wire (B): Parking Lights; **Small Red (C):** Fuse Block; **Big Red (D):** 12V Battery; **Black (E):** Ground

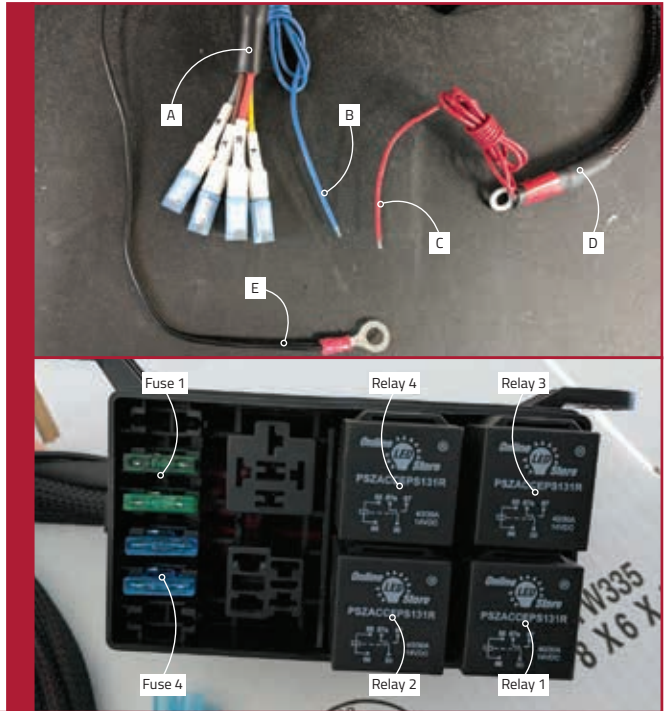

Locate the four output wires (A) that coincide with the switch position left to right

08

NOTE:

All circuits are capable of 30A each. Double check the accessory that you are controlling and make sure it matches the fuse Amperage installed in the control box.

EXAMPLE:

A 50" light bar would require a 30A fuse while a few LED rock lights would usually require less than 10A

09

Temporarily remove the Drivers Side Sun Visor and upper / driver side interior trim piece above the rear view mirror while slightly loosening the factory wiring attached to it



10

After removing the interior trim and sun visor around the driver windshield area up to and including above the rear view mirror. Prepare the Upper Center trim piece above the rear view mirror as shown

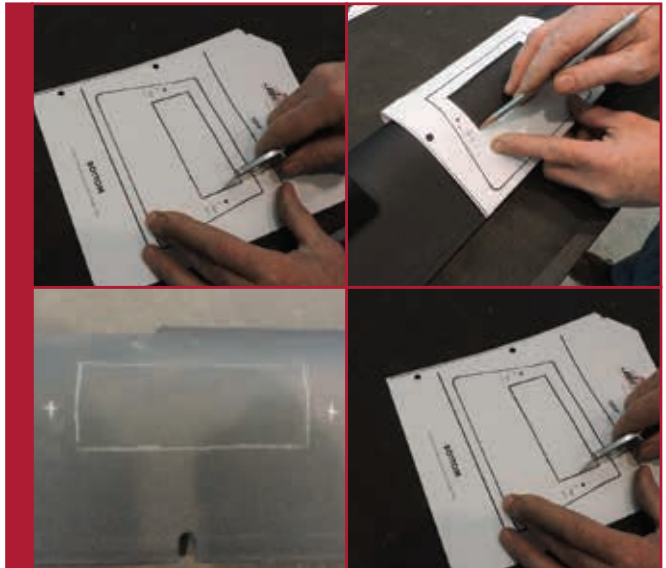

Using the supplied **TTO S-TECH Template**, align the section marked "TOP" to the top of the interior trim from above rear view mirror trace out the rectangle and drill at the marks using a silver pencil or pen then cut that section out using a utility knife or dremel tool. This will allow the back of the switches some relief and penetrate into the interior trim piece

REMEMBER: MEASURE TWICE CUT ONCE, DOUBLE CHECK YOUR WORK BEFORE MAKING ANY CUTS

11

Carefully cut out the rectangle section you just marked with a silver pen or pencil using a utility knife or dremel tool



12

Pass the switch housing end of the wire harness through the opening in the firewall on the drivers side and feed the wire up the A Pillar



13

Pull the connector through into the drivers side floor area and attach the wire harness to the are under the trim using cable ties as needed



14

Plug the Control box connector to the switch housing connector, (be sure to hear the "CLICK")



15

Re attach interior trim pieces and sun visor around drivers windshield area you are now done on the inside



16

Time to power up the unit. Connect the RED 12V power lead from the control box to the + side of the vehicles battery



17

Use the supplied Fuse Tap to provide for an "ignition on only" 12V source. CONNECT Fuse Tap to FUSE Location "M9" (Rear Heated Seats) This will enable the system when the ignition is turned on. If you prefer power all the time without the ignition "on" then connect this wire directly to the battery. This is not recommended since the system can drain the battery if accessory switches were left in the on position

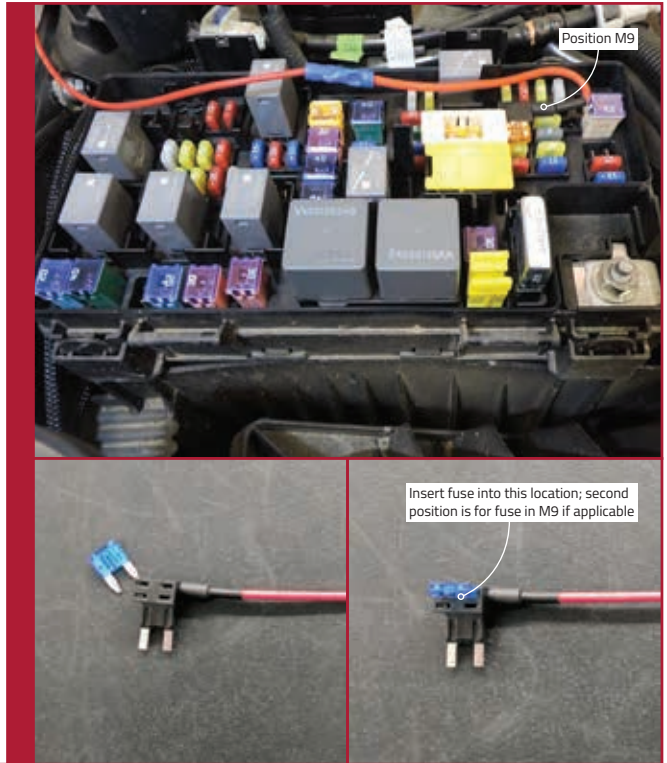

SWITCH PANEL OPERATION (Dual LED):

Parking or Headlights "ON"
(lower LED bar lite)



Parking or Headlights "On"
and accessories turned on
(both LEDs are lite)



SWITCHES LEFT TO RIGHT: Switch Position 1, 2, 3, 4.

Shown with optional dual blue LED; Dual LED option is available in Blue, Red and custom imprint.

NOTE:

If LED or outputs are inoperable recheck ground, 12V source and red ignition source for power.

CONGRATULATIONS!

You have just completed the installation of your new
S-Tech Switch System.

Any Questions or Comments please call

720-307-7263

or email us at

sales@stechswitch.com

For information & videos as well as printable / downloadable
instructions and templates, please visit

www.STECHSWITCH.com



S-TECH

SWITCH SYSTEMS

TEAMTECHOFFROAD.COM



Jeep 4x4 Off Road Parts

www.TeamTechOffroad.com