



S-TECH

SWITCH SYSTEMS™

INSTALL GUIDE

JEEP JK '07-'18



PATENTED

US # 10,688,946



S-TECH Switch Systems™

DEVELOPED, DESIGNED, MANUFACTURED and Assembled in the Rocky Mountains of Colorado, known to many as OFFROAD COUNTRY. Trail riding at 10,000 feet at night requires great lighting and a well-engineered switch system. That is where S-TECH was developed and tested. Simple solutions to Off-Road challenges results in reliability, safety and convenience. Our Made in the USA injection molded switch housing and plug and

play wire harness has a pure OEM look and feel second to none. Please take a moment to read the following instructions and procedures. Since you will be drilling and cutting into parts of your vehicle, we highly suggest that you consider using either a service professional or use professional techniques and practices while installing your **S-TECH Switch System.**

**Please be sure to check our website
stechswitch.com/installs-new/
 for the latest INSTALLATION UPDATES.
 Any questions please contact us at 720.307.7263**

**** Before starting the installation process, disconnect the vehicles' primary battery ground**



Included in Kit

- One (1) Custom Jeep JK ABS Switch Housing
- Dual LED Rocker Switches
- One (1) Power Control Module Box & Cover
- One Custom Plug and Play Wiring Harness
- One (1) Custom Powder Coated Bracket
- Eight (8) Nylon HD Cable Ties 50# Tensile 7" Black
- Two (2) 1/4-20 x 3/4" Hex Cap Screws
- Two (2) 1/4-20 Nyloc Nuts
- Two (2) 6-32x3/4 Black Hex Set Screws
- Two (2) 6-32 304 Stainless Hex Keys Lock Nuts
- Fuse Tap w/ 15 amp Fuse
- Instructions and Link to Installation Video
- Made in the USA Sticker
- Team Tech Offroad Sticker
- S-TECH Switch Systems Sticker



With Ignition "ON"



With Accessories and Ignition "ON"

sales@STechSwitch.com ■ 25587 Conifer Rd. | #105-220 | Conifer, CO 80433 | 720-307-7263

REMEMBER: Be a Pro!
Always measure twice and cut once.

01

Open the S-TECH box and familiarize yourself with all of the parts that you will be using during the install



02

Remove the S-TECH Switch Housing

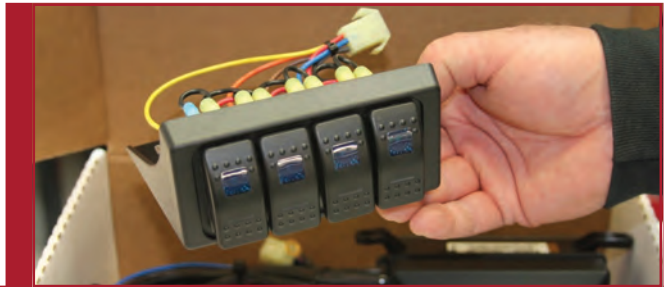

03

Remove the S-TECH Wire Harness and Control Box

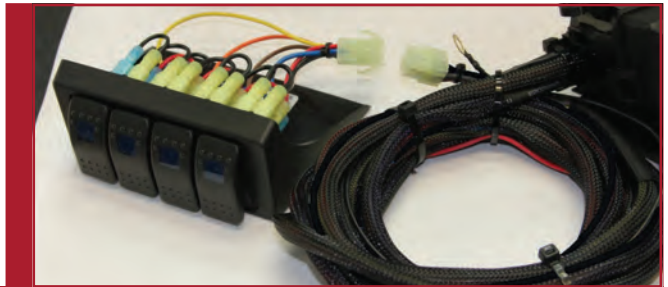

04

Cut Cable Ties on S-TECH Wire Harness

WARNING: Be sure NOT to cut into the wire harness



05

Attach the bracket to the control unit using the 1/4 x 20 hardware supplied with the S-TECH kit

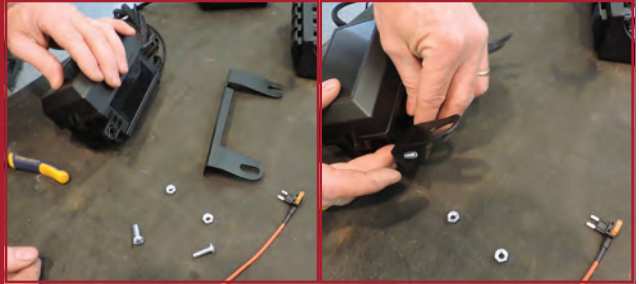

06

Install the Control Box/Harness by loosening the 10mm bolt on the drivers side fender and remove the 10mm bolt in front of it as shown. Slide the bracket into the 10mm bolt that was loosened and re-insert the bolt on the other. Tighten both bolts to original factory specifications

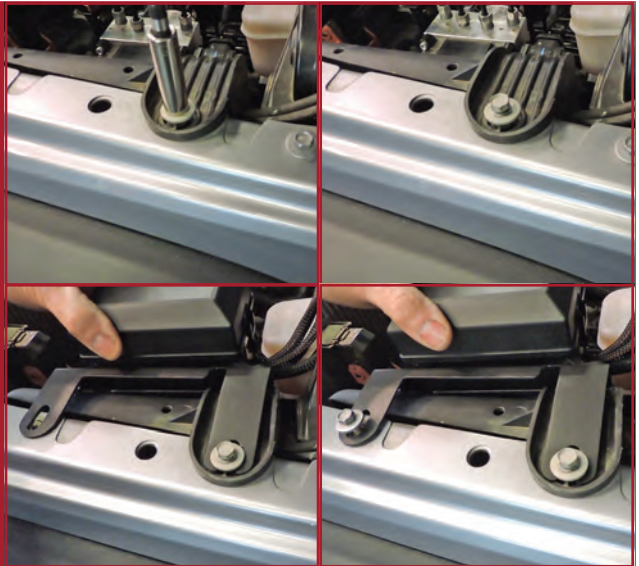

07

Locate the 10mm bolt about 6 inches forward of the bracket and attach the ground wire as shown



IDENTIFY WIRE LEADS:

Familiarize yourself with all of the wire circuits.

Please check our website, www.STechSwitch.com/Installs-new for the latest in installation updates and helpful hints to your installation.

FROM YOUR ACCESSORIES:

Only connect the positive side to the STECH OUTPUTS. By design, each of your accessories should be grounded at or near each accessory.

WIRE ID

A = Output Wires 1, 2, 3, 4 (5, 6)

B = Small Accessory Red Wire (Fuse Block, connect to Fuse tab and insert in Fuse Block Position M9)

C = Big Red Wire (12V Battery)

D = Black Wire (Ground)

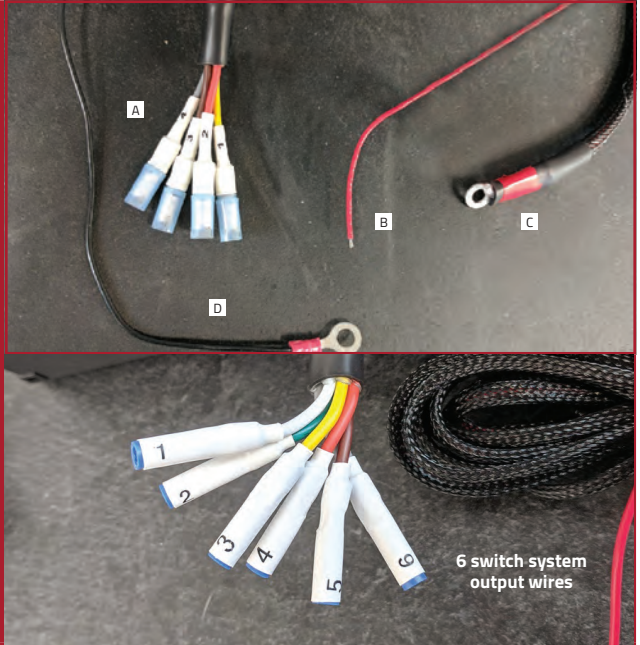

08

4 SWITCH SYSTEM

Position	Color
1	Yellow
2	Orange
3	Brown
4	Grey

6 SWITCH SYSTEM

Position	Color
1	White
2	Green
3	Yellow
4	Orange
5	Brown
6	Grey

BE SURE TO INSTALL THE CORRECT FUSE FOR YOUR ACCESSORY.

Install the fuse with the accessory manufacturers' recommendation on the amperage of each fuse location. Make sure it matches with the fuse location in S-TECH. Maximum Total Load 600 watts / at 12V, 72 amps. All circuits are capable of 30A each.

Example:

A 50" light bar would require a 30A fuse while a few LED rock lights would usually require less than 10A

Here's how the switch numbers relates to fuses and relays.

09

4 position switch system shown

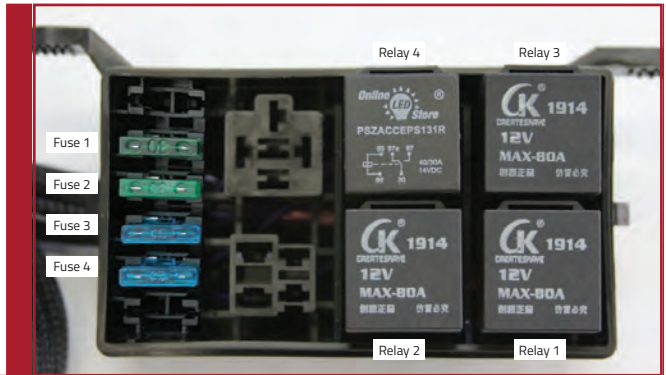

*** NOTE: Fuse layout is in the process of standardizing between all of our systems. Please confirm your specific S-TECH Fuse layout and use appropriate amperage fuses at all times.**

09b

6 position switch system shown

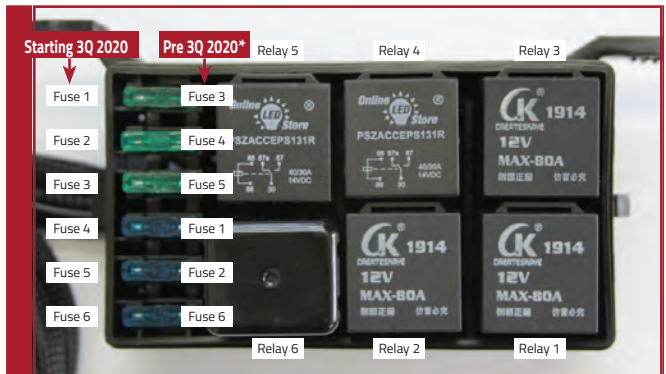

10

Temporarily remove the Drivers Side Sun Visor and upper/driver side interior trim piece above the rear view mirror while slightly loosening the factory wiring attached to it



11

After removing the interior trim and sun visor around the driver windshield area up to and including above the rear view mirror. Prepare the Upper Center trim piece above the rear view mirror as shown

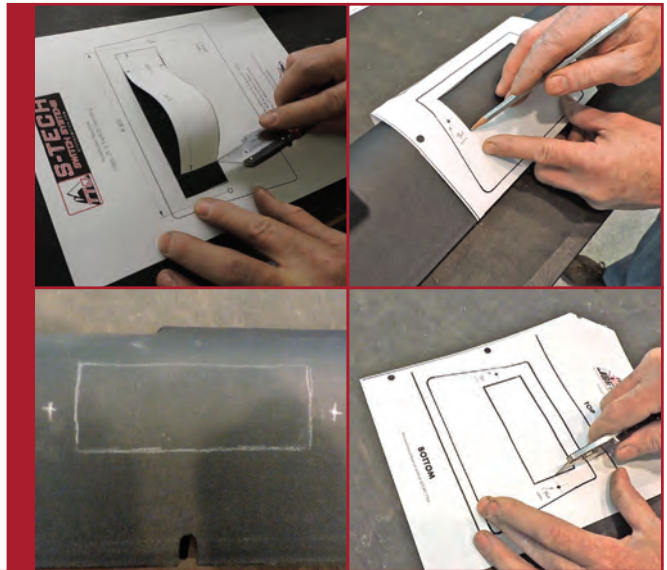

Using the supplied **S-TECH Template**, align the section marked "TOP" to the top of the interior trim from above rear view mirror trace out the rectangle and drill at the marks using a silver pencil or pen then cut that section out using a utility knife or dremel tool. This will allow the back of the switches some relief and penetrate into the interior trim piece.

REMEMBER: MEASURE TWICE CUT ONCE, DOUBLE CHECK YOUR WORK BEFORE MAKING ANY CUTS

- Check to make sure you are using the correct Template
- Measure the Template and Housing, make sure their dimensions match

12

Carefully cut out the rectangle section you just marked with a silver pen or pencil using a utility knife or dremel tool

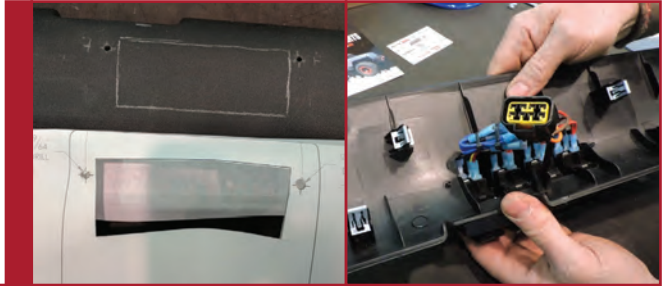

Passing the Harness through the Firewall



Close-up of hole "B" after removing grommet

If you have an **Automatic Transmission**, pass the switch housing connector end of the wire harness through the opening in the firewall where the Clutch Master Cylinder "A" normally would be on the drivers side firewall and feed the wire through the firewall and up the A-Pillar. After removing all of the required interior trim pieces, continue to route the wire to the top of the rear view mirror area.

If you have a **Manual Transmission**, use the hole "B" in the firewall that is approximately 6" above hole "A", it is used to pass the Windshield Washer Fluid hose through to the rear wiper. You will need to manipulate the grommet in such a way to allow the S-TECH harness to also pass through the same hole. After removing all of the required interior trim pieces, continue to route the wire to the top of the rear view mirror area.



13

Visit STechSwitch.com/Installation for additional photos

sales@STechSwitch.com ▪ 25587 Conifer Rd. | #105-220 | Conifer, CO 80433 | 720-307-7263

14

Pull the connector though into the drivers side floor area and attach the wire harness to the are under the trim using cable ties as needed

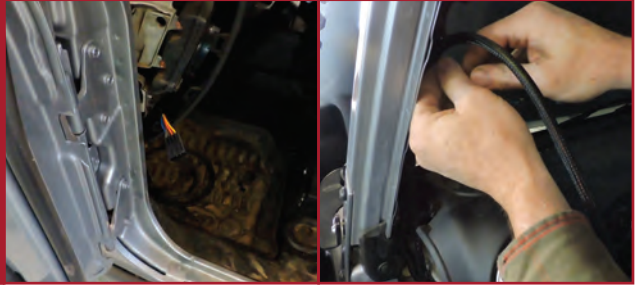

15

Plug the Control box connector to the switch housing connector, (be sure to hear the "CLICK")



16

Re attach interior trim pieces and sun visor around drivers windshield area you are now done on the inside



17

Time to power up the unit. Connect the large RED MAIN 12v power lead from the control box to the (+) side of the vehicles battery



Be sure to note the direction of the fuse tap relative to the Power Distribution Box.
NOTE: Front of Jeep.

OPTIONS TO INSTALL RED FUSE TAP AT LEFT. The fuse tap blades fit in either direction however, power is only delivered in the direction shown in the picture. Failure to install the FUSE TAP in the correct direction will result in NO POWER to the system.



Use the supplied Fuse Tap to provide for an "ignition on only" 12V source. CONNECT Fuse Tap to FUSE Location "M9" (Rear Heated Seats) This will enable the system when the ignition is turned on. Do not install the Red Accessory wire directly to a 12 volt source like a live fuse or the vehicles 12 V battery as this will drain your battery since the lower LED lights will be on all the time. Some customers have done this and installed a secondary switch (see inset photo) to the RED Accessory wire circuit to turn it On/ Off manually without the ignition on. However be very careful not to leave it on too long, it will drain our battery.

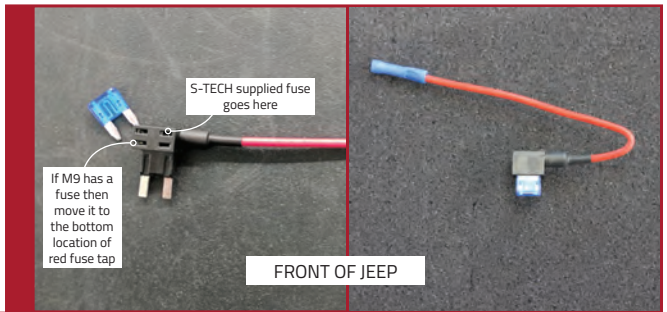
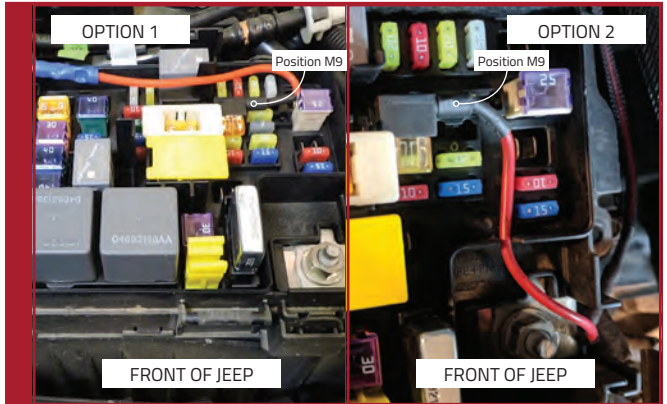

18

SWITCH PANEL OPERATION (Dual LED):

Ignition in the "On" position
or vehicle running
(lower LED bar lit)



Ignition in the "On" position or vehicle
running and Switch Accessories "ON"
(both LEDs are lit)



SWITCHES LEFT TO RIGHT: Switch Position 1, 2, 3, 4, (5, 6 only with 6 position)

NOTE:

If switches are inoperable recheck ground, 12V source and red ignition source for power.
Should you have troubleshooting questions check the S-TECH website
stechswitch.com/installs-new/#installationupdatespage or call us at 720-307-7263.

CONGRATULATIONS!

You have just completed the installation of your new
S-TECH SWITCH SYSTEM.

Any Questions or Comments please call

720-307-7263

or email us at

sales@stechswitch.com

For information & videos as well as printable / downloadable
instructions and templates, please visit

www.STECHSWITCH.com

sales@STechSwitch.com • 25587 Conifer Rd. | #105-220 | Conifer, CO 80433 | 720-307-7263



Other Vehicle Housing Solutions Available at:
stechswitch.com/accessories



Toyota Tacoma



Toyota 4 Runner



Jeep JL



Jeep JK



Dodge RAM



Chevy Colorado