

SA SERIES | GORTRAC[®] STEEL (open-style carriers)



SMALLEST STEEL CARRIER CURVE HEIGHT OF ONLY 3.5 INCHES (89mm)!

Key Features:

- Great for small O.D. wire management in high temperature applications such as thermal couple wires
- Self-cleaning link design expels debris from critical areas of the link during operation
- Standard construction is stainless steel. (Plated steel can be custom ordered)

PART NUMBER CONFIGURATION:

Model	Height	Length	Bracket (fixed)	Bracket (moving)
SA	35	15.00	#1STD	#1STD

Following above example, add dashes. Part number = **SA-35-15.00-#1STD-#1STD**

Carrier Length (between flanges) is specified to two decimals in inches. Total number of links depends on pitch length.

Specify bracket type (STD for standard) and arrangement # (1, 2, 3, 4).

SPECIFICATIONS

MODEL	A inches (mm)		C inches (mm)		WEIGHT lb/ft (kg/m)
SA	0.94 (24)		1.29 (33)		0.70 (1.04)
HEIGHT	R inches (mm)	H inches (mm)	K inches (mm)		CL inches (mm)
35	1.25 (32)	3.50 (89)	3.00 (76)		6.43 (163)

SA SERIES – WEIGHT LOAD

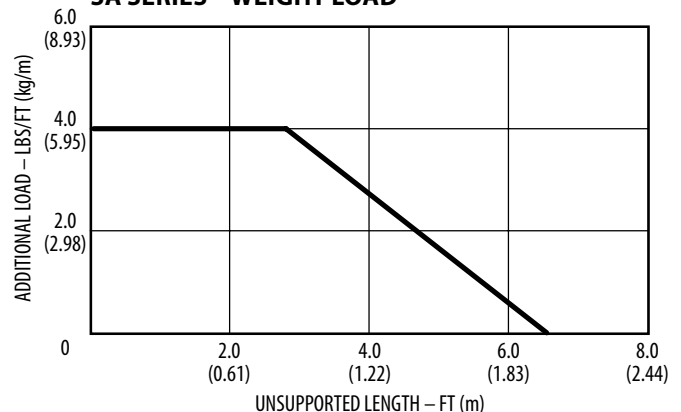

SA SERIES | GORTRAC[®] STEEL (open-style carriers)

CARRIER SIDE VIEW

Dimensions in inches (mm)

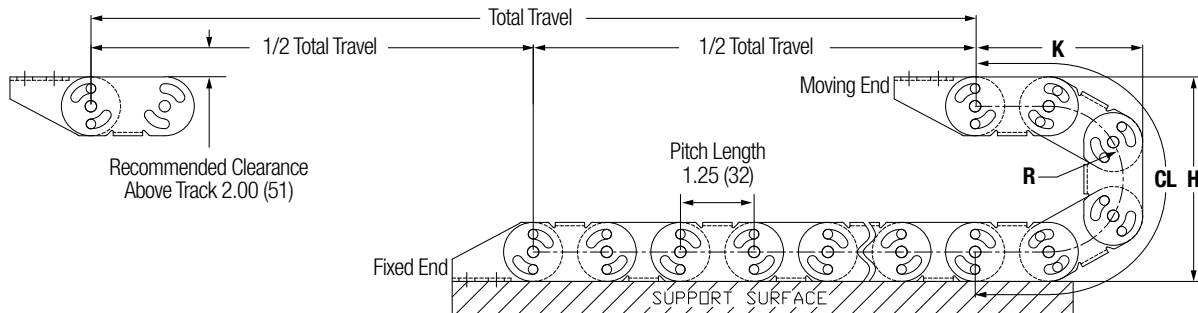

$$\text{Travel}/2 + \text{CL} (+ \text{Offset Distance From Center}^*) = \text{Length}$$

Dynatect recommends mounting the stationary end of the carrier at the center of travel, minimizing the required length. In cases where center mounting is not possible, add the distance offset from center to the carrier length calculation.

CARRIER CROSS SECTION

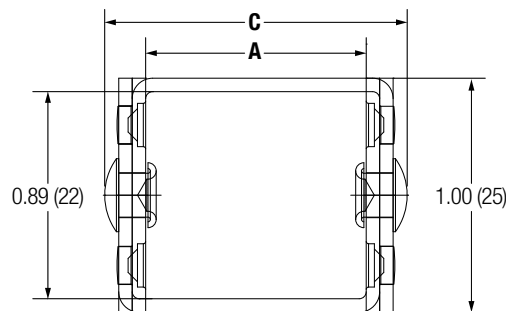

Dynatect Recommends: • 10% Cable Clearance • 20% Hose Clearance • 60% Maximum Fill

TOP VIEW MOUNTING BRACKET

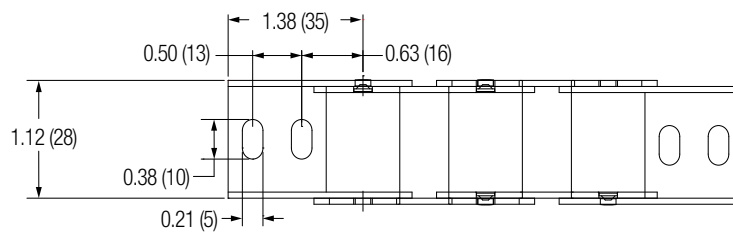

Dimensions Typ. Both Ends

BRACKET ARRANGEMENTS

Standard Mounting Bracket Arrangements

