

VIKING SAFE®

OWNER'S MANUAL®

MODEL:

VS-11PZ FAST ACCESS FINGERPRINT BIOMETRIC GUN SAFE

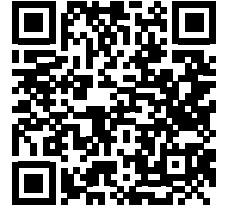

User's Manual online



FBI CERTIFIED GOLD PLATED BIOMETRIC SENSOR

PATENTED

HIGH SECURITY M4-LOCK CAM AND KEY

PATENTED

HIDDEN RESET BUTTON

CANNOT BE ACCESSED FROM THE OUTSIDE

DIMENSIONS

(in) H 4.05 x W 15.35 x D 7.48

(cm) H 10.3 x W 39 x D 19

WEIGHT

(lb) 8.26

(kg) 3.75

IMPORTANT - READ FIRST!!!

- **IN DEFAULT MODE** only Default PIN 1234 works. Fingerprint function is disabled.
 - **CHANGE the DEFAULT PIN 1234 to YOUR UNIQUE PIN**, or else anyone can access your safe!
 - **REGISTER TWO OR MORE DIFFERENT FINGERPRINTS PER USER.**
 - **PLACE YOUR FINGERPRINT FIRM and FLAT** touching **BOTH** the Fingerprint Sensor **and** the Frame Around it.
 - **5 INCORRECT PIN or FINGERPRINT** Puts your safe in TIME-OUT for 2 min.
 - **BOLT DOWN YOUR SAFE AFTER TESTING** all functions.
 - **NEVER STORE THE OVERRIDE KEYS** to This safe inside the safe.
 - **WHEN LOW BATTERY** is indicated "  " replace with new batteries. All data will be SAVED.
- ⚠ NOTE: IF BUTTON "A" STOPS RESPONDING ON PRESSING** Close and Open your safe. RESTART THE REGISTRATION PROCESS.

1. HOW TO START?

- 1.1. Unlock your safe with its High Security Override Key provided. Locate battery compartment and install the 4 AA batteries.
- 1.2. Locate Button "A" **Hidden** inside the Battery Compartment and Master Reset your safe by pressing Button "A" **3 consecutive times**.

⚠ NOTE: IN DEFAULT MODE only Default PIN 1234 works. Fingerprint function is disabled. To activate, register 1 or more fingerprints.



2. HOW TO MASTER RESET YOUR SAFE?



Master Reset will erase all programming and will bring your safe to Default Mode.

- 2.1. Locate Button "A" **Hidden** inside the Battery Compartment.
- 2.2. **Press Button "A" 3 consecutive times to Master Reset your safe.**

You'll hear short beeps and flashes with each press followed by a long beep and brief solid light. This confirms all data is erased and Master Reset is complete. Your safe is in Default Mode and ready to be programmed.

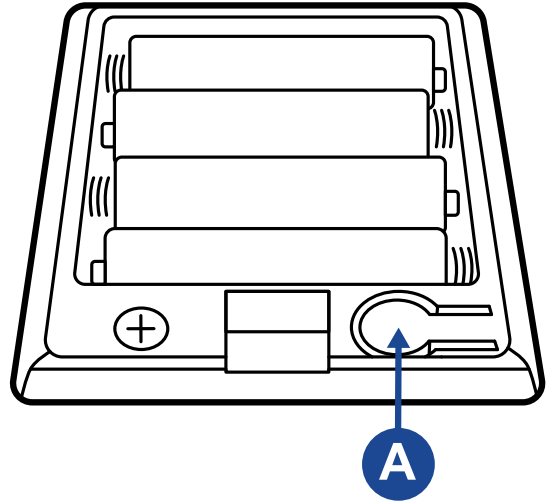

3. HOW TO CHANGE PIN CODE?

- 3.1. Locate Button "A" **Hidden** inside the Battery Compartment.
- 3.2. **Press Button "A" Once to initiate change of PIN.** Prompted by 2 beeps and flashes Enter your NEW 4- digit PIN Twice in a Row. You'll hear short beeps and flashes between entries followed by a long beep and brief solid light. This confirms the registration of your NEW 4- digits PIN Code.
- 3.3. **TEST the PIN:** Only your NEW PIN should unlock your safe.

⚠ NOTE: If changing PIN fails, for example, if the digits of the PIN entered are not identical, 5 beeps and Red flashes will indicate an error. Simply repeat step 3.1.



4. HOW TO REGISTER FINGERPRINTS?

⚠ IMPORTANT! Make sure your fingerprints are clean, dry and blemish-free when using the fingerprint sensor.

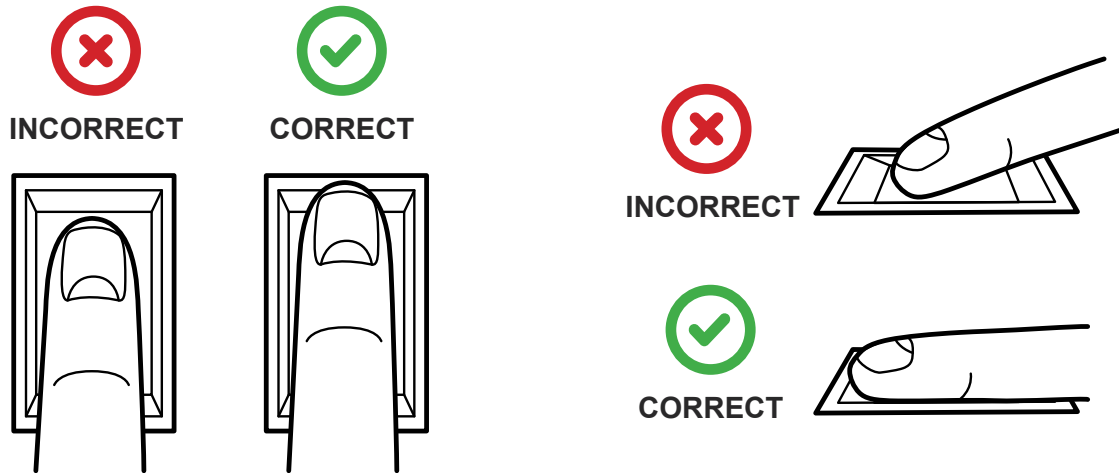

PLACE YOUR FINGERPRINT FIRM and FLAT TOUCHING BOTH the FBI CERTIFIED FINGERPRINT SENSOR AND THE FRAME AROUND IT

- 4.1. **Press Button “A” Once to initiate Fingerprint registration.**
- 4.2. Prompted by 2 beeps and flashes place your fingerprint **FIRM and FLAT** touching **both** the sensor and the frame around it.
- 4.3. **Lift and Place** the same fingerprint with the next prompt - 2 beeps and flashes **Prompts should be 1 second apart.** Keep Lifting and Placing back the same fingerprint until a Long Beep and a Brief Solid Light confirms the registration of 1 fingerprint.

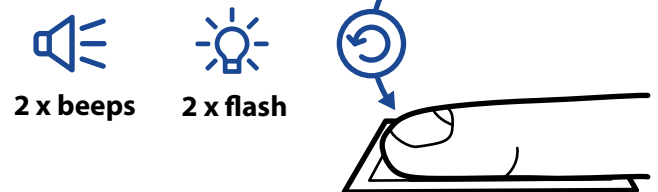

IMPORTANT



If a delay is detected during fingerprint registration - no sound and no flashes for more than 1 sec., simply Lift and Place the same fingerprint again. Continue - repeatedly Lift and Place your fingerprint on the sensor until you hear a long beep and a brief solid light.

- 4.4. To register another fingerprint, repeat the steps.
 - 4.5. **TEST the Fingerprint:** Only your REGISTERED Fingerprints should unlock your safe.
- 💡 NOTE:** Each fingerprint may take different numbers of repetitions to collect, bundle and store high-resolution images of the same fingerprint. This will assure fast and accurate read every time. Next Generation 3D technology works below the surface of the skin to recognize living tissue, while Anti-Spoof is eliminated.

5. HOW TO UNLOCK YOUR SAFE WITH FINGERPRINT

- 5.1. UNLOCK: Press ANY button on the keypad to “Wake Up” the sensor.
 - 5.2. Activation Indication will turn solid green light as a prompt.
 - 5.3. Place Registered Fingerprint touching **both** the fingerprint sensor and the frame around it and the door on your safe will pop open.
-

6. HOW TO UNLOCK YOUR SAFE WITH PIN

- 6.1. UNLOCK: Enter your PIN and the door on your safe will pop open.
-

7. HOW TO UNLOCK AND LOCK THE SAFE WITH A KEY

⚠ WARNING! NEVER STORE THE OVERRIDE KEYS to This safe inside the safe.

- 7.1. UNLOCK: Insert your Top Security Key with the indentation facing up and rotate.
-

8. HOW TO LOCK YOUR SAFE?

- 8.1. Simply shut the door close. Safe will lock automatically.
-

9. HOW TO TURN THE LED LIGHT ON

- 9.1. The Light on your safe will turn on for 20 Seconds every time your safe is open.
 - 9.2. Press any button on the keypad to turn the LED light for another 20 Seconds.
-

10. HOW TO TURN SOUNDS ON/OFF

- 10.1. In Default Mode all sounds are ON.
 - 10.2. To turn SOUNDS ON/OFF: Press and hold button #1 (left on the keypad).
 - 10.3. The Keypad will Light Up briefly and a Long Confirmation beep will indicate Sounds are ON. Or NO Confirmation beep to indicate Sounds are OFF.
-

11. HOW TO CHECK ON BATTERY CHARGE

- 11.1. Press any button on the keypad to see battery level.

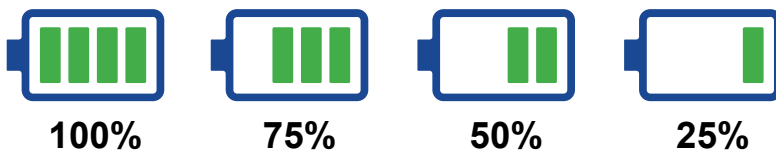

⚠ NOTE: Please change battery at 25% to keep the operation of your safe flawless.



12. MOUNTING THE SAFE

- 12.1. Choose a secure and convenient place to mount your safe.
- 12.2. Use the predrilled holes on the safe to mark where to place the screws.
- 12.3. Drill holes where previously marked and secure in place.

▲ NOTE: Your safe comes with a mounting bracket allowing it to be secured to a wall, desk, in a cardboard or closet, etc.

CHEAT SHEET

MASTER RESET - Press Button "A" 3 consecutive times.

CHANGE PIN - Press Button "A" Once and Enter NEW PIN Twice in a Row.

FINGERPRINT REGISTRATION - Press Button "A" Once. Place one fingerprint on the sensor and Lift it at the prompt. Repeatedly LIFT and PLACE one fingerprint till you hear a Long Confirmation Beep.

BATTERY CHARGE - Press any button.

TURN SOUNDS ON/OFF - Press and hold button # 1.

TURN ON LIGHT - Press any button.

TROUBLESHOOTING

- **IF BUTTON "A" STOPS RESPONDING ON PRESSING** Close and Open your safe. RESTART THE REGISTRATION PROCESS.
- **IF DELAY IS DETECTED during fingerprint registration** - no sound and no flashes for more than 1 sec., simply Lift and Place the same fingerprint again. Continue: repeatedly Lift and Place your fingerprint on the sensor until you hear a long beep and a brief solid light.
- **TIME OUT** - If 5 errors in a row - Incorrect PIN or Fingerprints are input, your safe will go in Time-Out for 2 min. All electronic function will be disabled and Warning Alarm will sound. Use your key to unlock your safe and remove one battery to stop the Warning beep before time is up.
- **TO DISABLE the 2 min WARNING ALARM before time is up** - Unlock your safe with the key and remove one battery.

For additional product information, FAQ's and troubleshooting, visit:

