

ELECTRICAL OUTLET INSTRUCTIONS



THINGS YOU'LL NEED:

- Power Drill
- 3/8" Drill Bit
- Philips Screwdriver
- Flat-Head Screwdriver
- Hammer
- Box Cutter or Knife

STEP-BY-STEP INSTRUCTIONS:

1



Locate/mark-off (on the exterior of the safe) where you would like to drill the hole for the cord to run through to the inside of your safe.

Use the **3/8" drill bit** to drill **only through the steel** on the outside of the safe. Once you get through the steel and to the fireboard **STOP DRILLING**.

IMPORTANT: Do not drill through the fireboard. It will tear the fabric on the inside of the safe.*

Please Note: Many safes already have a 3/8" hole pre-drilled in the back of the safe. Please check before drilling the hole.

2



Take a small **flat-head screwdriver**, insert into the drilled hole. Using the hammer, **lightly hit the back of the screwdriver** to lightly chisel through the fireboard **until you hit the fabric on the inside** of the safe.

3



Locate the hole positioned on the **inside of the safe** where the flathead poked through. Use a knife or box cutter to **cut an X in the fabric** to create opening flaps over the hole.

This step ensures you do NOT twist up and damage the fabric while drilling through the fireboard.

4



Drill through the fireboard from the outside of the safe. Use a vacuum to clean up any debris on the inside of the safe (from drilling through the fireboard).

**Stealth is not responsible for any damages to your safe.*

TURN OVER

INSTRUCTIONS CONTINUED

5



Feed the power cord through the hole from the outside of the safe.

Ensure the power cord is not plugged into an outlet during these steps.

From the inside of the safe, take the wire connector and flip up all the orange tabs.

Then, one-by-one, insert the **exposed wire into the connector**.

***Match up the cords with small writing across from each other.**

(RECOMMENDED: First insert the cord with small writing on it into the terminal, then line up the rest on that side)

After the wire is **completely inserted** into the terminal, **flip the orange tabs down** to secure the wire.

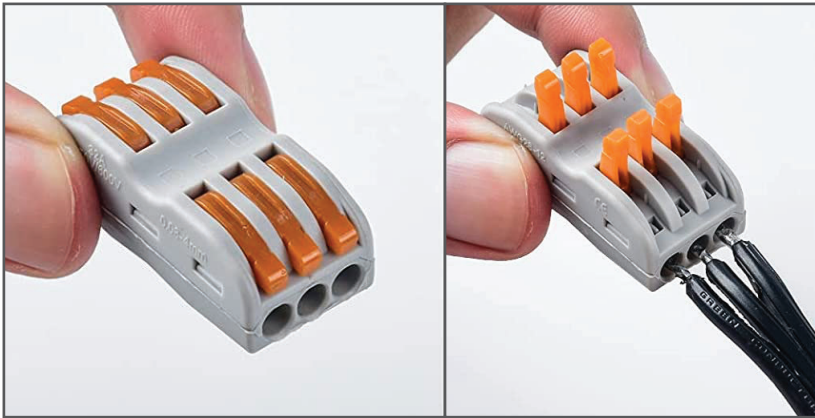

Take Wire Connector & Flip Open Orange Tabs



Insert Exposed Cords with writing on them lined up



STRONGLY RECOMMENDED

We **STRONGLY RECOMMEND** to **wrap the entire wire connector and all loose wires in electrical tape as a safety measure** when installing this outlet unit in your safe.

Electrical tape can also hide the wires and give a clean look to the cord.

Questions or Concerns?

✉ Info@StealthSafes.com

☎ (877) 486-7233



www.StealthSafes.com

MOUNTING INSTRUCTIONS

Mounting on **Carpet** Interior

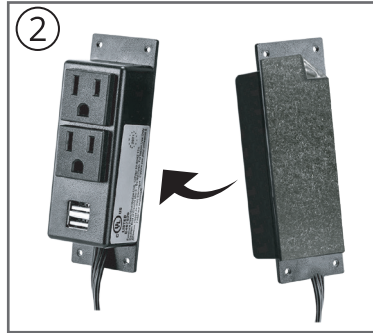

USING VELCRO STRIPS:

- ① **Peel off adhesive covering on hook portion** of the included strip of Velcro.
- ② **Attach adhesive side to the back of the outlet unit.**

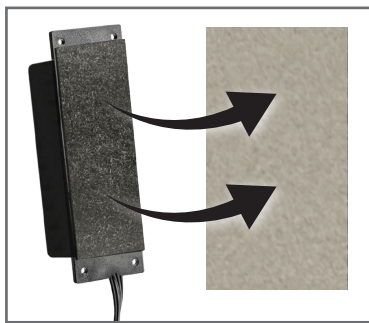

Position the outlet unit on the carpeted interior of your safe where you'd like it to sit.

NOTE: This hook material is able to attach to the fabric on most safes. Not all fabric is compatible with Velcro.

Mounting on **Steel Wall** Interior

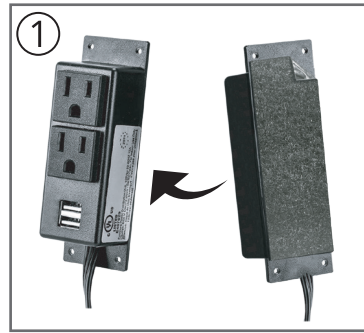

USING VELCRO STRIPS:

- ① **Peel off adhesive covering on one strip of Velcro** and attach it to the back side of the outlet unit.
- ② **Peel off adhesive to second Velcro strip and position it on the steel wall** where you want it to sit inside your safe.

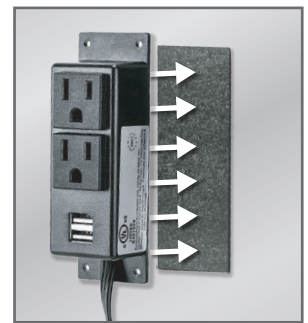
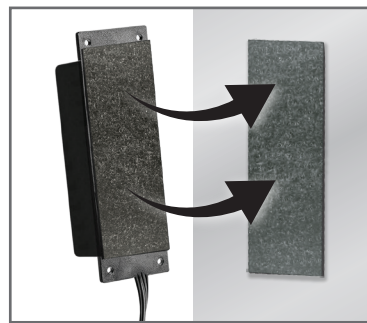

Simply line up and attach the Velcro on the back of the unit to the Velcro you placed on the interior wall of the safe.

Instructions for **Screwing** Outlet to Safe Interior Walls

For All Fire Rated Carpeted Gun Safes, use [Fine Thread Drywall Screws](#). For All Cabinets & Non-Fire Rated Safes, use [Self-Tapping Metal Screws](#).