



# SHOTLOCK™

**200 SERIES OWNER'S MANUAL**

*AR Solo-Vault™*

*Shotgun Solo-Vault™*

*Handgun Solo-Vault™*

*Quickdrawer Solo-Vault™*

# **SHOTLOCK™ OWNER'S MANUAL**

Thank you for purchasing a ShotLock Solo-Vault™. Now, you can enjoy peace-of-mind knowing your personal defense firearm is always close, secure and ready. When the first-responder is YOU, there may be no time to fumble with trigger locks or open your gun safe. With ShotLock your home defense firearm is at-the-ready in seconds. This Owner's Manual will guide you in the assembly and installation of your Solo-Vault on a wall under a table or in a vehicle\* putting the security you need, right where you need it, when you need it.

*\* Before using this product to transport any firearm or mount in any type of vehicle, make sure you are conforming to all applicable local, state and federal laws.*

*\* Note: Never store a firearm loaded.*

**IMMEDIATELY REGISTER YOUR VAULT  
at [www.shotlock.com/register](http://www.shotlock.com/register)**

**PLEASE CAREFULLY REVIEW YOUR WARRANTY:**  
Your ShotLock Solo-Vault is covered by a 2 Year Limited Warranty, which will be honored from the date of purchase by the original owner provided the ShotLock is registered within 30 days of purchase.

# **TABLE OF CONTENTS**

## **Section I - ShotLock for Shotguns**

**Page 4-7**

## **Section II - ShotLock for Handguns**

**Page 8-9**

## **Section III - QuickDrawer Solo-Vault**

**Page 10-13**

## **Section IV - AR Solo-Vault**

**Page 14-16**

## **Section IV - Locks and Lock Operation**

**Page 17-25**

## **Section IV - Warranty/Contact Information**

**Page 26-27**

**Back Cover - *Contact Information***

# SHOTGUN SOLO-VAULT™



## » FEATURES

- Accommodates left and right handed shotguns.
- Secures most pump, semi-auto, double barrel, side by side and over/under shotguns.
- Will fit some pistol grip (pump) shotguns.
- Flanged, no pry lid with dual internal locking hooks.
- Military grade 14 gauge steel construction.
- Exterior Dimensions:  
7.5" x 5.75" x 2.25"
- Interior Dimensions:  
7.25" x 3.875" x 2"

**SEE PAGES 10-13**  
for the M-Series Lock.  
(Mechanical)

**SEE PAGES 14-17**  
for the E-Series Lock.  
(Electrical)



# SHOTGUN SOLO-VAULT PARTS

\* Owner's Manual  
\* ShotLock Sticker

Shotgun Solo-Vault Body

Foam Bed Liners (2)

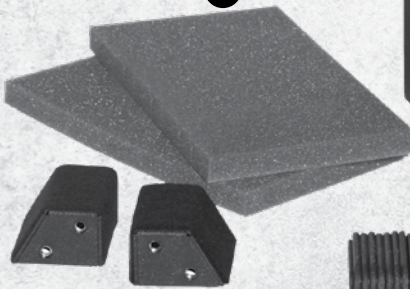

Adjustable Trigger Guard Blocks (2)

3

Pump Ejection Port Hanger (1)

4



E-SERIES ONLY:  
-Emergency Battery Backup Kit (1)  
-Allen Wrench (1)  
-AA Batteries (4)



Override Key (3)

7



5

M5x14mm Trigger Block Mounting Screws (4)

6

#14 Flat Head Phillips Vault Mounting Screws (4)



## MOUNTING YOUR SHOTGUN SOLO-VAULT

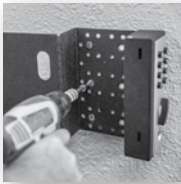

1. Securely attach vault in convenient location with the provided Vault Mounting Screws. \*
2. Pump Ejection Port Hanger may also be mounted on opposite side to reverse the direction the door opens.

*Don't forget, adhere logo sticker to front.*

**\* PLEASE NOTE : In order to be compliant with California DOJ standards, the Shotgun Solo-Vault must be mounted to a surface using the Mounting Screws, and the firearm must be secured using the Ejection Port Hanger or Trigger Blocks. The exposed screws on the back should not be accessible once the device is mounted and locked.**

## ▶▶ ASSEMBLY FOR SEMI-AUTO AND OVER/UNDER SHOTGUNS

1. Lay vault down either left or right opening, as preferred.
  2. Lay shotgun down inside vault with bolt, handle pointing up and position Trigger Guard Blocks snugly around trigger assembly.
  3. When action is closed, bolt handle should extend outside the vault through the door opening, and as close as possible to the top of the door.
  4. When action is open, handle will protrude through the hole in the door.
  5. Trace the positions of the Trigger Guard Blocks onto the Foam, then cut Foam Bed Liners to fit around Trigger Guard Blocks.
  6. Using M5x14mm screws attach Trigger Guard Blocks to securely confine trigger assembly inside vault.
  7. Insert Foam Bed Liner.
- \* The second piece of foam is a backup.

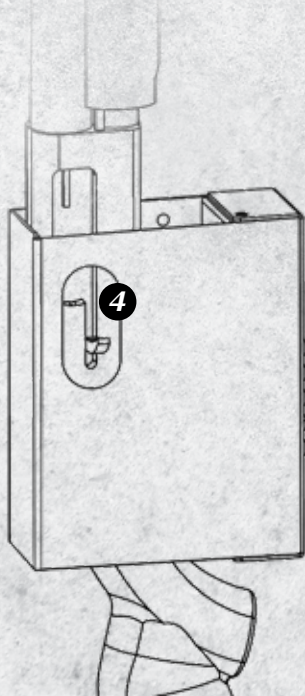
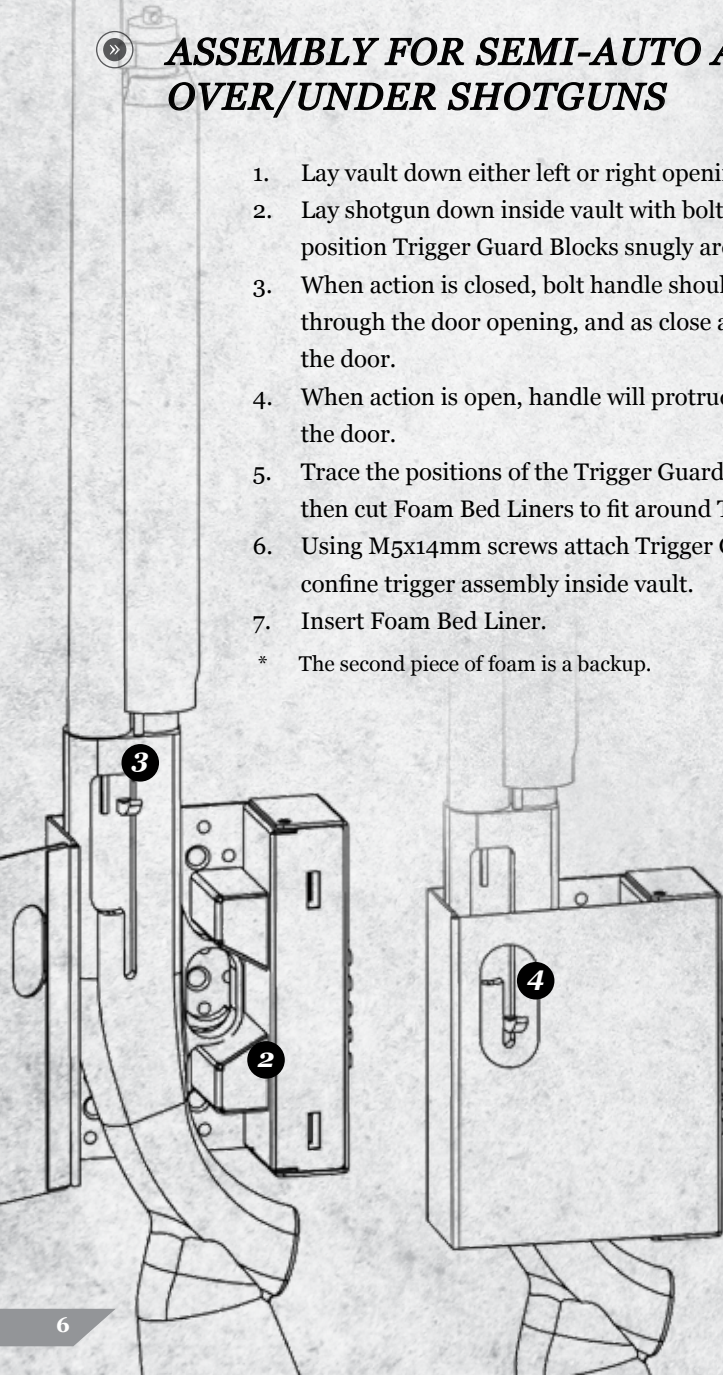

## ASSEMBLY FOR PUMP SHOTGUNS

1. Lay vault down either left or right opening, as preferred.
  2. For right-handed shotguns, Pump Ejection Port Hanger will be mounted top right. For left-handed shotguns, Pump Ejection Port Hanger will be mounted top left.
  3. Trace the position of the Pump Ejection Port Hanger onto the Foam Bed Liner, then cut Foam Bed Liner to fit around Hanger.
  4. Using M5x14mm screws attach Pump Ejection Port Hanger to inside of vault.
  5. Insert Foam Bed Liner.
  6. With action open, place ejection port over Pump Ejection Port Hanger.
- \* The second piece of foam is a backup.

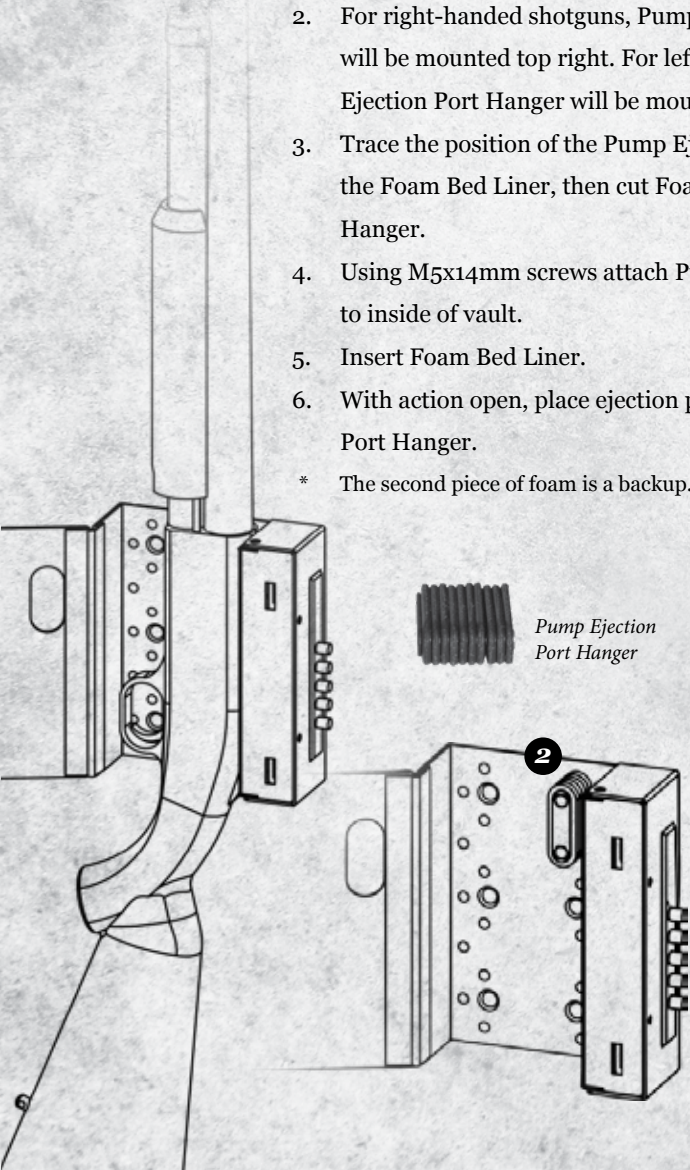

*Pump Ejection  
Port Hanger*

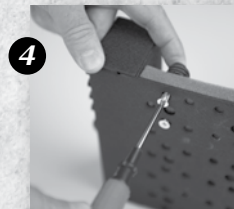
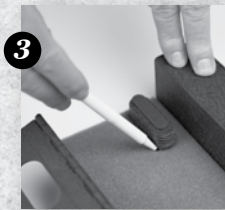

# HANDGUN SOLO-VAULT™



## » FEATURES

- Secures up to a 1911 sized full framed handgun.
- Mounts on a wall, flat surface or in a vehicle.
- Carrying handle and cable holes for ultra portability. (Cable not included).
- Military grade 14 gauge steel construction.
- Flanged, no pry lid with dual locking hooks.
- Exterior Dimensions:  
7.5" x 5.75" x 2.25"
- Interior Dimensions:  
7.25" x 3.875" x 2"

**SEE PAGES 17-20**  
For the M-Series Lock.  
(Mechanical)

**SEE PAGES 21-24**  
For the E-Series Lock.  
(Electrical)



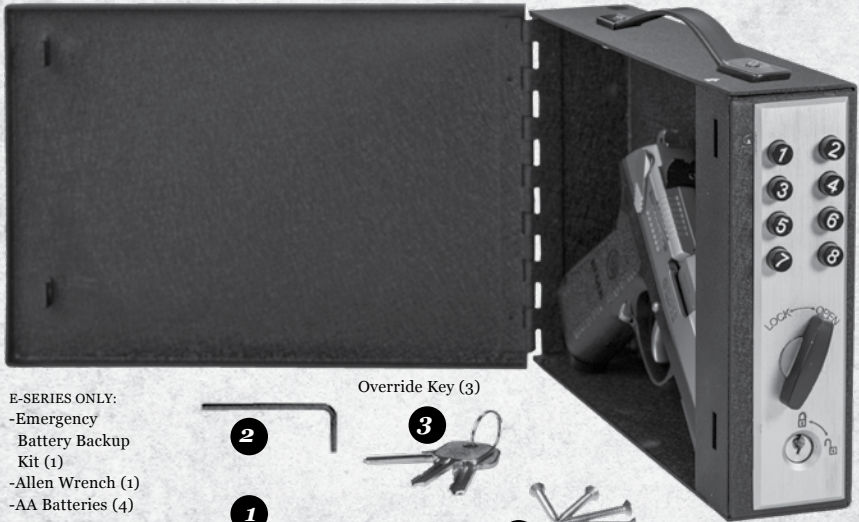

E-SERIES ONLY:

- Emergency Battery Backup Kit (1)
- Allen Wrench (1)
- AA Batteries (4)

Override Key (3)

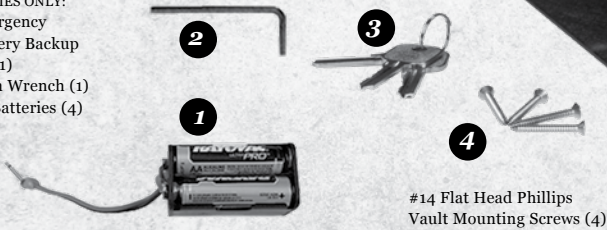

#14 Flat Head Phillips  
Vault Mounting Screws (4)

*Your Handgun Solo-Vault can mount virtually anywhere.*

## » MOUNTING YOUR HANDGUN SOLO-VAULT

1. Securely attach Handgun Solo-Vault in convenient location using 4 mounting screws.
  2. You may also secure your Handgun Solo-Vault by threading a heavy 5/16" locking cable through the provided port holes.
- *Be sure to adhere the ShotLock logo to the front side of your Handgun Solo-Vault.*



# QUICKDRAWER SOLO-VAULT™



## » FEATURES

- Secures up to a 1911 sized full framed handgun.
- Provided mounting plate allows for top or bottom side mounting..
- Over 1,500 four-button lock combinations.
- Military grade 14 gauge steel construction.
- Spring assisted drawer opening.
- Key override system.
- Exterior Dimensions:  
11" x 8" x 3.6" (4" with plate)
- Interior Dimensions:  
9" x 7" x 2.2"
- 2 year limited warranty

1. Turn knob left (counter-clockwise) to CLEAR position and release. Knob will spring back.

**SEE PAGES 17-20**  
For the M-Series Lock.  
(Mechanical)



# QUICKDRAWER SOLO-VAULT™ 200M PARTS

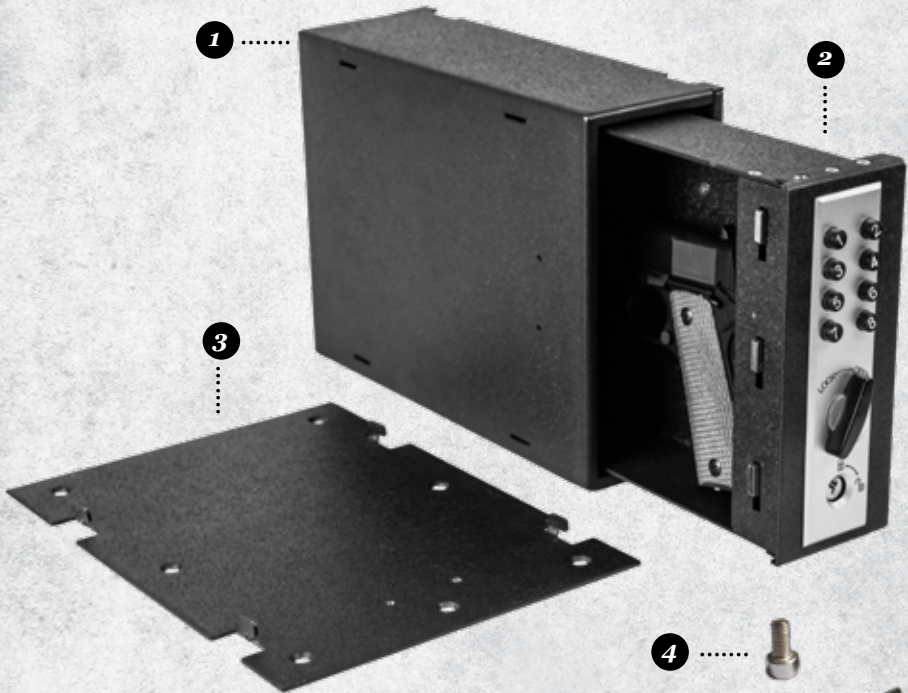

1. *Body (1)*
2. *Drawer (1)*
3. *Mounting Plate (1)*
4. *Mounting plate screws (2)*
5. *Allen Wrench (1)*
6. *Flat head Phillips surface mounting screws (6)*
7. *Override Keys (3)*

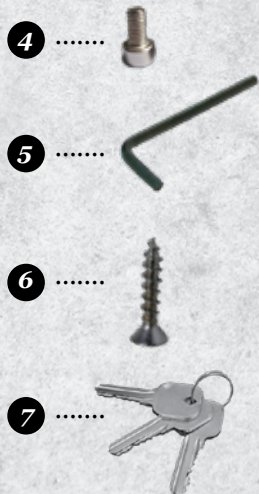

## » MOUNTING YOUR QUICKDRAWER SOLO-VAULT 200M

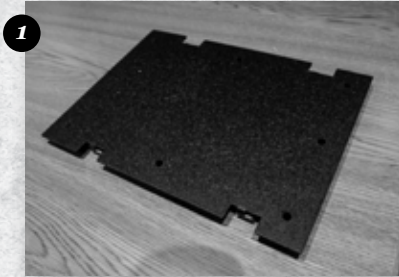

1. Remove cover plate from body.

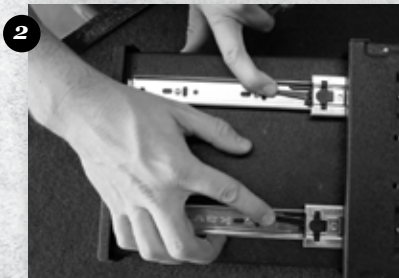

2. Open the unit. Flip upside-down, and then press the tabs located on the bottom of the glides. Once released, pull the drawer out and set aside.

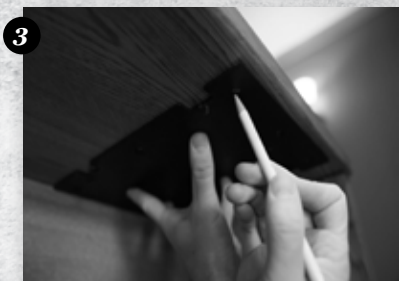

3. Hold the mounting plate in desired location, making sure hooks are facing outwards, and mark holes for drilling with a pencil. Set plate aside and drill pilot holes with a 1/8" drill bit.



4. Attach the mounting plate (using a screwdriver or power drill) to desired surface using provided surface mounting screws.

5. Slide body into mounting plate hooks, making sure hooks are inserted all the way. *At this point the body is not secured to the mounting plate. Be careful the body does not come free of the mounting plate.*

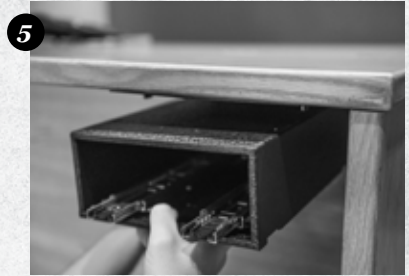

6. Attach body to mounting plate using provided mounting plate screws and Allen wrench.



7. Reinsert drawer into body by carefully lining up glides, and pushing drawer in until you hear a distinct click.



8. Test the drawer unit by unlocking and pressing to activate the spring-loaded release.



# AR SOLO-VAULT™



## » FEATURES

- Secures AR platform rifles with pistol grips and top rail mounted optics.
- Mounts on a wall or in a vehicle.
- Over 1,500 four-button lock combinations.
- Military grade 14 gauge steel construction.
- Flanged, no pry lid.
- Dual locking hooks.
- Key override system.
- Exterior Dimensions:  
13" x 10.5" x 3.25"
- Interior Dimensions:  
12.375" x 9.75" x 3"
- 2 year limited warranty

**SEE PAGES 17-20 & 25**  
For the M-Series Lock.  
(Mechanical)



## AR SOLO-VAULT™ 200M PARTS



1. Flat head Phillips surface mounting screws. (3)
2. Override Keys. (3)
3. Pistol grip hanger.
4. Lock module access.
5. Bumper Stops.
6. Magazine Shelf.



Two 30 round magazines.



One 30 round magazine.

# **MOUNTING YOUR AR SOLO-VAULT:**

- Determine desired mounting location.
- Locate stud in wall.
- Secure AR SOLO-VAULT to Stud using 3 mounting screws (provided)
- Adjust Pistol Grip Hanger as necessary by loosening the 2 (7 mm) attaching nuts and sliding the hanger to the desired position. When desired position is achieved, re-tighten the 2 (7 mm) nuts.
- Set combination on lock (following instructions in owners manual).

Securely attach vault in convenient location with the provided Vault Mounting Screws.

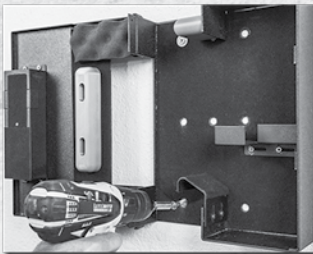

*Ensure all 3 mounting screws are in a stud to achieve maximum security*

Pistol Grip Hanger 7 mm adjusting bolts





# **M-SERIES LOCK** *(mechanical)*

## » **FEATURES**

- All mechanical operation, no batteries or wires.
- Over 1500 customizable push button combinations.
- Easily change your combination.
- Tamper proof lock clutch. Knob will spin when an incorrect combination is entered.
- Built in Key Override for backup access. (3 extra keys)
- 2 year limited warranty.

**RECORD YOUR NEW  
COMBINATION AND KEEP  
IT IN A SAFE PLACE**

--	--	--	--

*\* Pick any 4 numbers (no duplicates)*

*If you lose your combination and all three override keys, contact customer service at 800.852.0400*





## **OPERATING THE M-SERIES MECHANICAL LOCK**

**TO OPEN WITH FACTORY CODE:** Factory combination is 1 - 2 - 7 - 8.  
Before setting the new combination, we recommend recording your new password in the provided space on page 10.

- *Changing your combination can usually be done in less than five minutes. Please reference pages 12-13 to change your electric lock combination.*

---

### **UNLOCK**

---



*Enter in your four digit combination code, (each punch should provide a distinct “click”).*



*Turn the locking knob to the “Open” position and then proceed to open the door.*

---

### **LOCK**

---



*Ensure the locking knob is in the “Open” position and then close the door.*



*While holding the door closed, turn the locking knob to the “Lock” position.*

---

### **KEY OVERRIDE**

---



*Insert your key into the lock and turn to unlock position. Then turn the locking knob into the “Open” position.*

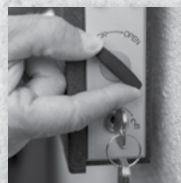

*When finished, close the door, and turn locking knob to “Lock” position. Return key into lock position, and then remove the key.*



## CHANGING COMBINATION (M-SERIES LOCK)

**Introduction:** Changing your combination can usually be done in less than five minutes. Of the 8 numbers possible, 4 numbers will need to be used for your custom combination. Factory combination is 1 - 2 - 7 - 8. Also, before setting the new combination, we recommend you record the new four digit code on page 10 of this manual.



**\*See page 25 for AR lock module access.**

### GETTING STARTED

1. Remove both Phillips screws (one on each side of the box) and slide the metal cover vertically.
2. Pull the lock module out as shown (no hardware disassembly required).
3. Once the combination pin box is removed, use your thumb to push the center gray slide and either the left or right unlock button to release the spring pressure, on all 8 pins (buttons facing up).
4. While holding these two buttons, pull out the A, B, C, and D pins (stamped on side of the pins).
  - These four pins are your combination pins. Place the four pins on a table and release the thumb pressure on the two buttons.
  - All remaining pins are blanks, and will always be located in the slots not associated with the combination. All blank pins are identical and can be inserted into any (non-combination) locations.

### SETTING NEW COMBINATION

5. Any new combination you pick will always need to be sequential when you enter your combination to unlock your ShotLock. For example : when entering the numbers out of your chosen sequence, it will not open.
6. To obtain the correct sequence with your new combination, we suggest to record your code in the designated box on **page 10**.

7. To insert the pins back into the module, press the two slides at the same time (see step 3). Proceed to insert the four pins into the correct locations.

- Any blank that may be still in one of these slots, can be removed and placed into any other location.
- Each time you insert a pin, gently push the pin all the way in to insure it is seated into its location.

8. Once finished, and all eight pins are installed, release your thumb, and gently press all eight pins to insure each snap in and out smoothly. If a pin does not, simply repeat steps 3 and 7 for that individual pin.

9. Once your new combination is complete, simply set the module back into its location. If the module seats into its three location pins, it will snap in place, and stay put in its cradle. If the module won't stay in place, put back into the cradle until you feel it snap into place.

10. Slide the metal cover back into place. Place special attention and have the cover follow the vertical guide rails. **(See page 25 for AR access).**

- If the cover won't go on easily, that usually means your lock module is not snapped into proper place.

11. Insert the two Phillips screws back into place, and now you are done!

12. Once installed, we recommend trying your new combination with the ShotLock door still open, in case you have placed a pin incorrectly by accident and the combination does not work as planned. If this happens, just remove again, and follow the previous instructions.



# ***E-SERIES LOCK*** (electrical)



## ***FEATURES***

- Over 1.3 million customizable button combinations.
- Tamper proof lock clutch. Knob will spin when an incorrect combination is entered.
- Built in Key Override for backup access. (3 extra keys)
- Easy combination change procedures.
- Emergency Battery Backup Kit.
- 2 year limited warranty.
- Low battery indicator.

### ***RECORD YOUR NEW COMBINATION AND KEEP IT IN A SAFE PLACE***

*\* Use between 4 and 10 digits / numbers can be used more than once.*

*If you lose your combination, keys, and Emergency Battery Backup kit, please contact customer service at 800.852.0400*





## **OPERATING THE E-SERIES ELECTRICAL LOCK**

**TO OPEN FOR THE FIRST TIME:** Batteries are included but not installed. You will need to access the ShotLock using the Key Override to install the batteries initially.

**TO OPEN WITH FACTORY CODE:** Factory combination is 1 - 2 - 3 - 4 plus “OK”. You will hear a single short beep if the combination was successful. A short double beep indicates a wrong combination was entered. To change the combination please see page 16.

**TO CHANGE THE BATTERIES:** A short triple beep indicates low battery power. To change the batteries, first open the ShotLock to access the interior battery cover plate. Use the provided Allen Wrench to remove the battery cover plate, and replace the 4 AA batteries. Reattach the battery cover plate.

**TO DISABLE THE BEEP:** If you wish to turn off the beeps emitted by pressing a button, simply press and hold “1” for 5 seconds. To re-enable the beeps, press and hold “2” for 5 seconds.

---

### **UNLOCK**

---



*Punch in your multi-digit code, then press OK. You will hear a single short beep if the code was successful.*



*Turn the locking knob to the “Open” position and proceed to open the door.*

---

### **LOCK**

---



*Ensure the locking knob is in the “Open” position and then close the door.*



*While holding the door closed, turn the locking knob to the “Lock” position.*

---

### **KEY OVERRIDE**

---



*Insert your key into the lock and turn to unlock position. Then turn the locking knob into the “Open” position.*

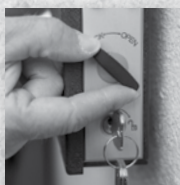

*When finished, close the door, and turn locking knob to “Lock” position. Return key into lock position, and then remove the key.*

## » **CHANGING COMBINATION (E-SERIES LOCK)**

**Introduction:** Changing your combination is easy and takes less than a minute.

The E-series lock offers over 1 million combination possibilities. Your code can be anywhere from 4 digits up to 10 digits in length. Also, before setting the new combination, we recommend you record the new combination code on page 14 of this manual.



### GETTING STARTED

1. *Open your ShotLock with your current electronic combination, OR by using the Key Override.*
2. *Make sure the locking knob is in the "OPEN" position.*
3. *Enter your new combination (4 to 10 digits) and press and HOLD the OK Key until a short beep is heard.*
4. *Quickly enter your new combination again, and press and HOLD the OK Key again until a LONG beep is heard.*
5. *The long beep CONFIRMS your new combination. DOUBLE beep means an ERROR, and start over at Number 4 (above).*

- *Any new combination you pick will always need to be sequential when you enter your combination to unlock your ShotLock. For example : when entering the numbers out of your chosen sequence, it will not open.*
- *To obtain the correct sequence with your new combination, we suggest you record your code in the designated box on page 14.*



## **EMERGENCY BATTERY BACKUP INSTRUCTIONS (E-SERIES LOCK)**

If all three of the provided keys have been misplaced, and the internal battery has expired, ShotLock provides another opportunity for you to get your ShotLock open.

### OPERATING THE EMERGENCY BATTERY BACKUP

1. Each E-Series lock comes with an Emergency Battery Backup Kit. Four AA batteries are required, but not included.
2. Install batteries into your included Emergency Battery Backup Kit.
3. Plug the pin into the DC hole on the top of the faceplate.
  - This will energize the internal electronics allowing you to enter your combination to access the ShotLock.
4. While keeping the pin in the DC hole, push your combination and the “OK” key. This will activate the unlock feature. Proceed to open your ShotLock Solo-Vault.
5. Finally, be sure to open the battery plate and replace the expired batteries (four AA) for future use.
  - We recommend changing batteries annually.

1

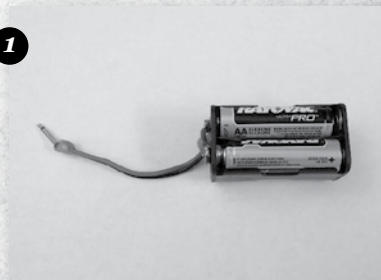

3



4





## » **AR SOLO-VAULT LOCK MODULE ACCESS (M-SERIES LOCK)**



1. *Remove Phillips screw from lock module cover.*



2. *Remove lock module cover.*



3. *Pull the lock module out as shown (no hardware disassembly required).*



5. *Insert lock module back into lock, replace lock module cover and lock module cover screw.*

## LIABILITY DISCLAIMER AND FULL WARRANTY

ShotLock LLC guarantees to the original purchaser that the ShotLock Solo-Vault™ is free from defects in material and workmanship for a period of 2 years (24 months) from the date of purchase.

In the event of any defects in material or workmanship, ShotLock's sole liability shall be to repair or replace the defective product or components, at its sole discretion. ShotLock may replace the unit with a new or refurbished unit, which is guaranteed by ShotLock. Allow up to 6 to 8 weeks for repair or replacements.

The conditions and extent of the Warranty are as follows:

- If it becomes necessary to send the product to ShotLock, the product must be shipped in its original carton or equivalent, fully insured with all shipping charges prepaid. ShotLock is not responsible for any loss or damage incurred in shipping.
- Advance return authorization is required from our Customer Service Department. 800-852-0400. If service on the product is required during the warranty period, obtain the authorization and send your product, together with a copy of your sales receipt with date of purchase (required), name, street, daytime telephone number and (if available) e-mail address to:

ShotLock LLC  
P.O. Box 307 / 215 Township Street  
Sedro-Woolley, WA 98284-0307

- This Warranty is void if (except for law enforcement personnel) the product is used for commercial purposes, or if service has been performed on the product by anyone other than ShotLock.
- This Warranty does not apply to any product that has been altered, misused, neglected or which has been used other than in accordance with the furnished instructions.
- Except to the extent prohibited by law, all implied warranties are disclaimed, including fitness for a particular purpose, merchantability and course of dealing or trade, and in no event shall they have greater duration than the warranty period set forth above.
- Under no circumstances shall ShotLock or its vendors be liable for any loss or any damage, injury or death, or direct, incidental, consequential or punitive damages arising out of or attributable to the malfunction, use or inability to use (including but not limited to because of a lost, misplaced, stolen or forgotten code) the product. Some states do not allow limitations on how long an implied warranty lasts or limitations or incidental or consequential damages, so THE ABOVE LIMITATIONS OR EXCLUSIONS MAY NOT APPLY TO YOU. THIS WARRANTY GIVES YOU SPECIFIC LEGAL RIGHTS, AND YOU MAY ALSO HAVE OTHER RIGHTS, WHICH VARY FROM STATE TO STATE.





## **CUSTOMER SERVICE**

For all Customer Service questions call us toll free:

P: 800-852.0400 F: 360-855-2239

Or write:

ShotLock

P.O. Box 307/215 Township Street  
Sedro-Woolley, WA 98284-0307

Or Email: [support@shotlock.com](mailto:support@shotlock.com)

Or visit our website: [www.shotlock.com](http://www.shotlock.com)

---

*Each 200 Series ShotLock Solo-Vault covered in this Owner's Manual is a California-approved firearm safety device that meet the requirements of Penal Code section 23655 and the regulations issued thereunder.*

---

*SAFETY WARNING: Firearms are inherently dangerous and use of this product requires care and attention. Weapon storage, security and use are your personal responsibilities. Since ShotLock has no control over the firearm you use, the ammunition you carry and the manner in which you use the firearm or ammunition, it disclaims all related responsibility and liability. Your use of our product is at your own risk.*

*Using appropriate safety precautions with a loaded firearm is the sole responsibility of the person(s) using or handling the product. The user takes full responsibility for careless, inappropriate, improper, incorrect or negligent use of this product or related firearm. ShotLock and its vendors are not responsible for the misuse or mishandling of this product or of any weapon in connection with the product, nor for any personal injury, death or damage to you, or to anyone else, to any property or your weapon or anyone else.*