

## LOW BATTERY WARNING

If the batteries become weak, the keypad will remain red during operation. Replace batteries immediately to ensure proper operation of the safe.

## SECURITY CABLE INSTALLATION

To maintain the security of the safe, either use the included security cable or bolt the safe to a secure structure.

### USING THE SECURITY CABLE

Wrap the security cable around a secure object and place the ferrule end through the loop in the cable. With the drawer open, snap the narrowest diameter of the ferrule into the back of the safe by gently pushing the ferrule end against the spring plate and sliding the ferrule down. As the drawer closes, it presses against the spring plate and locks the ferrule in place.

To remove the security cable, open the safe and press the pin above the ferrule while lifting the ferrule.

### BOLTING DOWN THE SAFE

Remove the drawer by gently pulling it out while pressing the plastic tab on the left side up, and the tab on the right side down.

Mark and pre-drill holes before installing the appropriate fasteners for your application.

To reinstall the drawer, carefully align the slides on each side and push the drawer in. The tabs should click into place.

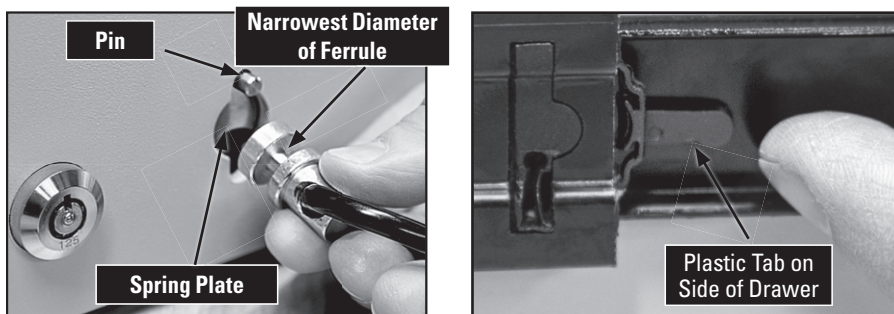

## Owner's Manual GlideVault™

Item No. 75404

Ext. Dimensions: 15.9" x 12.2" x 4.4"

Weight: 26 Lbs

Int. Dimensions: 13.5" x 9.5" x 3.14"

Power: 4 AAA batteries (not included)



Customer Service: PO Box 1848, Grand Island, NE 68802-1848  
1-877-214-4470 | Email: info@snapsafe.com

21SNAP0036 | 10/2021

**The safe is pre-programmed with default code 1-2-3-4-ENTER. You must change this code before storing valuables to ensure the security of the product.**

## POWER

1. Open the safe with the barrel override key. Lock found on back of safe.
2. Remove battery cover inside the drawer.
3. Insert four AAA batteries and replace the battery cover.
4. Do not close the door before testing digital lock.

## MICRO-USB BACKUP PORT

The GlideVault includes a micro-USB port on the front of the drawer. If the batteries become too weak to open the safe, use either the mechanical key override on the back of the safe, or plug in a battery backup into the front micro-USB port. To access the micro-USB port, pry up on the bottom center of the SnapSafe plastic cover.

After plugging in the battery backup the safe should power on and open with the programmed combination code.

Replace all batteries immediately to ensure proper function.

## PROGRAMMING/RESET COMBINATION CODE

1. Open the safe with either the barrel override key or default code.
2. Press and hold the yellow program button inside the drawer for about 3 seconds until the safe beeps.
3. Enter the new 4 to 6 digits code then press and release the program button. The safe should beep three times.

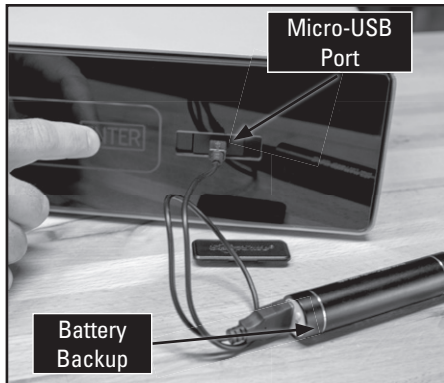
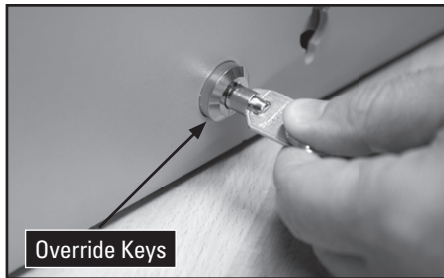

4. Re-enter the same new 4 to 6 digit code then press and release the program button. The safe should beep three times.

**Note:** If a mismatched code is entered during programming, the keypad will blink red and beep three times. Return to step 2 to enter a new code.

5. With the safe open, enter the new code followed by ENTER to confirm the safe is working properly. The motor should cycle after each correct entry.

**Note:** Become comfortable with the operation of your safe before storing anything of value inside.

## OPEN SAFE BY COMBINATION CODE

**Note:** To save batteries, the keypad lights turn off after approximately 10 seconds of inactivity. To enter a code, the keypad must first be turned on by pressing any of the buttons in the center of the front panel.

- With the keypad on, enter the programmed code followed by ENTER.
  - When a correct code is entered, the keypad will beep and blink blue one time.
  - When an incorrect code is entered, the keypad will beep and blink red two times. After five incorrect entries, the safe will beep and lock out for 3 minutes.
- The safe drawer should open a few inches automatically under spring tension.
- If five incorrect codes are entered, the safe will beep and the keypad will deactivate for 5 minutes. The safe can only be opened with the manual key during this time.

**Note:** If the safe does not open automatically, make sure the drawer front is not blocked by an object (i.e. carpet, bedding, clothes, etc.) and check to make sure the internal contents are not interfering with the top inside of the safe.

## TO CLOSE THE SAFE

- Push the center of the drawer until you hear the locking lugs engage and the drawer locks into place.

**Note:** The drawer is placed under spring tension, so the last few inches can be a little more difficult to close. Press firmly on the drawer front, but excessive force should not be used as it may damage the drawer slides or spring mechanism.

## KEYPAD TONES ON/OFF

Press and hold the "1" button for three seconds to toggle sound ON and OFF.

**Note:** Toggling the sound off will turn the keypad, program, and alarm beeps off. Toggling the sound on will turn the keypad, program, and alarm beeps on.