



# VIZORNET, INC.

**PRESENTS**



**Steve & Irina's Down To Earth, Inc.**

## **EMERGENCY CATALOGUE**

**Capability Statement:** **VizorNet, Inc. is a Service-Disabled Veteran-Owned Small Business Corporation** (re-certification pending). It was established in May 2003 under the laws of the State of Delaware. VizorNet provides exceptionally strong security solutions for its government, commercial, and overseas clients; a set of disruptive, evolutionary or niche technologies focused on the known yet unprotected vulnerabilities of modern systems and operations.

**Cage Code: 36CY3**

**Capability Statement:** **Steve & Irina's Down To Earth Inc. is a Certified HUBZone Business.**

We began our business in 1978, nearly 43 years ago. We incorporated on March 1, 2013. Our original core competency was Food (Health) Supplement Stores. We retain our original retail location and are the oldest operating health food store in Weber County, Utah. Since then, we have expanded into related competencies; each of which is focused on health, safety and shelter. Currently, we manufacture or have distributor status to offer competitively priced products in the following areas: emergency food and water including HEBs; temporary and emergency shelters; decontamination (surface and body); hand sanitizers; masks; closed type goggles, protective clothing; thermometers; safety and tactical gear; police gear; ballistic protection; optics; apparel; and body protection. **Cage Code: 89UJ2**

# Table of Contents

- Pg. 3: MEDECIDE: Long-Term Virus Killer
- Pg. 4: Test Kits
- Pg. 5: WEARSPRAY: Quick & Easy Sanitizing
- Pg. 6: Vital Ventilators
- Pg. 7-13: Face Masks
- Pg. 14: Goggles
- Pg. 15-16: Protective Clothing
- Pg. 17: Gloves
- Pg. 18-19: Gowns
- Pg. 20: Hand Sanitizer
- Pg. 21: Argumentative/Alternative Communication Device “ACC”
- Pg. 22: Homer Bracelet
- Pg. 23-26: Temporary Shelters

The following products are available at the prices indicated in a separate schedule to governmental entities and other approved purchasers **only**. This list was compiled as of September 7th, 2020 and was based upon availability at that time. No assurance can be made as to the ongoing availability of the product(s) or availability at the indicated prices.

The following pages include minimum order quantity (MOQ), production capacity and pricing.

**In certain specific instances, our contract manufacturers may require down payment and full payment prior to shipping. See Important Notes under Masks.**

**LONG TERM - VIRUS KILLER****MEDECIDE****Made in the USA**

***Persistent documented high-level protection of environmental surfaces against Virus and Germ contamination: MEDECIDE is an innovation in anti-viral technology to combat the spread of pandemic viruses and infections. (Extensive documentation and studies available upon request.)***

Ongoing worldwide efforts at controlling environmental contamination, specifically COVID-19 during the present pandemic, are undermined by the use of inadequate or non-existent anti-viral procedures. This is due to widespread dependence on conventional antimicrobial formulations that offer only short-term protection of surfaces that become contaminated with corona viruses. There is an urgent need to improve surface protection by utilizing newly available formulations that, for the first time, deposit long-lasting and powerful antimicrobial activity on treated surfaces, both hard and soft.

The MEDECIDE team developed these unique solutions (US Patented) to take full advantage of the superior germ-killing effectiveness of chlorine (Cl) atoms. This is accomplished by binding active Cl into biodegradable coatings that endure on treated surfaces. Compelling evidence from rigorous experiments described in the Supplemental Information (available upon request) makes a strong case for the practicality and long-term efficacy (28 days) of MEDECIDE on treated surfaces. This formulation adds a new and unprecedented means of attack on the environmental spread of infectious diseases in the 21st Century.

Evidence from previous coronavirus epidemics caused by human adapted variants (SARS, MERS) demonstrates that infectious viral particles can persist on surfaces, to which individuals are exposed, for up to 9 days. Survival for 4-5 days is common. There is every reason to believe that COVID-19 is equally persistent. Current anti-viral treatments, of which the most powerful and popular is aqueous chlorine (Cl) as hypochlorite bleach, are known to be effective at inactivating” coronaviruses rapidly, as demonstrated in the laboratory. But once applied to targeted surfaces they disappear within minutes by evaporation (e.g., bleach, ethanol, isopropanol) or chemical degradation on exposure to air (e.g., chlorine dioxide).

COVID-19 is extremely contagious. Therefore, this infectious virus in exhaled air and other bodily excretions will ensure rapid repopulation of environmental surfaces, where they will normally endure. Transmission by touching deposits of the virus and transferring these to the face is one of the most common means of acquiring infection. If excreted viruses in droplets land on MEDECIDE treated surfaces that continue to display germ-killing amounts of Cl for weeks after a single application there is a high likelihood of virus inactivation to a more useful and practical degree in preventing contagion.

**Partial client list of Medecide include the following:**

**Hospitals:** MD Anderson, Texas, | Mayo Clinic, Cleveland | Northwell, New York, | Mount Sinai, New York, | Weill Cornell Hospital, New York

**Countries:** Israel, China, Saudi Arabia, South Korea, Mexico, UAE, Thailand, Jordan, France and Germany. All of South America, except Brazil & Peru.

GN02-COVID-19 MEDECIDE Anti-Viral Spray (8,000 square foot coverage):  
 US\$ per gallon IN QUANTITIES OF 1,000,000 gallons or more.  
 Contract Application Cost (upon request): \$-US\$ per 8,000 square foot

## TEST KITS

### VizorNet's Ricovr Plasmonic Fiber Optic Biosensor for Covid-19 Antigen Detection

Maximizing high speed and lower cost in testing to detect COVID-19 with minimum disruption to national commercial and Government lab resources, resulting in the reduction in the allocation of critical resources.

The VizorNet's Ricovr Testing kit (PFAB Biosensor), presents a very quick and cost-effective solution to the COVID-19 challenge in the area of testing. PFAB Biosensor uses a point-of-care-testing device that will use saliva to test for the presence of SARS-CoV-2 virus particles. This will enable a highly specific and sensitive screening tool that can quickly screen for the presence of COVID without needing a specialized apparatus.

With very little or almost instantaneous training and uncomplicated equipment, VizorNet's Ricovr unit, will quickly test and screen for the virus in minutes, while sending only about 4-5% of tests to the lab. Hence, medical, military, and law enforcement units will incur fewer disruptions to their operations. Likewise, there will be fewer disruptions to commercial and industrial operations. VizorNet's Ricovr solution is the quickest, and most cost-effective solution currently available.

Rapid and low-cost diagnosis of COVID-19 is essential to identify the infected subjects, particularly the asymptomatic cases, primarily to arrest the spread of the disease through local transmission. The PFAB Biosensor is a field-deployable, handheld plasmonic fiber-optic absorbance biosensor (P-FAB) platform



VizorNet's Ricovr Testing kit (PFAB Immunosensor) will be available for distribution in commercial quantities by September. However, we are currently processing orders. Funds will be held in bank escrow pending release to the manufacturer.

Catalogue number: VN-001

Minimum Order: 10-50 Pieces: CIF Worldwide \$ per piece

51-100 Pieces: CIF Worldwide \$ per piece

100-500 Pieces: CIF Worldwide \$ per piece



# WEARSPRAY QUICK & EASY SANITIZING

Touching one's face is a common way of acquiring an infection. WearSpray offers quick & easy sanitization for Health Care, Transportation, Law Enforcement Industries, Military, Civilian & Government Employees who are on the front lines facing clients, customers and people. The WEARSPRAY wristband offers on-the-go, speed and easy access to a refillable, sanitizer. Made for comfort and durability, the band material is used in many health care products while proven safe for children. Custom colors and branding of your company's logo or emblem are available on request.

Simply apply pressure to the top of the WEARSPRAY wristband and the transparent reservoir triggers an even stream of sanitizing solution (of your choice) into your receiving palm. Reaching into your pockets or a bag with gloves on is a frustrating experience and can also cross-contaminate. Sanitizing your hands, with or without gloves, becomes quick & easy with the WEARSPRAY wristband. To refill, simply remove the back-cap. The wristband is designed to release 70 sanitizing streams.



Catalogue Number: WE-001 | Minimum Order: 10-50 Pieces: CIF Worldwide \$ per piece  
51-100 Pieces: CIF Worldwide \$ per piece | 100-500 Pieces: CIF Worldwide \$ per piece  
Wearspray will be available for distribution in commercial quantities by September. However, we are currently processing orders. Funds will be held in bank escrow pending release to the manufacturer.

# THE VITAL VENTILATOR

## CuraSigna - NASA Partnership

VITAL Ventilators are designed and manufactured to carry out several functions with extreme reliability. They are validated to supply oxygen at higher-than-ambient pressure and allow carbon dioxide to be exhaled and cleared away from the patient’s lungs with extreme precision. The air VITAL Ventilators provide to the patient is free of bacteria and other pathogens. Also, they are equipped with sensors and software that detect if the breathing mask or tube has been dislodged, if the patient’s breathing has become erratic or weaker, or if the breathing rate has changed. Finally, the machines are “Sterile-friendly” so that they can be thoroughly cleaned and eliminate, as much as possible, any pathogens in the patient’s exhalations. VITAL is also compatible with existing hospital infrastructures and envisions to integrate with Edge AI solution (that will be rolled out by CuraSigna in the near future).

CuraSigna is among the few companies selected by NASA (through an international challenge) for the worldwide license of their US-FDA Authorized Ventilator, VITAL. CuraSigna’s NFTDC facility manufactures these ventilators at its State of the Art facility.



CAPABILITY	VALUE
Supplemental Oxygen	21 % < FiO2 % < 100 %
Positive End-Expiratory Pressure (PEEP)	5 to 30 cmH2O
Back-Up Rate	4 to 40 breaths/min
Tidal Volume	150 to 800 mL
Size	30 cm x 30 cm x 25 cm
Weight	<10 kg

*Original Design of VITAL Ventilator by JPL-NASA has been approved by US FDA under emergency use authorization (EUA).*

# FACE MASKS

IMPORTANT NOTE: The COVID-19 Virus is much smaller than any virus previously documented by the medical community. ALL masks must be sprayed, both sides, with an effective anti-viral agent such as the MEDECIDE Anti-Viral Spray (see above.) This is because the filters in all masks will *not* stop this particular virus. Once sprayed with MEDECIDE, the mask will be virtually virus free for at least 28 days.

## KN-95





## FACE MASKS

### Medical Face Mask

Disposable medical surgical 3 ply face-mask and MEDICAL FACE MASK

Product description

- The bottom and surface of the product are made of non-woven fabrics with high efficiency filter material added in the middle and heated by machine. The bacterial filtration efficiency is more than 95% when synthetic blood is sprayed at 120 mmHg pressure to the outside of the mask; bacteria will not penetrate the inside of the mask.
- Prevents body fluids, particulate matter, and pathogenic microorganisms.

N-95





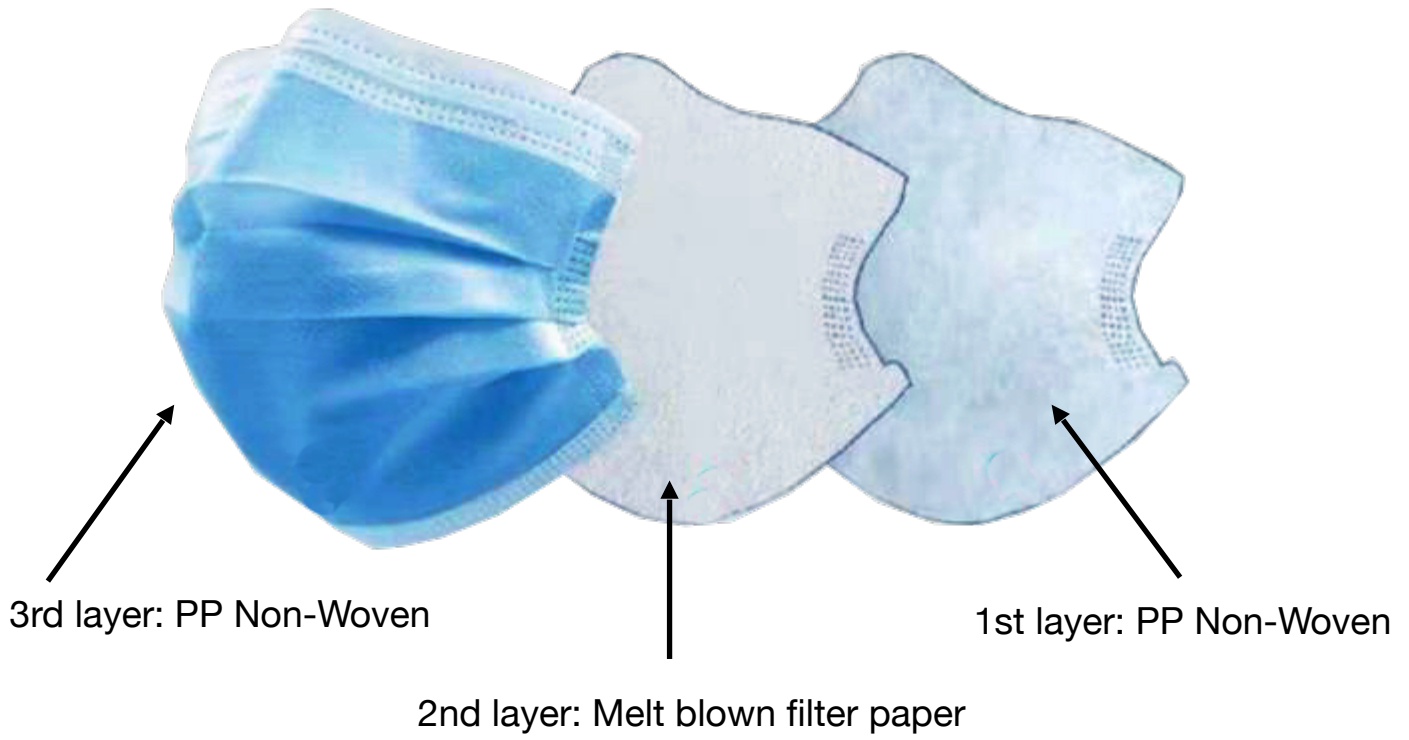

# FACE MASKS

## Medical 3 Ply Face Mask

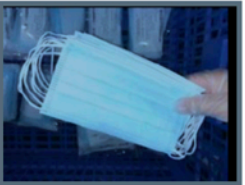

## QUOTATION LIST





Pic. Ref.	Item No.	Name	MOQ (pcs)	EXW Price (USD)	Passed Test Report	Packaging Details
	M-3	Disposable mask 3 Layers (for general); Nonwoven + Meltblown fabric	1K-9999		CE	Oriented Polypropylene (OPP) bag with card insert or printed polybag,20/50pcs/bag; welcome custom color box packing
			10K-499999			
			>100K			
	DS-3	Disposable mask 3 layers(for medical); Nonwoven + Meltblown fabric	1K-9999		CE,FDA	OPP bag with card insert or printed polybag,20/50pcs/bag; welcome custom color box packing
			10K-499999			
			>100K			
	MS-3	Disposable mask 3 layers(for surgery); Nonwoven + Meltblown	20W needs to reserve		CE,FDA	OPP bag with card insert or printed polybag, 20/50pcs/bag;welcome custom color box packing
	KN95-S	(26262006)KN95 without breather valve, Nonwoven + Melt-blown fabric,4 /5 layers, FFP2	1K-9999		CE,FDA	OPP bag with card insert or printed polybag, 5/10/20pcs/bag;welcome custom color box packing
			10K-499999			
			>100K			
	N95-A	GB2626-2006 KN95 Respirator Valve ,4 /5 layers FFP2	1K-9999		CE,FDA	0pc/bag,1000pcs/carton Carton size:67x56x32cm G.W.: 11.25KG
			10K-499999			
			>100K			





## QUOTATION LIST

	KN95-B	(2626-2006)KN95 with breather valve, Nonwoven + Melt-blown fabric, 5 layers, FFP2	1K-9999	CE,FDA	OPP bag with card insert or printed polybag, 5/10/20pcs/bag; welcome custom color box packing
			10K-499999		
			>100K		
	KN95-E	GB2626-2006 KN95 Respirator Valve ,4 /5 layers FFP2	1K-9999	CE,FDA	size:67*56*32cm 270pcs, G.W.:8.4kg/ctn 400pcs/ carton carton size :67*56*32cm G.W.:7.3KG
			10K-499999		
			>100K		
	KN95-N	(2626-2006)KN95 without breather valve, Nonwoven + Melt-blown fabric,4 layers, FFP2	1K-9999	CE,FDA	OPP bag with card insert or printed polybag, 1/5/10/20pcs/bag;welcome custom color box packing
			10K-499999		
			>100K		
	KN95-C	(2626-2006)KN95 with breather valve, Nonwoven + Melt-blown fabric, 4 layers, FFP2	1K-9999	CE,FDA	OPP bag with card insert or printed polybag, 1/5/10/20pcs/bag;welcome custom color box packing
			10K-499999		
			>100K		
	KN95-S2	(2626-2006)KN95, use N99 materia, 3 layers, Nonwoven + Melt-blown fabric, FFP2	1K-9999	CE,FDA	OPP bag with card insert or printed polybag,5/10/20pcs/bag; welcome custom color box packing
			10K-499999		
			>100K		

## QUOTATION LIST

	KN95-S1	(2626-2006)KN95, use N99 materia, 4 layers, Nonwoven + Melt-blown fabric, FFP2	1K-9999		CE,FDA	10pc/bag,1000pcs/carton Carton size:67*56*32cm G.W.: 7.0KG
			10K-499999			
			>100K			
 <p>EN149:2001 CE 0865 FFP2</p>	N010	EN149:2001, N95 , 3M Nonwoven + Melt-blown fabric,4 layers,,	1K-9999		CE,FDA	OPP bag with card insert or printed polybag, 10/20pcs/bag; welcome custom color box packing
			10K-499999			
			>100K			
	N010-M	N95-Niosh , 3M (for medical) Nonwoven + Meltblown fabric, FFP3	1K-9999		CE/FDA/NIOSH	OPP bag with card insert or printed polybag, 10/20pcs/bag; welcome custom color boxpacking
			10K-499999			
			>100K			
	RIZSQ100Sb	3Q N95-Niosh , Nonwoven + ≥ 99% Melt-blown fabric,4 layers,	1K-9999		CE/FDA/NIOSH	20pcs/box; 20boxes/ctn; 400pcs/ctn; 69*40*34cm, G.W.:8kg
			10K-499999			
			>100K			
 <p>产品图片</p>	9500	Makrite N95-Niosh , Nonwoven + ≥99% Meltblown fabric, FFP2	1K-9999		CE/FDA/NIOSH	0pcs/box; 20boxes/ctn; 400pcs/ctn; 69*40*34cm, G.W.:8kg
			10K-499999			
			>100K			

## QUOTATION LIST

	E101W	Makrite N95-Niosh , Nonwoven + ≥ 99% Melt-blown fabric, FFP2	1K-9999	CE/FDA/ NIOSH	50pcs/box; 20boxes/ctn; 1000pcs/ctn; 69*40*34cm, G.W.:8kg
			10K-499999		
			>100K		
	N95-NIOSH	N95-Niosh Nonwoven + Meltblown fabric, FFP3	1K-9999	CE/FDA/ NIOSH	OPP bag with card insert or printed polybag,5/10/20pcs/bag; welcome custom color box packing
			10K-499999		
			>100K		

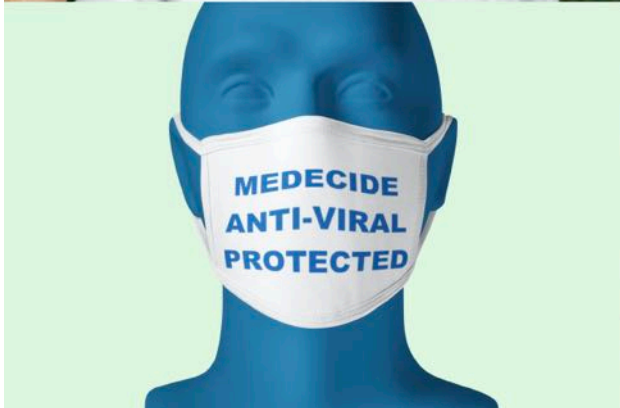

### IMPORTANT NOTE:

The COVID-19 Virus is much smaller than any virus previously documented by the medical community. ALL masks must be sprayed, both sides, with an effective anti-viral agent such as the MEDECIDE Anti-Viral Spray (see above.) This is because the filters in all masks will *not* stop this particular virus.

Once sprayed with MEDECIDE, the mask will be virtually virus free for at least 28 days.



## GOGGLES

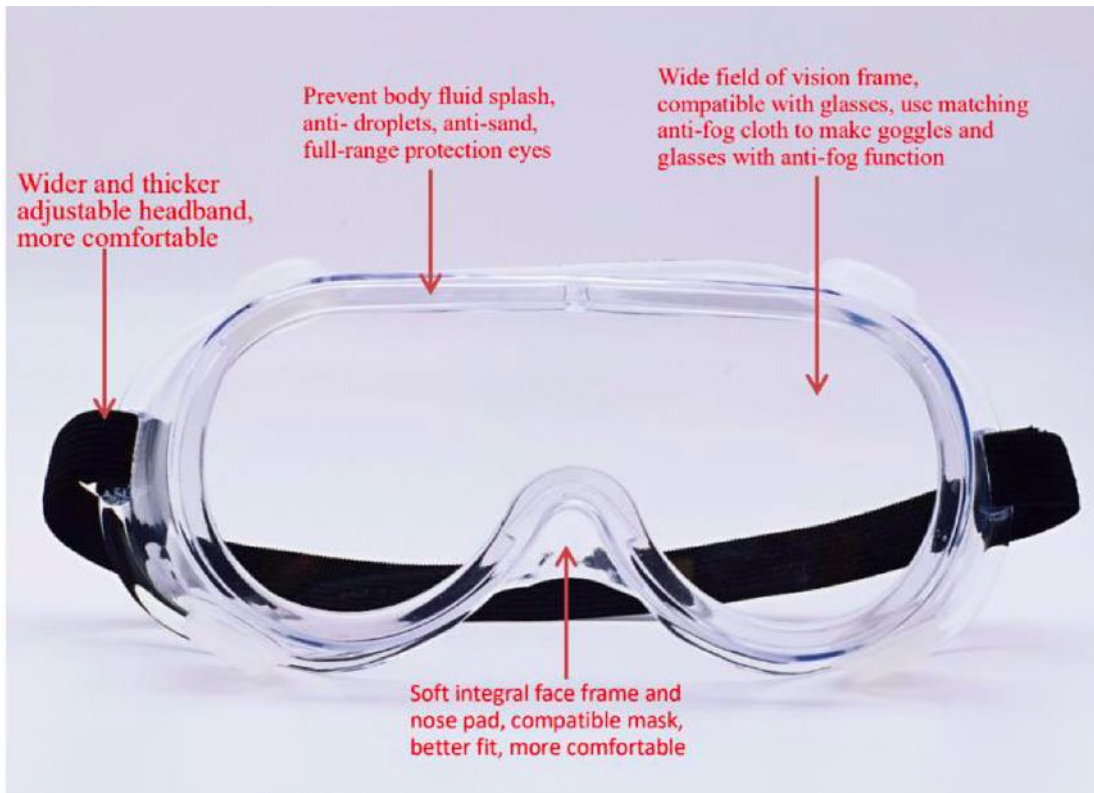

### The main features:

The frame is made of high-quality soft polyethylene; the goggles are easy to bend, designed with a good sealing contact surface, and provide full range protection. They offer high transparency and a wide field of vision. Our contract manufacturer has recommended that in order to avoid secondary contamination, the goggles should be thoroughly disinfected with MEDECIDE or another disinfectant. Alternatively, they should be disposed of following use. Degradation of the goggles can occur if repeatedly exposed to disinfectants, medical alcohol and high temperature. Also, should disinfectants be used on a repeated basis, the polyethylene may harden. In such cases, the contract manufacturer recommends that the goggles should be disposed of immediately and replaced. Further, following the use of a disinfectant it is recommended that the wearer should use a long-acting anti-fog lens cloth to wipe and then polish the lens. As shown in the photograph, the goggles are designed to be used with conventional glasses; and an adjustable elastic band has been included. Also included is an anti -fog mirror cloth. The contract manufacturer describes the goggles as ideal for “working in environments requiring frequent disinfection such as hospitals.”

These closed type goggles are widely used for the protection of doctors and medical staff in hospitals in China.

The MOQ for the goggles is 5,000 pieces.

The Unit price which does not include air delivery to the continental United States (FOB factory) is: GG01- Goggles Item Price: US\$ per piece.

The Unit price which does include air delivery to the continental United States (CIF US destination) is: GG01- Goggles Item Price: US\$.

## PROTECTIVE CLOTHING



### The main features:

**I. Product name:** single-use protective clothing for medical use.

**II. Product application:** It can provide barrier and protection for medical staff against potential infection when contacting blood, body fluid, secretion, particulate in the air etc. from patients.

**III. Product performance, structure and components:** The main performance indexes such as liquid barrier function, elongation at break, filtration efficiency all confirm to GB19082-2009 *Standard Technical Requirements for Single-use Protective Clothing for Medical Use*.

**IV. Product components:** Made of non-woven fabric peak processing.

#### **V. Application Method**

1. Before use choose the appropriate size according to the size table on the back of the package.
2. Pull the zipper to the bottom. The sequence in wearing is: Legs-arms-head, then pull the zipper to the lower jaw.
3. Ensure that protective clothing is properly worn. The head, wrist, foot mouth should be covered tightly in order to obtain the best protective effect.

## PROTECTIVE CLOTHING

**VI.**

1. Before use, please read the instructions carefully, check whether the package is in good condition, confirm the label, production date and expiry date of the package, and during the effective period of sterilization.
2. This product is single-use. Reuse is prohibited.
3. This product has been sterilized by radiation. It is prohibited to use in case the package is broken.
4. People who are allergic to non-woven fabrics should not use this product.
5. After use, please dispose according to the requirements of the hospital or environmental department.

**VII. Storage Situation:** Please store in dry, well-ventilated and noncorrosive gas situations.

**VIII. Validity:** Valid for one year from the date of sterilization.

**IX. Flame-retardant level:** not applicable

**X.**

**Size Table**

**Unit: cm**

Size	Overall length	Waist	Sleeve	Sleeve cuff	Ankle opening
160	165	120	84	18	24
165	169	125	86	18	24
170	173	130	90	18	24
175	178	135	93	18	24
180	181	140	96	18	24
185	188	145	99	18	24
Tolerance	±2	±2	±2	±2	±2

The MOQ for the Protective Clothing is 5,000 pieces.

The Unit price, which does not include air delivery to the continental United States (FOB Factory) is:  
 PC-01 Protective Clothing Price: US\$ per piece.

The Unit price, which does include air delivery to the continental United States (CIF US destination) is:  
 US\$ per piece.



## GLOVES

**Nitrile Disposable Gloves Safeguard, Powder Free, Food Grade, Latex-Free, 100 Pc. Dispenser Pack, All Sizes, Blue**

**The MOQ for the gloves is 10,000 pieces.**

The per box price which does include air delivery to the continental United States (CIF US destination) is:  
CM01- Nitrile Disposable Gloves Per Box (100 pieces) Price: US\$ per box.

The per box price which does include *sea* delivery to the continental United States (CIF US destination 25 to 30 days) is: US\$ per box.

CM01a- Nitrile Disposable Gloves Per Box (100 pieces) Price: US\$ per box.



## GOWNS



## GOWNS

**Level 1:** The MOQ for the Level 1 gowns is 12,000 pieces (100 boxes.) Each box contains 120 pieces. The per box price which does not include air delivery to the continental United States (FOB factory) is: LE01- Level 1 Per Box Price: US\$ per box.

The per box price which does include air delivery to the continental United States (CIF US destination) is: LE01- Level 1 Per Box Price: US per box.

**Level 2:** The MOQ for the Level 2 gowns is 12,000 pieces (100 boxes.) Each box contains 120 pieces. The per box price which does not include air delivery to the continental United States (FOB factory) is: LE02- Level 2 Per Box Price: US\$ per box.

The per box price which does include air delivery to the continental United States (CIF US destination) is: LE02- Level 2 Per Box Price: US\$ per box.

**Level 3:** The MOQ for the Level 3 gowns is 12,000 pieces (100 boxes.) Each box contains 120 pieces. The per box price which does not include air delivery to the continental United States (FOB factory) is: LE03- Level 3 Per Box Price: US\$ per box.

The per box price which does include air delivery to the continental United States (CIF US destination) is: LE03- Level 3 Per Box Price: US\$ per box.

**Level 4:** The Level 4 gowns will be available soon.



# HAND SANITIZER

The MOQ for hand sanitizer is 5,000 pieces.

## 65% No Wash Alcohol Hand Sanitizer

HS01 - 60 ml. US\$ per bottle

HS02 - 120 ml. US\$ per bottle

HS03 - 250 ml. US\$ per bottle

HS04 - 500 ml. US\$ per bottle



## 75% No Wash Alcohol Hand Sanitizer

HS05 - 60 ml. US\$ TBA per bottle

HS06 - 120 ml. US\$ per bottle

HS07 - 250 ml. US\$ per bottle

HS08 - 500 ml. US\$ per bottle





# Argumentative/Alternative Communication Device "AAC"

Doctors, nurses and first responders are getting infected because of close contact with patients having COVID-19 symptoms. Clearly, they wear fully protected gear but it is not enough. Doctors and nurses across the country have stated this communication device will be a vital tool to minimize risk and help patients on ventilators or who have extreme respiratory complications to communicate more effectively. The most vulnerable are our elderly. They become so weakened by the virus they cannot communicate verbally and accurately. It is difficult and dangerous to treat them properly.

The low-tech Augmentative/Alternative Communication device, AAC, communication board is designed to be used between caregivers and patients and first responders to communicate and minimize risk efficiently and effectively.

The communication board is also designed to assist individuals who have speech debility due to:

- Virus Incubation
- Connected to a Ventilator
- Extreme Respiratory Complications
- Social Separation
- ALS (Amyotrophic Lateral Sclerosis / Lou Gehrig's Disease.)
- Cerebral Palsy
- Stroke
- Autism
- Throat/Mouth Cancer
- Parkinson's Disease
- Other acquired neurological conditions
- Temporary communication needs (for example, while intubated)



The MOQ for the Argumentative/Alternative Communication Device "AAC" is 50,000 pieces.

AD 001 - Argumentative/Alternative communication Device "AAC": US\$ per unit FOB Salt Lake City  
If you would like to learn more about this product please [click here](#)

## HOMER BRACELET for Pandemic Use

The Homer Bracelet was originally conceived as a humanitarian/philanthropic product to protect persons in danger of being abducted for human trafficking. It later evolved, using the basic Homer Technology, as a “commercial platform” which was registered and patented five years ago, to track and secure passports, luxury goods, art and collectibles, as well as guns.

The latest evolution of the Homer Bracelet technology is a unique product which successfully blends the need for monitoring (tracking) those individuals who have (or had) COVID-19 while at the same time protecting civil liberties by only working during a quarantine, not utilizing a personal device that could be accessed after the quarantine through an “app” and is only activated if the person leaves the geo-fenced space or if it is removed. Although the Homer bracelet could “cooperate” with tracking apps tracking has **not** been programmed into the bracelet except when legally authorized by authorities through the Homer service.

Homer Technology uses 2G/3G/4G, SigFox and Wi-Fi triangulation to monitor and geo-fence quarantined people. Therefore, the Homer Bracelet offers these synergic features:

1. Can be used to geo-fence a person accurately without depending on another device.
2. Can be used to record when symptoms begin and to signal for medical help.
3. Cannot be removed without notifying authorities but is secure and cannot be used to penetrate personal data, thus protecting civil liberties.
4. Has a customizable battery that can last only for the duration of the quarantine.
5. It is waterproof, low cost, and can be thrown away (recycled) at the end of the quarantine.

The bracelet is secured by a zip-tie closure which fits snugly around the wrist without cutting circulation. If the bracelet is cut or forcibly removed, wires in the bracelet will break and authorities (or the Homer Service) will be notified. The bracelet is IP 67 waterproof; it can be submersed in a meter of water; therefore showers, etc. can be taken by the wearer.

The bracelet has a one button (pictured) configuration that can be used to notify when symptoms start or require medical attention, with the bracelet being automatically activated after a set time period. The battery in the bracelet can be sized so that it powers only for the time of the quarantine; afterward, the bracelet will become powerless.

Homer is the size of a Fitbit bracelet.



Catalogue Number: HO-001

Minimum Order: 10-50 Pieces: CIF Worldwide \$ per piece

51-100 Pieces: CIF Worldwide \$ per piece

100-500 Pieces: CIF Worldwide \$ per piece



# Temporary Shelters

## 1935 SHELTER SYSTEM



### Features and Benefits

- Rapid deployment without aid of ancillary equipment, set-up anywhere
- Lightweight frame, packaging allows shelter to be moved / stowed by two people
- Vertical 6 ft. sidewalls maximize usable square footage
- Sealable vinyl floor maintains environmentally secure shelter (SW-1935, SG-1935, SK-1935)
- Can be configured with roof or walls only for maximum flexibility in deployment
- Interior frame allows access to horizontal support bars capable of holding up to 50 lbs
- Rigid double doors provide a large entryway
- Roof vent caps significantly reduces condensation
- Framework design allows individual replacement of parts
- Flame retardant vinyl is UV resistant for long life, resists mildew and abrasion

### Shelter Packages

SH-1935	SW-1935	SG-1935	SK-1935
1 Frame	1 Frame	1 Frame	1 Frame
2 Vent Cap	2 Vent Cap	2 Vent Cap	2 Vent Cap
1 Roof	1 Roof	1 Roof	1 Roof
1 Wall	1 Wall	1 Wall	1 Wall
1 Double Door	2 Double Door	2 Double Door	2 Double Door w/ Filler Panels
1 Stake Kit	2 Stake Kit	2 Stake Kit	2 Stake Kit
1 Vinyl Repair Kit	1 Vinyl Repair Kit	1 Vinyl Repair Kit	1 Vinyl Repair Kit
	1 Floor	1 Floor	1 Floor
	2 Threshold Ramp	2 Threshold Ramp	2 Threshold Ramp
		1 Insulation Roof	1 Insulation Roof
		1 Wiring Harness	1 Wiring Harness
		6 T36 Lights	7 T36 Lights
			1 Insulation Wall Set

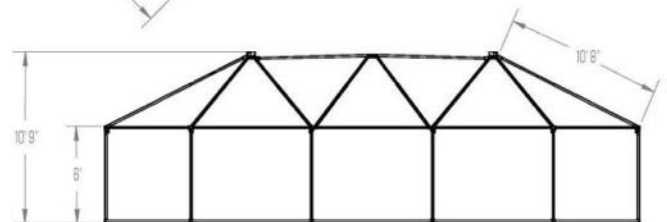
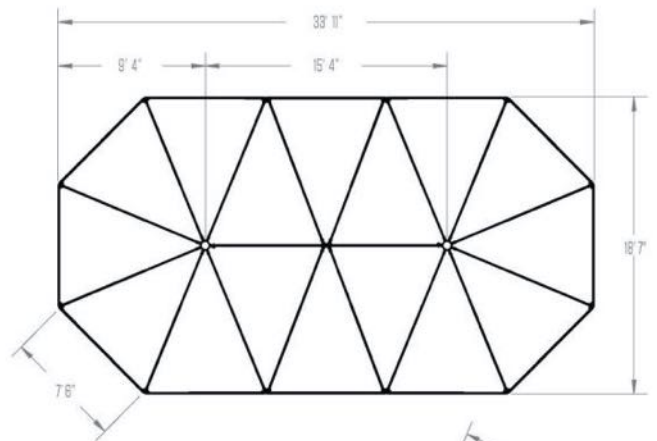

# Temporary Shelters

## Specifications NSN Pending

Usable Area	18' 7" x 33' 11"	(5.7 x 10.4 m)
Total Weight	596 lbs	(270 kg)
Time Under Canopy	20 min / 4 personnel	
Total Set-Up Time	35 min / 4 personnel	
Square Footage	570 ft <sup>2</sup>	(53m <sup>2</sup> )
Cube	3,420 ft <sup>3</sup>	(96.84 m <sup>3</sup> )
Environment	-40°F - 120°F	(-4.4°C to 49°C)
Snow Load	10 lbs / ft <sup>2</sup> for 12 hrs	(50 kg / m <sup>2</sup> for 12 hrs)
Wind Load	55 mph w/gusts to 65 mph	(89 km/h w/gusts to 105 km / h)
<b>Dimensions</b>		
Footprint	18' 7" x 33' 11"	(5.7 x 10.4 m)
Sidewall	6"	(1.8m)
Peak	10' 10"	(3.3m)
<b>Packaged Dimensions</b>		
Roof	21 x 23 x 14"	(53 x 58.5 x 35.5 cm)
Door (2)	26 x 3.5 x 72"	(66 x 9 x 183 cm)
Wall	28 x 28 x 14"	(71 x 71 x 35.5 cm)
Vinyl Floor	23 x 20 x 14"	(58.5 x 51 x 35.5 cm)
Frame #1	91 x 16 x 16"	(231 x 40.5 x 40.5 cm)
Frame #2	91 x 14 x 16"	(231 x 35.5 x 40.5 cm)
Berry Compliant Option	✓	

## Recommended Support Systems

### Shelter Connecting Systems

Increase the footprint of your shelter system with rigid frame connectors and entryways

### Electrical Distribution

Portable power and lighting to sustain your shelter complex

### Climate Control

Air heating, cooling, purifying and dehumidifying

### Water Distribution

Purification, storage, heating and distribution kits

### Hygiene Systems

Field showers and toilet stations

### Storage And Transport

Heavy-duty cases and customizable cargo trailers

### Digital ID

Your logo or name custom printed on roofs and doors for easy identification

### Anchoring Systems

Secure your shelter against high winds

### Shelter Accessories

Beds, work stations, tables, seating and food prep



Thirteen 1935s connected by vestibules make up this field hospital.



Shelter billering featuring Western Shelter bunk beds, air distribution plenum, lighting and wiring harness.

# Temporary Shelters

## QUARANTINE / ISOLATION STATION

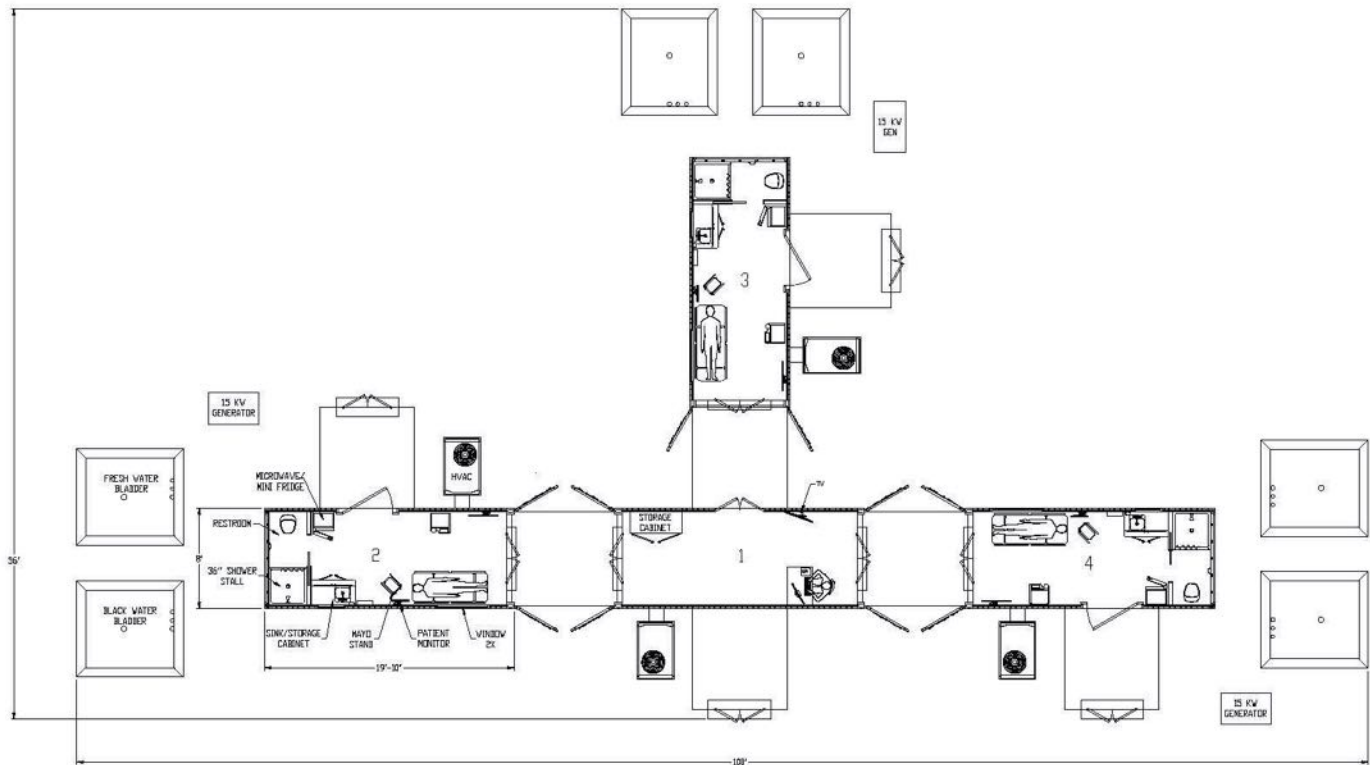

### Objective:

Provide a comprehensive alternative health facility that is designed to be functional, yet modular and portable for managing the infectious disease patient. Emerging infectious disease is an ever present danger in our society. Whether it is a seasonal influenza or an Ebola outbreak, the infrastructure of a hospital needs to remain as clean as possible during these events. Triage, treatment, quarantine, and isolation of these patients in an off-site facility may be critical to protecting the hospital's infrastructure.

### Conditions:

The facility should be portable, easy to erect, and easy to manage. The interior space should look as close to a brick and mortar structure as possible to reduce stress on patients and staff. Having spacious, well lit individual patient areas, functional staff areas, and good patient flow is also key. Isolation capability with negative pressure, HEPA filtration and climate control are required for safety. Individual patient areas that are separated by a double door air lock, and individual Hygiene Center, create the ultimate in patient isolation.

### Components:

Western Shelter's line of GateKeeper shelters is perfectly suited to meet the needs of this mission. Extended entryways with air locks help maintain the negative pressure atmosphere of the complex. Separate dressing areas that are directly connected within the complex helps maintain a secure and safe environment for both staff and patients.

### Guided Tour:

As you open the hinged door to the staff entrance, you feel a rush of air enter behind you. Once inside the airlock, a five count will ensure the correct pressure has been reestablished. Entering the Ante Room (1), you will see that this is a room designated for staff only. This is considered a clean area where personal protective gear can be donned. Medical supplies and other essential gear may be gathered here before entering one of the 3 patient area airlocks. Again, once inside the airlock, wait 5 seconds to allow for the pressure to build. Now inside one of the patient areas (2, 3 or 4) the shelter contains an E-Bed, MD bag, and any other needed equipment. There is a patient entrance on one wall, and a hygiene center on another. The hygiene center is there for patient use or gross decon of a staff member if needed. When it is time to leave the patient area, staff and patients must leave through the Exit airlock. Decontamination consistent with local standards should occur as they exit the airlock. Western Shelter can assist with decontamination components, but is not responsible for training or waste removal. Removal of waste, linens, and other "dirty" items from the interior will be passed through one of a few designated openings in the shelter. Staff areas are meant to be completely separate from the treatment complex.



# Temporary Shelters

## QUARANTINE / ISOLATION STATION

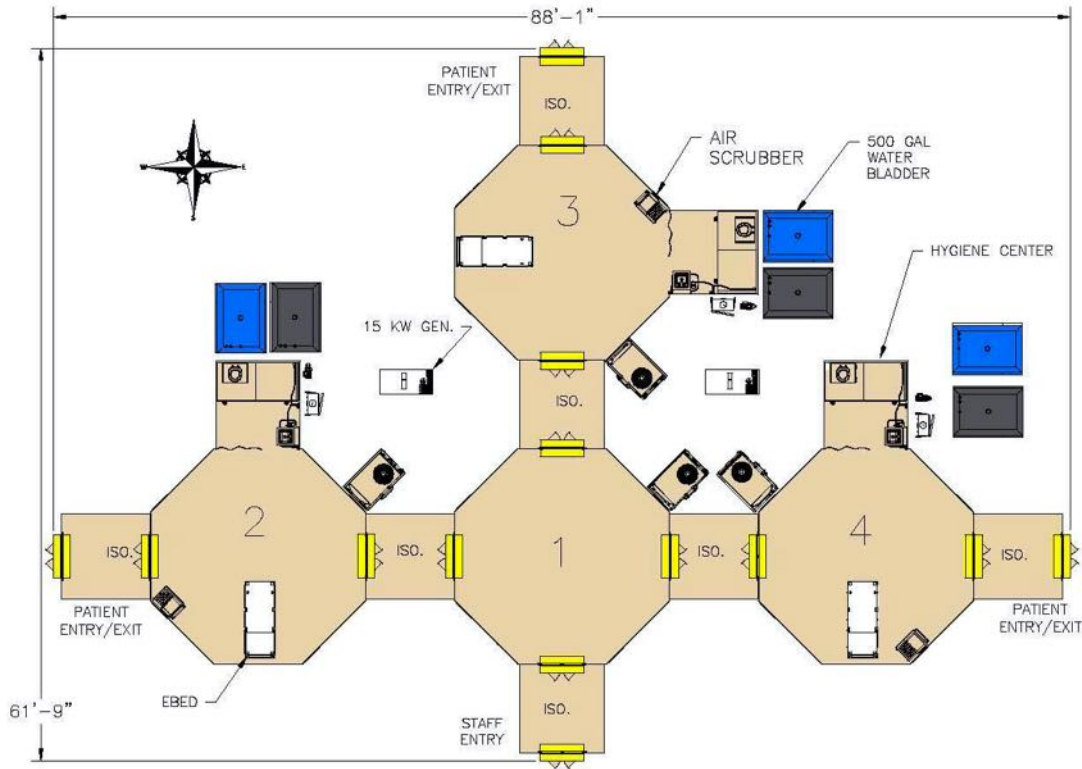

### Objective:

Provide a comprehensive alternative health facility that is designed to be functional, yet modular and portable for managing the infectious disease patient. Emerging infectious disease is an ever present danger in our society. Whether it is a seasonal influenza or an Ebola outbreak, the infrastructure of a hospital needs to remain as clean as possible during these events. Triage, treatment, quarantine, and isolation of these patients in an off-site facility may be critical to protecting the hospital's infrastructure.

### Conditions:

The facility should be portable, easy to erect, and easy to manage. The interior space should look as close to a brick and mortar structure as possible to reduce stress on patients and staff. Having spacious, well lit individual patient areas, functional staff areas, and good patient flow is also key. Isolation capability with negative pressure, HEPA filtration and climate control are required for safety. Individual patient areas that are separated by a double door air lock, and individual Hygiene Center, create the ultimate in patient isolation.

### Components:

Western Shelter's line of GateKeeper shelters is perfectly suited to meet the needs of this mission. Extended entryways with air locks help maintain the negative pressure atmosphere of the complex. Separate dressing areas that are directly connected within the complex helps maintain a secure and safe environment for both staff and patients.

### Guided Tour:

As you open the hinged door to the staff entrance, you feel a rush of air enter behind you. Once inside the airlock, a five count will ensure the correct pressure has been reestablished. Entering the Ante Room (1), you will see that this is a room designated for staff only. This is considered a clean area where personal protective gear can be donned. Medical supplies and other essential gear may be gathered here before entering one of the 3 patient area airlocks. Again, once inside the airlock, wait 5 seconds to allow for the pressure to build. Now inside one of the patient areas (2, 3 or 4) the shelter contains an E-Bed, MD bag, and any other needed equipment. There is a patient entrance on one wall, and a hygiene center on another. The hygiene center is there for patient use or gross decon of a staff member if needed. When it is time to leave the patient area, staff and patients must leave through the Exit airlock. Decontamination consistent with local standards should occur as they exit the airlock. Western Shelter can assist with decontamination components, but is not responsible for training or waste removal. Removal of waste, linens, and other "dirty" items from the interior will be passed through one of a few designated openings in the shelter. Staff areas are meant to be completely separate from the treatment complex.