

Single Acting Cylinder – TS Series

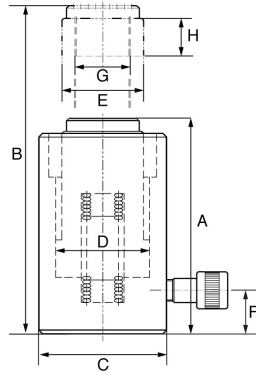

TECPOS

- Maximum Pressure: 700 Bar.
- Hydraulic Coupler: TBC 381F(PT3/8).
- Orange painted finish.
- Pump: To use 30% more than oil capacity of Cylinder.
- Marked with CE, capacity, manufacturers ID, product ID mark and traceability code.
- Certification available **2.1 DoC**

Product Code	Cyl. Cap.	Stroke	Cyl. Effective Area	Oil Cap.	Retracted Height	Extended Height	Cyl. Out Dia.	Cyl. Bore Dia.
	t	mm	cm(2)	cc	A mm	B mm	C mm	D mm
TS55	5	50	6.38	35	134	184	38	28.5
TS510	5	100	6.38	70	184	284	38	28.5
TS515	5	150	6.38	106	234	384	38	28.5
TS520	5	200	6.38	140	284	484	38	28.5
TS105	10	50	15.2	76	133	183	58	44
TS1010	10	100	15.2	152	183	283	58	44

Product Code	Cyl. Cap.	Stroke	Cyl. Effective Area	Oil Cap.	Retracted Height	Extended Height	Cyl. Out Dia.	Cyl. Bore Dia.
	t	mm	cm(2)	cc	A mm	B mm	C mm	D mm
TS1015	10	150	15.2	228	233	383	58	44
TS1020	10	200	15.2	304	283	483	58	44
TS205	20	50	33.18	166	165	215	88	65
TS2010	20	100	33.18	332	215	315	88	65
TS2015	20	150	33.18	498	265	415	88	65
TS2020	20	200	33.18	664	315	515	88	65
TS305	30	50	44.18	220	172	222	102	75
TS3010	30	100	44.18	440	222	322	102	75
TS3015	30	150	44.18	660	272	422	102	75
TS3020	30	200	44.18	880	322	522	102	75
TS505	50	50	70.88	355	173	223	127	95
TS5010	50	100	70.88	710	223	323	127	95
TS5015	50	150	70.88	1,070	273	423	127	95
TS5020	50	200	70.88	1,425	323	523	127	95
TS10010	100	100	132.7	1,330	226	326	165	130
TS10015	100	150	132.7	1,991	436	436	165	130

Model	Cyl. Cap.	Stroke	Piston Rod Dia	Base to Inlet port	Piston rod internal thread	Piston rod Thread Length	Weight	Pump
	t	mm	E mm	F mm	G	H mm	kgs	
TS55	5	50	25	25	3/4-16 UNF	16	1.1	1B or 08
TS510	5	100	25	25	3/4-16 UNF	16	1.4	1B or 08
TS515	5	150	25	25	3/4-16 UNF	16	1.4	1B or 08
TS520	5	200	25	25	3/4-16 UNF	16	2.2	1B or 08
TS105	10	50	38	20	1-8 UNC	19	2.1	1B or 08
TS1010	10	100	38	20	1-8 UNC	19	3.4	1B or 08
TS1015	10	150	38	20	1-8 UNC	19	4.8	1B or 08
TS1020	10	200	38	20	1-8 UNC	19	5.6	1B or 08
TS205	20	50	57	35	M38x2.0	26	7	1B or 08
TS2010	20	100	57	35	M38x2.0	26	8.8	1B or 08
TS2015	20	150	57	35	M38x2.0	26	11	1B or 08
TS2020	20	200	57	35	M38x2.0	26	12.7	1C or 17
TS305	30	50	65	35	M44x2.0	30	9.8	1B or 08
TS3010	30	100	65	35	M44x2.0	30	12.5	1B or 08
TS3015	30	150	65	35	M44x2.0	30	16	1C or 17
TS3020	30	200	65	35	M44x2.0	30	17.5	1C or 17

Model	Cyl. Cap.	Stroke	Piston Rod Dia	Base to Inlet port	Piston rod internal thread	Piston rod Thread Length	Weight	Pump
	t	mm	E mm	F mm	G	H mm	kgs	
TS505	50	50	85	35	M10x1.5	13	15.8	1C or 17
TS5010	50	100	85	35	M10x1.5	13	20	1C or 17
TS5015	50	150	85	35	M10x1.5	13	23.5	1C or 17
TS5020	50	200	85	35	M10x1.5	13	27.7	1C or 17
TS10010	100	100	110	40	M10x1.5	15	32.7	25
TS10015	100	150	110	40	M10x1.5	15	44.5	25