

Ratchet Type Loadbinder BS EN 12195-3 – LBREN

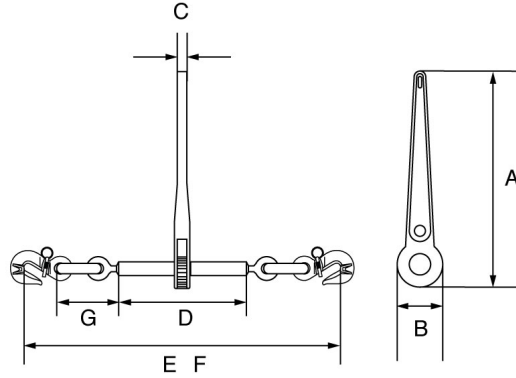

- Drop forged, cast steel, quenched and tempered.
- Red painted finish.
- Meets the performance requirements of BS EN 12195-3.
- Fitted with reinforced grab hooks complete with safety securing pin.
- Special securing device prevents threads coming out.
- Marked with L.C, M.B.F, manufacturers ID, size and product ID mark.
- Certification available [2.1](#) [2.2](#)

| Product Code | Chain Dia mm | A mm | B mm | C mm | D mm | E mm | F mm | G mm | Take Up mm |
|--------------|-----------------|---------|---------|---------|---------|---------|---------|---------|---------------|
| LBREN8 | 8 | 355 | 66 | 16 | 252 | 742 | 573 | 11 | 169 |
| LBREN10 | 10 | 355 | 66 | 16 | 252 | 789 | 620 | 13 | 169 |
| LBREN13 | 13 | 355 | 66 | 16 | 252 | 866 | 703 | 17 | 163 |
| LBREN16 | 16 | 355 | 66 | 16 | 252 | 892 | 733 | 20 | 159 |

| Chain Dia | L.C. | M.B.F. | Weight |
|-----------|------|--------|--------|
| mm | kN | kN | kg |
| 8 | 40 | 80.4 | 4.5 |
| 10 | 63 | 126 | 5.4 |
| 13 | 100 | 212 | 7.7 |
| 16 | 160 | 322 | 10.2 |