

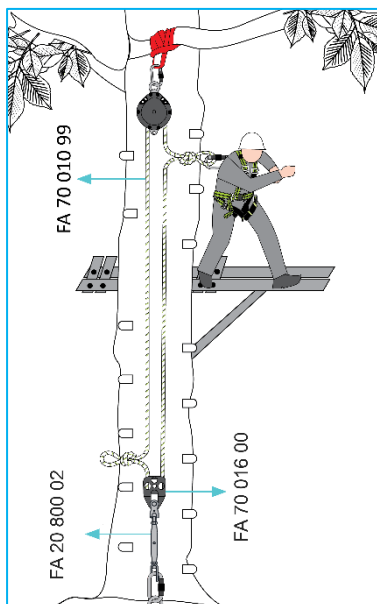

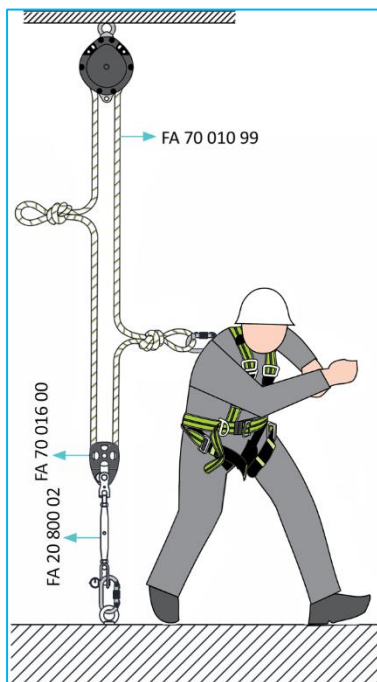

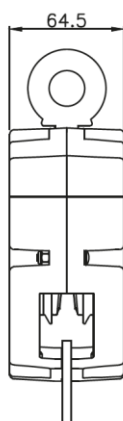

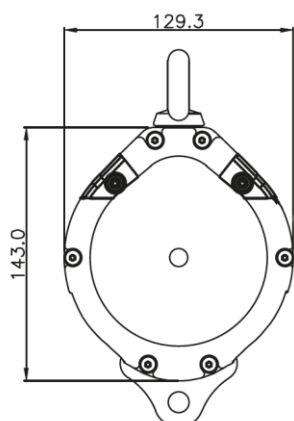

FA 20 800 00



Corde FA 70 010 99 vendue séparément
 Rope FA 70 010 99 sold separately
 Cuerda FA 70 010 99 vendida aparte
 Corda FA 70 010 99 venduta separatamente
 Seil FA 70 010 99 ist separat erhältlich



HS CODE
84798997
CARTON SIZE / PCS.
40 x 30 x 24 cm / 10
AET N° (in progress)
Satra Technology Europe Ltd., N° 2777, Bracetown Business Park, Clonee, Dublin, D15YN2P, Ireland
MODULE D FI14/14003.02
SGS Fimko Oy, N°0598 Takomotie 8, 00380 HELSINKI, Finland

REF.	FA 20 800 00
 KG	100 KG
CE	EN 360:2002
MAT.	Polyamide 6 - 30% fiber glass & 
	x1
R(kN)	13 kN
	NO
+	FA 70 010 99 + FA 20 800 01
	0.85 KG



Poids maxi utilisateur
Max. user weight
Peso máximo del usuario
Peso Max. dell'utente
Höchstgewicht des Benutzers

MAT.



Matière carter
Material of casing
Material cárter
Material dei carter
Material Gehäuse



Nombre d'émerillons
Number of swivels
Cantidad de eslabones giratorios
Numero di tornichetti
Anzahl der Wirbel



Homologué pour le travail à proximité d'arêtes vives
Approved for work near sharp edges
Homologado para trabajo cerca de aristas vivas
Omologato per lavoro in prossimità di spigoli vivi
Zugelassen für Arbeiten in der Nähe scharfer Kanten

+

À utiliser avec
To be used with
Para usar con
Ad essere utilizzato con
Verwendet werden soll mit