

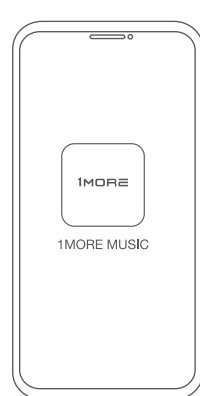

1MORE PistonBuds Pro User Guide

1MORE MUSIC APP



For users outside mainland China, please download the 1MORE MUSIC APP for product upgrades and additional features.

* APP UI in user guide may vary and for reference only, please refer to UI on device.

Inside The Box

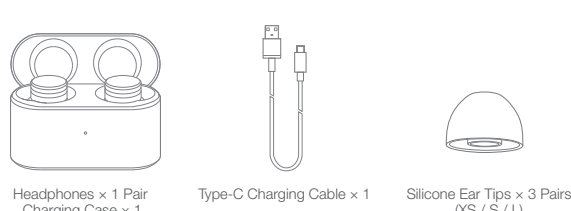

Product Overview

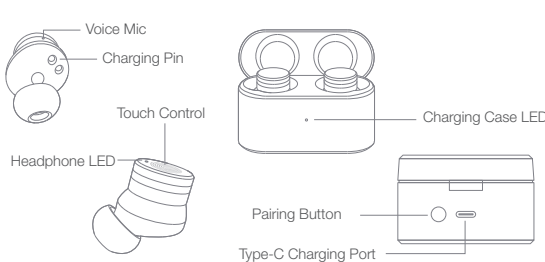

Placement

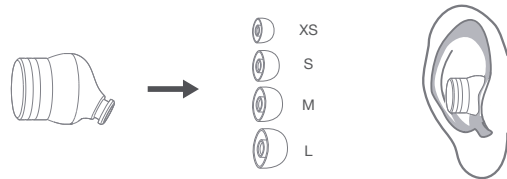

Power

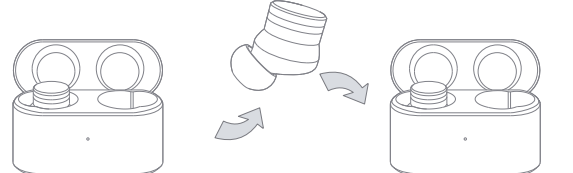

* Above functions are available for either earbud in individual or Stereo mode.

Charging Methods

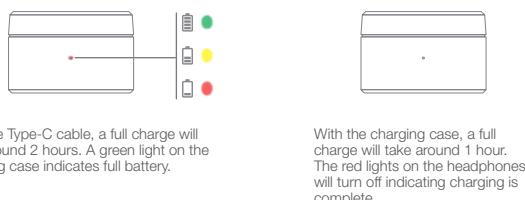

Battery Status Display in 1MORE MUSIC APP

Battery status of headphones and charging case will be displayed in 1MORE MUSIC APP.

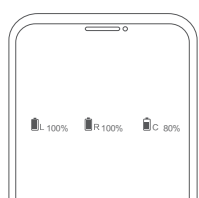

Auto Pause/Play:

Playback will auto pause when it detects the earbuds are removed from the ears, it will auto play when it detects they are on again. Smart Playback can be turned off via 1MORE MUSIC APP.



Switch Listening Modes

The default setting of the earbuds are "ANC Off"



Switch Listening Modes: Long press the touch control area on either earbud.

1MORE (1) Year Limited Warranty

1MORE warrants to the original retail purchaser that this product is to be free from defective materials and workmanship for a period of one year from the date of purchase if it is properly used and maintained. If this product proves defective in either material or workmanship, 1MORE, at its option, will (a) repair the product with new or refurbished parts, or (b) replace the product with an equivalent new or refurbished product, at no charge for parts or labor. If the product model is no longer available and cannot be repaired effectively or replaced with an identical model, 1MORE at its sole option may replace the unit with a current model of equal or greater value. In some cases, modification to the mounting surface may be required where a new model is substituted. 1MORE assumes no responsibility or liability for such modification. TO OBTAIN A REPAIR OR REPLACEMENT UNDER THE TERMS OF THIS WARRANTY, PLEASE RETURN TO THE ORIGINAL DEALER FIRST AND THE ORIGINAL DEALER SHALL REPAIR THE PRODUCT WITH NEW OR REFURBISHED PARTS OR REPLACE THE PRODUCT WITH AN EQUIVALENT NEW OR REFURBISHED PRODUCT. You will be required to submit a proof of purchasing details, including but not limited to a receipt or sales invoice. Return shipping for exchanges/repairs is the sole responsibility of the original retail purchaser.

Limitations:

- This limited warranty does not cover the failure of the product resulting from improper installation, misuse, abuse, accident, neglect, mishandling, or wear from ordinary use or environmental deterioration.
- This limited warranty does not cover cosmetic damage, including paint damage, or consequential damage to other components or premises which may result for any reason from the failure of the product.
- This limited warranty is null and void for products not used in accordance with 1MORE's instructions.
- This limited warranty is null and void for products with altered or missing serial numbers and for products not purchased from an AUTHORIZED dealer.
- This limited warranty terminates if you sell or otherwise transfer this product to another party.

FAQ

- Why the headphones cannot be turned on?
Check if your headphones have enough battery life. If not, please charge them for at least 30 minutes.
- Why the headphones cannot connect to my cellphone, or take a long time to connect?
1) If the left & right earbuds cannot be paired and only one earbud can be connected to the phone, please put the two earbuds back into the case, triple click the pairing button on the case, search for earbuds' name in your phones Bluetooth settings and tap to connect.
2) To connect with a new phone, put the earbuds back into the case, triple click the pairing button when the phone is powered on (no music or phone calls), search for earbuds' name in your phones Bluetooth settings and tap to connect.
- Why the headphones cannot play music after successfully connecting to my Android device?
After pairing successfully, on the Bluetooth menu of your device, tap the icon on the right of your device name and make sure the "Media Audio" option is on.
- Why there is no sound from the headphones while making phone calls after successfully connecting to my Android device?
After pairing successfully, on the Bluetooth menu of your device, tap the icon on the right of your device name and make sure the "Phone Audio" option is on.
- Why the Bluetooth connection is not stable and causes some interruptions?
1) By shortening the distance between your headphones and devices. Avoid solid barriers in between.
2) Please keep away from strong interference sources, such as Wi-Fi and GPFS.
3) Please make sure the Bluetooth antenna of your device is not blocked.
- Why some control functions do not match those in the manual while using third party music/video player Apps?
Your operating system and the third party music/video player apps may have different settings for the control functions. We recommend that you use the music/video player apps that your device has originally provided.
- I turned the headphones up to the maximum volume, but why the actual volume still sounds low?
In different operating systems, especially some Android systems, the headphones and your device have separate volume control systems. Please adjust the volume controls on both the device and the headphones according to your preference.
- Why are my headphones not able to connect to 1MORE MUSIC APP for the primary use?
For Android users, please click "Allow all the time" to access to the location information of your device when entering 1MORE MUSIC APP. Or adjust this option in your settings for this app.

* For more detailed product FAQs, please visit the product support section under www.1more.com

Warning

Replacement of a battery with an incorrect type that can defeat a safeguard (such as catching fire, explosion, leakage of corrosive electrolyte etc).

Disposal of a battery into fire or a hot oven, or mechanically crushing or cutting of a battery, that can result in an explosion;
Leaving a battery in an extremely high temperature surrounding environment that can result in an explosion or the leakage of flammable liquid or gas; and A battery subjected to extremely low air pressure that may result in an explosion or the leakage of flammable liquid or gas.

--- The symbol indicates DC voltage.



This product bears the selective sorting symbol for Waste electrical and electronic equipment (WEEE). This means that this product must be handled pursuant to European directive 2014/53/EU in order to be recycled or dismantled to minimize its impact on the environment.

User has the choice to give his product to a competent recycling organization or to the retailer when he buys a new electrical or electronic equipment.



To prevent possible hearing damage, do not listen at high volume levels for long periods.

The SAR limit of USA (FCC) is 1.6 W/kg for head averaged over one gram of tissue. Device types EC302 (FCC ID: 2ASDIEC302) has also been tested with 0mm against this SAR limit.

IC regulatory conformance

This device complies with CAN ICES-003 (B)/NMB-003(B). This device contains licence-exempt transmitter(s)/receiver(s) that comply with Innovation, Science and Economic Development Canada's licence-exempt RSS(s). Operation is subject to the following two conditions:

- This device may not cause interference.
 - This device must accept any interference, including interference that may cause undesired operation of the device.
- Cet appareil est conforme à la norme CAN ICES-003 (B)/NMB-003 (B). Cet appareil contient des émetteurs / récepteurs exempt (s) de licence qui sont conformes aux RSS exemptes de licence d'Innovation, Sciences et Développement économique Canada. Son fonctionnement est soumis aux deux conditions suivantes:
- Cet appareil ne doit pas provoquer d'interférences.
 - Cet appareil doit accepter toute interférence, y compris les interférences susceptibles de provoquer un fonctionnement indésirable de l'appareil.

The SAR limit of Canada (ICES) is 1.6 W/kg for head averaged over one gram of tissue. Device types EC302 (IC:24662-EC302) has also been tested with 0mm against this SAR limit.

Headphones Pairing

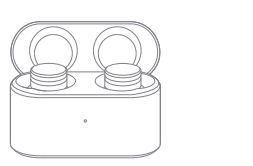

The Left and Right headphones will automatically pair to each other after the lid is open when they are in the case (with charge).

Bluetooth Pairing To The Device

- To connect to your device during first use, turn the headphones on to enter pairing mode. The headphones will enter sleep mode if not paired to a device within 3 minutes.
- After the first successful pairing, headphones will automatically connect to your device when the case lid is opened.
- To pair with a new device; put headphones back into the case, click the pairing button for 3 times when powered on (no music or phone calls) to re-enter pairing mode.



* Above functions are available for either earbud in individual or Stereo mode.

Battery Notification



Low Battery Alert: When there is 25-30 minutes of use time left, you will hear a voice prompt.



Tap the touch control area of the headphones to control phone calls and music playback.

Touch Controls

Tap the touch control area of the headphones to control phone calls and music playback.

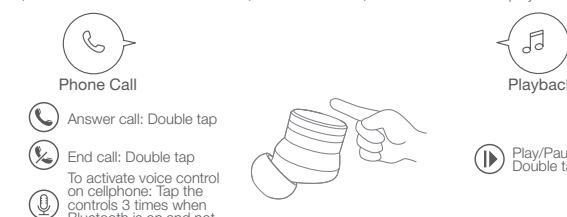

- * Reject Call: Long press 2 seconds.
- * To control the music playback or volume adjustment, please set it up on 1MORE MUSIC APP or operate on the connected mobile phone or devices.
- * Above functions are available for either earbud in individual or Stereo mode.
- * Above functions may vary with different devices.

Multiple noise cancellation options are available via 1MORE MUSIC APP:

- ANC Mode: suitable for aviation, highspeed train, metro etc.
 - Pass-through Mode: Lets in environmental sounds so you don't need to take out the earbuds to hear what is going on around you.
 - WNR (Wind Noise Resistance): To lessen the annoying wind noise.
- Once the Listening mode has been set up in the APP, they will be memorized by the headphones allowing you to switch modes based on your settings.

Extra Functions

- If the earbuds cannot pair normally when powered on, open the case and quickly click the pairing button 3 times to reset the Left & Right pairing process.
 - Unpair the Connected Device: Put the earbuds into the case, press and hold the pairing button for 8 seconds.
 - OTA Firmware Update: It can be synchronously upgraded via the 1MORE MUSIC APP while the Left and Right earbuds are connected to each other with at least 50% battery.
- * Functions of 1MORE MUSIC APP may vary with different cellphones or operating systems. For more details, please contact our customer service.

We Appreciate Your Business

We know you will enjoy new 1MORE headphones as much as we do. At 1MORE, we value your satisfaction. If you would like more details on this product or any of our other products, please visit us online by scanning the QR code. Go to www.1more.com and sign up for VIP, and 1MORE will treat you like one.

Tips

- Please read this instruction manual carefully and retain for future reference.
- Please fully charge the battery before first use.
- If the headphones have been unused for more than 3 months, we recommend that you charge them. This will improve battery capacity.
- Only use charging cables and adapters that are FCC (Federal Communications Commission) approved.
- In dry environments, static electricity may numb your ear. This is not related to the quality of the product.

Safety Information

- Never disassemble the headphones. There are no user-serviceable parts inside.
- Do not expose the headphones to temperatures below 32 °F (0 °C) or to temperatures above 113 °F (45 °C).
- Do not use the headphones in a thunderstorm storm. This could prevent the headphones from working properly, and also increase your chance of being electrically shocked.
- Do not use oil or any volatile liquid to clean this product.
- Do not listen at high volumes for extended periods of time.
- Do not use the headphones in traffic. Do not use the headphones any time it would be dangerous to be unaware of noises around you.
- Adult supervision is required for children of age 6 and under.

WEEE

Electrical and electronic equipment, parts and batteries marked with this symbol must not be disposed of with normal household waste; it must be collected and disposed of separately to protect the environment.

Your 1MORE retailer will advise you of the correct way of disposal in your country.

Safety Caution

Do not expose batteries or battery packs to excessive heat such as sunshine, fire or the like.

CE

Declaration of Conformity Hereby, Tinlab Acoustic Technology Limited declares that the radio equipment type 1MORE PistonBuds Pro Wireless Headphones of EC302 is in compliance with Directive 2014/53/EU. The full text of the EU declaration of conformity is available at the following internet address: www.1more.com



Hereby, Tinlab Corporation declares that the radio equipment type Wireless Headphones is in compliance with UK Radio Equipment Regulations (SI 2017/1206). The full text of the EU declaration of conformity is available at the following internet address: www.1more.com

EU regulatory conformance:
RF exposure information: The ERP power of the device at maximal case is below the exempt condition: 20mW (specified EN62479:2010).
RF exposure assessment has been performed to prove that this unit will not generate the harmful EM emission above the reference level as specified in EC Council Recommendation(1999/519/EC).
Declaration for EU Compliance
Operation Frequency/Max. ERP: 2402-2480MHz, 10 dBm.

FCC

This device complies with part 15 of the FCC rules. Operation is subject to the following two conditions:

- (1) this device may not cause harmful interference, and (2) this device must accept any interference received, including interference that may cause undesired operation.
- NOTE: The manufacturer is not responsible for any radio or TV interference caused by unauthorized modifications or changes to this equipment. Such modifications or changes could void the user's authority to operate the equipment.
NOTE: This equipment has been tested and found to comply with the limits for a Class B digital device, pursuant to part 15 of the FCC Rules. These limits are designed to provide reasonable protection against harmful interference in a residential installation. This equipment generates uses and can radiate radio frequency energy and, if not installed and used in accordance with the instructions, may cause harmful interference to radio communications. However, there is no guarantee that interference will not occur in a particular installation. If this equipment does cause harmful interference to radio or television reception, which can be determined by turning the equipment off and on, the user is encouraged to try to correct the interference by one or more of the following measures:
- Reorient or relocate the receiving antenna.
- Increase the separation between the equipment and receiver.
- Connect the equipment into an outlet on a circuit different from that to which the receiver is connected.
- Consult the dealer or an experienced radio/TV technician for help.

Supplier's Declaration of Conformity
47 CFR § 2.1077 Compliance Information
Unique Identifier:
Trade Name: 1MORE
Model No.: EC302
Responsible Party – U.S. Contact Information
1MORE USA, Inc.
Address: 10229 Barnes Canyon Road, Suite A202, San Diego, California, 92121
Tel: 1-855-551-6673
E-Mail: support@1moreusa.com

Name: Wireless Earphones	Playtime* (ANC Off):
Model: EC302	Headphone Fully Charged: 7.5h
Headphone Weight: 4.5 g	Headphones & Case Fully Charged: 30h
Case Weight: 30.5 g	Impedance: 16 Ω
Product Weight: 39.5 g	Wireless Range: 10 m
Headphone Size: 17×18×21.4 mm	Bluetooth® 5.2
Headphone Size: 58×23×37.7 mm	Bluetooth Protocol: HFP / A2DP / AVRCP
Headphone Battery Capacity: 38 mAh	Input: 5V=0.5A
Case Battery Capacity: 410 mAh	Working Temperature: 0 °C – 45 °C
Headphone Charging Time: 1h	Frequency Band: 2.400 GHz – 2.4835 GHz
Case Charging Time: 2h	
Playtime* (ANC On):	
Headphone Fully Charged: 5h	
Headphones & Case Fully Charged: 20h	

The specifications are acquired from laboratory tested data.
* The playback time, tested under the laboratory condition of AAC format and 50% volume, may vary with different device settings, user preferences, usage and other factors.
Manufacturer: Tinlab Corporation
Address: No. 3333, Lixian Avenue, Tower A, 35th Floor, Tanglang City, Nanshan District, Shenzhen, China
Product information can be found at www.1more.com
Made in China