

# Bircher Signal Indicator (BSI)

## RF-Level in open area

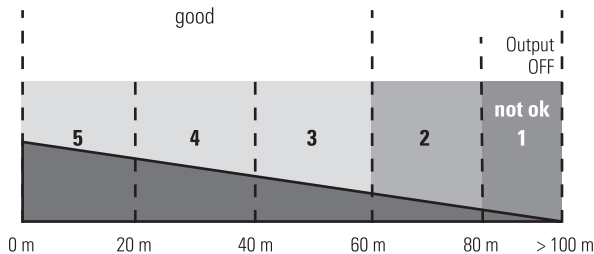

The level is shown by **green LED** flashes and beeps on the receiver XRF-RD will show signal strength also in numbers on LCD display.

- ⓘ The beeps/LED flashes will occur at random intervals within a few seconds (max. 9 s off) or upon sensing edge/sensor activation.

## Two options

### A. 1st check within configuration/pairing mode (no gate/door movements)

#### Activation

Simply activate by **brief press** of the **button** within configuration/**pairing** mode.

Step by step instruction see page 2.

#### Use

Move around with selected transmitter (possibly receiver): check for best position/orientation of devices

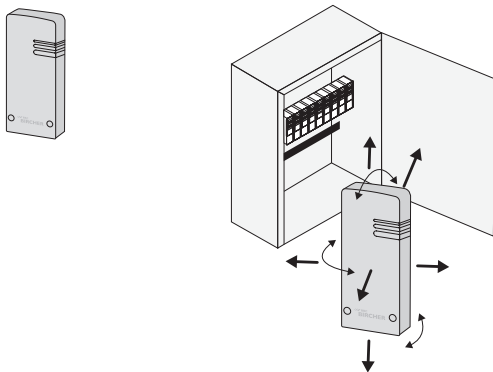

### B. In depth analysis with normal gate/door operation (more complex to activate)

Due to constant signalling typically only recommended for temporary use.

#### Activation

To enter into these functional indication modes please refer to the step by step instructions on pages 3, 4 & 5

#### Use

Have gate/door running and observe over various cycles if BSI stays within acceptable limits (best ≥ level 3)

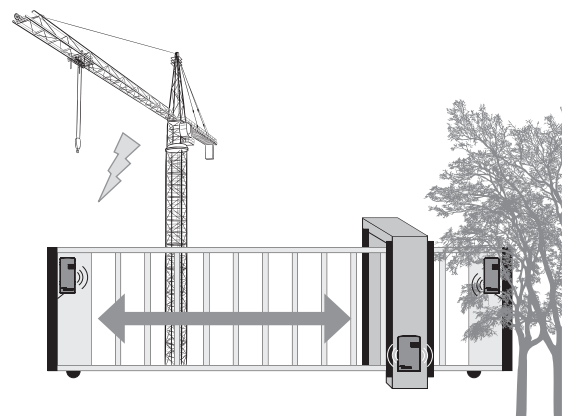

## How to activate temporary BSI Mode

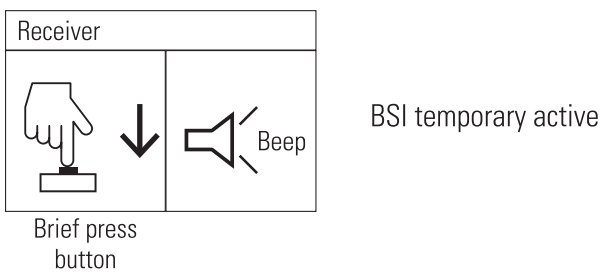
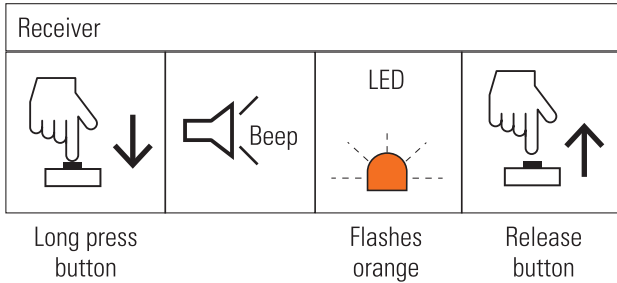

**i** Press one sensing edge/activate one sensor to set which transmitters RF-Signal shall be monitored.

## How to deactivate

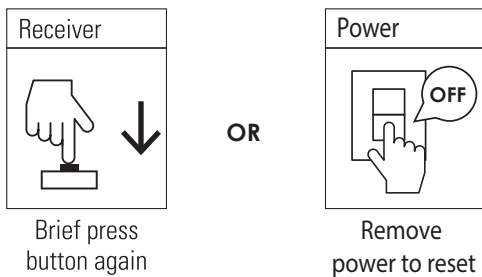

## How to leave pairing mode

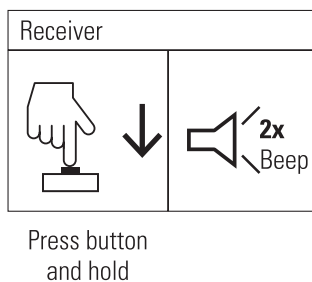

## Guide for Single and Dual Channel Receiver

### How to activate permanent BSI Mode (LED Indication Only)

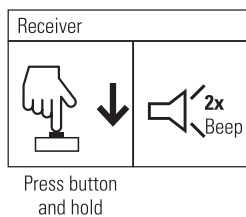
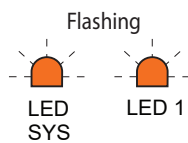
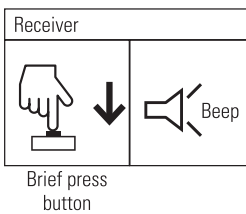
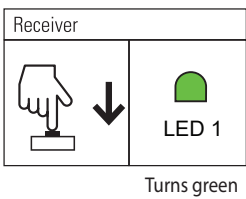
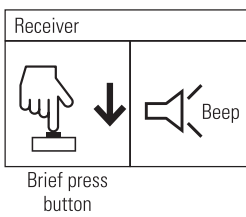
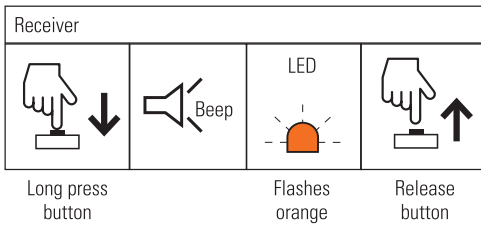

### Exiting this mode and returning to normal Operation

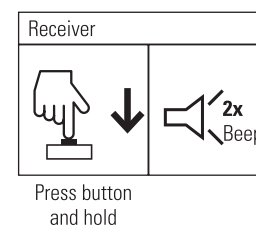
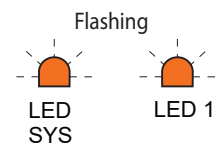
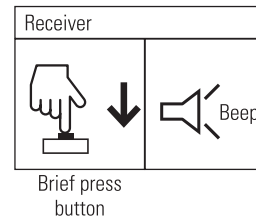
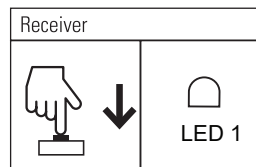
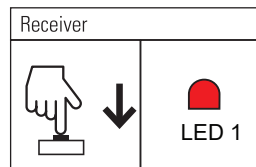
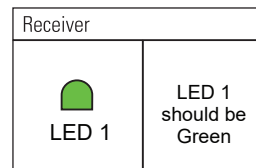
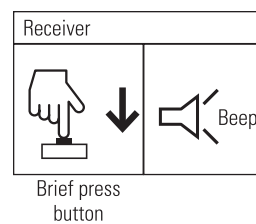
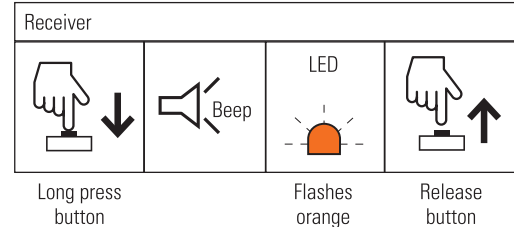

## Guide for Single and Dual Channel Receiver

### How to activate permanent BSI Mode (LED & Beep Indication)

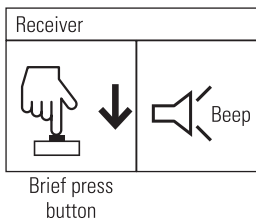
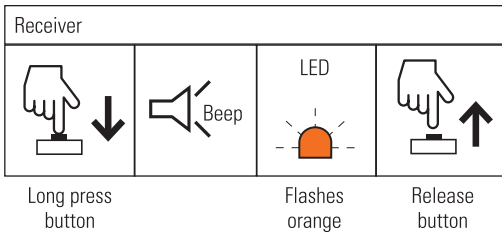

BSI temporary active

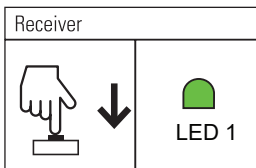

Press button until LED 1 turns GREEN (5 Secs)

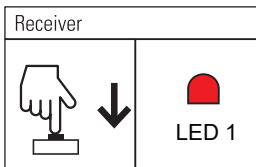

Press button until LED 1 turns RED (5 Secs)

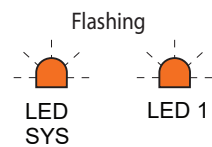
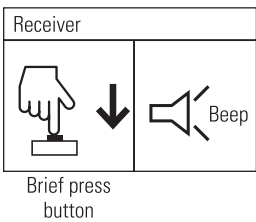

You should now return to normal operation with BSI function (Audible Beep & LED flash) every 5 seconds or when edge is activated

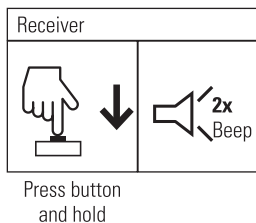

### Exiting this mode and returning to normal Operation

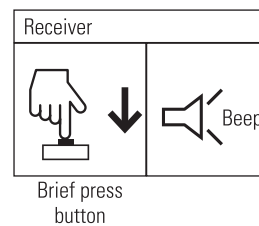
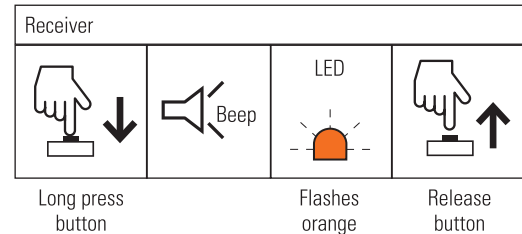

BSI temporary active

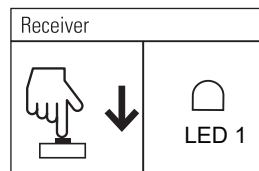
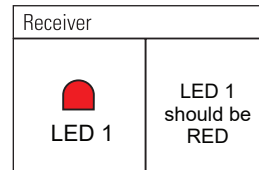

Press button until LED 1 turns OFF (5 Secs)

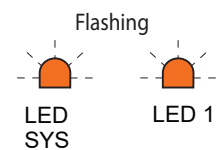
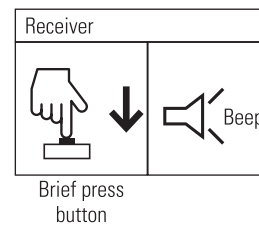

You should now return to normal operation with BSI function disabled

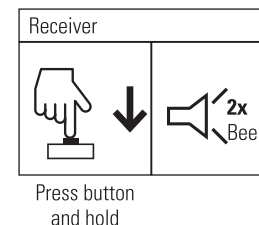

## Guide for XRF.RD & XRF.RD.A Receiver

### How to activate temporary BSI Mode

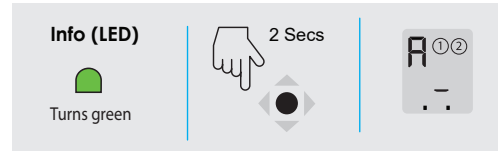
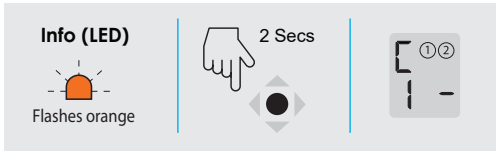

ⓘ **NOTE:** Display may vary depending on set up of Unit

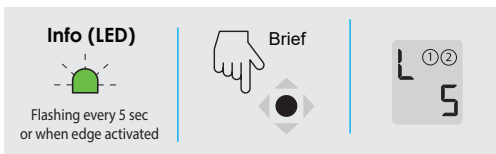

### How to activate permanent BSI Mode

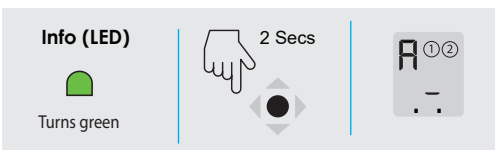
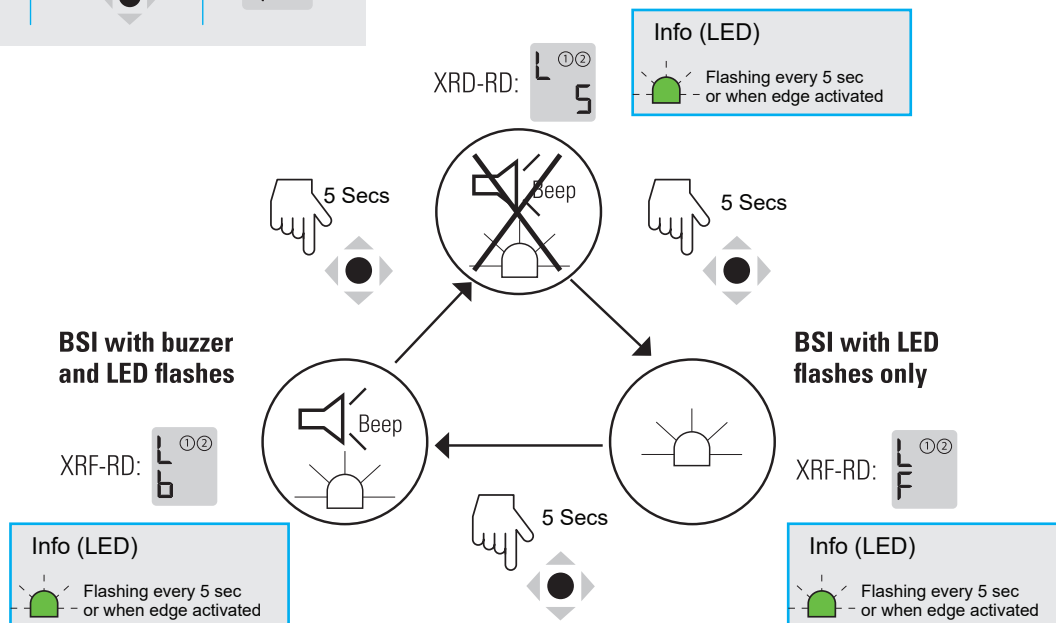
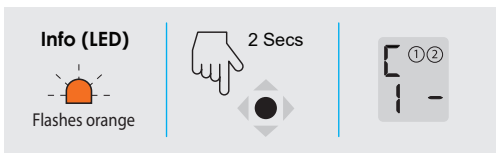

ⓘ **NOTE:** Display may vary depending on set up of Unit

ⓘ **Exiting modes at any stage will either flash LED only, Flash and beep or turn off as displayed in the diagram above. To change setting at any time, repeat as above.**

