

ELITE BATHROOMWARE

# VANITY

INSTALLATION  
INSTRUCTIONS &  
WARRANTY  
INFORMATION



# THANK YOU

**FOR PURCHASING AN ELITE BATHROOMWARE VANITY. PLEASE READ THE FOLLOWING INSTRUCTIONS PRIOR TO INSTALLING YOUR VANITY. FAILURE TO COMPLY WITH THESE INSTRUCTIONS COULD INVALIDATE YOUR WARRANTY.**

*(IT IS RECOMMENDED THAT A QUALIFIED, LICENSED TRADES PERSON INSTALL YOUR UNIT.)*

Prior to installation it is important to inspect the unit and ensure no damage has occurred in transit. If damage has occurred, or a visible defect exists, do not proceed with installation and advise the supplier immediately.

Note: The supplier will not be liable for the cost of installation or removal of the unit. The warranty will be null and void if damage occurred during or after installation.

1. Check the wall is straight, (not bowed or twisted). Ensure unit is square against the wall before securing. Door and drawer alignment could be affected otherwise.
2. For wall hung units: Decide appropriate height for top of unit. For a Polymarble or full Vitreous China top we recommend 880mm from the finished floor to the top of the basin. For a Vessel style bowl with stone top we recommend 900mm from the finished floor to the top of the basin. These are however only guidelines so they can be hung at whatever level you wish.
3. Drill holes for pipes in base/rear of unit with appropriate size hole saws.
4. Position unit over pipes and check level with spirit level.
5. Securely fasten unit to wall through the back with bolts and washers, no further than 100mm from end of cabinet. Upper fixings no lower than 100mm from top of back. Also secure with a blob of silicone in each corner of the vanity.
6. Tops without fixing holes should be secured with silicone to the vanity carcass on all four sides. This includes stone tops, polymarble tops and Vitreous china tops. This helps with the rigidity of the overall vanity.



## SEAL ALL EDGES

7. Seal all edges where water penetration may occur, i.e. between top, wall and floor, etc. (Materials used in the construction of bathroom furniture are water-resistant not waterproof). Ensure only silicone is used according to supplier's instructions. DO NOT use adhesive. If a hole is drilled in the top for a tap or soap dispenser, this must also be sealed with silicone. Failure to fully silicone seal the vanity and top together, and the carcass to the wall will void all warranties and may result in water damage.

**8. Please refer to Silicone Seal Instructions.**

9. When a separate basin is to be fitted it is essential that the basin be fully sealed to the top to prevent any water penetration.

10. Tiles, mirrors etc. Surrounding the installation must provide adequate space for future removal of product if required. Tiles or mirrors must clear cabinet by at least 3mm.

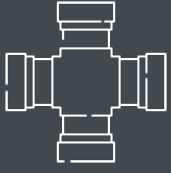

## RECOMMENDATION FOR PLUMBING

1. Do not over tighten the waste as this may cause stress on basin or top.
2. Contoured waste to suit must be fitted to basin.
3. Basin overflow must line up with waste opening.
4. Waste hole opening must not be blocked by sealant.
5. Ensure all edges are sealed with silicone as per install instruction 8.



## CLEANING & MAINTENANCE

1. To maintain the finish on your unit and top, use only a soft cloth, or a weak solution of non-abrasive detergent. Do not use cleaners that incorporate isopropyl alcohol or abrasives like Jif.
2. Mirrors should be cleaned with diluted methylated spirits only (dilute 1:10). Do not spray cleaners directly onto the glass as this can cause water damage, spray onto a cloth first. Remove all moisture caused by splashes, wet hands, or steam with a chamois or soft cloth after use where possible.



## LIGHTING

Product that is exposed to natural light may result in discolouring of product. This is not covered by warranty.

## SILICONE SEAL INSTRUCTIONS



**PART A** Silicone top to the vanity

**PART B** Silicone vanity edges against wall on both sides and around vanity top edge

# THE ELITE BATHROOMWARE WARRANTY

---

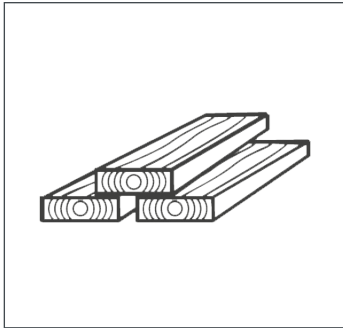

---

## 01. MATERIAL

---

Elite Bathroomware warrants that in the supply of its products, only high quality workmanship and materials have been used. If within five years there should be a fault with either materials or workmanship, Elite Bathroomware will repair at its own cost or, with consideration, arrange the replacement or repair of faulty product. If replacement or repair is hindered by incorrect installation, Elite Bathroomware will not be responsible for removal/replacement.



---

## 02. WARRANTY EXCLUSIONS

---

This warranty does not cover damage by improper installation, i.e. fixing with adhesives, abuse, accident, misuse, excessive wear and tear, negligence, neglect, natural causes e.g. water and sunlight, improper care and maintenance, water temperatures in excess of 55 degrees Celsius, humidity, direct lighting and other environmental conditions.

It should be noted that all cabinets are water-resistant not waterproof. Any spillage or leakage of water that may come in contact with the unit should be carefully dried immediately as water damage is not a justifiable claim. Installation, cleaning and maintenance instructions need to be followed to ensure validity of warranty.

The warranty does not cover hardware used incorrectly or exposed to loads in excess of the specification.

NB: Failure to follow instructions will void warranty.



---

## 03. SUPPORT

---

The Elite Bathroomware warranty applies for five years from the date of purchase. Proof of the purchase date needs to be produced by the purchaser when making a claim.

The bathroom vanity you have purchased includes high quality concealed hinges and drawer slides from Hettich (Germany) and distributed by Hettich New Zealand and covered by their life time warranty against defects in material and workmanship. The warranty does not cover hardware used incorrectly or exposed to loads in excess of the specification.

# Hettich Drawer Adjustments

With extended use of your cabinetry, adjustments may sometimes be required. Hettich hinges are simple to adjust.

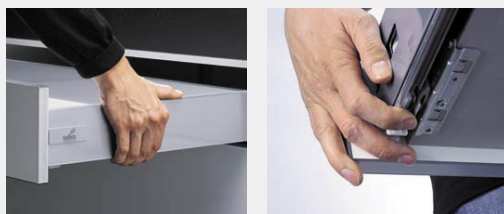
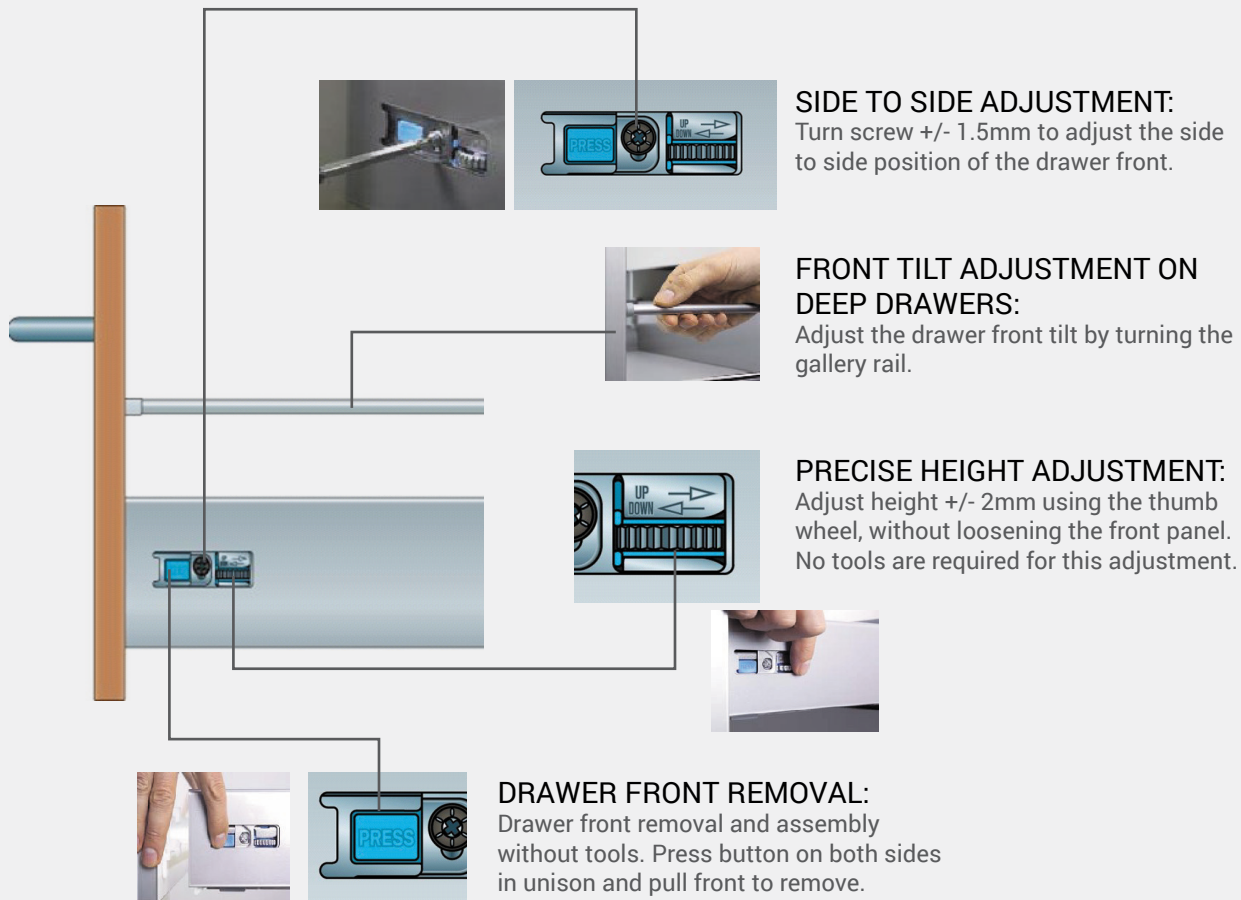

## DRAWER INSTALLATION AND REMOVAL:

The drawer is fitted simply by pulling out drawer runners, positioning drawer on the runners and pushing it into place. It is automatically connected to the runner by two catches. You will here a click when it has engaged. Removal is just as easy. The catches on the bottom of the drawer box are pressed in while pulling the drawer forward.