

ORBIT ROUND UNEQUAL SIDED SHOWERS

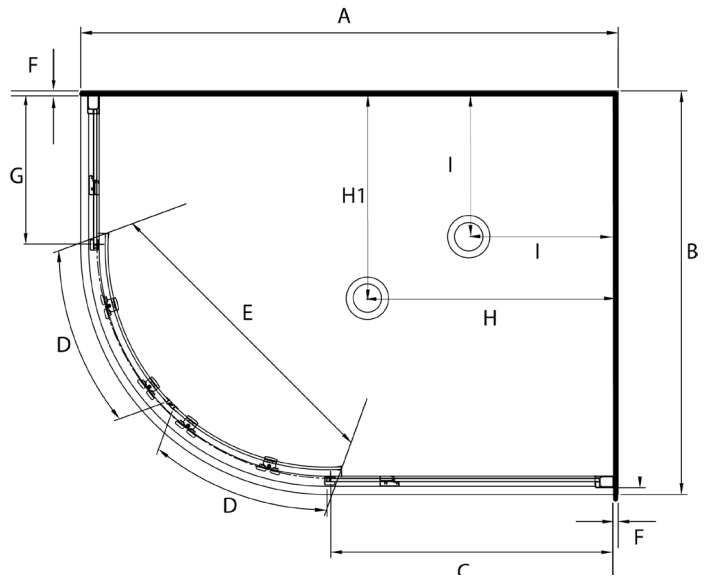

LH



RH

DESCRIPTION

The Orbit Unequal Sided range of Showers can be brought as a complete shower cubicle including Acrylic Tray, Wall Liner and Door pack.

The Door Pack and Tray can also be brought as individual items for a tiled floor and/or wall installation.

FEATURES

- Low profile tray with 40mm upstand
- 1950mm high glass
- Total OVERALL height 2020mm
- Quick release rollers for easy cleaning
- Magnetic strip on closing edges of doors
- 6mm Safety Glass
- Polished quality metal chrome handle, inner & outer

LEGEND

Dimension	Description	Shower Size			
		12 x 8 RH	12 x 8 LH	12 x 9 RH	12 x 9 LH
A	Tray External Length	1200mm	1200mm	1200mm	1200mm
B	Tray External Width	800mm	800mm	900mm	900mm
C	Large Glass Return Panel	640mm	640mm	640mm	640mm
D	Door Panel Width	410mm	410mm	410mm	410mm
E	Door Opening Width	450mm	450mm	540mm	540mm
F	Gib and Liner thickness +/- 1.5mm	12.5mm	12.5mm	12.5mm	12.5mm
G	Small Glass Return Panel	200mm	200mm	335mm	335mm
H	Centre Waste Dimension	N/A	N/A	550mm	550mm
H1	Centre Waste Dimension	N/A	N/A	450mm	450mm
I	Corner Waste Position	250mm	250mm	250mm	250mm

ORDERING CODES

Description	Shower Size			
	12 x 8 LH	12 x 8 RH	12 x 9 LH	12 x 9 RH
CORNER WASTE				
Complete Cubicle White Flat Wall	98065	98069	98081	98085
Complete Cubicle Chrome Flat Wall	98066	98070	98082	98086
Complete Cubicle White Moulded Wall	98067	98071	98083	98087
Complete Cubicle Chrome Moulded Wall	98068	98072	98084	98088
CENTRE WASTE				
Complete Cubicle White Flat Wall	N/A	N/A	98073	98077
Complete Cubicle Chrome Flat Wall	N/A	N/A	98074	98078
Complete Cubicle White Moulded Wall	N/A	N/A	98075	98079
Complete Cubicle Chrome Moulded Wall	N/A	N/A	98076	98080
PARTS ONLY				
Tray Only Centre Waste	N/A	N/A	TFR12X9LHCW	TFR12X9RHCW
Tray Only Corner Waste	TFR12X8LHCNR	TFR12X8RHCNR	TFR12X9LHCNR	TFR12X9RHCNR
Liner Only Flat Wall 1950mm High	LB12X8FW2S195	LB12X8FW2S196	LB12X9FW2S197	LB12X9FW2S198
Liner Only Moulded Wall 1950mm High	LB12X8MW2S195	LB12X8MW2S196	LB12X9MW2S197	LB12X9MW2S198
Round Door Pack Complete 1950mm High White	DR12X8WH195	DR12X8WH195	DR12X9WH195	DR12X9WH195
Round Door Pack Complete 1950mm High Chrome	DR12X8SI195	DR12X8SI195	DR12X9SI195	DR12X9SI195

WARRANTY INFORMATION

All bathroomware products supplied by Nouera Shower Systems carry our Quality Assurance and Product Warranty. We use the highest quality materials available and manufacture these in accordance with New Zealand specifications and requirements to ensure that all products are fit for the intended purpose for which they are designed. Our customers peace of mind is of paramount importance to us.

Warranty Periods

Baths	10 years
Showers	10 years
Shower Screens and Doors	10 years

Warranty Exclusions

The product must be installed according to the instructions supplied.
The water supply temperature applied to the product must not exceed 55 degrees Celsius.
Commercial applications are restricted to a 2 year warranty on all products.

CLEANING AND MAINTENANCE

Bathroom products are used often and the following is our suggestion on how to clean and care for them.

Shower Wall

We use Durosan premium quality sanitaryware grade Acrylic. It is, by design, very robust and chemical resistant. A soft damp cloth with non-abrasive cleaners should be used. Use only non-abrasive cleaners that are recommended for acrylic products.

Shower Tray and Bath

We manufacture our Shower Trays and Baths using a Solid Acrylic Surface. Most other shower trays are manufactured using a veneer acrylic surface. The great advantage is that small scratches can be removed easily by using fine cutting compound. Again, the same basic cleaning methods as the wall are recommended.

Shower Doors and Glass

All glass is compliant to AS/NZS 2208. We suggest that the glass surfaces are wiped down or squeegeed following use to remove excess water. For best results use a trusted glass cleaner.

Metal Framework

Should be cleaned using a soft damp cloth with non-abrasive cleaner. Note that on round showers, the bottom rollers are easy release for ease of cleaning. If chemical spray cleaners are used, avoid direct contact with the rollers and guides and ensure the shower is rinsed off to avoid residue build up.

Weather Seals and Drip Strips

Can be removed if required for cleaning, and can be replaced when they no longer look their best. Refer to the spare parts and accessories section of our website for more details.

Note - If the Glass has been treated follow specific cleaning instructions from the system provider.

ORDERING CODES

Description	Shower Size						
	820mm	900mm	928mm	955mm	1000mm	1010mm	1055mm
CENTRE WASTE							
Complete Cubicle White Flat Wall	98001	98009	98021	98029	98037	98049	98057
Complete Cubicle Chrome Flat Wall	98002	98010	98022	98030	98038	98050	98058
Complete Cubicle Black Flat Wall	N/A	98011	N/A	N/A	98039	N/A	N/A
Complete Cubicle White Moulded Wall	98003	98012	98023	98031	98040	98051	98059
Complete Cubicle Chrome Moulded Wall	98004	98013	98024	98032	98041	98052	98060
Complete Cubicle Black Moulded Wall	N/A	98014	N/A	N/A	98042	N/A	N/A
CORNER WASTE							
Complete Cubicle White Flat Wall	98005	98015	98025	98033	98043	98053	98061
Complete Cubicle Chrome Flat Wall	98006	98016	98026	98034	98044	98054	98062
Complete Cubicle Black Flat Wall	N/A	98017	N/A	N/A	98045	N/A	N/A
Complete Cubicle White Moulded Wall	98007	98018	98027	98035	98046	98055	98063
Complete Cubicle Chrome Moulded Wall	98008	98019	98028	98036	98047	98056	98064
Complete Cubicle Black Moulded Wall	N/A	98020	N/A	N/A	98048	N/A	N/A
PARTS ONLY							
Tray Only Centre Waste	TFR820CW	TFR900CW	TFR928CW	TFR955CW	TFR1000CW	TFR1010CW	TFR1055CW
Tray Only Corner Waste	TFR820CNR	TFR900CNR	TFR928CNR	TFR955CNR	TFR1000CNR	TFR1010CNR	TFR1055CNR
Liner Only Flat Wall 1950mm High	LB820FW2S195	LB9X9FW2S195	LB928FW2S195	LB955FW2S195	LB1X1FW2S195	LB1X1FW2S195	LB1055FW2S195
Liner Only Moulded Wall 1950mm High	LB820MW2S195	LB9X9MW2S195	LB928MW2S195	LB955MW2S195	LB1X1MW2S195	LB1X1MW2S195	LB1055MW2S195
Round Door Pack Complete 1950mm High White	DR820WH195	DR900WH195	DR928WH195	DR955WH195	DR1000WH195	DR1010WH195	DR1055WH195
Round Door Pack Complete 1950mm High Chrome	DR820SI195	DR900SI195	DR928SI195	DR955SI195	DR1000SI195	DR1010SI195	DR1055SI195
Round Door Pack Complete 1950mm High Black	N/A	DR900BL195	N/A	N/A	DR1000BL195	N/A	N/A

WARRANTY INFORMATION

All bathroomware products supplied by Nouera Shower Systems carry our Quality Assurance and Product Warranty. We use the highest quality materials available and manufacture these in accordance with New Zealand specifications and requirements to ensure that all products are fit for the intended purpose for which they are designed. Our customers peace of mind is of paramount importance to us.

Warranty Periods

Baths	10 years
Showers	10 years
Shower Screens and Doors	10 years
Black Coated Framework	5 years

Warranty Exclusions

The product must be installed according to the instructions supplied.
The water supply temperature applied to the product must not exceed 55 degrees Celsius.
Commercial applications are restricted to a 2 year warranty on all products.

CLEANING AND MAINTENANCE

Bathroom products are used often and the following is our suggestion on how to clean and care for them.

Shower Wall

We use Durosan premium quality sanitaryware grade Acrylic. It is, by design, very robust and chemical resistant. A soft damp cloth with non-abrasive cleaners should be used. Use only non-abrasive cleaners that are recommended for acrylic products.

Shower Tray and Bath

We manufacture our Shower Trays and Baths using a Solid Acrylic Surface. Most other shower trays are manufactured using a veneer acrylic surface. The great advantage is that small scratches can be removed easily by using fine cutting compound. Again the same basic cleaning methods as the wall are recommended.

Shower Doors and Glass

All glass is compliant to AS/NZS 2208. We suggest that the glass surfaces are wiped down or squeegeed following use to remove excess water. For best results use a trusted glass cleaner.

Metal Framework

Should be cleaned using a soft damp cloth with non-abrasive cleaner. Note that on round showers, the bottom rollers are easy release for ease of cleaning. If chemical spray cleaners are used, avoid direct contact with the rollers and guides and ensure the shower is rinsed off to avoid residue build up.

Weather Seals and Drip Strips

Can be removed if required for cleaning, and can be replaced when they no longer look their best. Refer to the spare parts and accessories section of our website for more details.

Note - If the Glass has been treated follow specific cleaning instructions from the system provider.