



R35 Nissan GTR

Competition

Paddle Shifter

Installation

Guide

ACG Automotive
7884 Ronson Road
San Diego, CA 92111
858.633.1017
www.acgautomotive.com

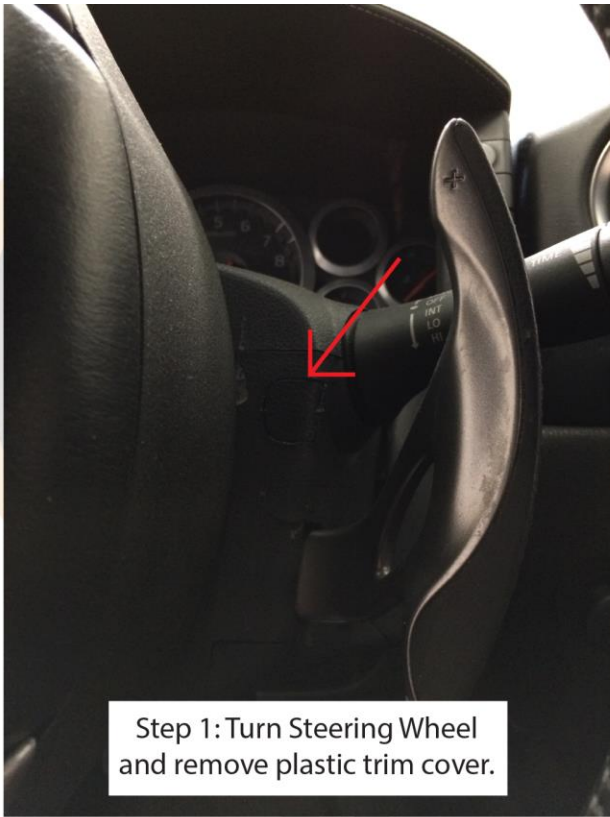

Step 1: Turn Steering Wheel and remove plastic trim cover.



Step 2: Remove Screw Located here and repeat on other side.



Step 3: Lift top trim cover up.



Step 4: Carefully pry outer trim panels away from steering column and remove.

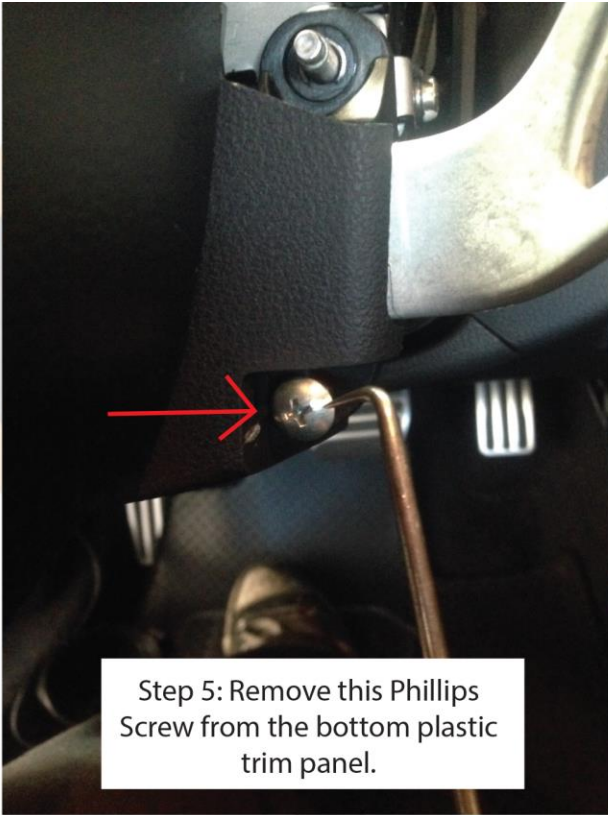

Step 5: Remove this Phillips Screw from the bottom plastic trim panel.



Step 6: Remove this 10mm Nut that fastens the front of the paddle assembly.

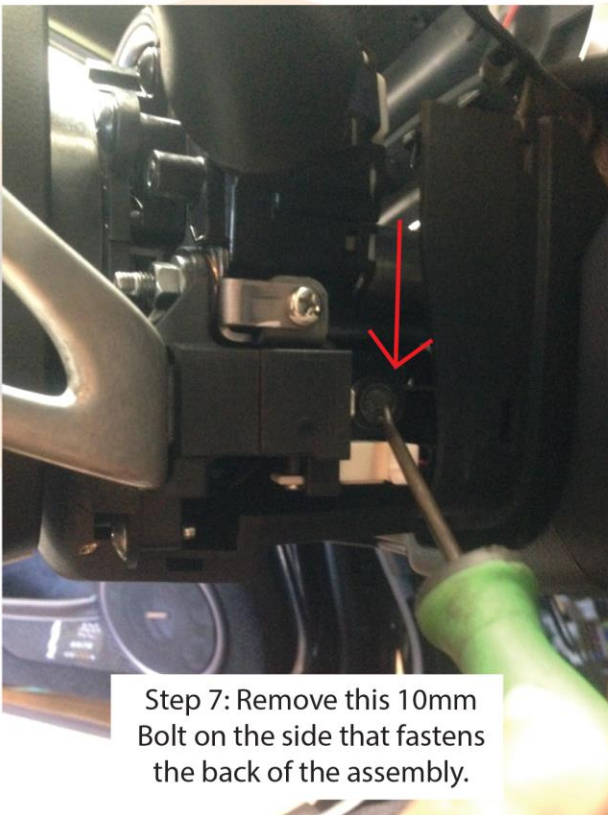

Step 7: Remove this 10mm Bolt on the side that fastens the back of the assembly.

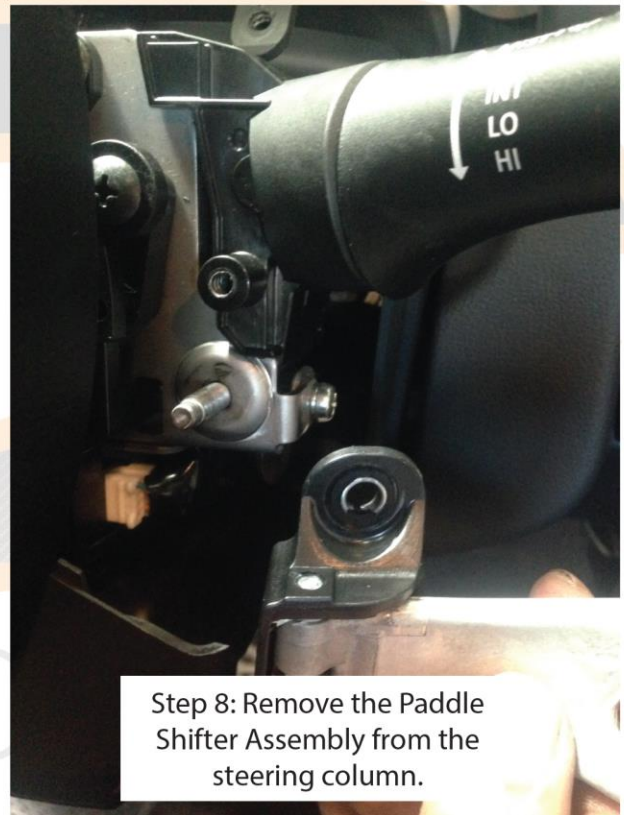

Step 8: Remove the Paddle Shifter Assembly from the steering column.

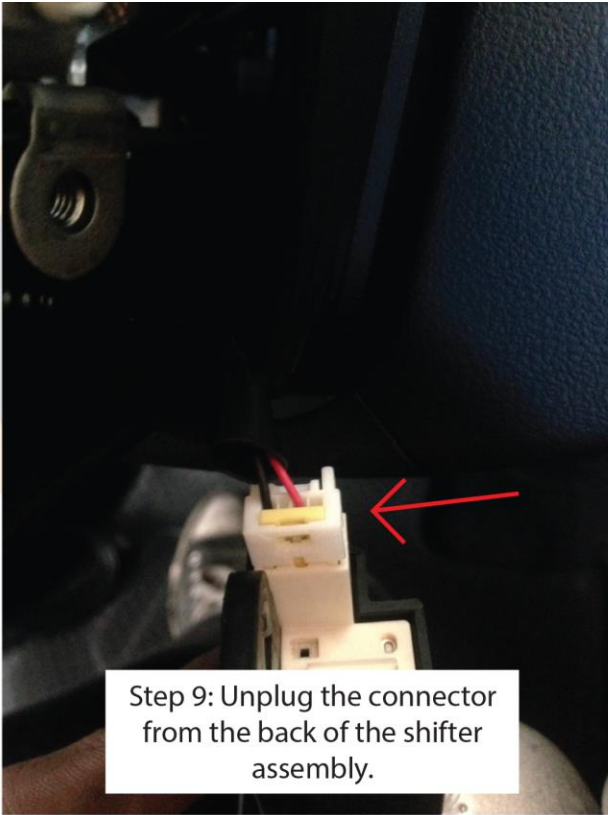

Step 9: Unplug the connector from the back of the shifter assembly.



Step 10: Remove screw on bottom side of paddle shifter assembly.



Step 11: Remove plastic backing plate.

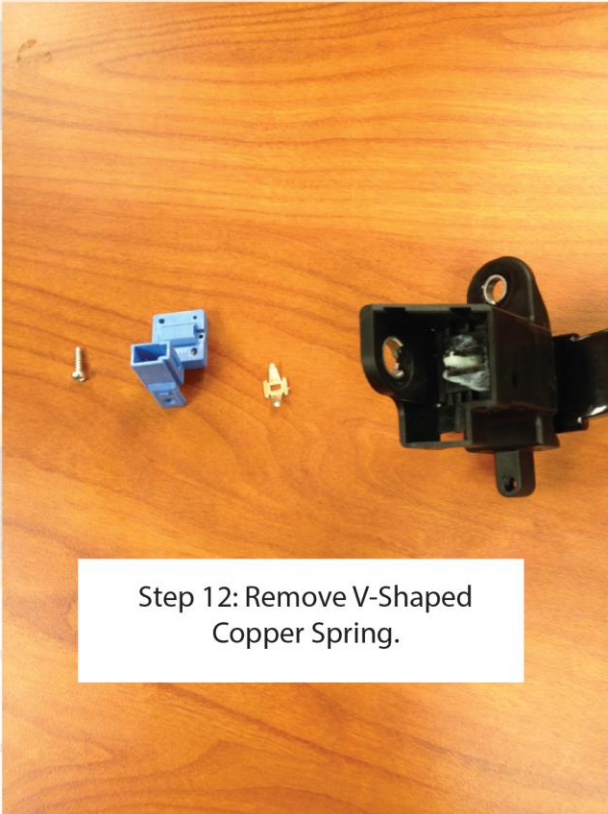

Step 12: Remove V-Shaped Copper Spring.



Step 13: Use a punch to remove the pin that the paddle shifter rotates on.



Step 14: Remove paddle from assembly.



Step 15: Remove white plastic shift fork from paddle shifter.

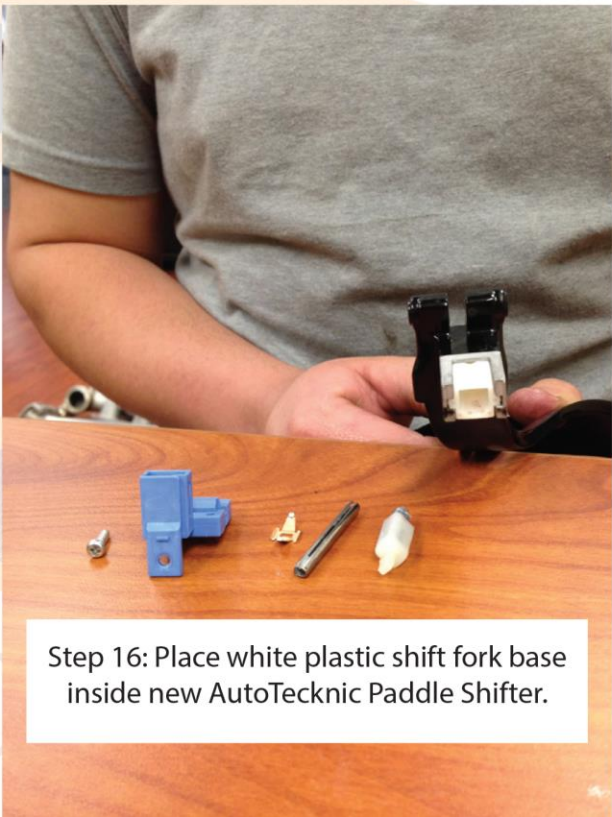

Step 16: Place white plastic shift fork base inside new AutoTecknic Paddle Shifter.

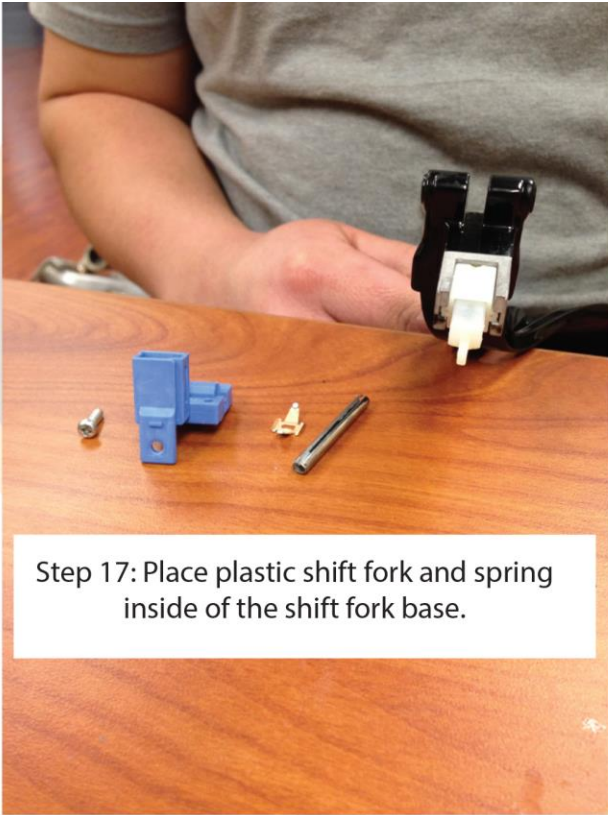

Step 17: Place plastic shift fork and spring inside of the shift fork base.



Step 18: Place new AutoTecknic Paddle shifter inside assemble and reinsert pin.



Step 18.2: Make certain pin sits flush on both top and bottom of the paddle shifter assembly.

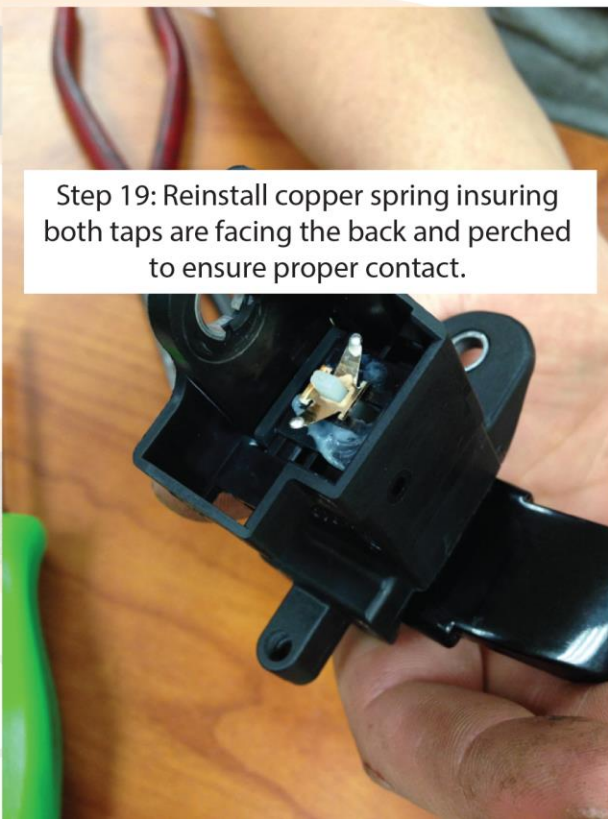

Step 19: Reinstall copper spring insuring both taps are facing the back and perched to ensure proper contact.

Step 20: Reinstall plastic back plate.



Step 21: Reinstall screw on underside.



Reinstall everything in reverse order and enjoy!

