



CABLE COVER ORGANIZER KIT

USER GUIDE AND INSTALLATION INSTRUCTIONS

	PAGE
Applications, Specifications, Warnings and Cautions	2
Kit Contents	3
Layout and Installation	
Painting	4
Layout Preparation	5
Mark Raceway Path	6
Coupler Locator Notches	7
Mark Raceway Ends	8
Install Raceway C-Channels	9
Raceway C-Channel Mounting Options	10
Insert Cables Into Raceway C-Channels	11
Install Anti-Slump Strips If Needed	12
Install Covers and Couplers	13
Swing Joints and Uneven Surfaces	14 - 15

APPLICATIONS, SPECIFICATIONS, WARNINGS and CAUTIONS



APPLICATIONS: Hiding, Organizing and Managing Cables and Cords for:

- Entertainment Systems, TVs
- Office and Desk
- Kitchen, Workshop
- Network and WiFi Equipment
- Printers, Scanners, Copiers
- Phone Lines

SPECIFICATIONS:

Material	PVC
Paintable	Yes
Raceway Dimensions	1.2" W x 0.6" D (30mm x 15mm)

WARNINGS AND CAUTIONS:

- This Product and Packaging is Not a Toy. This is not a safety device.
- Only to be used for its intended purpose
- This product is not designed to be used as a wiring box, enclosure or conduit where compliance with Electrical Code (such as NEC) is a requirement. It is not to be used to extend hard-wired electrical wiring and connections.
- Contact a professional installer if appropriate
- Manufacturer is not responsible damage to walls, furniture, appliances or property due to improper installation

KIT CONTENTS

- 1** (12) Raceway Sections (C-Channel with Cover), 16.7"/425mm
- 2** (12) Double-Sided Tape Strips, 16"/410mm
- 3** (12) Straight Couplers
- 4** (4) Flat Elbow Couplers
- 5** (1) Inside Elbow Coupler
- 6** (1) Outside Elbow Coupler
- 7** (1) Tee (3-Way) Coupler
- 8** (28) Screws, M3.5 x 1"
- 9** (28) Drywall Anchors, Fiberglass-Reinforced Nylon
- 10** (12) Cable Clips (3 88mm sticks, user cuts to 22mm)
- 11** (6) Slump Eliminator Strips

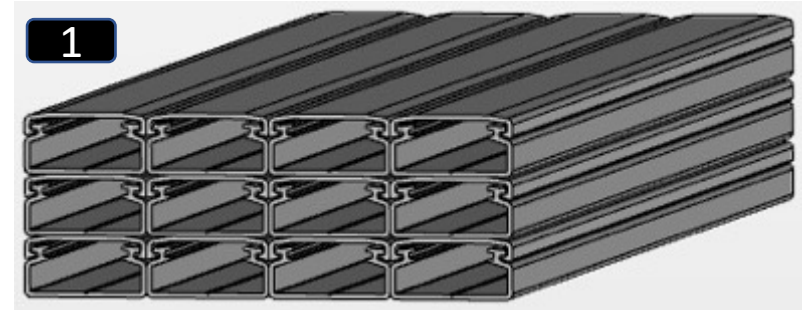

2

x 12

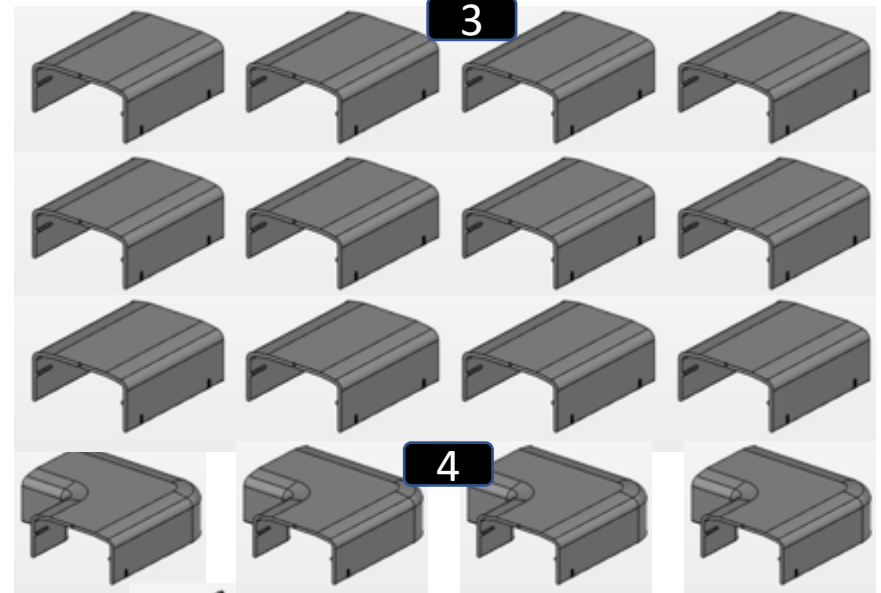

4

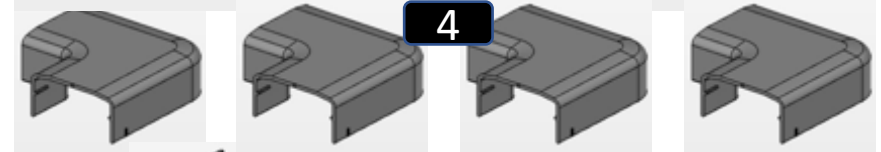

5

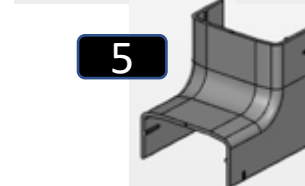

6



7

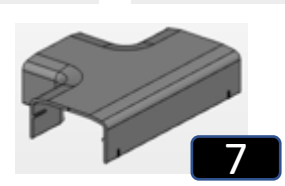

8



9



10

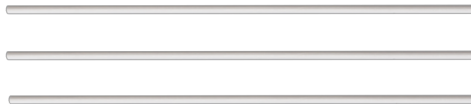

11



LAYOUT & INSTALLATION



HELPFUL HINTS: PAINTING

- The Raceway Sections and Couplers are Paintable.
- No priming is required.
- Make sure the surfaces are clean and dry prior to painting.
- It is recommended that you paint AFTER installation.

LAYOUT & INSTALLATION

1 LAYOUT PREPARATION

For complex installs, it's helpful to generate a simple sketch of your layout before you begin installing. Here are some things you might want to include in your layout sketch.

- Raceway Entry/Exit Points
- List of Cables/Cords at each of the Entry/Exit Points
- Specify where those Cables/Cords are going from the Entry/Exit Points
- Basic drawing of the Raceway Sections and Couplers required

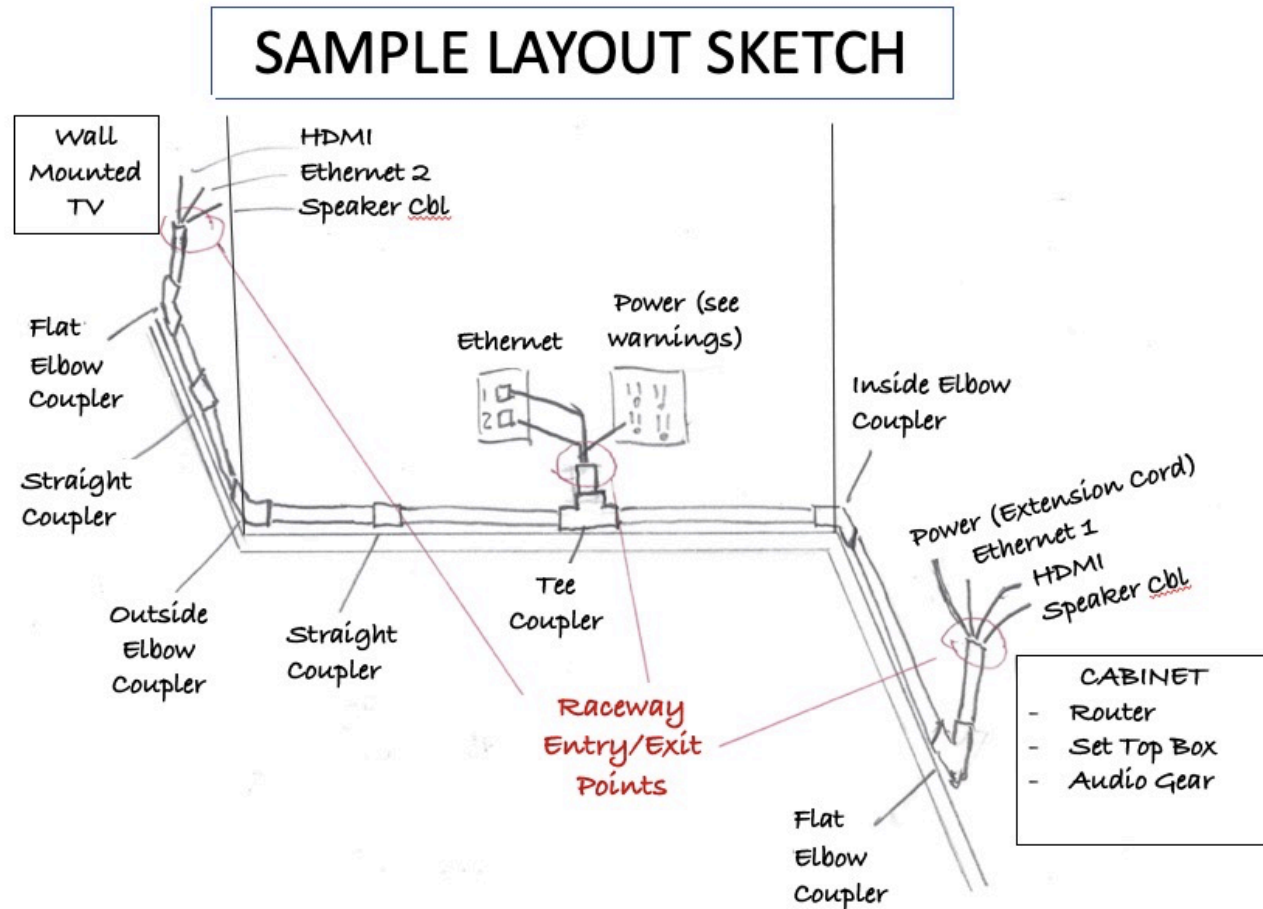

LAYOUT & INSTALLATION



2

MARK RACEWAY PATH - HELPFUL HINTS



Using a Pencil, Straight Edge and Level, lightly mark the wall with the Centerline of your Raceway path.

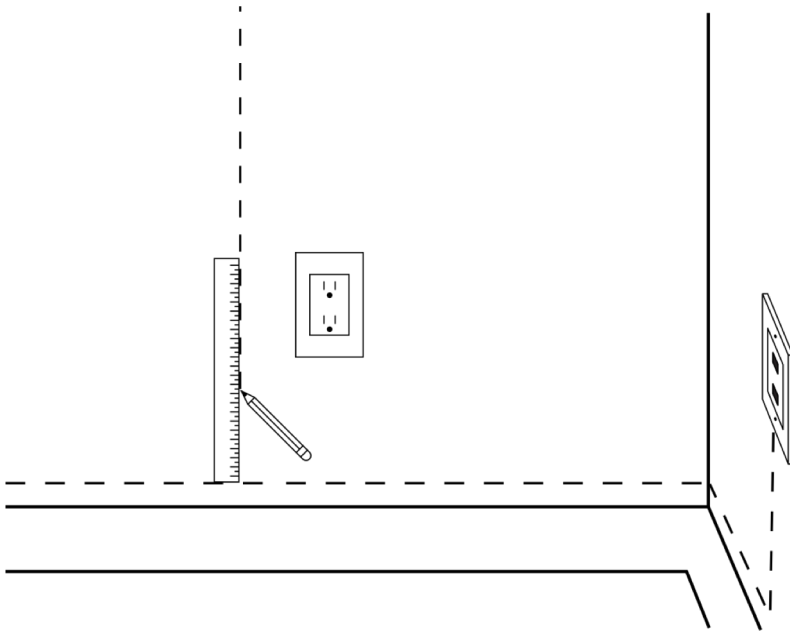

When running straight lengths of Raceway against a wall corner or molding edge:

- Do not butt the Raceway sections directly against the corner. Leave a small space (about 4mm) to install your Couplers over the Raceway.
- To mark the centerline, place a Straight Coupler backwards against the corner. Use the Center Locator Notch to mark the exact centerline location for Raceway placement.

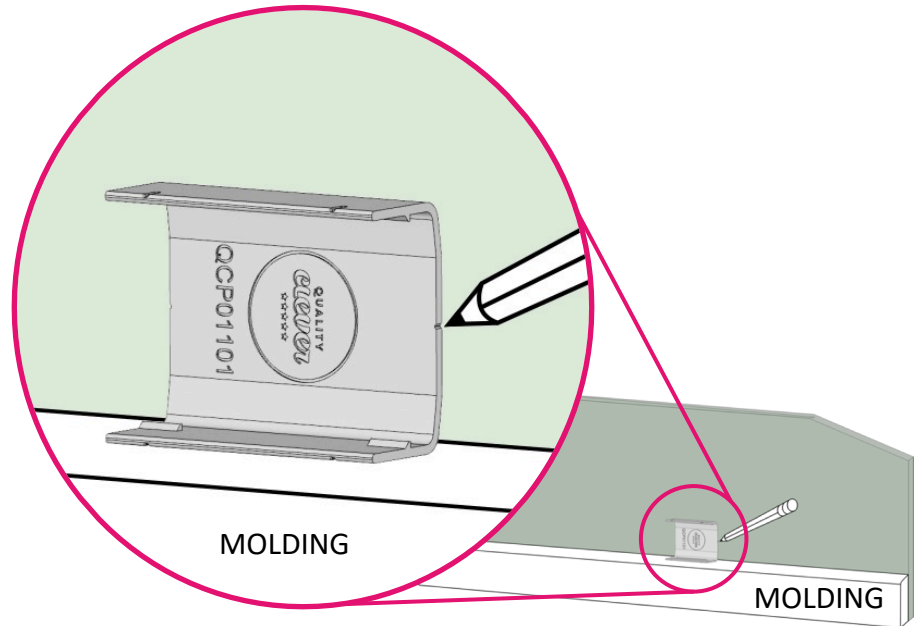



LAYOUT & INSTALLATION



IMPORTANT INFORMATION

Each opening on every Coupler has:

-  A **Center Locator Notch** To properly line up the Coupler with the centerline mark during the layout process.
-  Two **Edge Locator Notches** To demarcate the line where the Raceway end must fall within (see Step 3)

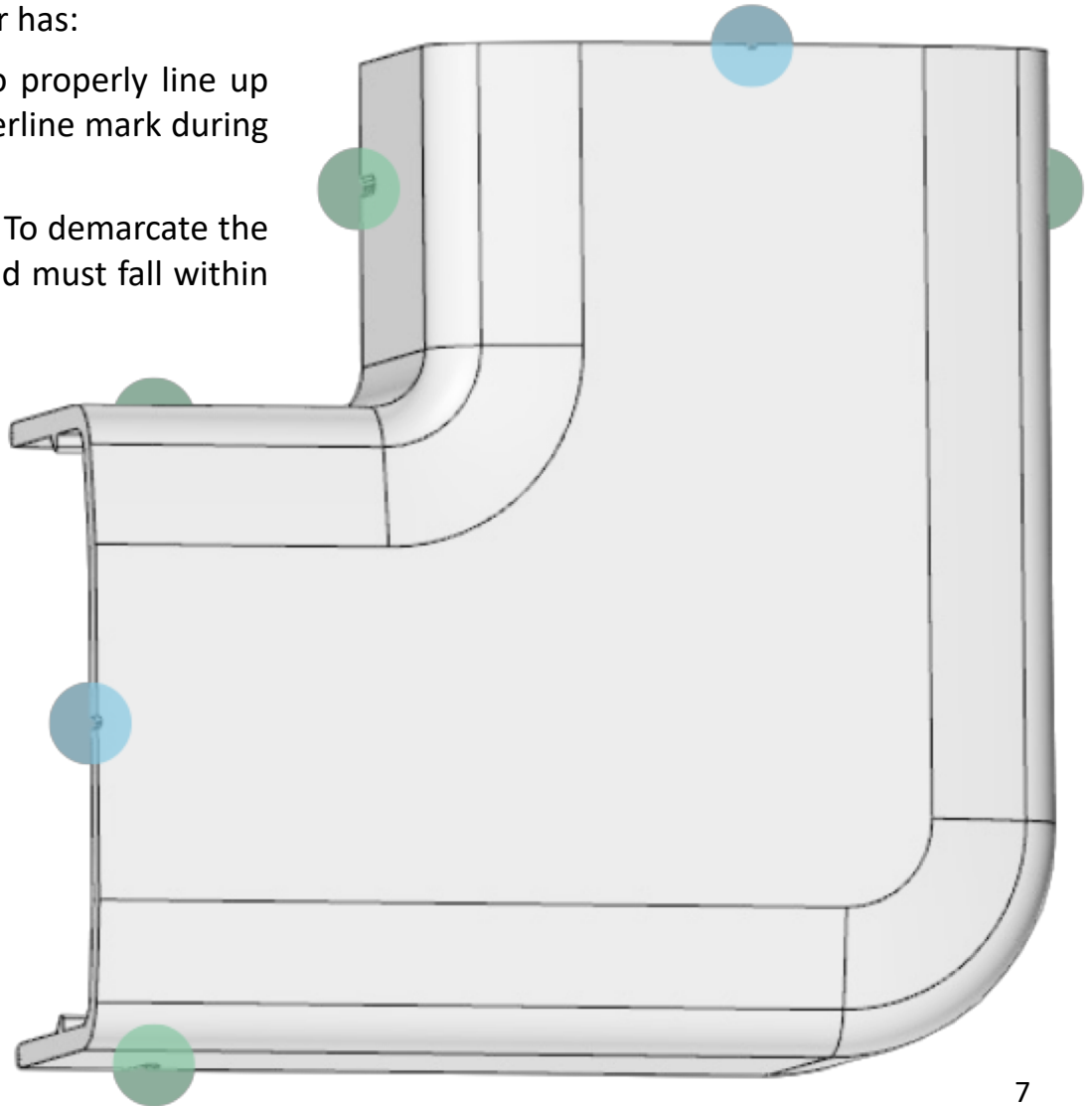

LAYOUT & INSTALLATION



3 MARK RACEWAY ENDS (ELBOWs AND TEEs)

For each of the Elbow connections (Flat, Inside, Outside) and Tee connections, hold the corresponding Coupler against the wall with the Center Locator Notches aligned with your Raceway path Centerline and place small marks at each of the Raceway Edge Locator Notches.

Flat Elbows

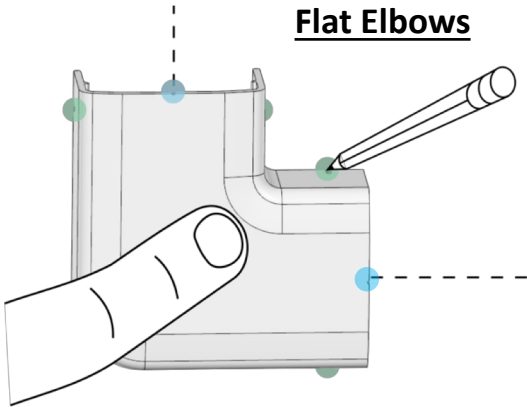

Inside Elbows

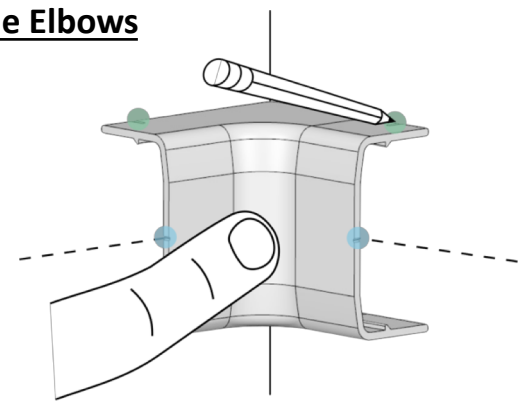

- Center Locator Notches
- Raceway Edge Locator Notches

Outside Elbows

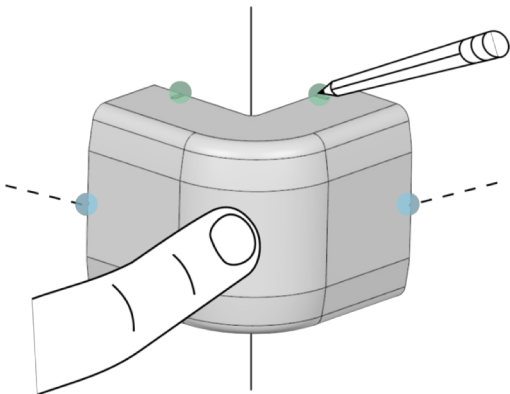

Tees

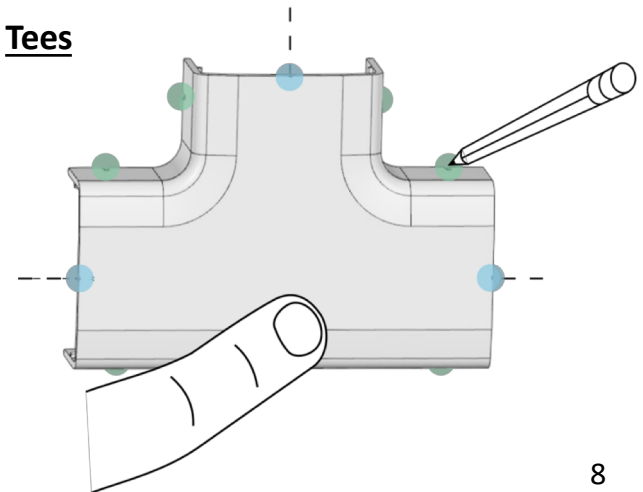

LAYOUT & INSTALLATION



4 INSTALL RACEWAY C-CHANNELS

For each straight line segment, start installing Raceway C-Channels at one end, working toward the other end. Cut Raceway sections as required. Remove Raceway Covers before installing the C-Channels. Be sure to align the groove in the center of the C-Channel with your Centerline mark. *See mounting instructions on the next page.*

For Elbow and Tee connections, the Raceway end just needs to fall within about $\frac{1}{2}$ " (12mm) of Raceway Edge Locator marks (from Step 3).

For Straight connections, the Raceway ends also need to fall inside the Edge Locator Notch marks BUT the gap between the mating Raceway Ends can be as small as 0 (ends butted together).

Flat Elbows

Inside Elbows

Straight

CUTTING RACEWAY SECTIONS: Cut C-Channels with Covers in place. Use a Fine-Tooth Hacksaw or PVC/ABS Pipe Saw. Deburr sharp edges with a Razor Knife or File.

Outside Elbows

Tees

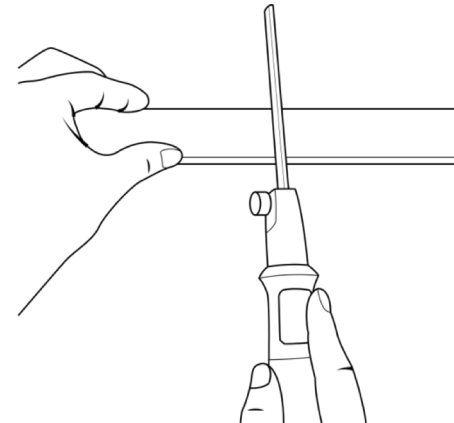

LAYOUT & INSTALLATION



IMPORTANT INFORMATION

The Raceway C-Channels can be secured to your walls or furniture surfaces using the supplied Double Sided Tape, Screws, or both.

Double-Sided Tape: The wall or desk surface must be smooth (no heavy texture), clean and dry. Measure, mark and cut the Tape with Scissors. Apply the Tape to the back side of the "C" Channel. Press the "C" Channel in place.



To get perfect alignment of your screws with Drywall Anchors or Studs **WITHOUT DRILLING LOCATOR HOLES:**

- i. Place a mark for your Raceway end.
- ii. Hold your C-Channel with the edge aligned directly above or below the Centerline, mark the Anchor and/or Stud locations on the inside of the C-Channel.
- iii. Align the C-Channel edge and center grooves with the wall markings, drive the screws through the cross-hatch marking.

Screws: Use 2 screws per Raceway section.



Drywall Anchors and Screws are Self-Tapping

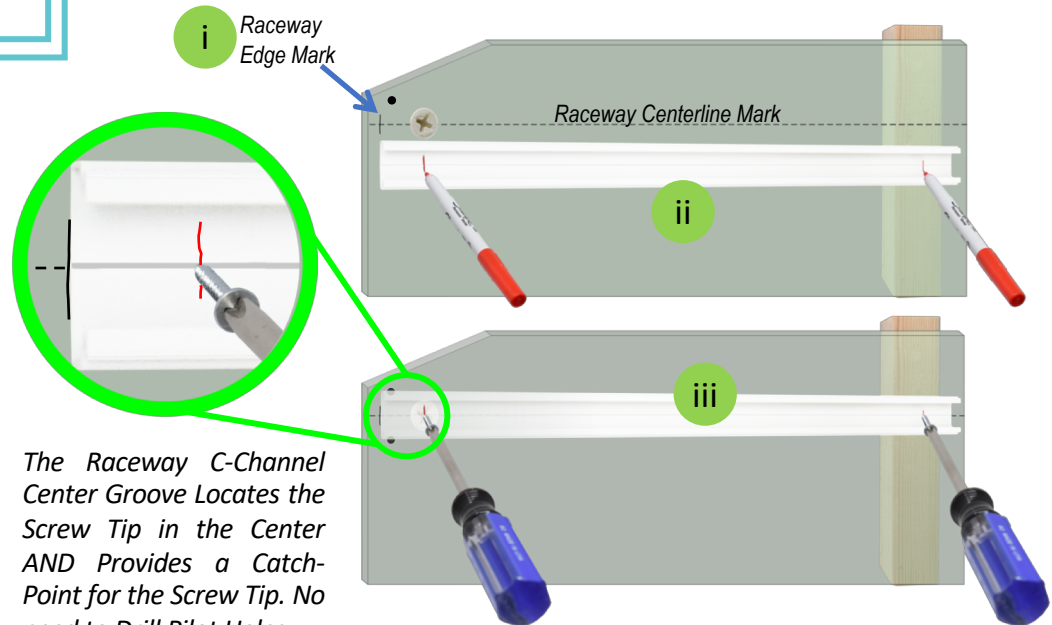

The Raceway C-Channel Center Groove Locates the Screw Tip in the Center AND Provides a Catch-Point for the Screw Tip. No need to Drill Pilot Holes.

LAYOUT & INSTALLATION

5 INSERT CABLES INTO RACEWAY C-CHANNELS

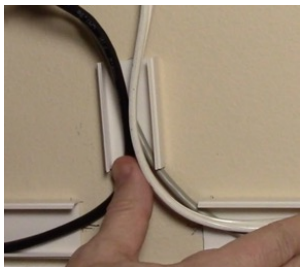

Insert your cables into the Raceway C-Channels



For unruly cables that tend to spill out of the C-Channel making it difficult to put the Covers on, use the included Cable Clips as described on this page.

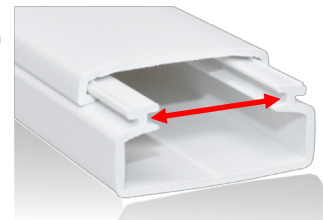
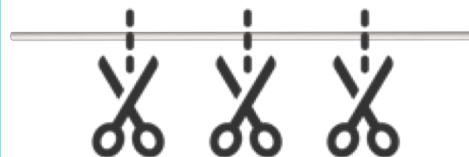

Using Scissors, cut the supplied paper sticks into 22mm (7/8") length Cable Clips. For easy measurement, simply hold the stick up against the edge of a Raceway C-Channel section and place a cut mark just slightly longer than the slot spacing (shown in red).

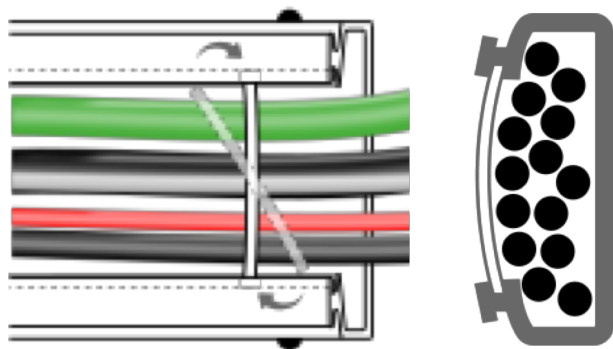

Insert Cable Clip at an angle then turn perpendicular to the Raceway to trap the ends of the Clip inside the C-Channel Slots.



Install Cable Clips along the Raceway path as needed.



The Cable Clips hold the cable bundles so you can install the Covers without the cables spilling out and getting in your way.

LAYOUT & INSTALLATION

6 INSTALL ANTI-SLUMP STRIPS IF NEEDED



On vertical sections, the Raceway Covers can occasionally “slump” due to gravity. This generally only happens on short Raceway Sections installed near a door jamb (with frequent vibration from the door closing). To solve this problem, simply apply 1 Slump Eliminator Tape Strip on each problem Raceway Section as described on this page.



Slump Eliminator Tape Strips, Qty 6, are supplied in the Accessory Bag with your Kit. If you need additional strips, simply cut some thin strips, about 5mm (0.2”) wide, off of the end of the supplied Raceway Double-Sided Tapes.

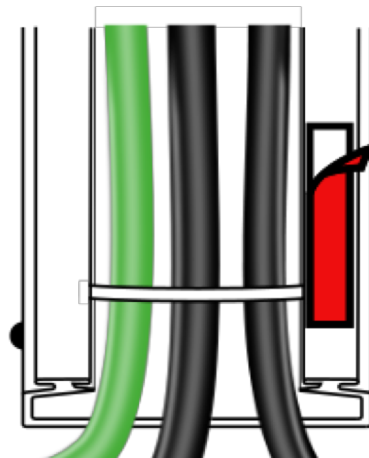

- Press on a Slump Eliminator Tape Strip anywhere along the top flat section on either side of the Raceway C-Channel.
- Remove the Adhesive Backer Film
- When installing the Cover on this section be sure to line it up properly before snapping it in place.
- The Strip will bond the Cover to the C-Channel, holding it securely in place.

LAYOUT & INSTALLATION



7 INSTALL COVERS AND COUPLERS

- i. Hook one edge of the Cover under the mating slot in the C-Channel.
- ii. Snap one corner of the Cover in place.
- iii. Moving toward the other end snap the center in place.
- iv. Moving further toward the other end snap the Cover completely in place.

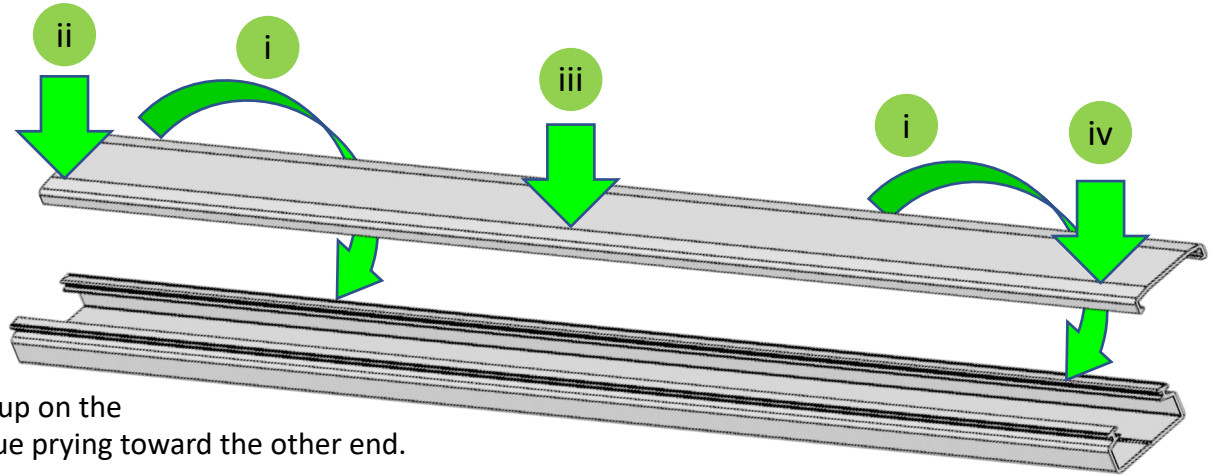

REMOVING COVERS:

The Covers can be removed by squeezing the C-Channel sides together on one end, prying up on the corner of the Cover on that side, then continue prying toward the other end.

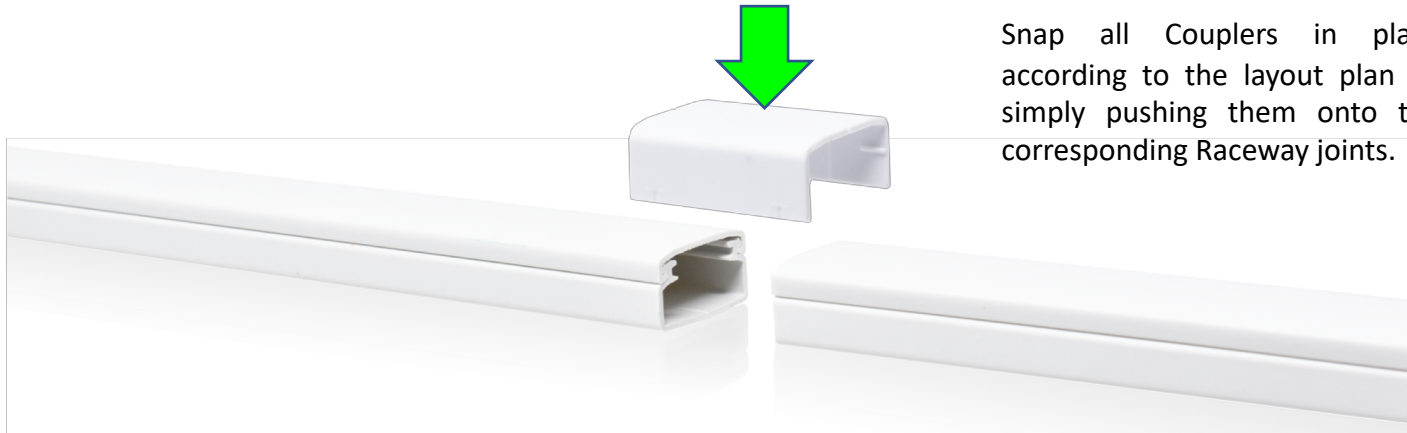

Snap all Couplers in place according to the layout plan by simply pushing them onto the corresponding Raceway joints.



HELPFUL HINTS: SWING JOINTS



A “Swing Joint” is a transition involving two axis changes. To make a Swing Joint use a Flat Elbow + Inside Elbow, OR Flat Elbow + Outside Elbow. You can use multiple Swing Joints for complex transitions. See Swing Joint examples below.

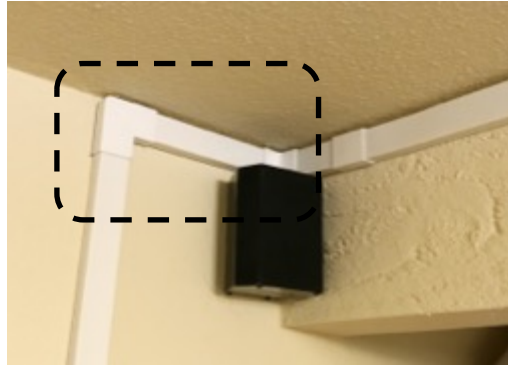

One Swing Joint

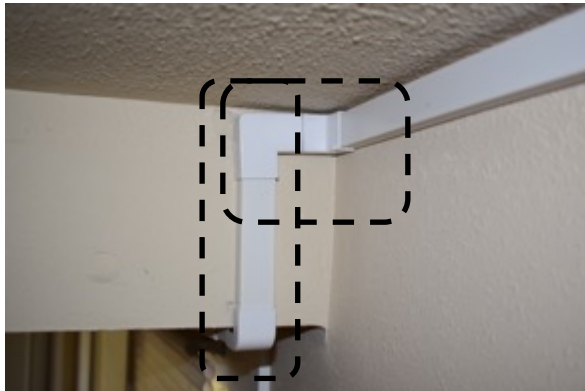

Two Swing Joints

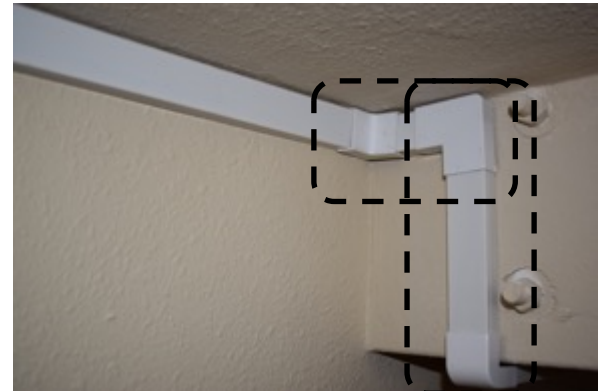

Two Swing Joints



HELPFUL HINTS:

INSTALLING RACEWAY OVER UNEVEN SURFACES

Please keep the following recommendations in mind:

- Double-Sided Tape will not stick reliably to Textured Surfaces. Use Screws or Tape + Screws whenever surface texture is a concern.

When you encounter a “bump” in the path of your Raceway, like this protruding bolt head, cut out a section of the C-Channel to clear the obstruction and install the Cover as shown here.





For Technical Support or Customer Support, Email info@QualityClever.com or
Call (888) 861-1704

Quality Clever, LLC
Bellevue, WA 98006

Quality Clever is a Registered Trademark