

**Swan**

designed for life



## Milk Frother

Model: SK33020 (all colours)

Help line

**0333 220 6050**

v1.0



## IMPORTANT INFORMATION - RETAIN FOR FUTURE USE

**When using any electrical appliance, basic safety precautions should always be followed including the following:**

- Always ensure that the voltage on the rating label corresponds to the mains voltage in your home
- Incorrect operation and improper use can damage the appliance and cause injury to the user.
- This appliance can be used by children aged from 8 years and above if they have been given supervision or instruction concerning use of the appliance in a safe way and if they understand the hazards involved. Cleaning and user maintenance shall not be made by children unless they are older than 8 and supervised. Keep the appliance and its cord out of reach of children aged less than 8 years. Check the power cord and plug regularly for any damage. If the cord or the plug is damaged, it must be replaced by the manufacturer or qualified person in order to avoid an electrical hazard.
- Do not use the appliance if it has been dropped or damaged in any way. In case of damage, take the unit in for examination and/or repair by an authorised service agent.
- Never immerse the unit in water or any other liquid for cleaning purposes.
- Remove the plug from the socket by gripping the plug. Do not pull on the cord to disconnect the appliance from the mains. Always unplug the unit when not in use, before cleaning or when adding or removing parts.
- The use of accessory attachments that are not recommended or supplied by the manufacturer may result in injuries, fire or electric shock.
- Do not let the cord hang over the edge of a table or counter. Ensure that the cord is not in a position where it can be pulled on inadvertently.

2

**Swan**



## IMPORTANT INFORMATION - RETAIN FOR FUTURE USE

- Do not allow the cord to touch hot surfaces and do not place on or near a hot gas or electric burner or in a heated oven.
- Do not use the appliance on a gas or electric cooking top or over or near an open flame.
- Use of an extension cord with this appliance is not recommended. However, if it is necessary to use an extension lead, ensure that the lead is suited to the power consumption of the appliance to avoid overheating of extension cord, appliance or plug point. Do not place the extension cord in a position where it can be pulled on by children or animals or tripped over.
- This appliance is not suitable for outdoor use. Do not use the appliance for anything other than its intended use.
- Do not carry the appliance by the power cord.
- Do not leave the appliance unattended during use. Always unplug the unit when not in use or before cleaning.
- Always operate the appliance on a smooth, even, stable surface. Do not place the unit on a hot surface.
- Ensure that the unit is switched off after use.
- The manufacturer does not accept responsibility for any damage or injury caused by improper or incorrect use, or for repairs carried out by unauthorised personnel.
- In case of technical problems, switch off the product and do not attempt to repair it yourself. Return the appliance to an authorised service facility for examination, adjustment or repair. Always insist on the use of original spare parts. Failure to comply with the above mentions precautions and instructions, could affect the safe operation of this product.
- Your appliance must never be switched on through an external timer or any kind of separate remote control system
- **This is an attended appliance. Do not leave unattended when in use**
- **Do not overfill as this could pose a scalding hazard**



## HOW TO USE

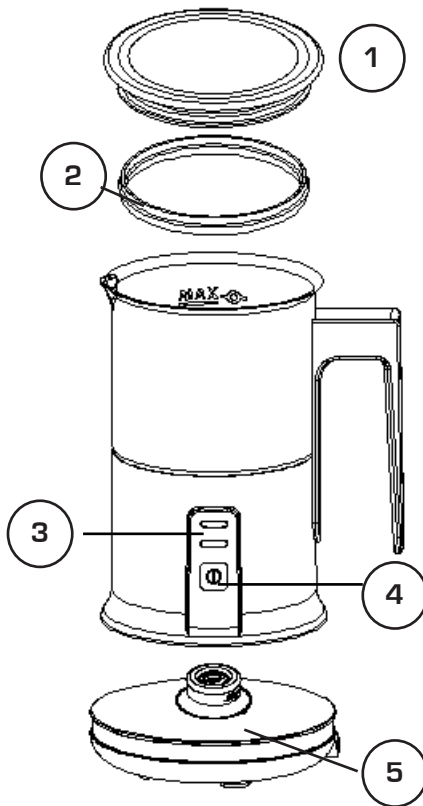

1. Transparent lid
2. Silicon ring
3. Indicator lights
4. On/pause button
5. Power base with cord



Select fill level based on whether you want heated milk or frothed milk. The lower mark is for frothed milk. The upper mark is for heated milk

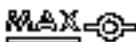

There are 2 types of whisk.

**This one is for heating milk.** Please note the max level for this whisk



**This one is for frothing milk.** Please note the LOWER max level.

If you mix them up the milk could overflow!



## HOW TO USE

- Choose the appropriate whisk and set it inside the jug. (See the function above for reference)
- Pour the milk into the jug below the mark. (See the max capacity above for reference)
- Push the button to start the machine:
- **Frothing & Heating/Heating:** Press the button until the blue light and the red light are on at the same time. The red light keeps flashing for 30s and the blue light goes off after finishing working.
- **Frothing cold milk:** Pour cold milk into the jug and press the button for **1-2 seconds** then the blue light is on. After 60s the machine finishes working, the blue light off and the red light keeps flashing for 30s.
- **Error status:** If the red light keeps flashing it means the machine is overloaded. You must unplug the product and pour out the milk (the milk level must be below the max mark), then start again.

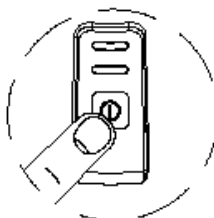

### TIPS:

Here are some handy hints to help you get the best out of your frother.

- Always use your frother first to froth or heat your milk. While it is operating prepare your coffee or hot chocolate and serve immediately.
- Use whole milk (fat content >3.0%) for best results.
- Cold milk can be frothed with this frother. But it doesn't mean you can cool down the milk with it. The frother works in normal temperature in this condition.
- Milk heats to approximately 65C. This is the ideal temperature to ensure the flavour of your coffee is not impaired and so you don't have to wait too long until you can start sipping on your drink.
- Keep the whisks in a safe place. They are small and can easily be lost.
- After frothing or heating allow 2 minutes for the thermostat to reset and the frother to be ready for use again. To shorten this time, rinse with water and wipe dry after each use.
- The frother is designed to heat and froth milk only.



## CLEANING & MAINTENANCE

Separate the lid and the silicon ring from the jug. Never immerse the jug or the base into water. Always unplug from mains before cleaning

1. **THE JUG:** Clean immediately after each use. Flush and clean the walls using warm soapy water and a non-abrasive cloth. Then dry with a soft cloth.
2. **THE LID:** Separate the lid and the silicon ring from the jug. Wash with water directly.
3. **THE BODY:** Clean with a soft cloth. Never use sharp cleaning agents, hard nylon brush or metal brush to avoid scratches on the stain less steel surface! Never clean with metal objects and never use abrasives.
4. **THE WHISKS:** Remove from the jug. Wash with warm water. Dry and store in a safe place. Do not use the dishwasher. Be careful not to lose them!
5. Take out the spiral whisk or paddle, fill with water, use a small brush to clean the gap under shaft sleeve of motor.
6. When cleaning the jug, never immerse the jug fully in water. There are electronic components in the body of the jug that will be damaged.
7. Product can't be cleaned in the dishwasher.



## TECHNICAL DATA

Description: Milk Frother  
Model: SK33020 (all colours)  
Input Voltage: 220-240V  
Frequency: 50/60Hz  
Power consumption: 500 Watts



## SPARE PARTS LIST

SK33020BLKN001: Lid  
SK33020BLKN002: Seal  
SK33020BLKN003: Heating whisk  
SK33020BLKN004: Frothing whisk



## WARRANTY

This product is guaranteed for 2 years from the date of original purchase. If any defect arises due to faulty materials or workmanship the faulty products must be returned to the place of purchase. Refunds or replacement is at the discretion of the store.

The following conditions apply:

- The product must be returned to the retailer with proof of purchase.
- The product must be installed and used in accordance with the instructions contained in this instruction guide.
- It must be used only for domestic purposes.
- It does not cover wear and tear, damage, misuse or consumable parts.
- Swan Products Ltd has limited liability for incidental or consequential loss or damage.
- This guarantee is valid in the UK and Eire Only.



## BS PLUG

The wires in the mains lead are coloured in accordance with the following code:

BLUE	NEUTRAL
BROWN	LIVE
GREEN/YELLOW	EARTH

As the colours of the wire in the mains lead of this appliance may not correspond with the colour markings identifying the terminals on your plug, proceed as follows:

The wire which is coloured BLUE must be connected to the terminal which is marked with the letter N or coloured black. The wire which is coloured BROWN must be connected to the terminal which is marked with the letter L or coloured red. The wire which is coloured GREEN/YELLOW must be connected to the terminal which is marked with the letter E or (earth symbol) and is coloured GREEN or GREEN/YELLOW.

WARNING: THIS APPLIANCE MUST BE EARTHED



## DISPOSAL OF UNIT



Appliances bearing the symbol shown here may not be disposed of in domestic rubbish. You are required to dispose of old electrical and electronic appliances like this separately. Please visit [www.recycle-more.co.uk](http://www.recycle-more.co.uk) or [www.recyclenow.co.uk](http://www.recyclenow.co.uk) for access to information about the recycling of electrical items. Please visit [www.weeeireland.ie](http://www.weeeireland.ie) for access to information about the recycling of electrical items purchased in Ireland. The WEEE directive, introduced in August 2006, states that all electrical items must be recycled, rather than taken to landfill. Please arrange to take this appliance to your local Civic Amenity site for recycling, once it has reached the end of its life.



[www.swan-brand.co.uk](http://www.swan-brand.co.uk)



Scan this QR code  
to hear about  
our story



We love  
what we do



we're proud  
of our quality



Find us on Facebook

\* on selected products

Copyright © Swan Products Ltd.  
PO Box 3117, Stoke-on-Trent ST4 9GD

