

Swan
designed for life



**Bean to Cup
Coffee Maker**
Model: SK32020N

Helpline
01733 404703

v1.1



IMPORTANT INFORMATION - RETAIN FOR FUTURE USE

When using any electrical appliance, basic safety precautions should always be followed including the following:

- Always ensure that the voltage on the rating label corresponds to the mains voltage in your home
- Incorrect operation and improper use can damage the appliance and cause injury to the user.
- This appliance can be used by children aged from 8 years and above if they have been given supervision or instruction concerning use of the appliance in a safe way and if they understand the hazards involved. Cleaning and user maintenance shall not be made by children unless they are older than 8 and supervised. Keep the appliance and its cord out of reach of children aged less than 8 years. Check the power cord and plug regularly for any damage. If the cord or the plug is damaged, it must be replaced by the manufacturer or qualified person in order to avoid an electrical hazard.
- Do not use the appliance if it has been dropped or damaged in any way. In case of damage, take the unit in for examination and/or repair by an authorised service agent.
- Never immerse the unit in water or any other liquid for cleaning purposes.
- Remove the plug from the socket by gripping the plug. Do not pull on the cord to disconnect the appliance from the mains. Always unplug the unit when not in use, before cleaning or when adding or removing parts.
- The use of accessory attachments that are not recommended or supplied by the manufacturer may result in injuries, fire or electric shock.
- Do not let the cord hang over the edge of a table or counter. Ensure that the cord is not in a position where it can be pulled on inadvertently.
- Do not allow the cord to touch hot surfaces and do not place on or near a hot gas or electric burner or in a heated oven.
- Do not use the appliance on a gas or electric cooking top or over or near an open flame.
- Use of an extension cord with this appliance is not recommended. However, if it is necessary to use an extension lead, ensure that the lead is suited to the power consumption of the appliance to avoid overheating of extension cord, appliance or plug point. Do not place the extension cord in a position where it can be pulled on by children or animals or tripped over.
- This appliance is not suitable for outdoor use. Do not use the appliance for anything other than its intended use.
- Do not carry the appliance by the power cord.
- Do not leave the appliance unattended during use. Always unplug the unit when not in use or before cleaning.
- Always operate the appliance on a smooth, even, stable surface. Do not place the unit on a hot surface.
- Ensure that the unit is switched off after use.
- The manufacturer does not accept responsibility for any damage or injury caused by improper or incorrect use, or for repairs carried out by unauthorised personnel.
- In case of technical problems, switch off the product and do not attempt to repair it yourself. Return the appliance to an authorised service facility for examination, adjustment or repair. Always insist on the use of original spare parts. Failure to comply with the above mentions precautions and instructions, could affect the safe operation of this product.
- Your appliance must never be switched on through an external timer or any kind of separate remote control system
- This appliance is intended to be used in household and similar applications such as: staff kitchen areas, in shops, offices and other working environments; farm houses; by clients in hotels, motels and other residential type environments; bed and breakfast type environments.



TECHNICAL DATA

Description: Bean to Cup Coffee Maker

Model: SK32020N

Input Voltage: 220-240V

Frequency: 50Hz

Power consumption: 1000 Watts



Scope of Supply and Appliance Overview

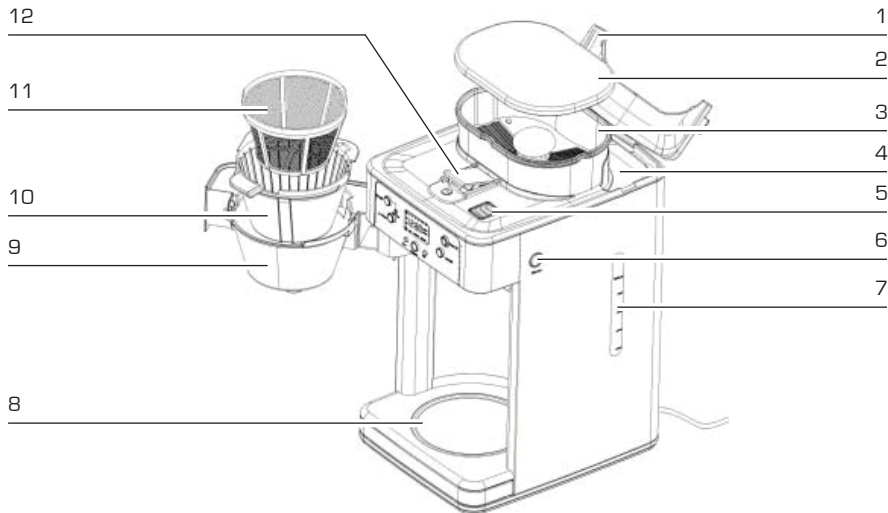

- 1 Water reservoir cover
- 2 Grinding mechanism lid
- 3 Grinding mechanism
- 4 Water reservoir
- 5 Ventilation opening
- 6 Button for unlocking filter compartment
- 7 Water level indication
- 8 Hotplate
- 9 Filter compartment
- 10 Filter compartment insert
- 11 Permanent filter
- 12 Opening for cleaning the coffee mill

Not shown

- Coffee pot
- Water filter with water filterbracket
- Brush for cleaning the coffee mill





HOW TO USE

Control Panel

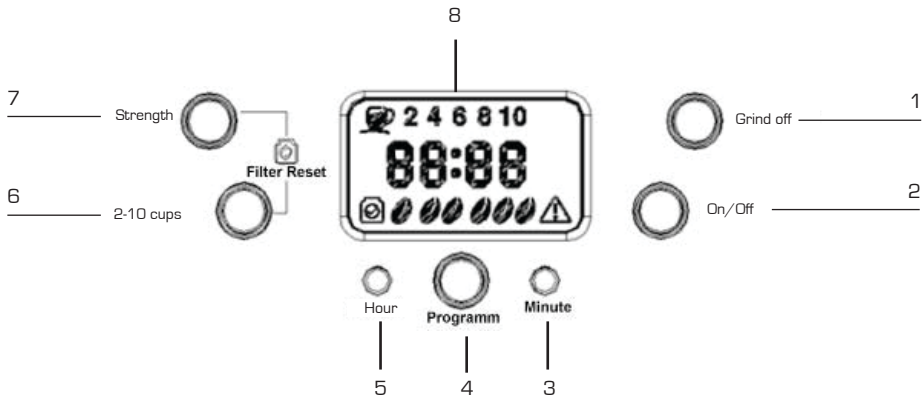

- 1 [Grind Off]: button to switch off the grinding mechanism.
- 2 [On/Off]: button to switch the device on and off.
- 3 [Minute]: button to set the minutes of the clock.
- 4 [Programme]: button for setting the Timer.
- 5 [Hour]: button to set the hours of the clock.
- 6 [2 - 10 Cups]: button to set the number of cups you would like to brew.
- 7 [Strength]: button to set the coffee strength.
- 8 Display [The display light automatically switches off after approx. 1 minute. You can activate it again by pressing any button.]

Display

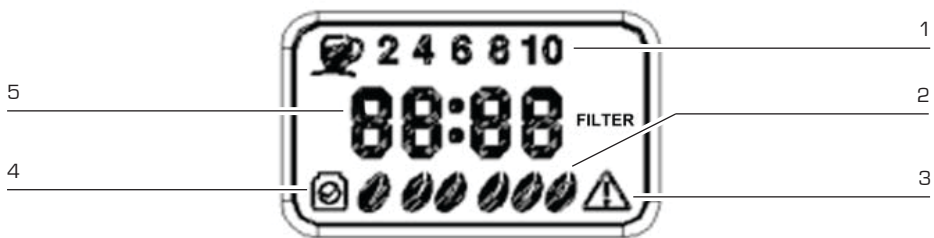

- 1 Shows the number of cups you would like to brew (2 - 10 cups button).
- 2 Shows the preset coffee strength button).
- 3 Error message (see the "Troubleshooting" chapter)
- 4 Shows, together with the word "FILTER", that the water filter needs to be exchanged.
- 5 Clock



HOW TO USE

PREPARATION & FIRST USE

Unpack the unit completely and remove any stickers that can prevent unit operation. Check the unit for damage, do not use it in case of damage.

- Do not immerse the coffee maker into water or other liquids.
- Do not wash the unit in a dishwashing machine.

First Use

1. Place the device on a level, firm and heat-resistant surface.
2. Connect the device to a mains socket that has been properly installed.
3. The preset time "12:00" will appear on the display.
4. Set the time using the Hour and Minute buttons.

Brewing Coffee with Freshly Ground Beans

1. Open the water reservoir cover.
2. Fill the desired amount of water into the water reservoir. On the water level indication, you can see how many cups of water you have already poured into the water reservoir.
3. Always fill the water reservoir with at least two up to a maximum of 10 cups of water. Then close the water reservoir cover.
4. Open the filter compartment by pressing the unlocking button on the side of the device.
5. Place the filter compartment insert and the permanent filter into the filter compartment.
Make sure that all parts are placed in correctly as otherwise the coffee machine will not start the brewing procedure.
6. Close the filter compartment.
7. Fill coffee beans into the grinding mechanism of the coffee machine. Then place the lid of the grinding mechanism back on.
8. Place the coffee pot on the hotplate.
9. Use the 2-10 cup button to set the number of cups you would like to brew.
10. You can press the Strength button to set the coffee strength. You have a choice of three levels. One bean: mild, Two bean: medium, Three bean: strong
11. Press the On/Off button to switch on the device. The On/Off button lights up
12. As soon as you have pressed the On/Off button, the grinding procedure begins. After the grinding procedure, the brewing procedure starts immediately
13. After the brewing procedure, you can take the coffee pot from the hotplate and serve the coffee
14. After the brewing procedure, the hotplate remains on for another 40 minutes and then switches off automatically.
15. If you would like to turn off the coffee machine before the two hours are up, press the On/Off button
16. Clean the device after use (see the "Maintenance" chapter).
17. The coffee machine has a non-drip valve. You can also take the coffee pot from the hotplate during the brewing procedure and pour yourself a cup of coffee. But be careful: You should place the coffee pot back on the hotplate within 20 seconds to prevent the coffee filter from overflowing with water!





HOW TO USE

Brewing with Powder Coffee

1. Open the water reservoir cover.
2. Fill the desired amount of water into the water reservoir. On the water level indication, you can see how many cups of water you have already filled in the water reservoir.
3. Always fill the water reservoir with at least two up to a maximum of 10 cups of water. Then close the water reservoir cover.
4. Open the filter compartment by pressing the unlocking button on the side of the device.
5. Place the filter compartment insert and the permanent filter into the filter compartment.
Make sure that all parts are placed in correctly as otherwise the coffee machine will not start the brewing procedure.
6. Pour the coffee powder into the permanent filter and close the filter compartment.
7. Place the coffee pot on the hotplate.
8. Press the Grind Off button to switch off the grinding mechanism of the coffee machine. The Grind Off button lights up.
9. Press the On/Off button to switch on the device. The On/Off button lights up.
10. As soon as you have pressed the On/Off button, the brewing procedure begins.
11. After the brewing procedure, you can take the coffee pot from the hotplate and serve the coffee.
12. After the brewing procedure, the hotplate remains on for another two hours and then switches off automatically.
13. If you would like to turn off the coffee machine before the two hours are up, press the On/Off button.
14. Clean the device after use (see the "Maintenance" chapter).
15. The coffee machine has a non-drip valve. You can also take the coffee pot from the hotplate during the brewing procedure and pour yourself a cup of coffee. But be careful: You should place the coffee pot back on the hotplate within 20 seconds to prevent the coffee filter from overflowing with water!

Timer Function

The coffee machine has an automatic coffee brewing function. You can select a starting time at which the coffee machine automatically starts the brewing procedure. To do so, take the following steps.

1. Fill the coffee machine as described in the "Brewing Coffee with Freshly Ground Beans" and "Brewing with Powder Coffee" sections according to whether you would like to brew coffee with freshly ground beans or with powder coffee.
2. You should now set the starting time at which the coffee machine automatically starts the brewing procedure by pressing the Programme button for 3 seconds until the programme button flashes. Now set the automatic starting time using the Hour and Minute buttons.
3. Press the Programm button again to confirm your entry. The Programm button will now light up without flashing.
4. The current time then appears on the display again.
5. The brewing or grinding procedure now starts at the set time



HOW TO USE

6. Tip: You can also start the grinding or brewing procedure at any time before the set starting time. To do this, press the Programme button once to switch off the timer and then press the On/Off button to start the grinding or brewing procedure manually.
7. After the brewing procedure, you can take the coffee pot from the hotplate and serve the coffee.
8. After the brewing procedure, the hotplate remains on for another two hours and then switches off automatically.
9. If you would like to turn off the coffee machine before the two hours are up, press the On/Off button
10. Clean the device after use (see the "Maintenance" chapter).



MAINTENANCE



Always remove the mains plug from the mains socket before you clean the device or change the water filter.

- **The hotplate is very hot after use! Let it cool down first before cleaning it.**
- **Never immerse the device, the cable or the plug in water.**
- **Do not use corrosive or abrasive cleaning agents to clean the device. These could damage the surface.**

Cleaning the Device

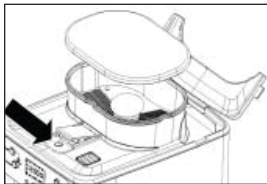
1. Clean the coffee mill using the cleaning brush.



2. Adjust the screw at the opening for cleaning the coffee mill with the shaft end of the cleaning brush to the "Open" symbol . The cover will open up and you can then remove any excess coffee powder with the cleaning brush.
3. Then close the cover again by pressing down on the cover and adjusting the screw on the opening for cleaning the coffee mill with the shaft end of the cleaning brush to the "Closed" symbol .
4. Then press the unlocking button on the side of the device and open the filter compartment.
5. Take out the permanent filter and dispose of the coffee powder.
6. Clean the permanent filter and the filter compartment insert with hot water and a little detergent if necessary.
7. Then dry all parts thoroughly and place them in the coffee machine again.
8. If necessary, clean the coffee machine and hotplate with a damp cloth and then with a dry one.



MAINTENANCE

Changing the Water Filter

If you live in a hard water area, you can greatly increase the life of the filter, the coffee machine and the taste of your coffee by using **BOTTLED WATER** in this appliance! Check your kettle. If it has limescale deposits then we strongly recommend using bottled or filtered water in this product.

To produce a more aromatic coffee flavour, the device has a water filter which is inserted in the water reservoir. If the  symbol and the word "FILTER" are shown on the display, the water filter should be replaced. You can order new water filters in our online shop (see the "Ordering Replacement Parts" chapter).

1. Open the water reservoir cover and pull out the water filter by its bracket.

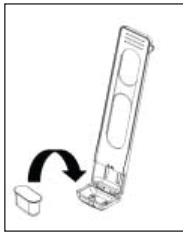

2. Open the lower part of the water filter bracket, take out the water filter and dispose of it.
3. Insert a new waterfilter and then close the waterfilter bracket again.
4. Place the waterfilter bracket back into the water reservoir. Make sure that the waterfilter is seated correctly in the slot in the water reservoir.
5. To delete the  symbol on the display, press the Kaffeestärke button and the 2-10 Tassen button simultaneously.



The absence of a waterfilter does not stop the device from working properly.

Descaling the Device

If the water only runs very slowly through the device or the device is louder than usual during the brewing procedure, you should descale it.

1. Pour the mixture of water and descaling agent into the water reservoir and switch on the device. Pay attention to the directions for use of the descaling agent in regard to the ratio of water to descaling agent.
2. Let the mixture run through the machine completely. Repeat this procedure if the water still runs through slowly.
3. After descaling, let water (without coffee) run through the device at least three times to flush the lines etc.
4. Please ensure that you have switched on the Grind Off function if you want to flush the device with water or descale it.



TROUBLESHOOTING

Troubleshooting

If the device should stop working properly, first check whether you are able to correct the problem yourself. Otherwise, contact our customer service department.

Do not try to repair a faulty device yourself!

Problem	Possible cause/solution
The device does not work.	<ul style="list-style-type: none"> • Is the plug inserted in the mains socket correctly? • Is the mains socket defective? Try another mains socket. • Check the fuse of the main connection. • Is the coffee filter correctly inserted? • Is the lid of the filter placed on correctly? • Is the coffee pot sitting correctly on the hotplate?
 appears on the display.	<ul style="list-style-type: none"> • Pull the plug out of the socket to reset all of the settings you have made. Check whether the filter compartment insert and the permanent filter are positioned correctly, whether the cover for cleaning the coffee mill is closed correctly and then try to start the brewing procedure again.

PARTS ORDERING & SERVICE

Our service help line is on the cover of this instruction manual. You may also be able to buy spare parts (eg filters) from our website at www.swan-brand.co.uk

Parts references:

SK32020N-01 Water filter

SK32020N-02 Permanent filter (11)

SK32020N-03 Replacement jug





DOCUMENTATION

We Swan Products Ltd declare that this product conforms to the following product legislation in accordance with the following directive(s):

2004/108/EC The EMC Directive (the Electromagnetic Compatibility Directive).

2006/95/EC. The LVD Directive (Low Voltage Directive).

2011-65-EU. The RoHS directive (Restriction of Hazardous Substances Directive)

EC 1935/2004 Food Contact



WARRANTY

This product is guaranteed for 2 years from the date of original purchase. If any defect arises due to faulty materials of workmanship the faulty products must be returned to the place of purchase. Refunds or replacement is at the discretion of the store.

The following conditions apply:

- The product must be returned to the retailer with proof of purchase.
- The product must be installed and used in accordance with the instructions contained in this instruction guide.
- It must be used only for domestic purposes.
- It does not cover wear and tear, damage, misuse or consumable parts.
- Swan Products Ltd has limited liability for incidental or consequential loss or damage.
- This guarantee is valid in the UK and Eire Only.



BS PLUG

The wires in the mains lead are coloured in accordance with the following code:

BLUE	NEUTRAL
BROWN	LIVE
GREEN/YELLOW	EARTH

As the colours of the wire in the mains lead of this appliance may not correspond with the colour markings identifying the terminals on your plug, proceed as follows:

The wire which is coloured BLUE must be connected to the terminal which is marked with the letter N or coloured black. The wire which is coloured BROWN must be connected to the terminal which is marked with the letter L or coloured red. The wire which is coloured GREEN/YELLOW must be connected to the terminal which is marked with the letter E or (earth symbol) and is coloured GREEN or GREEN/YELLOW.

WARNING: THIS APPLIANCE MUST BE EARTHED



DISPOSAL OF UNIT



Appliances bearing the symbol shown here may not be disposed of in domestic rubbish. You are required to dispose of old electrical and electronic appliances like this separately. Please visit www.recycle-more.co.uk or www.recyclenow.co.uk for access to information about the recycling of electrical items. Please visit www.weeeireland.ie for access to information about the recycling of electrical items purchased in Ireland. The WEEE directive, introduced in August 2006, states that all electrical items must be recycled, rather than taken to landfill. Please arrange to take this appliance to your local Civic Amenity site for recycling, once it has reached the end of its life.



SWAN BRAND HERITAGE



Did you know...

In 1933 Swan were the first to develop an electric heating element that could be immersed in water. This led to the Swan kettle range that could boil up to six pints of water in just over nine minutes - pretty hot for the time! These days it takes about two minutes for a Swan kettle to boil.





www.swan-brand.co.uk



Scan this QR code
to hear about
our story



We love
what we do



we're proud
of our quality



Find us on Facebook

* on selected products

Copyright © Swan Products Ltd.
PO Box 3117, Stoke-on-Trent ST4 9GD

