

SLI SYSTEM INSTALLATION INSTRUCTIONS - REPEAT THIS PROCESS FOR BOTH SIDES

TOOLS 2.5MM / 4MM / SCREWDRIVER / TORQUE WRENCH / BLUE TREADLOCK / FRICTION PASTE

- 1** Apply a heavy amount of blue threadlock and thread handlebar extensions into each end of handlebar. Use a round shank screwdriver through the cross-drilled hole to tighten.

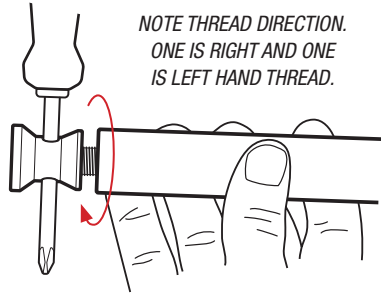

- 2** Insert clamp bolts in both clamps several turns but do not tighten.

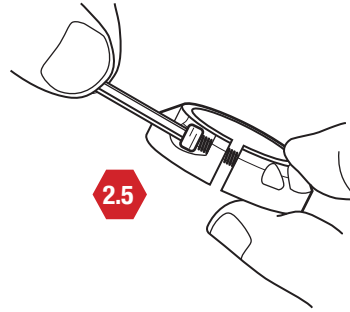

- 3** Select your grip setting/tune from the chart below and place the desired washer over the tabs on the grip sleeve.

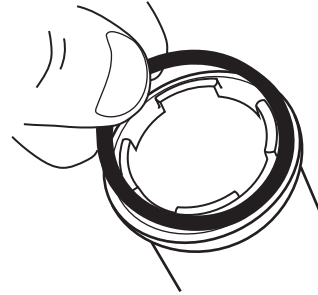

- 4** Install suspension insert over tabs on grip sleeve making sure that the connecting ring goes **INSIDE** the sleeve.

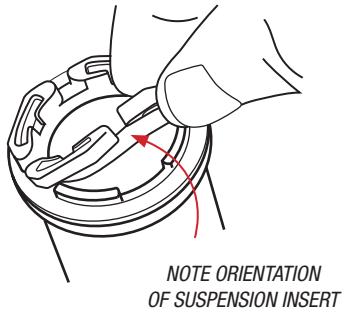

- 5** Install lock-on clamps and SLI end caps by aligning the grip sleeve (with suspension insert) with the pockets in the clamp and SLI end cap and press together.

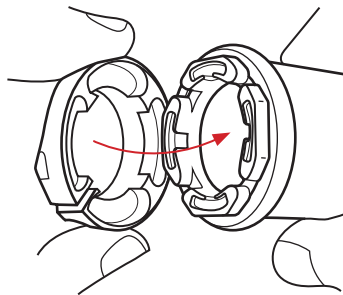

- 6** Carefully slide grips over the handlebar by holding the outer SLI cap, making sure the insert ring fits around the handlebar. Do not tighten the clamp bolts.

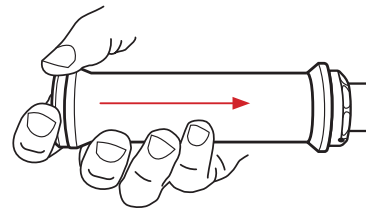

- 7** Position inner clamp bolt at the bottom of the grip for both left and right grips.

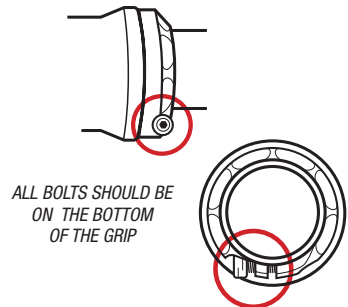

- 8** Tighten the bar end screw to 12nm (8.8 ft lb) while holding the outer SLI cap so it does not rotate.

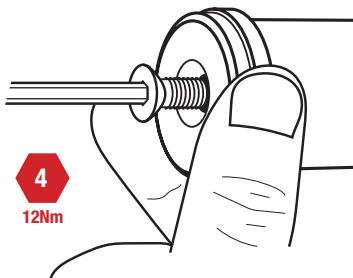

- 9** Pull the **INNER** clamp outward toward the SLI cap, ensuring there are no gaps between the grip sleeve and clamp. Torque clamp bolt to 15in/lbs. (1.7nm).

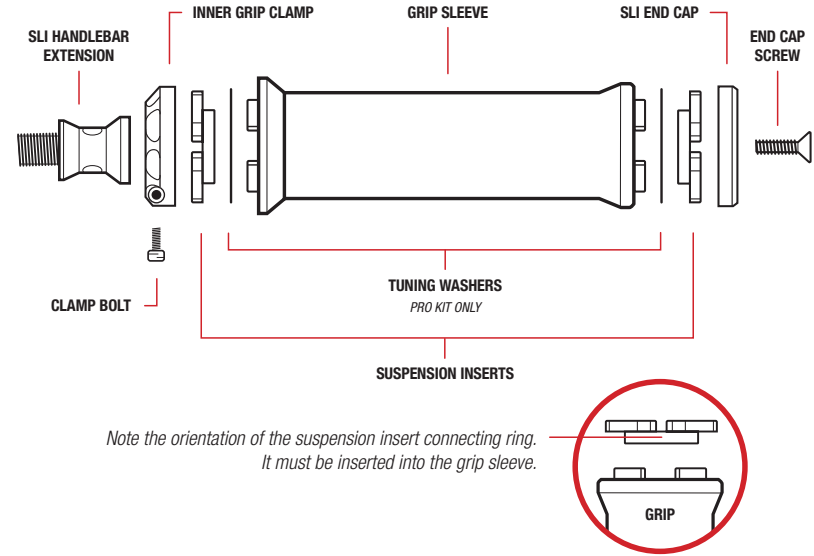
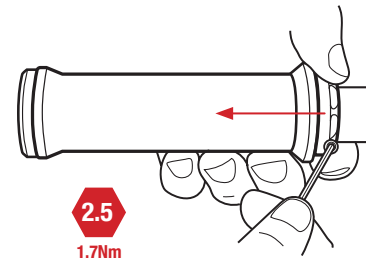

IMPORTANT INSTALLATION TIPS

- Using a 2.5mm and 4mm hex wrench, check all grip screws before each ride as part of your standard maintenance routine.
- Grips will not perform properly with side to side play between the grip sleeve and clamp. Clamp should always be right against the grip.
- In some instances, a small amount of friction paste is needed between the clamp and bar to ensure the clamp stays in position while riding.
- Industry standard handlebars are .875 Diameter. Our lock-on clamps have a working range from .865-.880. If your bars are too small the clamp will tighten against itself, and not your handlebar. There should always be a gap between the two halves of the clamp when fully tightened as illustrated below.

WHEN CLAMP IS PROPERLY TORQUED:

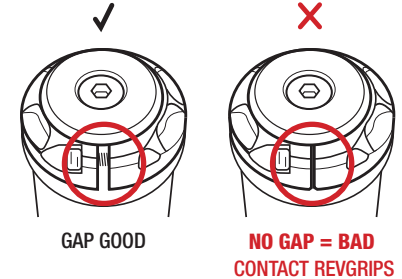

TUNING YOUR REVGRIPS (PRO SERIES ONLY)

FIRM	MEDIUM-FIRM	MEDIUM	MEDIUM-SOFT	SOFT
Zero tuning washers.	One thin (white) washer on one side.	(RECOMMENDED START) One thin (white) washer on each side.	One thick (black) washer on one side and one thin (white) washer on the other side.	One thick (black) washer on each side.

ALL RACE SERIES AND PRO SERIES PARTS ARE INTERCHANGEABLE.