

SUPPLEMENTAL GRIPSHIFT INSTALLATION INSTRUCTIONS

TOOLS 2.5MM / 3MM / TORQUE WRENCH / FRICTION PASTE

1 Begin by following the standard RevGrips instructions that are included with this kit to prepare your grip clamps, suspension inserts, and tuning washers for your grips. Use this instruction sheet only for your GripShift RevGrips installation.

Note that our GripShift grips do not require tuning washers.

2 All clamp slots are positioned towards the bottom of the grip on both the standard and GripShift RevGrips.

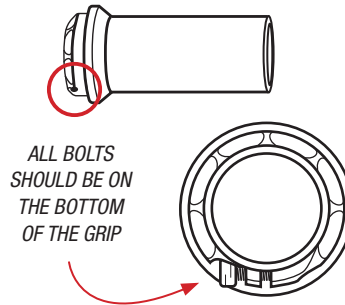

3 After installing your GripShift shifter, carefully slide your GripShift grip over your handlebar by holding the outer clamp, making sure the insert ring fits around the handlebar. Do not tighten the clamp bolt.

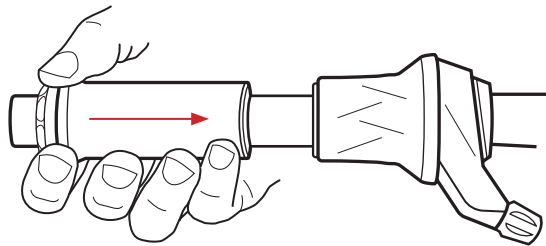

4 Insert bar end into handlebar and tighten (3mm hex) while firmly pressing inward.

BAR END MUST BE TIGHT!

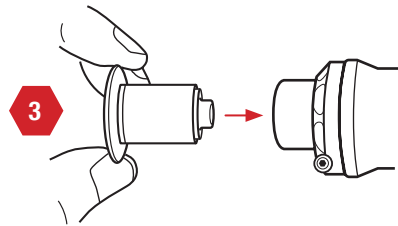

5 Position the clamp bolts downward (under the grip) and pull the RevGrip and clamp OUTWARD toward the bar end. Torque the OUTER clamp bolt to 15in lbs. (1.7nm).

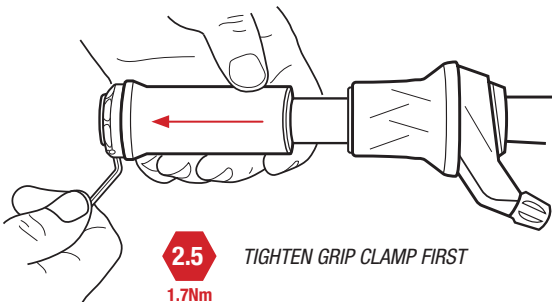

TIGHTEN GRIP CLAMP FIRST

6 Pull the GripShift shifter outward toward the bar end, ensuring there are no gaps between the grip sleeve and the shifter. Torque the shifter bolt to manufacturer spec.

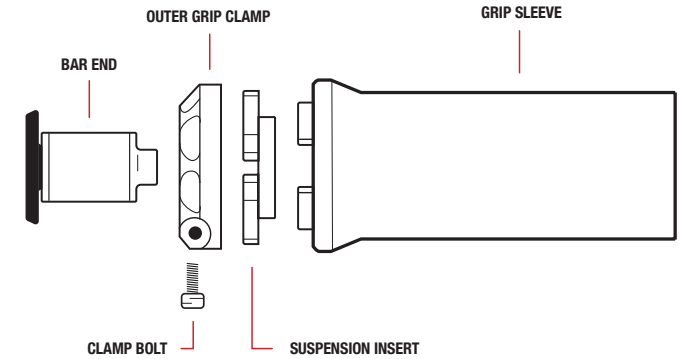
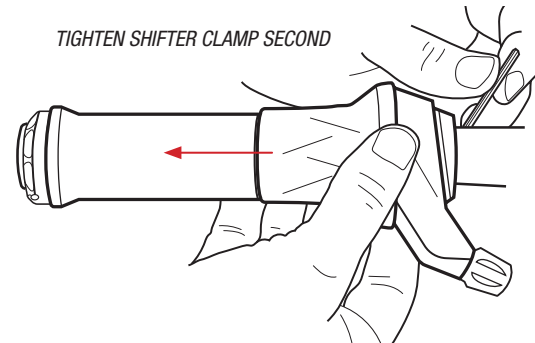

Note the orientation of the suspension insert connecting ring. It must be inserted into the grip sleeve.

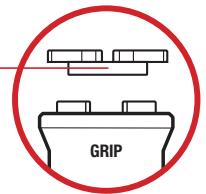

IMPORTANT INSTALLATION TIPS

- Using a 2.5mm and 3mm hex wrench, check all grip screws before each ride as part of your standard maintenance routine.
- Grips will not perform properly with side to side play between the grip sleeve and clamp. Clamp should always be right against the grip.
- In some instances, a small amount of friction paste is needed between the clamp and bar to ensure the clamp stays in position while riding.
- Industry standard handlebars are .875 Diameter. Our lock-on clamps have a working range from .865-.880. If your bars are too small the clamp will tighten against itself, and not your handlebar. There should always be a gap between the two halves of the clamp when fully tightened as illustrated below.

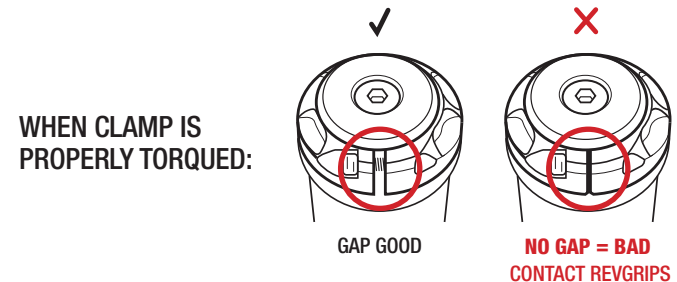

WHEN CLAMP IS PROPERLY TORQUED:

ALL RACE SERIES AND PRO SERIES PARTS ARE INTERCHANGEABLE.