

RANS

OWNERS MANUAL for Crank Forward & Recumbent Bikes



YOUR RESPONSIBILITIES

A lot of these items are common sense, and it may seem silly to include them in this booklet. In spite of this, when accidents occur, usually one or more of these items were ignored. A little review of the basics can't hurt.

You must have the skill to operate the bicycle safely before riding in traffic. Every bike has different handling characteristics. Take the time to learn the behavior of your bike. If you are riding a tandem or short-wheelbase bike, remember there is wheel- overlap which means that your front wheel can strike your foot if you turn sharply. Practice in unobstructed open areas before riding on public roads.

Always wear a bike helmet and use a rear-view mirror.

Check the operation of brakes and steering before each ride, along with tire pressures. Make sure all the clamps on the handlebar and risers are snug. Inspect tires for cuts, bulges or excessive wear.

Maintain your bike. Don't unnecessarily expose it to the elements. Watch for corrosion. Promptly touch up any areas of paint damage.

Do not overload the bicycle. RANS bikes are designed for loads up to 250 or 275 lbs. (Check our web site for weight limit specific to model.) Cargo may affect the handling of your bike. Be especially careful of any cargo or apparel that could interfere with the braking or steering mechanisms or contact the wheels of the bike when in motion.

Aftermarket items such as fairings, tailboxes, body socks, pedals incorporating clip-in devices, assisted drive systems, and other items not specifically engineered for your bike may adversely affect handling and safety, and are the sole responsibility of the rider as to their suitability for use on a RANS bike.

Ride under control. This goes double for tandems. Avoid excessive speed going down hills. Ride slowly on damp surfaces. Remember, you will need extra stopping distance when wheel rims and tires are wet. Be aware of drain grates, gravel or sand, uneven pavement, wet leaves and debris. If your bike suddenly begins to handle differently, stop immediately and inspect for problems.

Be sure your reflectors are correctly installed and not damaged or missing. Do not allow your reflectors to be obscured by gear or cargo. Keep your reflectors clean. Reflectors are not sufficient for night visibility. Use powered front and rear lighting for maximum safety.

CRANK FORWARD BICYCLES



GENERAL

PROFESSIONAL ASSEMBLY OF YOUR RANS BIKE IS REQUIRED BEFORE RIDING!

Check security of the wheels, handlebars, brake levers, shifters, grips, and seat prior to riding. Adjustment of the gearing and brakes may be required. Seek the help of your dealer, local bike shop, or qualified bike mechanic for best results.

Check tire pressure and inflate as required. Pressure limits are printed on the sidewalls of the tires. Always ride on tires inflated within the range of the recommended values.

Rider weight limit is specified on your bike, this decal is usually on the seat tube. Use of the bike with loads greater than specified voids the warranty. Ramping and jumping the bike also voids the warranty.



FITTING THE BIKE TO THE RIDER

Three main adjustments come into play in order to fine tune the bike to a specific rider. The one size fits all design is accomplished by the laid back angle of the seat tube. As the seat raises or lowers the distance to the handlebar and pedals change. Most riders will fit with simple adjusting of seat height and tilt. Handlebar height, or rotation adjustments can be made to suit individual taste and some may require a deeper bar for greater reach back. Other bar choices are available, consult our web site at www.ransbikes.com for detailed information on handlebar options.

Begin by setting the seat with the front tilted down slightly. This adjustment is made using the QR on the underside of the seat. Step over the bike, hold the bars and check for proper leg extension. Proper seat height occurs when the leg is straight when the heel of your foot (with the intended riding shoes) is on the pedal. Place the toe on the pedal and there should be slight bend at the knee.

Seat tilt will affect seat height. The more nose down tilt rotates the body slightly down and forward requiring a slight raise to seat height. Less tilt raises and pushes back the body; meaning seat height may need to be reduced.

These settings are not critical, riding a bit and experimenting with tilt and height is recommended. The increase in comfort will be noticed once you have achieved the right setting. Note: seat tilt is usually at the right angle when it feels like you are almost sliding out of the seat. A foot on the pedal will secure you in the seat. This effect will be a little less on the Cruz and Fusion due the more laid back seat angle. Too little tilt may result in the front edge of the seat applying pressure against the thighs and chafing, and less circulation can result. Tilt the seat until no pressure is felt.

We also provided numbers etched on the seat post that correspond with your pant inseam. This usually places the seat very close to the correct height. Use this gauge as a starting point ride to fine tune. Also knowing your “seat setting number” allows you to check for slippage and if removing the seat, restore it to your setting. The inseam scale will vary depending on size. Refer to the diagram for adjustment in scale readings.



Adjusting seat tilt is as easy as flipping the Quick Release to position and lock.

Use the “inseam” scale to position seat at correct height. Your pant inseam corresponds to this number etched on seat post.



Adjust seat height so leg is straight when heel of the foot is on crank at most extended point.

Note, be sure hips are level.

Handlebar height should be set to just above the knees. This general setting can be modified after test rides. Rotating the handlebar will also change wrist and palm comfort and the feel and reach. The best bar position occurs when:

1. Elbows are slightly bent.
2. Wrist are not held at an odd angle producing pressure.
3. The bars are just above the knees or higher.
4. Check the security of clamps after adjusting handlebar.

Adjusting seat tilt is as easy as flipping the Quick Release to position and lock. Use the "inseam" scale to position seat at correct height. Your pant inseam corresponds to this number etched on seat post.

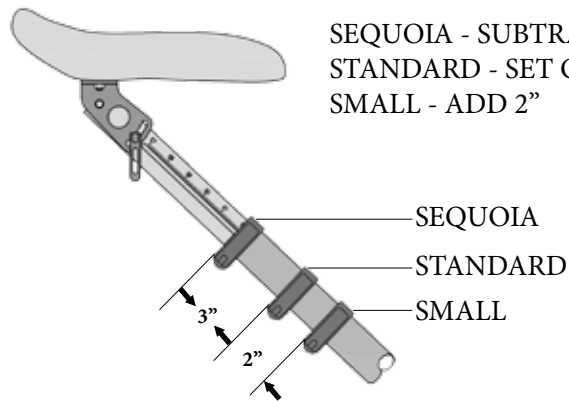

◀ HOW TO READ INSEAM GAUGE



Do not attempt riding with loose handlebars! Injury may result.

AFTER RIDING AWHILE...

Some fine-tuning tips to enhance performance and enjoyment...

Too much Palm Pressure: This is caused by several factors, rough roads, overreaching to the bars, or bars too low. To correct for the rough road, try taking bumps at lower speeds or wearing padded gloves. Correct overreaching first. Check seat location, too high will cause you to lean down to the bars more. As the bars are raised they come aft a slight amount helping with the reach. Deeper bars or bars that extend further aft are available from your dealer and our online store.

Back Muscle Fatigue: This is a sign of overreaching or pulling too much on the bars (before being in shape). Try rotating the bars to locate them more aft, or try a deeper set of bars. A little more tilt will shorten the distance to the bars. If everything is adjusted correctly keep riding. As your muscles strengthen the fatigue will go away.

Numb Seat: Time in the saddle is what will cause the circulation to restrict, and numbness to set in. Standing up on the pedals for a few seconds will help. If this becomes a chronic problem, try putting a layer of open cell foam stuffed between the stock cushion and seat. Adjustment of seat height and tilt may be required. You can buy open cell foam for cushions at most craft stores.

Stand Up Riding: The Fusion and Cruz are not intended for riding while standing on the pedals. Coasting yes. but since the bars will be too close to your knees when off the saddle, this will conflict with pedaling. The Dynamik, Zenetik, and Alterra's however can be ridden while off the seat. Some may require handlebar adjustment or changing the bar, depending on your build. While stand pedaling is possible on these two bikes, it is still different from a standard D/F and will require some adapting. Learning to ride this way is a great asset on the more aggressive trails, where the Dynamik and Alterra seems to be eager to go.

The CF-1 & CF-2 Seat: The CF-1 and CF-2 seats are wonderful for comfort, and have the added advantage of springboard affect, especially when more to the front of the seat. This is a great idea if the road is extra bumpy, just slide an inch or two forward and you will notice the shock absorbing nature.

Handling Characteristics: Long wheelbase has advantages on loose surfaces- it is easy to maintain control. You will find it easy to maintain control on loose sand and other surfaces not so ideal for skinny high-pressure tires. You will also find going a little slower on such roads is a good idea, especially if you are riding skinny high pressure tires. The fatter tires will be at home on such roads, and it opens up a great experience to be able to cruise the back-roads on a bike that is comfortable.

The laid back seat angle places less weight on the front wheel, there can be some tendency for front wheel sliding when tight cornering too fast on a loose surface. Shifting body weight and controlling speed will enhance your ability to corner. Again tire size, tread type, and pressure will affect this greatly. Otherwise the bikes handle very naturally, there is no learning curve, simply get on and ride (provided you are currently able to ride a bike!) However learning and understanding the special nature of this design will enhance your utilization and enjoyment. The more you ride the more you will enjoy.

Special Consideration for Trail Riding the Dynamik: The lighter front loading will come into play during aggressive trail rides, but with a little practice it will become second nature to compensate, and in some cases an advantage, such as popping the front wheel over small obstacles. Crank clearance can be less than typical MTB's so watch out for crank strikes! Bunny hops are no problem once you learn to push down a bit, or stiffen your arms, since the nose of the bike will pop up easily. As you ride you will notice the same body English works here as on typical bikes, but slightly different portions. It only takes a few rides though to start nailing the trail. You will get used to the low seat height, the few inches difference really feels big! The bike seems to hug the ground compared to a MTB. Definitely nice when ducking under tree limbs! The low top tube height is nice also; it helps avoid painful groin jams when an errant dismount occurs. Plus the low top tube height is great when you have encountered a hill that wins, you can simply stay on the bike and walk it up.

Using Shock Forks: Most MTB shock forks will adapt. The rake needs to be at least 38mm. Stroke can be your personal preference but 56 to 76mm is plenty. Much over 76mm will, however start lifting the head angle and change the bike's handling.

Front Tire Clearance: If trying out larger tires than spec, foot to tire clearance may become close or contact possible. Check this prior to riding.

Caution: Changing tire sizes can affect toe clearance with the front wheel.



CARE...

General: The conventional aspects of the Crank Forward line can be maintained, as any bike should. The bike differs in the seat, seat post, and seat attach brackets. About the only care needed for these special parts is to spray a dry wax lube onto the seat post shaft and inside the seat tube on the frame. This will prevent corrosion from binding the seat post. Keep the seat components clean to avoid extra wear at adjust points, and wash the seat cover/cushion in the kitchen sink using dish soap. The seat cover may even survive most gentle cycles in the clothes washer, but no guarantees if you try this.

Since you will tend to pull harder on the bars on this bike than perhaps the norm, inspect the stem and bar clamps for security.

Headset Adjustment: The headset is adjusted to be play free by using the headset adjustor. It is a bit of a trick to get all the play out, but simple: ▼



PARTS LAYOUT TOP TO BOTTOM

1. Riser clamp
2. Headset adjuster nut
3. Headset adjuster barrel
4. Headset adjuster clamp

Note: Riser clamp and Headset adjuster clamp are identical in function, but are given different names for the purpose of clarity in these instructions.

1



Turn the headset adjuster nut onto the end of the headset adjuster barrel that is NOT slotted. Continue until the end of the nut is even with the end of the barrel.

2



Slide clamp over threaded section with clamp slot aligned with the slot in the threaded section.

3



Slide the assembled headset adjuster onto the fork steer tube.

4



Push the riser into the end of the riser clamp that does NOT have a lip.

5



Slide the assembled riser onto the fork steer tube.

6



Tighten the riser clamp.

7



Turn the nut up into the riser clamp. This will push the adjuster clamp into headset, applying tension to the headset bearings. Continue to turn the nut until the headset has no lateral play. Not so tight as to effect the proper operation of the headset.

8



When the proper adjustment is achieved, tighten the adjuster clamp.

RANS CRANK FORWARD BIKE



ACCESSORIES FOR YOUR BIKE

RANS offers a variety of custom made accessories for your RANS bike.



For more details on our line of accessories visit:

WWW.SHOPRANS.COM

RECUMBENT BICYCLES





Thanks for choosing a RANS bike. We are delighted, that you share our enthusiasm for the sport of cycling and we want you to enjoy your RANS bike to the fullest. This owner's manual contains some information you will find useful.

Component information from the respective manufacturers of various components used on your RANS can be found online.



RANS CUSTOM COMPONENTS

1. Riser
2. Seat Mesh
3. Sprint Brace
4. Hoagie Seat
5. Seat Cushion/Cover (Std.)
6. Idler
7. Flip-It
8. T-Bar
9. Oval or V-Clamp
10. Seat Pan
11. Cable Cover
12. Frame

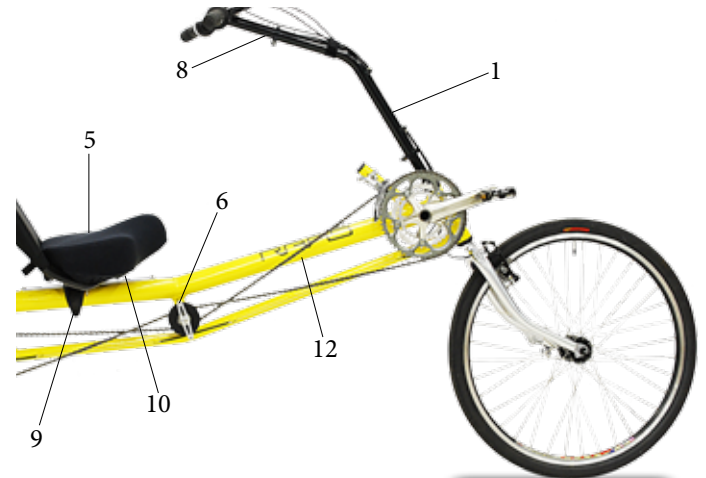

ASSEMBLY AND REGISTRATION



Serial Number Rear Dropout



Serial Number Bottom Bracket

BIKE ASSEMBLY

RANS Dealers have agreed that they will assemble and test each bike before delivery. If you have received your bike in a less than fully assembled condition, it is the dealer's responsibility to provide any necessary re-assembly instructions. If for any reason you are uncomfortable with the setup of your bike upon delivery, don't ride it. Contact RANS at (785) 625-6346.

YOUR SERIAL NUMBER & WARRANTY REGISTRATION

You will find your serial number of your RANS bike is embossed in one of 3 locations. (See Photos.) Please include your serial number with your online warranty registration. Ask your dealer for the serial number if you have trouble reading or locating it.

Register online @ www.rans.com.

It is vital that you register your warranty with RANS so that you may be informed of product safety actions or other issues that may arise regarding the maintenance and operation of your bike.

PRIVACY POLICY

It is RANS policy to restrict use of warranty registration data solely to the RANS service department, unless the bike owner has specifically requested to be included to receive marketing materials for RANS products. In no instance will any owner or warranty data be offered to any outside entity, except in event of a product recall or safety advisory.

MAKING IT FIT

RANS bikes are designed to fit all sizes of riders, and to accommodate them with a range of comfort options. Finding your best riding position is easier when you begin with a good fundamental riding posture. Here 's how to begin:

FINDING THE CORRECT SEAT POSITION

To find the right seat position, mount the bike. Hold a brake lever as you mount. On long-wheelbase models, just step over the frame and seat yourself. On short-wheelbase models (and the Screamer captain 's position), take hold of the seat back with one hand, hold the handlebar grip with the other, fold the riser forward, step over the frame and seat yourself.

REMEMBER: IF YOU LET UP ON THE BRAKE, THE BIKE MAY ROLL

Lift your foot and rotate the pedal counter-clockwise to the extended position. Sitting with your back against the seat and your leg fully extended, your heel should rest squarely on the pedal. If your knee is bent, move the seat as required to bring your heel to the pedal with your leg held straight.



PROPER SEAT ADJUSTMENT POSITION



V-Clamp



Position 1

Position 2



Oval Clamp

The oval or v-clamp seat clamp system will release enough to slide with deployment of the QR handle. For seat back tilt adjustments, pull the pins from the sprint brace tubes. When the seat is positioned as desired, clamp with the QR handle. If the sprint brace tube pins have been removed, replace them before mounting the bike. Both oval and v-clamps can be adjusted for more clamping pressure by tightening the QR. The top adjustment of the clamp should be set to allow the seat to slip over the shoulder bolts but not move side to side. Use (2) 6mm allen wrenches to adjust.

Now, with the brakes still applied and sitting back in the seat, place the ball of your foot on the pedal, extend your leg fully and apply pressure. In this position, which represents the bottom power of your stroke, your knee should be slightly bent.

At first you may prefer your seat upright. After gaining riding experience, you may want to try a more reclined position. Minor adjustments are made by pulling the pins from the sprint brace tubes and tilting the seat to the position you want.

ADJUSTING YOUR RISER

There are different designs of handlebars and risers used on RANS bikes.

RANS long-wheelbase bikes usually feature the T-bar riser. Height and bar position are adjustable throughout a three-inch range at both ends of the riser. Using a hex wrench, loosen the clamps, adjust and retighten. You should be able to sit back comfortably in the seat, resting hands on the handlebar grips with elbows gently bent. The handlebar should be roughly chest high. The handlebar should not crowd your face, chest or knees.

Check www.rans.com for more on custom sized bars and risers.

RANS short-wheelbase bikes and tandems feature the Flip-It riser. The Flip-It folds forward, away from the seat, letting you mount the bike easily. There should be sufficient tension on the quick-release to keep the riser firmly in place when you pull it back to the riding position. Use care not to excessively leverage the quick-release as this can over-tighten the Flip-It mechanism and deform the clamping mechanism or fork steer tube. Flip-Its without the quick-releases need only occasional adjustment of tension. Use a hex wrench to adjust until it moves smoothly with some friction.

For bar and riser combinations see www.shoprans.com.

The Flip-It folds forward, away from the seat, a self locking bolt at the base of the riser adjusts tension, controlling the riser's freedom of movement. Sufficient tension should be applied to keep the Flip-It play free, with some light friction.

The travel of the Flip-It is limited by a set screw at its base. Adjust this screw with a hex wrench to adjust the lay of the handlebar when pulled fully into your chest.

With either riser, the handlebar should not crowd your face, chest, or knees.



WARNING! THE 3-INCH RULE: WHEN CLAMPING HANDLEBARS TOGETHER, BE SURE THREE INCHES OF THE THINNER BAR REMAIN INSIDE THE LARGER TUBE.



RANS HANDLEBARS



Chopper Bar



HR 3-Way



T-Bar

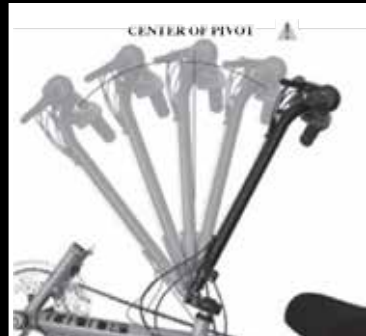

Flip-It



WARNING! CONTROL OF THE BRAKE WILL BE COMPROMISED IF THE HANDLEBAR IS POSITIONED FORWARD OF THE FORK'S CENTER OF PIVOT.

RIDING YOUR RANS BIKE

If you're unaccustomed to recumbent riding, it may take some practice to control the bike with confidence. Practice on a smooth surface with plenty of room, free of traffic and obstacles. An empty parking lot is ideal. It's important to become acquainted with your bike before mixing with traffic.

Apply a brake when mounting. If a brake is not applied when mounting, the bike may roll.

Lean back in the seat. Relax your back, shoulders, neck and arms. Turn the handlebar left and right. Lean on one foot, then the other to acquaint yourself with the weight and balance.

Check your gear settings. Begin on a level surface in a low gear.

Now sit back and relax. Focus your attention well ahead. This helps avoid over controlling and wobbling. Try gentle turns in both directions. Acquaint yourself with the brakes by applying them gently. Try U-turns in both directions. Try circles.

If you're riding a short-wheelbase model, beware of striking your heels on the front wheel during sharp turns. This happens because the bottom bracket is located close to the front wheel. Learn to point your toes forward a bit when turning a tight corner. As your balance improves, you will not need to correct your steering as much and "heel-strike" will happen much less often.

Shift and acquaint yourself with the bike's gearing. Anticipate the need to shift down, as when approaching traffic lights, so you'll be in a low gear when starting again.

Look around and enjoy the view! You can see in all directions without neck strain. Practice looking in the rear-view mirror and over your shoulders. Watch out for the natural tendency to steer the bike into the traffic lane when you check traffic behind you.

Anytime you 're in traffic on any kind of bike, ride as if you 're invisible. Do not assume other vehicle operators see you.

After a half hour or so, you should be confident in your balance and control. Remember, riding a RANS bike is a natural position, so relax.

CARING FOR YOUR RANS BIKE

FRAME

The RANS bike frame requires little to maintain. Keep it clean and dry. Dirt, dust and grit can be removed safely by spraying with common furniture polish and wiping with a clean cloth. Although not required, automotive wax may be applied to finished surfaces. Avoid high pressure spray. Trapped water can promote corrosion and damage moving parts.

DRIVE TRAIN

To extend the life and efficiency of your drive train, use a degreaser to remove grit from the chain, chain rings, derailleurs and brake pivots; lubricate to reduce friction and corrosion. Your RANS dealer offers cleaning products and lubricants appropriate for your locale.

SEATS

RANS recumbent seats are state-of-the-art, built for comfort, performance and durability. Light, isolated soiling can be removed with a damp cloth. For a more thorough cleaning of the seat bottom or mesh, remove and hand or machine-wash with a mild detergent. Air dry. To remove mud or other heavy soiling from the seat back, remove the seat from the frame, wash with soap and water, rinse and air-dry. Seat bottom and back fabrics are designed to easily be replaced, and replacement fabrics are available through your dealer or you can order online at www.shoprans.com.

TIRES

RANS bikes use high-pressure tires for reduced rolling resistance. Recommended pressures are found on the tire sidewalls. Our bikes use tubes with Presta-style valves, and adapters are included for common Schrader-style fittings. Presta valves require finger-loosening the valve stem before air is added to the tube, and re-tightening when complete.

WHEELS AND BRAKES

Before wheel removal, open brakes as per applicable procedure: Pull the cable lead tube from the yoke on the right brake arm.



Open and rotate the quick-release lever counter-clockwise to remove the forward wheel. To remove the rear wheel, shift the chain to the smallest sprocket on the rear cassette (highest setting on the right gear shifter) and open the quick-release; once it drops from the fork, remove the chain from the sprocket.

When replacing wheels, we recommend q.r. levers are positioned so that the lever points to the rear of the bike, and that the q.r. is tight enough that the lever will leave a slight imprint on your hand after it is "cammed over". Be sure axles are properly aligned in the dropouts, brakes are closed, and q.r. levers are shut.



Riding with loose or open quick releases can result in serious injury!

OVAL & V-CLAMP SEAT CLAMPS

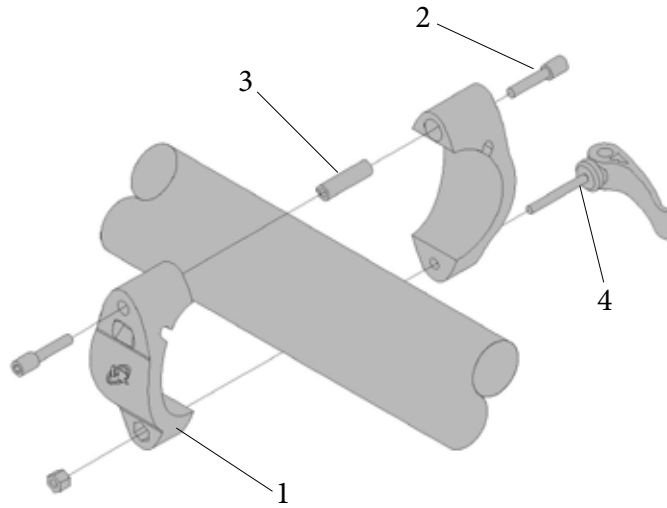

OVAL CLAMP

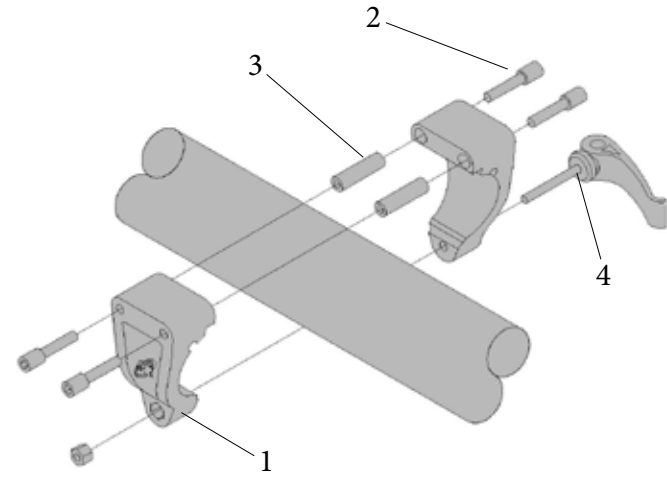

V-CLAMP

1. 1 1/2" V-CLAMP - (BPST0269-L/R) OR 2" V-CLAMP - (BPST0270-L/R) OR OVAL V-CLAMP - (BPST0312-L/R)
2. 8MM BOLT - (BPHW0072)
3. 8MM THREADED BUSHING - (BPHW0074)
4. 6MM X 60MM SKEWER - (BSST0006)

RANS Bikes Warranty Registration Form

(Your Name) _____
(Age) _____
(Address) _____ (City) _____
(St/Prov) _____ (Post Code) _____ (Your Email) _____
(Purchased From) _____
(Model) _____ (Date Purchased) _____
(Serial # On the crank tube 2-letters and 8 numbers) _____
(Comments) _____

You may also Register on-line at:
WWW.RANS.COM

.....Cut along lines and send to RANS.....



BIKES Limited Frame Warranty

RANS Bicycles, Inc. guarantees its bike frames against breakage for the lifetime of the original owner, subject to these conditions:

1. Damage resulting from neglected, modified, overloaded (over 275 lbs. rider & cargo) improperly adjusted or poorly maintained bikes, or bikes used in competition or commercially, or damage resulting in mistreatment or accidents.
2. Damage due to improper assembly or repair.
3. Flaws in the surface, aesthetics, or appearance of the bike, including though not limited to decals, anodized, plated, painted or powdercoated finishes; brazed-on parts; cable-stops, pump pegs, ect.
4. Normal wear and tear.
5. Damage resulting from rust or corrosion.
6. Damage resulting from the installation of aftermarket items, including fairings, racks, kickstand or any other fixture to the bike not specifically sold by or authorized by RANS as acceptable for use with the specific model and model year of bike.
7. Damage during shipping.
8. Dated bill of sale required.



BIKES Limited Parts Warranty

RANS Bicycles Inc. guarantees all parts on all models of RANS Bikes for a period of 90 days from the date of purchase by the original owner, subject to the same conditions of the limited frame warranty above.

RANS will repair or replace at our sole option. Labor and shipping charges are not covered by these warranties.

**RANS DESIGNS, INC.
4600 Highway 183 Alternate
Hays, KS 67601**

PLACE
STAMP
HERE

THANKS!

Ride safe and please contact us to let us know how the bike is working for you, any comments, ideas, or otherwise that you would like to share. Thanks for purchasing a RANS and I hope you will have many years of great cycling!

Randy Schlitter,

President RANS Bikes Inc.

RIDING - RULES OF THE ROAD

1. Watch for car doors opening and for cars pulling into traffic. Ride defensively. Always be prepared to stop quickly if necessary. Be extremely careful at intersections.
2. Advise motorists of your intent by giving the proper hand signals at least 100 feet before turning or stopping and also while waiting to turn. If traffic is heavy, walk your bicycle with pedestrian traffic. Look both ways before crossing streets.
3. Replace damaged reflectors and straighten or tighten any that are bent or loose. Reflectors are no substitute for lights. Always equip your bicycle with all state required lights, bicycle flags, reflective tape, and reflectors to make the bicycle and you more visible.
4. Ride slowly on damp surfaces as the tires will slide more easily. Apply the brakes sooner than normal as a greater stopping distance is required, especially if the wheel rims on caliper brake equipped models are wet. Lightly apply the rear brake to control your speed on downhill areas. Only apply the front brake gradually. Be carefully on loose gravel and loose soil. Apply the brakes gradually to maintain control.
5. Vision is very limited at dusk, so be very careful to avoid possible hazards.
6. Don't not let a coat or other clothing hang down and cover the rear reflector. Use extra caution in wet weather. Wear light-colored or reflective clothing, such as a reflective vest and reflective bands for your arms and legs. Use reflective tape on your helmet.
7. Always be courteous to pedestrians. Give pedestrians the right of way. Do not park your bike where it may be in someone's way, ride while carrying items, or with anything attached to your bike that might hinder your vision or control.
8. Ride on the correct side of the road. Ride with the traffic, not against. Ride in single file. Ride close to the curb, but far enough away so your pedal does not strike the curb.
9. Watch for the "other guy", the car, or the bicycle in front of you, and be prepared to take defensive action. Do not follow a car or another bicycle too closely. Especially beware of traffic approaching from behind; you may need to swerve to avoid hitting something.
10. Always keep both hands on the handlebar for better control of the bike. Keep your eyes on the road and the traffic around you. Be prepared to make an emergency stop to prevent an accident.

4600 Highway 183 Alt. Hays, KS 67601 P. (785) 625-6346 F. (785) 625-2795

WWW.RANS.COM

The background of the page is a light gray technical drawing or schematic. It features various mechanical components, including gears, shafts, and electrical connectors, rendered in a fine-line, wireframe style. The drawing is centered and occupies most of the page area below the black text bar.