

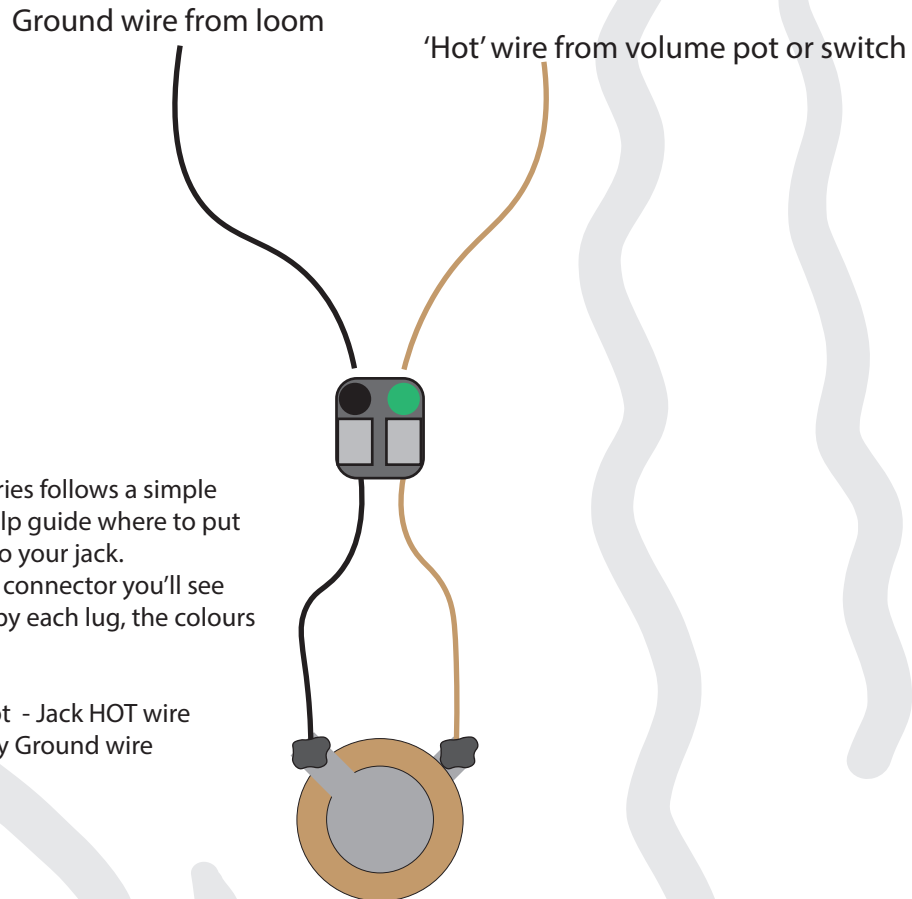

Configuration | Solderless Jack Socket
Volumes | N/A
Tones | N/A
Switch | N/A
Orientation | N/A



The Solderless series follows a simple colour code to help guide where to put each of the wire to your jack.
On the solderless connector you'll see little colour dots by each lug, the colours are as follows -

Green Metallic dot - Jack HOT wire
Black dot - For any Ground wire